

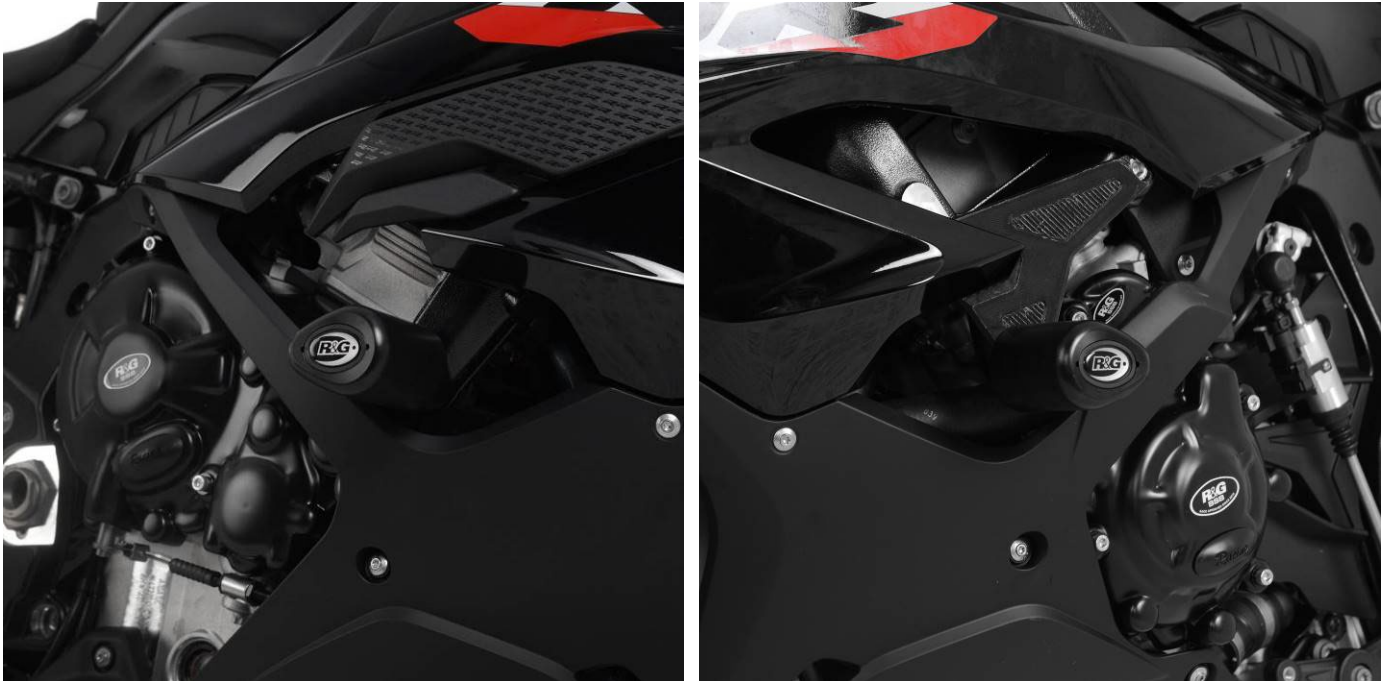

## **FITTING INSTRUCTIONS FOR CP0551 SYMMETRICAL CRASH PROTECTORS**



**THIS KIT CONTAINS THE ITEMS PICTURED AND LABELLED OVER PAGE.**

SOME PARTS MAY BE SHOWN FOR CLARITY OF INSTRUCTIONS ONLY.

DO NOT PROCEED UNTIL YOU ARE SURE ALL PARTS ARE PRESENT.

**PLEASE READ ALL INSTRUCTIONS BEFORE PROCEEDING.**

**IF IN ANY DOUBT WHEN FITTING OUR PRODUCTS, CONSULT ONE OF OUR DEALERS  
OR HAVE FITTED BY A QUALIFIED TECHNICIAN.**

PLEASE NOTE THAT THE WAY THE KIT IS PACKED DOES NOT NECESSARILY REPRESENT THE WAY OF  
MOUNTING TO THE BIKE.

IN THE EVENT OF RUBBER WASHERS BEING USED TO HOLD COMPONENTS ONTO BOLTS,  
THESE RUBBER WASHERS CAN BE THROWN AWAY.

**DIGITAL COPIES OF THESE INSTRUCTIONS ARE AVAILABLE FROM:**

[WWW.RG-RACING.COM](http://WWW.RG-RACING.COM)

R&G

Unit 1, Shelley's Lane, East Worldham, Alton, Hampshire, GU34 3AQ  
Tel: +44 (0)1420 89007 Fax: +44 (0)1420 87301 [www.rg-racing.com](http://www.rg-racing.com) Email: [info@rg-racing.com](mailto:info@rg-racing.com)



<b><u>GENERAL TORQUE SETTINGS</u></b>	<b><u>TOOLS REQUIRED</u></b>
M4 BOLT = 8Nm M5 BOLT = 12Nm M6 BOLT = 15Nm M8 BOLT = 20Nm M10 BOLT = 40Nm	<ul style="list-style-type: none"> <li>• T50 Torx Key/Socket</li> <li>• Torque Wrench</li> <li>• Scissor Jack</li> <li>• 17mm Socket and Ratchet</li> </ul>

### **LEGEND**

<b>ITEM NO.</b>	<b>DESCRIPTION</b>	<b>QTY</b>
ITEM 1	M0750 – CRASH PROTECTOR FIXING BRACKET	1
ITEM 2	B0061 - CRASH PROTECTOR	2
ITEM 3	M10x1.50x60mm CAP HEAD BOLT	2
ITEM 4	M10x1.25x60 HEX HEAD BOLT	1
ITEM 5	M10x1.50x110mm HEX HEAD BOLT	1
ITEM 6	S0142 – SPACER	1
ITEM 7	LW0001 – ANTI-ROTATION WASHER	2
ITEM 8	M10x19 PLAIN WASHER	2
ITEM 9	BC0002 – BOBBIN CAP	2
ITEM 10	FS0002 - SELF ADHESIVE FOAM	2

### **AERO STYLE CRASH-PROTECTOR ORIENTATION**



R&G

Unit 1, Shelley's Lane, East Worldham, Alton, Hampshire, GU34 3AQ

Tel: +44 (0)1420 89007 Fax: +44 (0)1420 87301 [www.rg-racing.com](http://www.rg-racing.com) Email: [info@rg-racing.com](mailto:info@rg-racing.com)



**LHS ASSEMBLY**

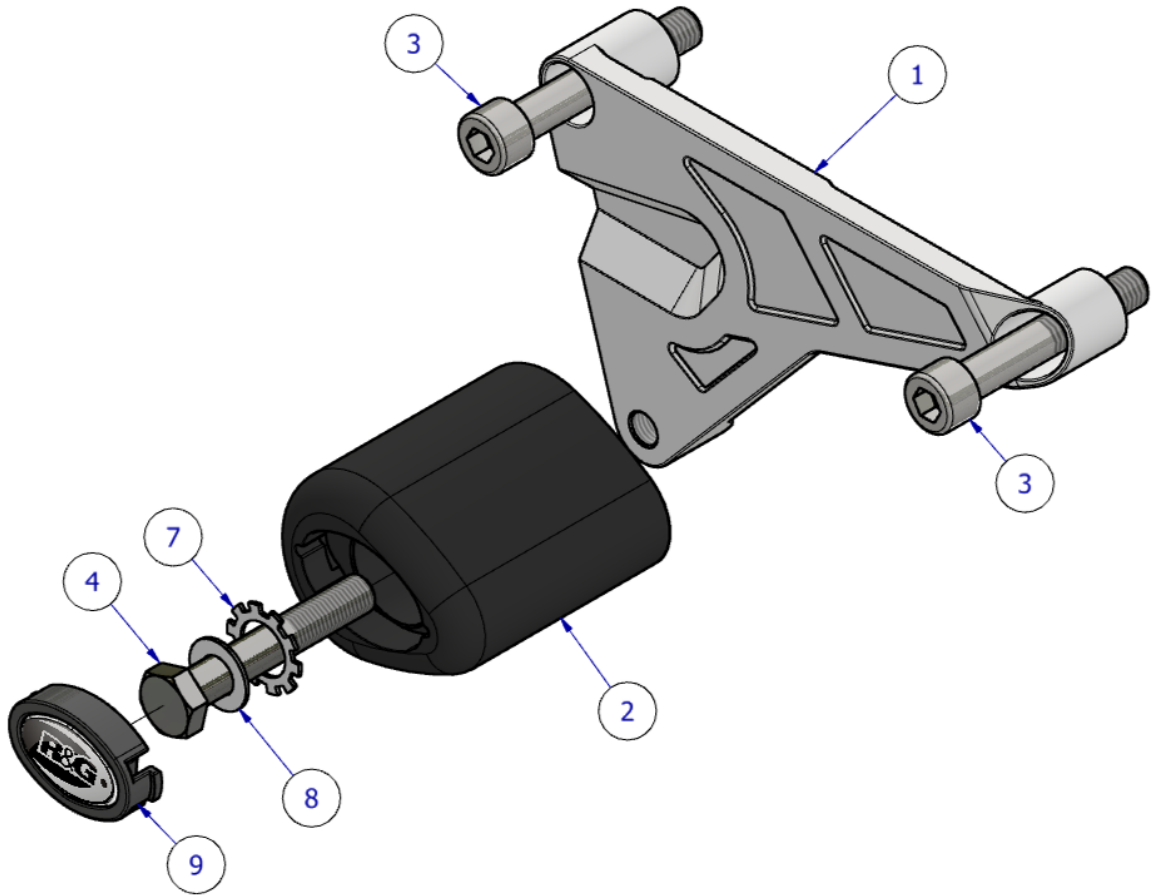

**RHS ASSEMBLY**

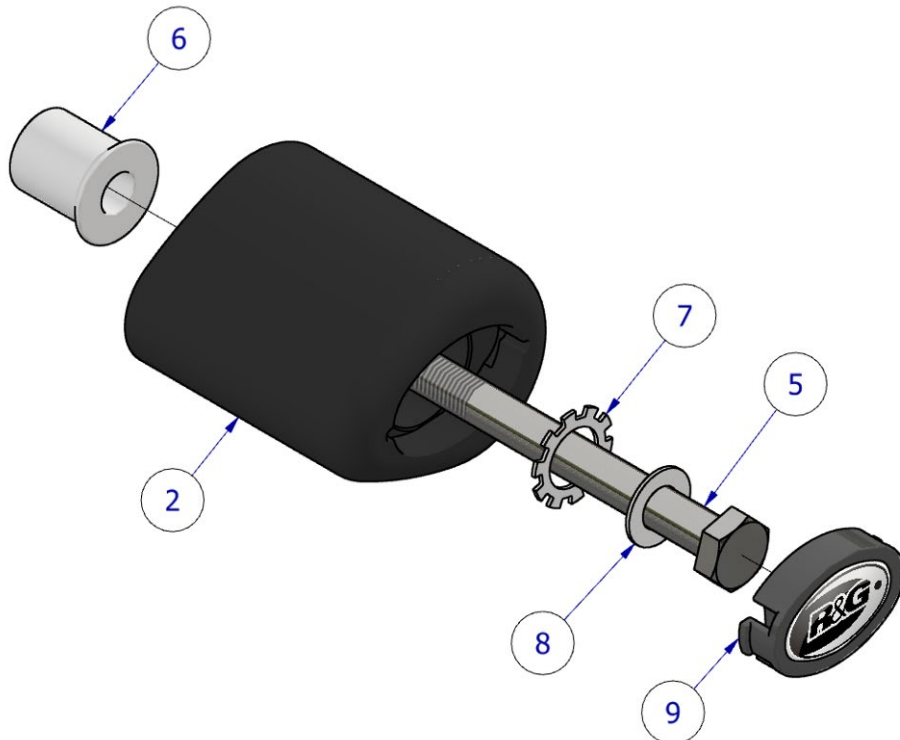

R&G

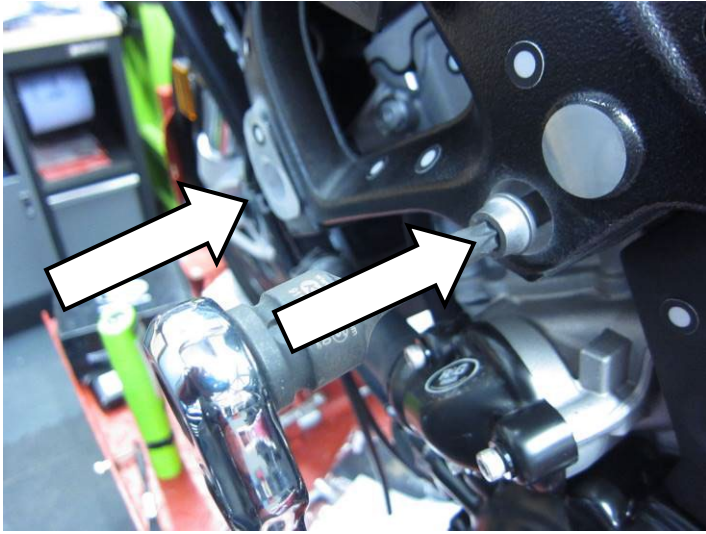

PICTURE 1



PICTURE 2

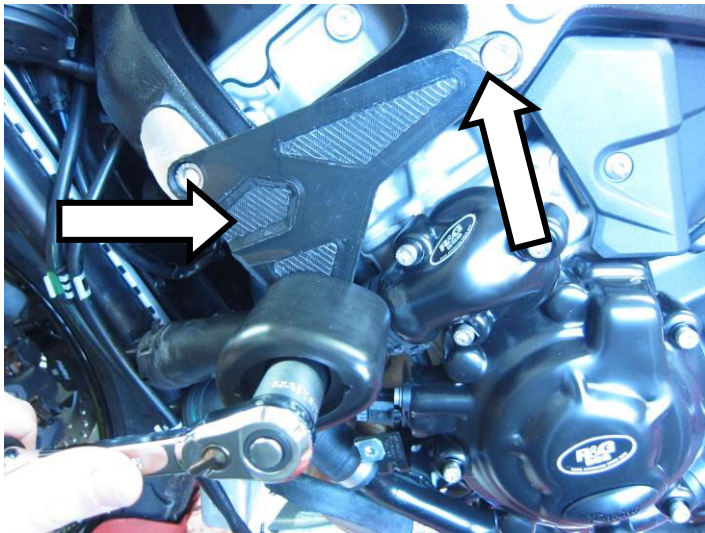

PICTURE 3

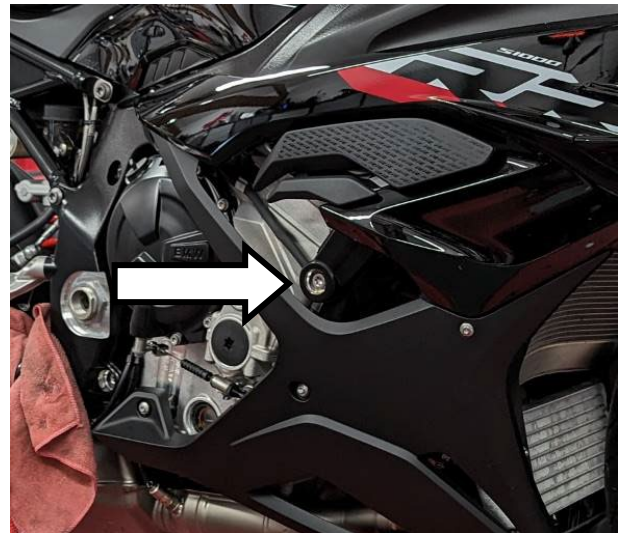

PICTURE 4

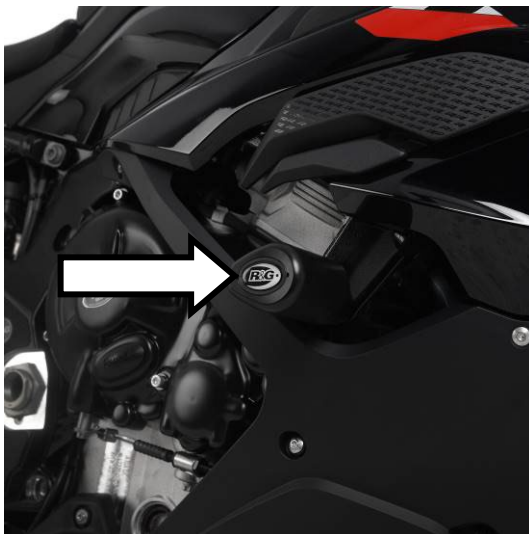

PICTURE 5



PICTURE 6



## **FITTING INSTRUCTIONS**

**Before removing engine bolts, ensure the bike is upright and supported by a suitable engine stand or jack placed under the sump of the motorbike to support the partial weight of the engine, this will prevent the engine from moving during fitting.**

**DO NOT REMOVE ENGINE BOLTS FROM BOTH SIDES AT THE SAME TIME.**

### **Left-Hand Side**

- Begin by removing the LHS fairing piece according to the manufacturers service manual.
- Remove the LHS engine bolts shown in **picture 1 & picture 2** using a T50 Torx tool.
- Referring to the assembly diagram on page 3 – fit the Metal bracket M0750 ash shown in picture 1 using the two cap head bolts (item 3). Torque bolts to the recommended setting.
- Re-fit the fairing as removed – during this stage be careful to avoid contact between the mounting bracket and fairing during fitting.

**NOTE:** For M1000R Model – The inner plastic fairing will need to be trimmed using a Dremel or similar tool in the area shown in **Picture 6**, this will not be visible once fairing has been re-fitted.

- Because of variation in fairings and wind-flex at higher speeds, it is recommended to place a piece of provided foam (item 10) in the areas highlighted in **picture 3** in case of contact.
- Assemble the LHS crash protector assembly according to the assembly diagram on page 3.
- Fix the crash protector into the mount bracket and torque to the recommended specification.

**PLEASE NOTE, THE CRASH PROTECTOR MUST BE POSITIONED AS IN THE DIAGRAM ON PAGE 2, WITH THE LARGER END TOWARDS THE FRONT OF THE BIKE.**

### **Right-Hand Side**

- Moving to the RHS of the motorcycle, remove the engine bolt arrowed in **picture 4** using a T50 Torx tool.
- Referring to the RHS assembly diagram on page 3 and shown in picture 3. First slide a washer (item 8) over the longest included hex-head bolt (item 5), followed by one of the serrated washers (item 7). Next, slide the bolt assembly through one of the included crash protectors (item 2), then slide the spacer (item 6) over the exposed end of the bolt, ensuring the tapered end sits against the rear face of the crash protector.
- Fix the crash protector into the frame and engine and tighten to the recommended torque. **PLEASE NOTE, THE CRASH PROTECTOR MUST BE POSITIONED AS IN THE DIAGRAM ON PAGE 2, WITH THE LARGER END TOWARDS THE FRONT OF THE BIKE.**

### **Both-Sides**

- Finally, fit the bobbin caps (item 4) to both crash protectors, as shown in **picture 5**.
- Before riding, check both sides are secure, and the crash protectors cannot rotate.
- Check tightness of each side regularly.

**See more R&G products for your Motorcycle On:**

**[RG-RACING.COM](http://RG-RACING.COM)**

ISSUE 2 – 21/03/2023 – DM

R&G

Unit 1, Shelley's Lane, East Worldham, Alton, Hampshire, GU34 3AQ  
Tel: +44 (0)1420 89007 Fax: +44 (0)1420 87301 [www.rg-racing.com](http://www.rg-racing.com) Email: [info@rg-racing.com](mailto:info@rg-racing.com)