



**FITTING INSTRUCTIONS FOR LP0267BK + LP0267BK(A) TAIL TIDY FOR
BENELLI TNT 2017-**



**THIS KIT CONTAINS THE ITEMS PICTURED AND LABELLED BELOW.
DO NOT PROCEED UNTIL YOU ARE SURE ALL PARTS ARE PRESENT.**

Please note that the way the kit is packed does not necessarily represent the way of mounting to the bike.

THE PARTS SHOWN MAY BE REPRESENTATIVE ONLY (FOR CLARITY OF INSTRUCTIONS ONLY).

Please note that in cases where kits are packed with rubber washers holding the components onto the bolt – *the rubber washers should be thrown away!*

Digital copies of these instructions are available to download from www.rg-racing.com



Assembly Diagram 1

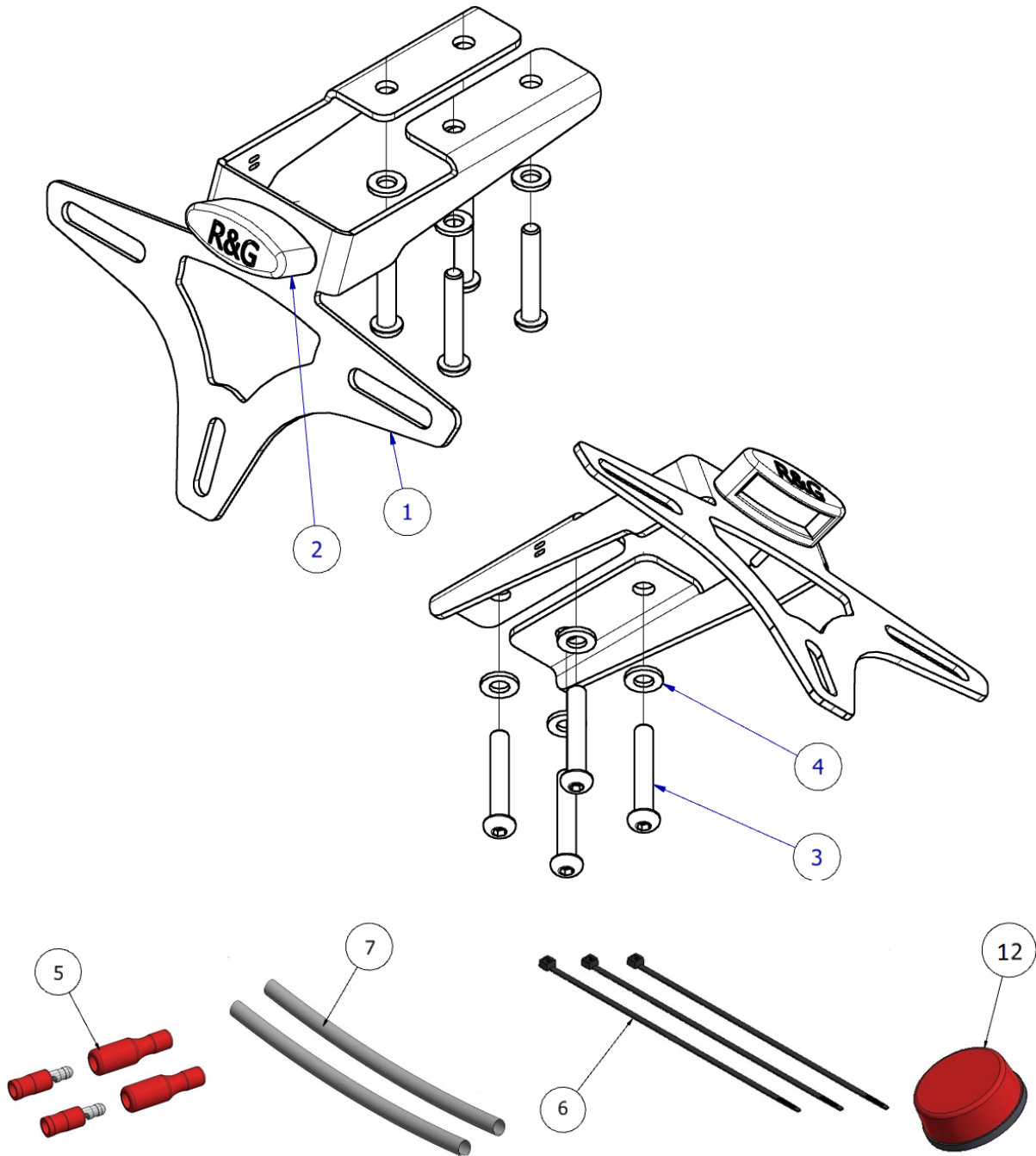



OE LICENCE PLATE HOLDER MOUNT COVER PARTS INCLUDED WITH LP0267(A)
Assembly Diagram 2

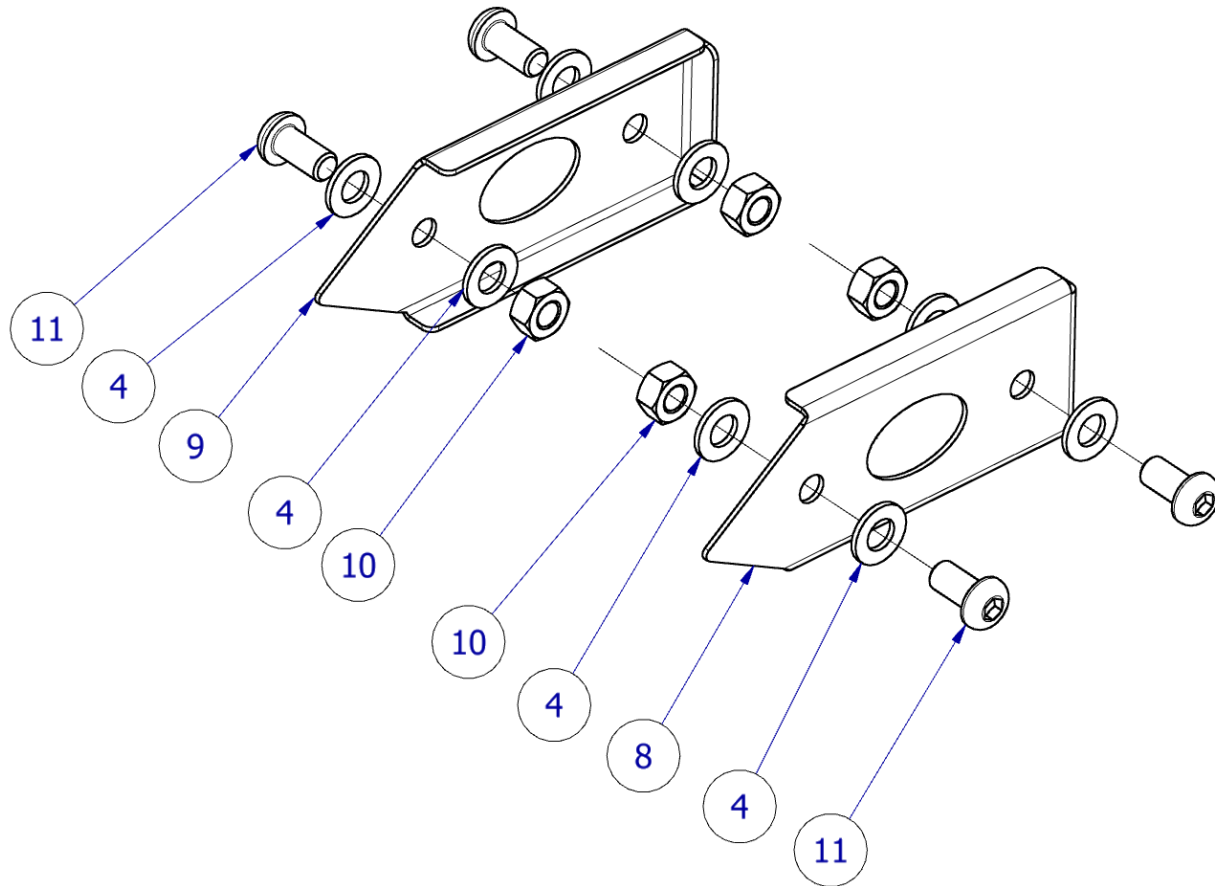

LEGEND

- ITEM 1 = TB0267 LICENCE PLATE MOUNTING BRACKET
 ITEM 2 = LA0002 No PLATE LIGHT ASSEMBLY (INCLUDING SHROUD)
 ITEM 3 = M6x1x35mm LONG BUTTON HEAD BOLTS (LP0267 - 4) (LP0267(A) - 12)
 ITEM 4 = M6 WASHERS 12mm O/DIA (4)
 ITEM 5 = No. PLATE CONNECTOR - CON0004
 ITEM 6 = 2.5mm CABLE TIES x 100mm LONG (4)
 ITEM 7 = 200MM LENGTH OF HEAT SHRINK
 ITEM 8 = LHS MOUNT COVER PLATE - SMW0147 - only provided with LP0267 (A)
 ITEM 9 = RHS MOUNT COVER PLATE - SMW0148 - only provided with LP0267 (A)
 ITEM 10 = M6 NYLOC NUTS (4)
 ITEM 11 = M6 x 15MM BUTTON HEAD BOLT - only provided with LP0267 (A)
 ITEM 12 = REFLECTOR

R&G

Unit 1, Shelley's Lane, East Worldham, Alton, Hampshire, GU34 3AQ
 Tel: +44 (0)1420 89007 Fax: +44 (0)1420 87301 www.rg-racing.com Email: info@rg-racing.com



TOOLS REQUIRED

- 4mm Allen key
- 6mm + 10mm sockets or spanners
- Small amount of superglue or similar adhesive
 - Electrical wire crimps

MAXIMUM TORQUE SETTINGS

- M4 BOLT = 8Nm
- M5 BOLT = 12Nm
- M6 BOLT = 15Nm
- M8 BOLT = 20Nm
- M10 BOLT = 40Nm

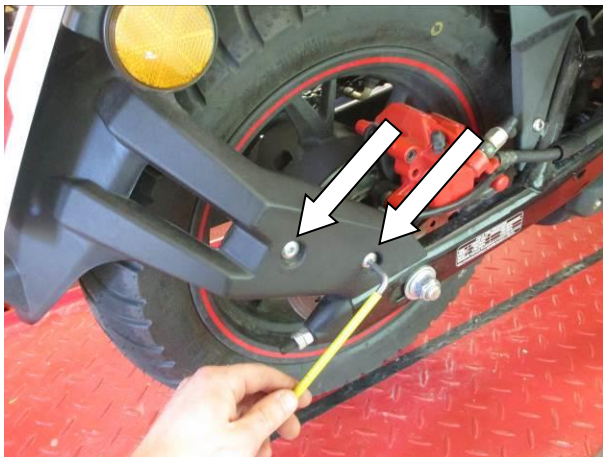

Picture 1

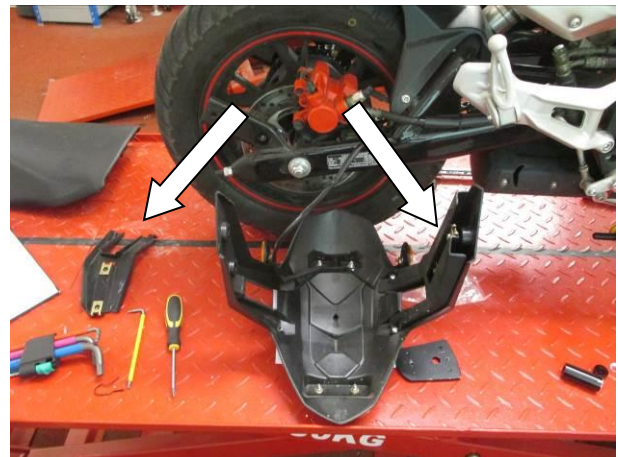

Picture 2

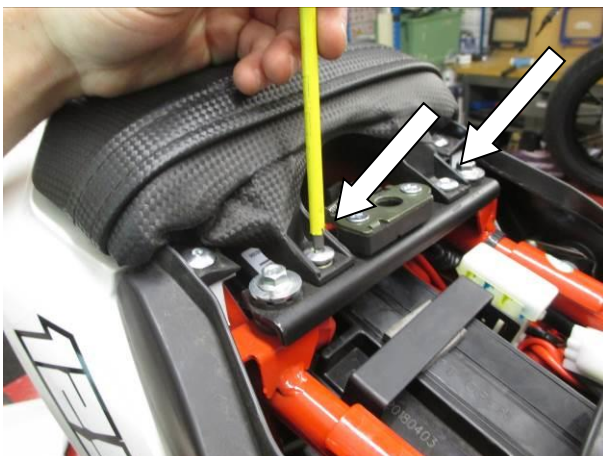

Picture 3



Picture 4

R&G

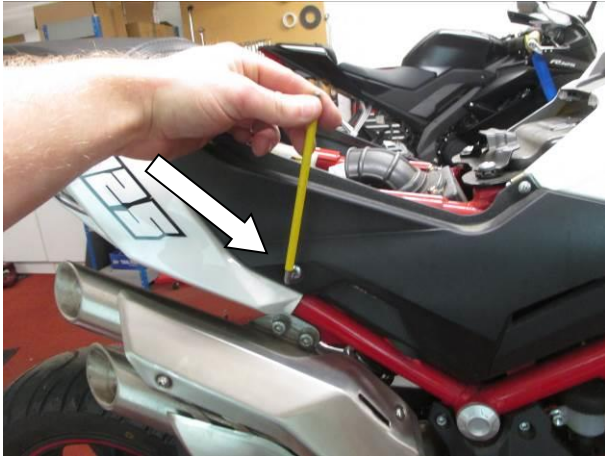

Picture 5



Picture 6



Picture 7



Picture 8

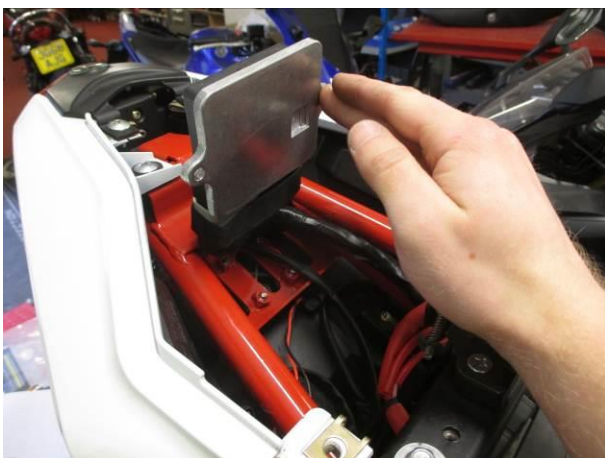

Picture 9



Picture 10

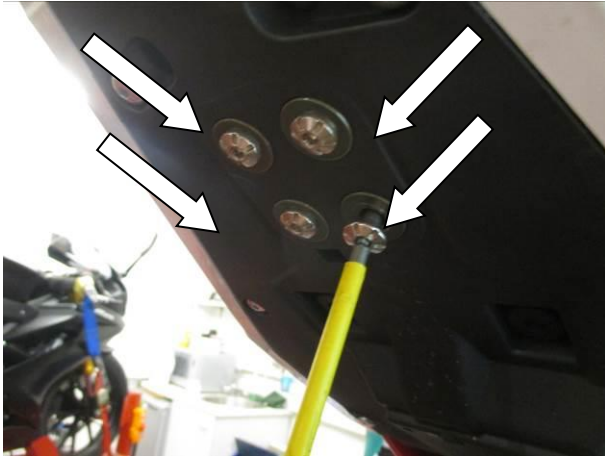

Picture 11



Picture 12

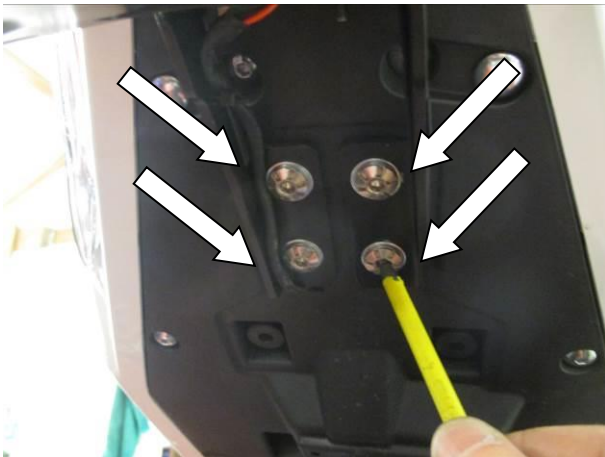

Picture 13



Picture 14



Picture 15



Picture 16

FITTING INSTRUCTIONS



- Begin by removing the OEM licence plate assembly, to do this, undo the two bolts shown in **picture 1** using a 4mm allen key on each side of the bike.
- Once removed, the LHS and RHS inner panels will come away from the tail unit as arrowed in **picture 2** and you can remove the tail piece.
- Remove the seat using the key to release the rider seat and use a 4mm allen key to remove 2 bolts for the pillion seat shown in **picture 3** and lift this away from the bike.
- The OEM licence plate illuminator wire will need to be disconnected before the unit can be fully removed. To disconnect this, remove the RHS mid panel using your 4mm allen key to remove the 2 bolts shown in **pictures 4 and 5** to gain access to the two bullet connectors shown in **picture 6**. Disconnect the bullet connectors.
- Trace the wire down the right hand side of the swingarm and remove any cable ties holding this to the bike as shown in **picture 7**. You can now fully remove the OEM tail piece from the bike.

TAIL TIDY ASSEMBLY

- To assemble the R&G tail unit, you should affix the shroud provided with the licence plate illuminator LA0002 (item 2) using a small amount of superglue or adhesive.
- Cover the red and black wires with the heat shrink provided (item 7) and heat with a heat gun to shrink the wire cover neatly.
- Next fix the licence plate illuminator (LA0002 - item 2) to the Tail bracket piece (TB0267 – Item 1) using the M4 washers and nuts provided with the light assembly, tighten these with a 6mm socket so the light is secure as shown in **Assembly diagram 1** on page 2
- Use the provided cable ties (item 6) by passing through the cable tie slots on the LHS of the tail tidy to neatly route the wire.
- To affix the R&G tail tidy to the bike, remove the 2 bolts found under the pillion seat that locate the ECU as shown in **picture 8**. **Do not disconnect the ECU**. lift the ECU as shown in **picture 9** to reveal a small rubber bung in the LHS of the plastic undertray, remove this as shown in **picture 10** to reveal a wiring hole.
- Remove the 4 x OEM bolts in the undertray as shown in **picture 11** using a 4mm allen key.
- Now feed the wire from the assembled R&G tail tidy through the hole as shown in **picture 12**.
- Fix the R&G tail tidy to the bike using the four M6x35mm button head bolts (item 3) and M6 washers (item 4) in place of the bolts just removed as shown in **Assembly Diagram 1** on page 2 and tighten the bolts to the specified torque as shown in **picture 13**.
- Next, route the licence plate illuminator wire underneath the ECU and towards the RHS of the bike to meet the OEM tail light illuminator wire bullet connectors.
- The OEM female bullet connectors will need to be replaced with the CON0004 female bullet connectors (Item 5) provided in the kit to ensure a good fit. Using your electrical crimps, cut the connectors and strip the wire insulation back by 10mm. Slide the plastic cover over the wire before crimping the new female bullet connector in place.
- Now, connect the licence plate illuminator bullet connectors to the original wires as shown in **picture 14**
- Test the licence plate illuminator at this stage. If illumination fails, swap the bullet connectors and re-test.
- Use the remaining cable ties to neaten the wiring and ensure the wire is clear of the seat mounts
- Refit the ECU, side panel and both seats to the bike in the same way they were removed.
- Fit the licence plate to the bike (it may require drilling).
- Depending on local laws, fit the reflector provided (item 12) to an appropriate location.

R&G

Unit 1, Shelley's Lane, East Worldham, Alton, Hampshire, GU34 3AQ
 Tel: +44 (0)1420 89007 Fax: +44 (0)1420 87301 www.rg-racing.com Email: info@rg-racing.com



- **IMPORTANT: IF FITTING A FULL-SIZE LICENCE PLATE AND PLACING IT FAR DOWN ON THE LICENCE PLATE HANGER, THERE IS A SMALL CHANCE OF THE LICENCE PLATE HITTING THE BACK WHEEL UNDER HEAVY LOAD AND OVER LARGE BUMPS IN THE ROAD. IT IS YOUR RESPONSIBILITY TO CHECK FOR THIS POSSIBILITY AND TAKE AVOIDING ACTION. FAILURE TO CHECK THIS COULD RESULT IN SERIOUS INJURY.**
- Retest the licence plate illuminator and all lights before riding.

COVER PLATE FITTING IF USING LP0267(A)

- To cover the rear mounts left by the OEM tail unit, Use SMW0147 LHS (item 8) and attach to the the swingarm mounting holes as shown in **picture 15**, use 2 x M6x15mm button head bolts (item 11) and 2 x M6 Nyloc nuts (item 10) and 4 x M6 washers (item 4) as shown in **assembly diagram 2**
- Repeat this for the right-hand side using SMW0148 RHS (item 9) Ensuring all bolts are tightened correctly using your 10mm socket and 4mm allen key.
- Insert a bubble sticker into each recess to complete the installation.

ISSUE 1 01/07/19 (DM)

CONSUMER NOTICE

The catalogue description and any exhibition of samples are only broad indications of the Products and R&G may make design changes which do not diminish their performance or visual appeal and supplying them in such state shall conform to the order. The Buyer acknowledges no representation or warranty (other than as to title) has been given or will apply to the Products other than those in R&G's order or confirmation and the Buyer confirms it has chosen the Products as being of merchantable quality and suitable for its particular purposes. Where R&G fits the Products or undertakes other services it shall exercise reasonable skill and care and rectify any fault free of charge unless the workmanship has been disturbed. The Buyer is responsible for ensuring that the warranty on the motorcycle is not affected by the fitting of the Products. On return of any defective Products R&G shall at its option either supply a replacement or refund the purchase money but shall not be liable if the Products have been modified or used or maintained otherwise than in accordance with R&G's or manufacturer's instructions and good engineering practice or if the defect arises from accident or neglect. Other than identified above and subject to R&G not limiting its liability for causing death and personal injury, it shall not be liable for indirect or consequential loss and otherwise its liability shall be limited to the amounts paid by the Buyer for the Products or the fitting or service concerned. These terms do not affect the Buyer's statutory rights.

R&G RETURNS POLICY (NON-FAULTY GOODS)

Returns must be pre-authorized (if not pre-authorized the return will be rejected). Goods may only be returned direct to us if they were purchased direct from us (customer must prove if necessary). Otherwise to be returned to original vendor. Goods must be in re-sellable condition, in the opinion of R&G. All returns are subject to a 25% restocking and handling fee (25% of the gross value exc. P&P – at the prevailing price at time of purchase). The customer must pay any and all carriage charges. No returns of discontinued products, unless within 14 days of purchase. This policy does not affect your statutory rights and does not refer to faulty goods.

R&G

Unit 1, Shelley's Lane, East Worldham, Alton, Hampshire, GU34 3AQ
 Tel: +44 (0)1420 89007 Fax: +44 (0)1420 87301 www.rg-racing.com Email: info@rg-racing.com