



**FITTING INSTRUCTIONS FOR TH0002**  
**TIE-DOWN HOOKS FOR DUCATI PANIGALE (ALL MODELS)**



**THIS KIT CONTAINS THE ITEMS PICTURED AND LABELLED BELOW.**  
**DO NOT PROCEED UNTIL YOU ARE SURE ALL PARTS ARE PRESENT.**

Please note that the way the kit is packed does not necessarily represent the way of mounting to the bike.

THE PARTS SHOWN MAY BE REPRESENTATIVE ONLY (FOR CLARITY OF INSTRUCTIONS ONLY).

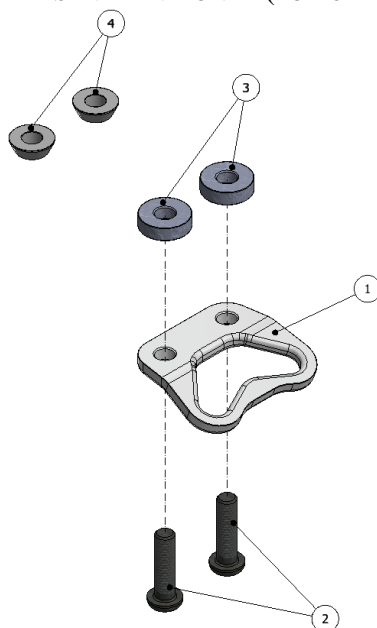

R&G Racing

Unit 1, Shelley's Lane, East Worldham, Alton, Hampshire, GU34 3AQ

Tel: +44 (0)1420 89007 Fax: +44 (0)1420 87301 [www.rg-racing.com](http://www.rg-racing.com) Email: [info@rg-racing.com](mailto:info@rg-racing.com)



### **LEGEND**

ITEM 1 = TIE-DOWN HOOK (SMW0059) (x1).

ITEM 2 = M8 x 30mm LONG COUNTERSUNK BOLT (x2).

ITEM 3 = SPACERS (S0623 – 6mm LONG) (x2).

ITEM 4 = SPACERS (S0940 – 6mm LONG TAPERED) (x2). *\*TO BE USED ON 959 WHEN NOT USING EXHAUST HANGER*

ITEM 5 = M8 x 20mm LONG COUNTERSUNK BOLT (x2). *(NOT SHOWN) \*TO BE USED ON 899 ONLY IN PLACE OF M8 x 30mm LONG COUNTERSUNK BOLTS*

Please note that in cases where kits are packed with rubber washers holding the components onto the bolt – *the rubber washers should be thrown away!*

### **TOOLS REQUIRED**

- Socket set to include 5 & 6mm socket and wrench and extensions.
- Socket set to include 12mm socket (only for use on 959).



Picture 1



Picture 2



Picture 3



### **GENERAL TORQUE SETTINGS**

- M4 BOLT = 8Nm
- M5 BOLT = 12Nm
- M6 BOLT = 15Nm
- M8 BOLT = 20Nm
- M10 BOLT = 40Nm

### **FITTING INSTRUCTIONS**

#### **If fitting to the 1199 & 1299**

- Position the two M8 x 30mm long countersunk bolts through the two mounting holes of the tie-down hook (SMW0059) (*ensuring the part bends outwards away from the bike*) and then through the two standard spacers (item 3 – S0623 – 6mm long), as shown in the exploded diagram on page 1.
- Take this assembly and offer it up to the bike, before loosely tightening the two bolts into the two subframe threaded bosses on the underside of the seat unit, as shown in pictures 1 & 2.
- Ensure the part is correctly fitted before tightening both bolts to the recommended torque values.

#### **If fitting to the 899**

- Position the two M8 x 20mm long countersunk bolts through the two mounting holes of the tie-down hook (SMW0059) (*ensuring the part bends outwards away from the bike*) and then through the two standard spacers (item 3 – S0623 – 6mm long), as shown in the exploded diagram on page 1.
- Take this assembly and offer it up to the bike, before loosely tightening the two bolts into the two subframe threaded bosses on the underside of the seat unit, as shown in pictures 1 & 2.
- Ensure the part is correctly fitted before tightening both bolts to the recommended torque values.

#### **If fitting to the 959 with exhaust hanger**

- Remove the two rearward mounting bolts for the exhaust hanger and offer the tie-down hook into position (*ensuring the part bends outwards away from the bike*) before fitting the two M8 x 30mm long countersunk bolts through the two mounting holes of the tie-down hook and exhaust hanger, before tightening into the two subframe threaded bosses on the underside of the seat unit, as shown in picture 3.
- Ensure the part is correctly fitted before tightening both bolts to the recommended torque values.

#### **If fitting to the 959 without exhaust hanger**

- If removing the pillion footrest mounting bracket and not re-fitting an exhaust hanger, use the two tapered spacers supplied (item 4 – S0940 – 6mm long) and fit between the heatshield and rear subframe front mounts and tighten using the OEM bolts.
  - Position the two M8 x 30mm long countersunk bolts through the two mounting holes of the tie-down hook (SMW0059) (*ensuring the part bends outwards away from the bike*) and then through the two standard spacers (item 3 – S0623 – 6mm long), as shown in the exploded diagram on page 1.
  - Take this assembly and offer it up to the bike, before loosely tightening the two bolts into the two subframe threaded bosses on the underside of the seat unit, as shown in pictures 1 & 2.
  - Ensure the part is correctly fitted before tightening both bolts to the recommended torque values.
- We recommend that fabric from the straps be in contact with the product, as opposed to the hook on the end of the strap. This will increase the lifespan of the protective coating on the product.
- Do not overtighten straps attached to the product, as it would be possible to bend or break the product with excessive force. If in any doubt please consult a professional.



- R&G cannot be held liable for any breakages to straps, or consequential damage from this, as a result of fraying/breaking of the straps, or incorrect use. Please ensure that all bodywork of the motorcycle which may come in contact with the straps (e.g. plastic panels, exhausts, swingarms) are protected or left completely clear of the straps.
- While we may show certain applications where the product is being used for attaching luggage to a motorcycle, this is not a general recommendation and cannot be achieved on all motorcycles.
- Care and attention needs to be taken whenever the product is in use for securing luggage or for tying the motorcycle down. R&G cannot accept any responsibility for inappropriate use or decisions on the part of the user. If in doubt, always consult a professional.

ISSUE 3 18/04/2017 (AR)

**Digital copies of these instructions are available to download from [www.rg-racing.com](http://www.rg-racing.com)**

#### **CONSUMER NOTICE**

The catalogue description and any exhibition of samples are only broad indications of the Products and R&G may make design changes which do not diminish their performance or visual appeal and supplying them in such state shall conform to the order. The Buyer acknowledges no representation or warranty (other than as to title) has been given or will apply to the Products other than those in R&G's order or confirmation and the Buyer confirms it has chosen the Products as being of merchantable quality and suitable for its particular purposes. Where R&G fits the Products or undertakes other services it shall exercise reasonable skill and care and rectify any fault free of charge unless the workmanship has been disturbed. The Buyer is responsible for ensuring that the warranty on the motorcycle is not affected by the fitting of the Products. On return of any defective Products R&G shall at its option either supply a replacement or refund the purchase money but shall not be liable if the Products have been modified or used or maintained otherwise than in accordance with R&G's or manufacturer's instructions and good engineering practice or if the defect arises from accident or neglect. Other than identified above and subject to R&G not limiting its liability for causing death and personal injury, it shall not be liable for indirect or consequential loss and otherwise its liability shall be limited to the amounts paid by the Buyer for the Products or the fitting or service concerned. These terms do not affect the Buyer's statutory rights.

#### **R&G RACING RETURNS POLICY (NON-FAULTY GOODS)**

Returns must be pre-authorized (if not pre-authorized the return will be rejected). Goods may only be returned direct to us if they were purchased direct from us (customer must prove if necessary). Otherwise to be returned to original vendor. Goods must be in re-sellable condition, in the opinion of R&G Racing. All returns are subject to a 25% restocking and handling fee (25% of the gross value exc. P&P – at the prevailing price at time of purchase). The customer must pay any and all carriage charges. No returns of discontinued products, unless within 14 days of purchase. This policy does not affect your statutory rights and does not refer to faulty goods.