



**FITTING INSTRUCTIONS FOR LP0255BK LICENCE PLATE BRACKET**  
**DUCATI SCRAMBLER DESERT SLED 18-**



**THIS KIT CONTAINS THE ITEMS PICTURED AND LABELLED BELOW.**  
**DO NOT PROCEED UNTIL YOU ARE SURE ALL PARTS ARE PRESENT.**

Please note that the way the kit is packed does not necessarily represent the way of mounting to the bike.

THE PARTS SHOWN MAY BE REPRESENTATIVE ONLY (FOR CLARITY OF INSTRUCTIONS ONLY).

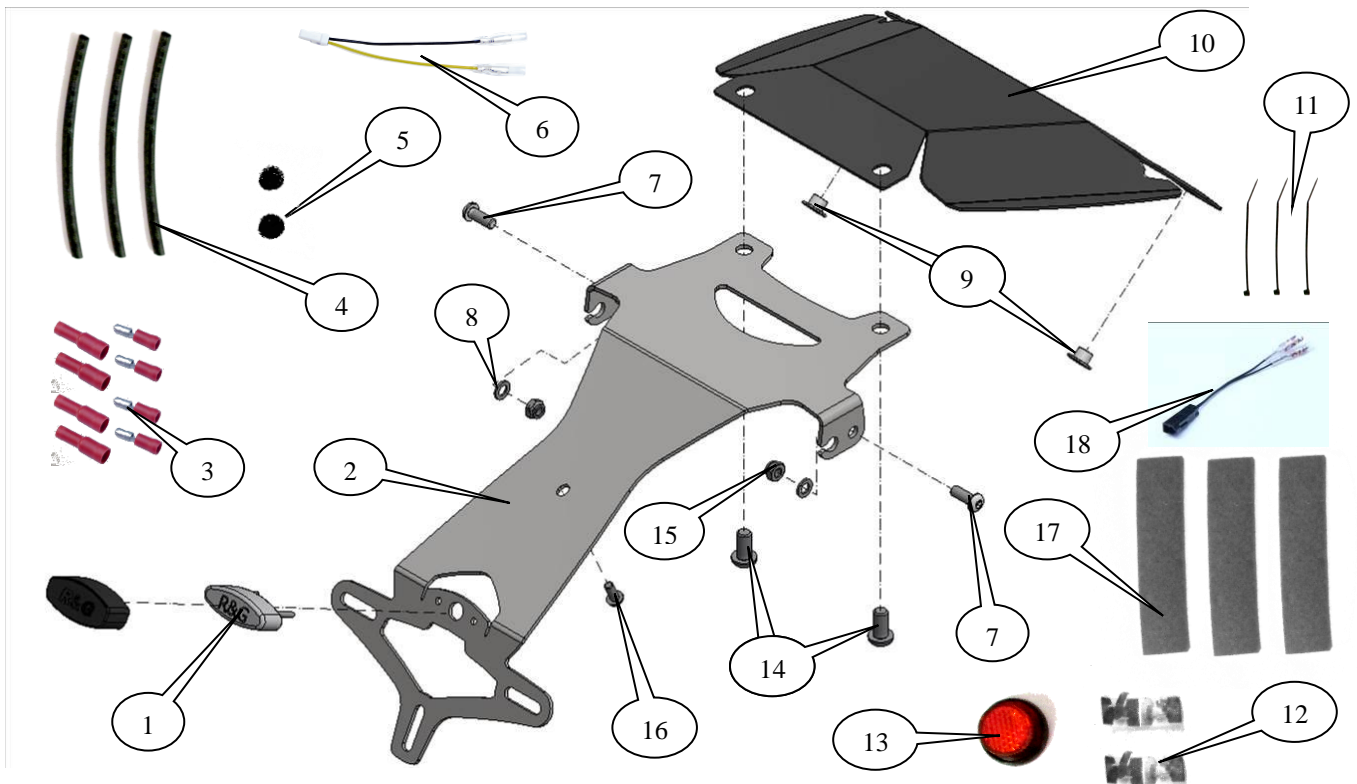



### **LEGEND**

- ITEM 1 = LA0002 No. PLATE LIGHT inc SHROUD (x1).  
 ITEM 2 = LICENSE PLATE BRACKET (TB255 Part 1) (x1).  
 ITEM 3 = BULLET CONNECTORS (CON0004) (x2).  
 ITEM 4 = 150mm LENGTH OF HEATSHRINK (x3).  
 ITEM 5 = RUBBER BUNGS (RB80-30-00) (x2).  
 ITEM 6 = No. PLATE ILLUMINATOR CONNECTOR (CON0014) (x1).  
 ITEM 7 = M6 x 16mm LONG BUTTON HEAD BOLTS (x2).  
 ITEM 8 = M6 WASHER (x2).  
 ITEM 9 = SPACERS (S0915 – 7.5mm LONG) (x2).  
 ITEM 10 = COVER (TB0187 Part 2) (x1).  
 ITEM 11 = 2.5mm CABLE TIES (x3).  
 ITEM 12 = SELF ADHESIVE CABLE CLIPS (x4).  
 ITEM 13 = REFLECTOR (x1).  
 ITEM 14 = M8 x 16mm LONG BUTTON HEAD BOLTS (x2).  
 ITEM 15 = M6 NYLOC NUTS (x2).  
 ITEM 16 = M5 x 12mm LONG BUTTON HEAD BOLT (x1).  
 ITEM 17 = SELF-ADHESIVE NEOPRENE FOAM (x3).  
 ITEM 18 = INDICATOR CONNECTORS (CON0015) (x2)

Please note that in cases where kits are packed with rubber washers holding the components onto the bolt – *the rubber washers should be thrown away!*

### **TOOLS REQUIRED**

- Set of metric Allen keys to include 3, 4, & 5mm A/F size.
  - 6, & 10mm spanners or sockets.
  - Cable cutters.

### **MAXIMUM TORQUE SETTINGS**

- M4 Bolt = 8 Nm
- M5 Bolt = 12 Nm
- M6 Bolt = 15 Nm
- M8 Bolt = 20 Nm



Picture 1



Picture 2



Picture 3



Picture 4



Picture 5



Picture 6



Picture 7



Picture 8



Picture 9



Picture 10



Picture 11



Picture 12



Picture 13



Picture 14



Picture 15



Picture 16



Picture 17



Picture 18



Picture 19



Picture 20



Picture 21



Picture 22



Picture 23



Picture 24

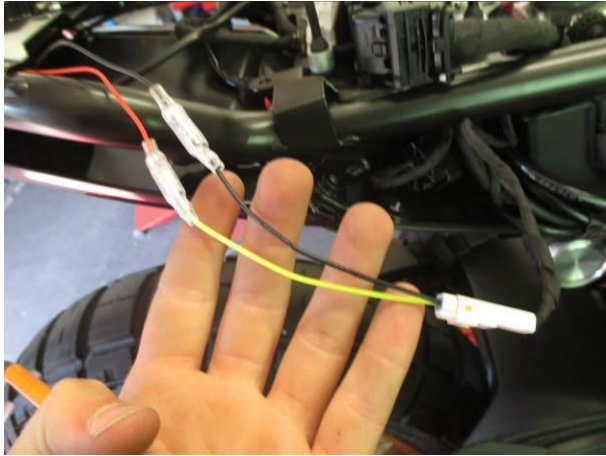

Picture 25



Picture 26



Picture 27



Picture 28



Picture 29



Picture 30



### FITTING INSTRUCTIONS

- To fit the R&G tail tidy, remove the seat using the key as shown in picture 1.
- Gently pull the two boxes labelled 'MAIN' and 'FUEL' from their rubber housing as shown in picture 2
- Remove the tool pouch and plastic tool box compartment by removing the two allen head bolts and lifting the box from the front as shown in picture 3
- Remove the plastic undertray on the underside of the tail shown in picture 4 by removing the four bolts on the underside of the panel
- On the side panel on the right side of the bike, remove the top mounting bolt shown in picture 5 and the lower mounting bolt as arrowed in picture 6.
- The side panel can now be pulled off its rubber mounts and removed from the bike, as shown in picture 7.
- In order to access the connectors for the license plate light and indicators it may be necessary to remove the mid panel underneath the seat. Start by removing the allen head bolt securing the damper oil reservoir to the under tray as shown in picture 8
- Open the reservoir mount and carefully manoeuvre the reservoir out of the unit to reveal two hidden bolts. Loosen or remove these bolts to allow better access to the wiring connectors located on top of this panel. There should be no need to remove this panel entirely. See picture 9
- Follow the wires from the license plate light and indicators and cut any cable ties securing these to the subframe as shown in picture 10
- Disconnect the license plate light and indicator connectors accessed from the right side of the bike. Shown in picture 11 and 12. (*it is advisable to mark on the connectors which pair match, to aid re-fitting*).
- Cut any cable ties that secure these wires to the subframe and feed the wires out towards the rear of the bike as shown in picture 13
- Remove the 5x Allen head bolts securing the licence plate subframe to the rear of the bike lower away from the bike being careful not to pull or damage any wires as they part from the bike. As seen in picture 14

R&G Racing

Unit 1, Shelley's Lane, East Worldham, Alton, Hampshire, GU34 3AQ

Tel: +44 (0)1420 89007 Fax: +44 (0)1420 87301 [www.rg-racing.com](http://www.rg-racing.com) Email: [info@rg-racing.com](mailto:info@rg-racing.com)





- With the subframe now loose, remove the top hat spacers from the front mounting holes, as shown in picture 15, as these will be required when re-fitting.

#### Tail Tidy Assembly

- Take the licence plate bracket (item 2 – TB0255 Part 1) and fit the R&G tail light (item 1 – LA0002) to the bracket, as shown in picture 16. Fit one length of heatshrink to the wires and tighten the nuts on the rear. Route the wire on the top side of the tail tidy using the adhesive tabs (item 12) and cable ties (item 11) provided as shown in picture 17.

#### If fitting OEM Indicators

- Remove the OEM indicators from the subframe by removing the 1 x allen head bolt from each indicator and remove the wire via the slot as shown in picture 18
- To fit the OEM indicators to the R&G Tail Tidy, re-fit the indicator to the mounts on the tail tidy and fit the M6 x 16mm long button head bolt, M6 washer & M6 nyloc nut through the mounting hole, before tightening, as shown in pictures 19, 20 & 21.

#### If fitting R&G Mini Indicators

- To fit the R&G Mini Indicators, first fit the rubber bung (item 5) into the round hole and then the R&G Mini Indicator through the hole with the slot, before fitting the nut and tightening, as shown in pictures 22 & 23.
- Attach the indicator connectors (CON0015 – Item 18) to the mini indicator using bullet connectors as follow:
  - If fitting R&G Aero Indicators with LED's
    - Indicator Yellow ----- → Connector Black/white*
    - Indicator Black ----- → Connector Black*

*1x set of RGR0001 resistors (available separately) are required to achieve the correct flash rate.*
  - If fitting R&G Mini Indicators with bulbs
    - Indicator Black/white ----- → Connector Black/white*
    - Indicator Black ----- → Connector Black*
  - If fitting R&G Mini Indicators with LED's
    - Indicator Black/white ----- → Connector Black/white*
    - Indicator Black ----- → Connector Black*

*1x set of RGR0001 resistors (available separately) are required to achieve the correct flash rate.*
- Fit one length of heat shrink supplied (item 4) to protect the indicator wiring on both indicators.
- Take the No. plate illuminator connector (item 6 – CON0014) and connect the bullet connectors to the connectors on the no. plate illuminator wiring – black to black and yellow to red, as shown in picture 25.
- Take the tail tidy assembly and sit it on the rear wheel whilst feeding the wiring into the area where the original wiring was disconnected, Shown in image 26. Careful to ensure the wires are placed where they will not obstruct the seat unit or tool box on reassembly
- Re-connect the wiring to the original connectors and check for the correct operation of all lights.
- Re-fit the damper reservoir and cover using the same spacers and OEM bolts that were removed to gain access to the wiring area, leaving the rearmost bolts out for now.
- Take the tail tidy cover (item 10 – TB0187 Part 2) and offer up to the underside of the tail as shown in pictures 27. The front mounts (the holes that are widest apart) need to locate between the

R&G Racing

Unit 1, Shelley's Lane, East Worldham, Alton, Hampshire, GU34 3AQ

Tel: +44 (0)1420 89007 Fax: +44 (0)1420 87301 [www.rg-racing.com](http://www.rg-racing.com) Email: [info@rg-racing.com](mailto:info@rg-racing.com)



subframe and the tail tidy, use the foam strips (part 17) to protect any areas where this panel may contact the frame or underside of the bike.

- With the cover correctly positioned, re-fit the OEM top hat spacer and OEM bolt through the hole and into the threaded boss on the frame
- Whilst keeping the wires clear of any mounting holes or pinching areas, lift the tail tidy assembly and place this onto the underside of the bike and fit the two M8x16 bolts through the cover plate and into the threaded hole where the subframe was originally supported as shown in picture 24, this will be enough to support the tail tidy whilst the rest of the bolts are inserted.
- Refit the rear support attaching the tail tidy to the mudguard using the M5 X 12 button head bolt (item 16) as shown in picture 29
- Ensure the tail tidy is correctly fitted and that the indicators are at the right level and all wiring is routed correctly before tightening all bolts evenly.
- Re-fit the side panel using the three original bolts.
- Re-fit the tool box as shown in picture 30 and reinsert the 'Fuel' and 'Main' wires back into the rubber housing.
- Re-fit the seat.
- Ensure the tail tidy is securely mounted and all bolts are fully tightened.
- Re-fit the licence plate (it may require drilling).
- **IMPORTANT: IF FITTING A FULL-SIZE LICENCE PLATE AND PLACING IT FAR DOWN ON THE LICENCE PLATE HANGER, THERE IS A SMALL CHANCE OF THE LICENCE PLATE HITTING THE BACK WHEEL UNDER HEAVY LOAD AND OVER LARGE BUMPS IN THE ROAD. IT IS YOUR RESPONSIBILITY TO CHECK FOR THIS POSSIBILITY AND TAKE AVOIDING ACTION. FAILURE TO CHECK THIS COULD RESULT IN SERIOUS INJURY.**
- Depending on local laws, attach enclosed reflector in an appropriate location.
- Test the license plate illuminator and all lights before riding.

#### CONSUMER NOTICE

The catalogue description and any exhibition of samples are only broad indications of the Products and R&G may make design changes which do not diminish their performance or visual appeal and supplying them in such state shall conform to the order. The Buyer acknowledges no representation or warranty (other than as to title) has been given or will apply to the Products other than those in R&G's order or confirmation and the Buyer confirms it has chosen the Products as being of merchantable quality and suitable for its particular purposes. Where R&G fits the Products or undertakes other services it shall exercise reasonable skill and care and rectify any fault free of charge unless the workmanship has been disturbed. The Buyer is responsible for ensuring that the warranty on the motorcycle is not affected by the fitting of the Products. On return of any defective Products R&G shall at its option either supply a replacement or refund the purchase money but shall not be liable if the Products have been modified or used or maintained otherwise than in accordance with R&G's or manufacturer's instructions and good engineering practice or if the defect arises from accident or neglect. Other than identified above and subject to R&G not limiting its liability for causing death and personal injury, it shall not be liable for indirect or consequential loss and otherwise its liability shall be limited to the amounts paid by the Buyer for the Products or the fitting or service concerned. These terms do not affect the Buyer's statutory rights.

#### R&G RETURNS POLICY (NON-FAULTY GOODS)

Returns must be pre-authorized (if not pre-authorized the return will be rejected). Goods may only be returned direct to us if they were purchased direct from us (customer must prove if necessary). Otherwise to be returned to original vendor. Goods must be in re-sellable condition, in the opinion of R&G. All returns are subject to a 25% restocking and handling fee (25% of the gross value exc. P&P – at the prevailing price at time of purchase). The customer must pay any and all carriage charges. No returns of discontinued products, unless within 14 days of purchase. This policy does not affect your statutory rights and does not refer to faulty goods.

ISSUE 1 02/08/2018 (DM)

R&G Racing

Unit 1, Shelley's Lane, East Worldham, Alton, Hampshire, GU34 3AQ

Tel: +44 (0)1420 89007 Fax: +44 (0)1420 87301 [www.rg-racing.com](http://www.rg-racing.com) Email: [info@rg-racing.com](mailto:info@rg-racing.com)