



**FITTING INSTRUCTIONS FOR LP0243BK LICENCE PLATE BRACKET  
DUCATI PANIGALE V4, V4S & SPECIALE '18-**



**THIS KIT CONTAINS THE ITEMS PICTURED AND LABELLED BELOW.  
DO NOT PROCEED UNTIL YOU ARE SURE ALL PARTS ARE PRESENT.**

Please note that the way the kit is packed does not necessarily represent the way of mounting to the bike.

THE PARTS SHOWN MAY BE REPRESENTATIVE ONLY (FOR CLARITY OF INSTRUCTIONS ONLY).

**TOOLS REQUIRED**

- Set of metric Allen keys.
- 6mm deep socket & wrench.
  - Set of Torx socket bits.
- 8, 10 & 12mm open-ended spanner.
  - Cable cutters.

**MAXIMUM TORQUE SETTINGS**

- M4 Bolt = 8 Nm
- M5 Bolt = 12 Nm
- M6 Bolt = 15 Nm
- M8 Bolt = 20 Nm
- M10 Bolt = 40 Nm

Please note that in cases where kits are packed with rubber washers holding the components onto the bolt – *the rubber washers should be thrown away!*

R&G

Unit 1, Shelley's Lane, East Worldham, Alton, Hampshire, GU34 3AQ  
Tel: +44 (0)1420 89007 Fax: +44 (0)1420 87301 [www.rg-racing.com](http://www.rg-racing.com) Email: [info@rg-racing.com](mailto:info@rg-racing.com)

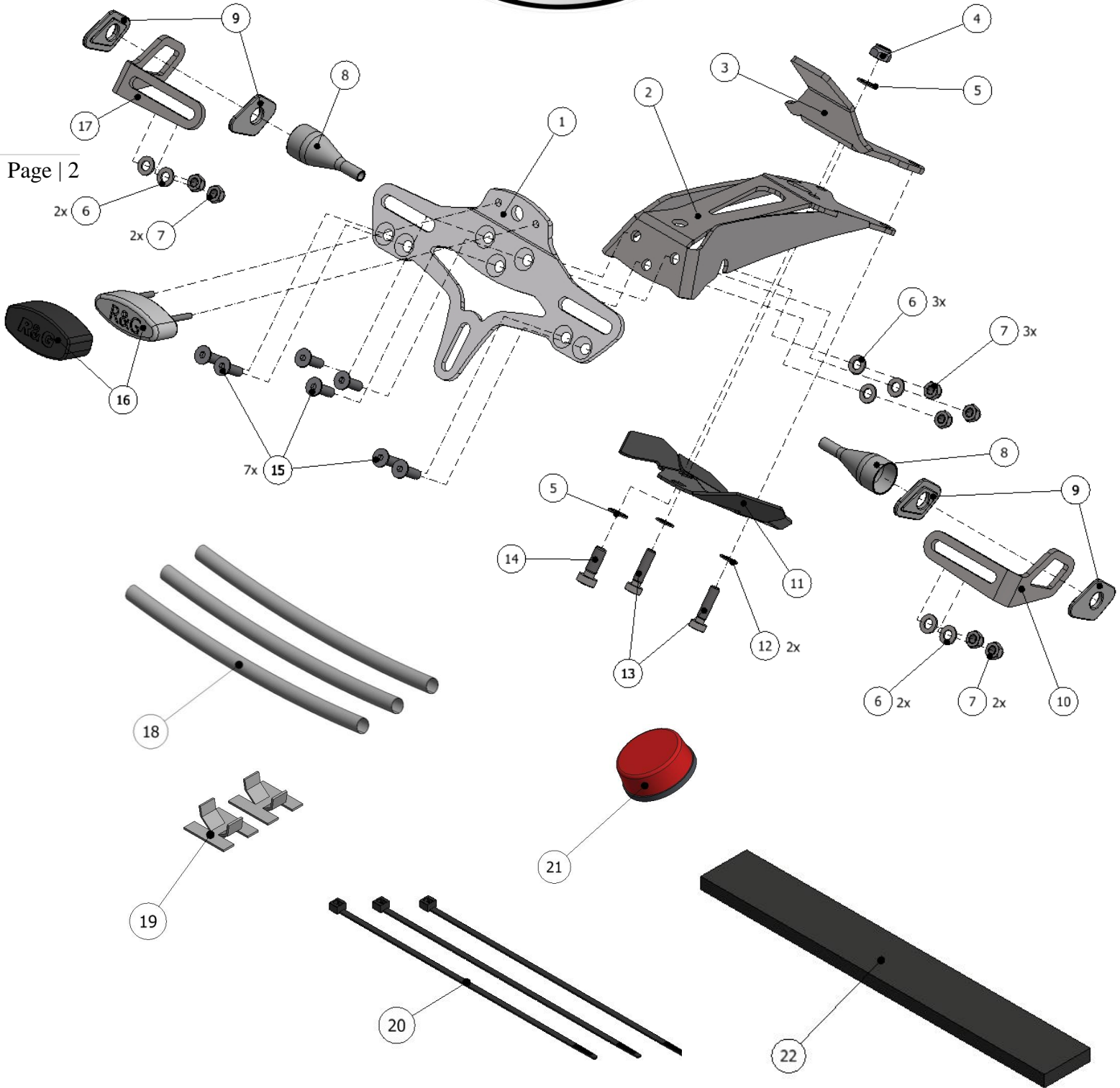

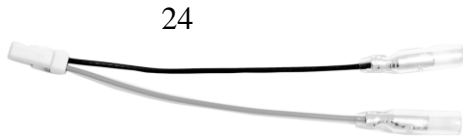

**LEGEND**

- ITEM 1 = LICENCE PLATE BRACKET (TB0243 Part 3) (x1).
- ITEM 2 = MAIN BRACKET (TB0243 Part 1) (x1).
- ITEM 3 = MOUNTING BRACKET (TB0243 Part 2) (x1).
- ITEM 4 = M6 NYLOC NUT (x1).
- ITEM 5 = M6 LOCK WASHERS (x2).
- ITEM 6 = M5 WASHERS (x7).
- ITEM 7 = M5 NYLOC NUTS (x7).
- ITEM 8 = INDICATOR WIRING COVERS (x2).
- ITEM 9 = MINI INDICATOR ADAPTORS (I0043) (x4).
- ITEM 10 = INDICATOR MOUNT RIGHT (TB0243 Part 6) (x1).
- ITEM 11 = COVER (TB0243 Part 4) (x1).
- ITEM 12 = M5 LOCK WASHERS (x2).
- ITEM 13 = M5 x 20mm LONG TORX BOLTS (x2).
- ITEM 14 = M6 x 16mm LONG TORX BOLT (x1).
- ITEM 15 = M5 x16mm LONG COUNTERSUNK BOLTS (x7).
- ITEM 16 = LICENCE PLATE ILLUMINATOR & SHROUD (LA0002) (x1).
- ITEM 17 = INDICATOR MOUNT LEFT (TB0243 Part 5) (x1).
- ITEM 18 = 150mm LENGTH OF HEATSHRINK (x3).
- ITEM 19 = SELF-ADHESIVE CABLE CLIPS (x2).
- ITEM 20 = CABLE TIES (x6).
- ITEM 21 = REFLECTOR (x1).
- ITEM 22 = SELF-ADHESIVE FOAM (x1).
- ITEM 23 = INDICATOR CONNECTORS (CON0015) (x2).
- ITEM 24 = LICENCE PLATE ILLUMINATOR CONNECTOR (CON0014) (x1).



Picture 1



Picture 2

R&G



Page |



Picture 3



Picture 4



Picture 5



Picture 6



Picture 7



Picture 8



Picture 9



Picture 10



Picture 11



Picture 12



Picture 13



Picture 14



Picture 15



Picture 16



Picture 17



Picture 18



Picture 19



Picture 20



Picture 21



Picture 22

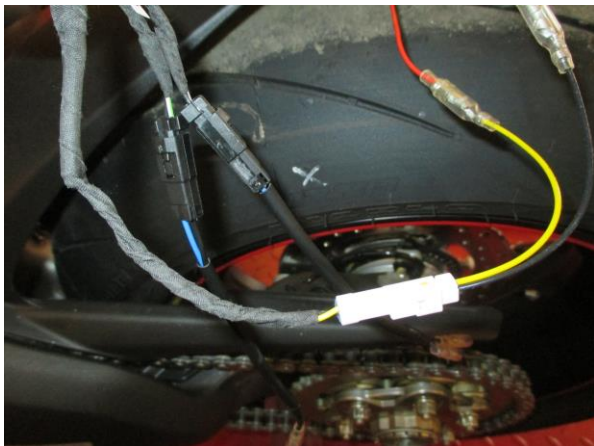

Picture 23



Picture 24



Picture 25



Picture 26



Picture 27



Picture 28

### **FITTING INSTRUCTIONS**

- Remove the two bolts that secure the OEM licence plate hanger in place, as shown in picture 1.
- Rotate the licence plate hanger downwards and slide out from its rubber mount, as shown in picture 2. Disconnect the wiring connector and remove from the bike.
- Remove the four Torx screws on the underside of the OEM licence bracket to split in half, as shown in pictures 3 & 4.
- Cut the cable ties and disconnect the wiring connectors before removing the sub-loom, as shown in picture 5.
- If planning to re-use the OEM indicators, remove these from their mounts, as shown in picture 6.
- Take the licence plate bracket (item 1 – TB0243 Part 3) and offer it up to the main bracket (item 2 – TB0243 Part 1), as shown in the exploded diagram. Take three of the M5 x 16mm long countersunk bolts (item 15) and locate through the three countersunk holes on the licence plate bracket and the main bracket, as shown in pictures 7 & 8. Fit three of the M5 washers (item 6) and three M5 nyloc nuts (item 7) to the exposed ends of the three bolts, before tightening.
- Take the R&G licence plate illuminator (item 16) and fit by feeding the two threaded studs on the light through the two holes in the bracket, before fitting the two nuts using a 6mm deep socket on the rear, as shown in pictures 9 & 10.
- Fit one length of heatshrink to the wires on the licence plate illuminator, before feeding the wires through the hole on the main bracket, as shown in picture 11. Fit the shroud to the light.
- Fit the indicator brackets (item 10 on the right & item 17 on the left) using the remaining four M5 x 16mm long countersunk bolts (item 15), M5 washers (item 6) and M5 nyloc nuts (item 7) to locate in place, as shown in pictures 11 & 12.
- If re-using the OEM indicators, fit the rubber mounts through the diamond shaped hole in the indicator mount, as shown in picture 13. *Some lubricant may be required to aid fitment.*
- If fitting mini indicators, take two indicator adaptors (item 9 – I0043) and fit over the indicator stalk, with the raised bosses facing each other. Feed the wiring through the indicator mounting hole and position one adaptor on each side of the bracket, before fitting the nut and tightening in place, as shown in pictures 14 & 15. Once tight, slide one of the indicator wiring covers (item 8 – IWC0002) over the wiring before applying a length of heatshrink to the wiring, as shown in picture 15.
- Repeat the above procedure to fit the remaining indicator on the other side of the tail tidy.
- Position the wiring in the slot of the main bracket to keep the wiring routing neat, as shown in picture 16.
- Feed the wiring through the larger hole on the main bracket and the larger hole on the mounting bracket (item 3 – TB0243 Part 2), as shown in pictures 17 & 18. *If using the OEM indicators, the indicator connectors and*

R&G

Unit 1, Shelley's Lane, East Worldham, Alton, Hampshire, GU34 3AQ

Tel: +44 (0)1420 89007 Fax: +44 (0)1420 87301 [www.rg-racing.com](http://www.rg-racing.com) Email: [info@rg-racing.com](mailto:info@rg-racing.com)



wiring off the sub-loom will need to be feed through the holes in a reverse direction, due to the length of wiring on the OEM indicators.

- Offer up the cover plate (item 11 – TB0243 Part 4) to the underside of the tail tidy assembly, as shown in picture 19. Fit the M6 x 16mm long Torx bolt (item 14) and one of the M6 lock washers (item 5) through the rearward hole on the cover plate, then through the hole in the main bracket and mounting plate, before fitting the remaining M6 lock washer (item 5) and M6 nyloc nut (item 4) to the exposed thread. Ensure the cover plate holes all align before tightening the nut and bolt, as shown in picture 20.
- Fit the self-adhesive foam (item 22) as shown in picture 22.
- Take the licence plate illuminator connector (item 24 – CON0014) and connect the bullet connectors to the LA0002 already fitted to the tail tidy assembly. Connect the black to blue and the yellow to red.
- If re-using the OEM indicators, the sub-loom will already be connected to the indicators. Connect the remaining licence plate light connector to the one on the loom, before connecting the 3-pin connector to the one on the bike.
- If using mini indicators, connect the licence plate light connector to the one on the sub-loom.
- Connect each indicator connector (item 23 – CON0015) to the connectors on the sub-loom and connect the bullet connectors to those on the indicators as follows.
- If fitting R&G Aero Indicators the yellow wire on the Aero Indicators connects with black wire on the connector and the black wire on the Aero Indicators connects with the blue wire on the connector. 1x set of RGR0001 resistors (available separately) are required to achieve the correct flash rate.
- If fitting R&G Mini Indicators with LED's, the black/white wire on the Mini Indicators connects with the black wire on the connector and the black wire on the Mini Indicators connects with the blue wire on the connector. 1x set of RGR0001 resistors (available separately) are required to achieve the correct flash rate.
- Mini indicators with bulbs do not work.
- Connect the 3-pin connector on the sub-loom to the one on the bike.
- It is advised to check for the correct operation of all lights at this stage.
- Use cable ties to neatly bundle the wiring before feeding up into the tail unit, as shown in pictures 23 & 24.
- Fit the tail tidy assembly up to the underside of the tail unit, by feeding the mounting bracket into the rubber mount and letting the assembly rotate downwards into position, as shown in picture 25.
- Fit the two M5 x 20mm long Torx bolts (item 13) with the two M5 lock washers (item 12) through the mounting holes on the underside of the tail tidy and into the threaded bosses of the subframe, as shown in picture 26.
- Depending on the size of the licence plate, the indicator mounts can be adjusted to be wide or narrow by loosening the bolts, as shown in pictures 27 & 28.
- Re-fit the licence plate (it may require drilling).
- Depending on local laws, attach enclosed reflector in an appropriate location.
- Test the licence plate illuminator and all lights before riding.

ISSUE 1 07/03/2018 (AR)

**Digital copies of these instructions are available to download from [www.rg-racing.com](http://www.rg-racing.com)**

#### CONSUMER NOTICE

The catalogue description and any exhibition of samples are only broad indications of the Products and R&G may make design changes which do not diminish their performance or visual appeal and supplying them in such state shall conform to the order. The Buyer acknowledges no representation or warranty (other than as to title) has been given or will apply to the Products other than those in R&G's order or confirmation and the Buyer confirms it has chosen the Products as being of merchantable quality and suitable for its particular purposes. Where R&G fits the Products or undertakes other services it shall exercise reasonable skill and care and rectify any fault free of charge unless the workmanship has been disturbed. The Buyer is responsible for ensuring that the warranty on the motorcycle is not affected by the fitting of the Products. On return of any defective Products R&G shall at its option either supply a replacement or refund the purchase money but shall not be liable if the Products have been modified or used or maintained otherwise than in accordance with R&G's or manufacturer's instructions and good engineering practice or if the defect arises from accident or neglect. Other than identified above and subject to R&G not limiting its liability for causing death and personal injury, it shall not be liable for indirect or consequential loss and otherwise its liability shall be limited to the amounts paid by the Buyer for the Products or the fitting or service concerned. These terms do not affect the Buyer's statutory rights.

R&G

Unit 1, Shelley's Lane, East Worldham, Alton, Hampshire, GU34 3AQ

Tel: +44 (0)1420 89007 Fax: +44 (0)1420 87301 [www.rg-racing.com](http://www.rg-racing.com) Email: [info@rg-racing.com](mailto:info@rg-racing.com)