



## FITTING INSTRUCTIONS FOR LP0278BK LICENCE PLATE BRACKET INDIAN FTR1200 + FTR1200S 2019



**THIS KIT CONTAINS THE ITEMS PICTURED AND LABELLED OVER PAGE.**

SOME PARTS MAY BE SHOWN FOR CLARITY OF INSTRUCTIONS ONLY.

DO NOT PROCEED UNTIL YOU ARE SURE ALL PARTS ARE PRESENT.

**PLEASE READ ALL INSTRUCTIONS BEFORE PROCEEDING.**

**IF IN ANY DOUBT WHEN FITTING OUR PRODUCTS, CONSULT ONE OF OUR DEALERS  
OR HAVE FITTED BY A QUALIFIED TECHNICIAN.**

PLEASE NOTE THAT THE WAY THE KIT IS PACKED DOES NOT NECESSARILY REPRESENT THE WAY OF  
MOUNTING TO THE BIKE.

IN THE EVENT OF RUBBER WASHERS BEING USED TO HOLD COMPONENTS ONTO BOLTS,  
THESE RUBBER WASHERS CAN BE THROWN AWAY.

**DIGITAL COPIES OF THESE INSTRUCTIONS ARE AVAILABLE FROM:**

[WWW.RG-RACING.COM](http://WWW.RG-RACING.COM)

R&G Racing

Unit 1, Shelly's Lane, East Worldham, Alton, Hampshire GU34 3AQ.

Tel: +44 (0)1420 89007 Fax +44 (0)1420 87301 [www.rg-racing.com](http://www.rg-racing.com) Email: [info@rg-racing.com](mailto:info@rg-racing.com)



<b><u>TOOLS REQUIRED</u></b>	<b><u>GENERAL TORQUE SETTINGS</u></b>
<ul style="list-style-type: none"> <li>• Set of metric Allen keys to include 4, 5 &amp; 6mm</li> <li>• Socket set to include 10mm</li> <li>• T30 + T40 Torx tools</li> <li>• Small flat bladed screwdriver</li> <li>• Small amount of adhesive</li> <li>• Loctite or similar</li> <li>• 8mm spanner</li> </ul>	M4 BOLT = 8Nm M5 BOLT = 12Nm M6 BOLT = 15Nm M8 BOLT = 20Nm M10 BOLT = 40Nm M12 BOLT = 40Nm

### **LEGEND**

<b>ITEM No.</b>	<b>DESCRIPTION</b>	<b>QTY</b>
ITEM 1	TB0278 PART 1 LICENCE PLATE MOUNTING BRACKET	1
ITEM 2	TB0278 PART 2 LICENCE PLATE LIGHT MOUNTING BRACKET	1
ITEM 3	TB0276 PART 3 LHS INDICATOR MOUNT BRACKET	1
ITEM 4	TB0276 PART 4 RHS INDICATOR MOUNT BRACKET	1
ITEM 5	S1088 MOUNTING SPACER	1
ITEM 6	S0693 MOUNTING SPACER	2
ITEM 7	LA0002 No PLATE LIGHT ASSEMBLY	1
ITEM 8	CON14 RHS MINI INDICATOR CONNECTOR	1
ITEM 9	CON26 LHS MINI INDICATOR CONNECTOR	1
ITEM 10	CON0004 NUMBER PLATE CONNECTOR PAIR	2
ITEM 11	CON0030 BULLET CONNECTOR EXTENSION	1
ITEM 12	M8 x 1.25 x 10MM BUTTON HEAD BOLTS - INDICATOR BRACKET BOLTS	4
ITEM 13	M8 x 1.25 x 25MM BUTTON HEAD BOLTS— TAIL TIDY BRACKET BOLTS	4
ITEM 14	M6 x 1.00 x 12MM BUTTON HEAD BOLTS—INDICATOR FASTENING BOLTS	2
ITEM 15	M6 x 12mm O/D WASHER	2
ITEM 16	M8 x 14MM O/D WASHER - INDICATOR BRACKET BOLTS	12
ITEM 17	M5 x 15MM BUTTON HEAD BOLTS - LIGHT MOUNTING PLATE	2
ITEM 18	M5 X 10MM WASHER LIGHT BRACKET WASHERS	4
ITEM 19	M5 NYLOC NUTS	2
ITEM 20	150mm LENGTH OF HEAT SHRINK	3
ITEM 21	CT100BK (2.5mm CABLE TIES x 100mm LONG)	14
ITEM 22	IWC0002 MINI INDICATOR WIRING COVERS	2
ITEM 23	REFLECTOR	1

R&G Racing

Unit 1, Shelly's Lane, East Worldham, Alton, Hampshire GU34 3AQ.

Tel: +44 (0)1420 89007 Fax +44 (0)1420 87301 [www.rg-racing.com](http://www.rg-racing.com) Email: [info@rg-racing.com](mailto:info@rg-racing.com)

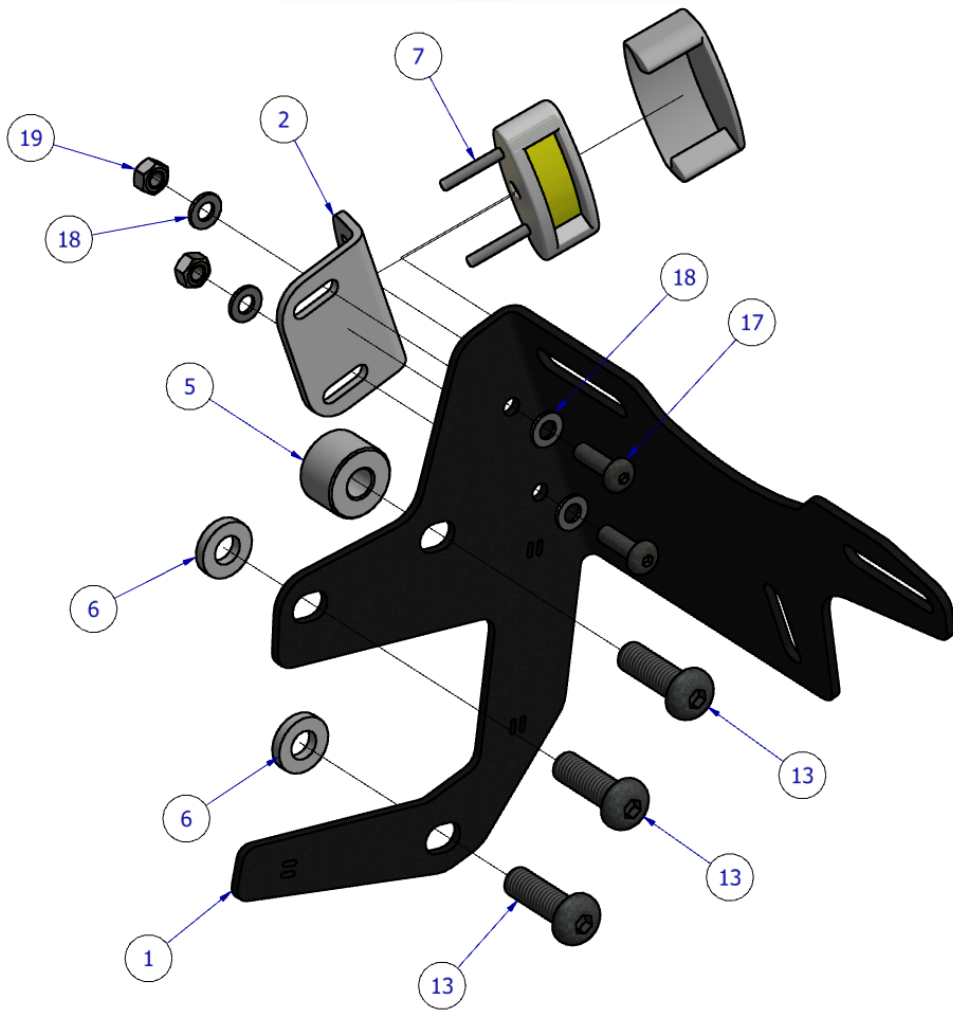

**ASSEMBLY DIAGRAM 1**

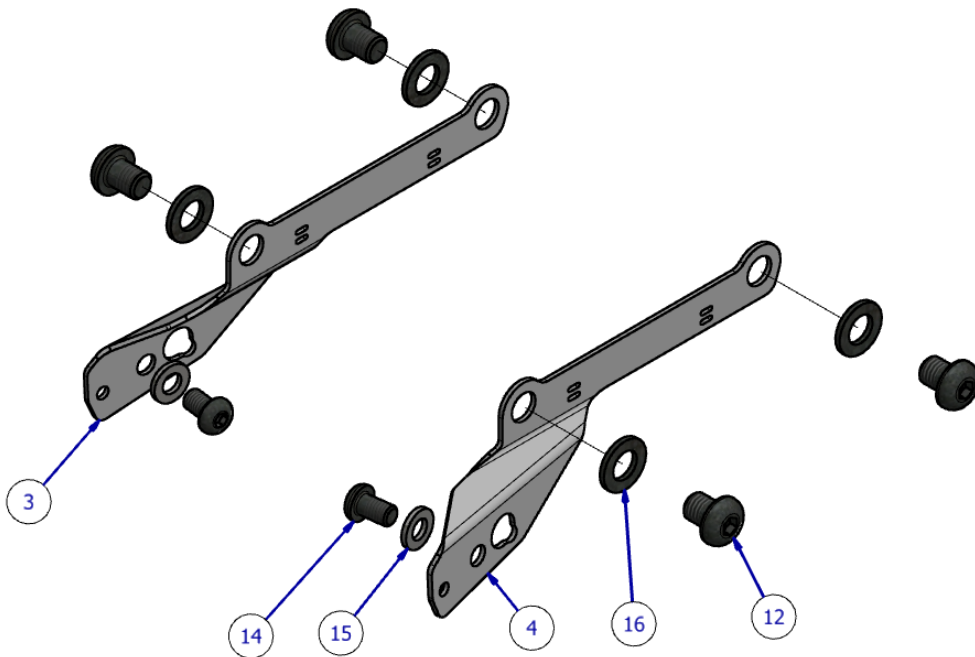

**ASSEMBLY DIAGRAM 2**

R&G Racing

Unit 1, Shelly's Lane, East Worldham, Alton, Hampshire GU34 3AQ.

Tel: +44 (0)1420 89007 Fax +44 (0)1420 87301 [www.rg-racing.com](http://www.rg-racing.com) Email: [info@rg-racing.com](mailto:info@rg-racing.com)

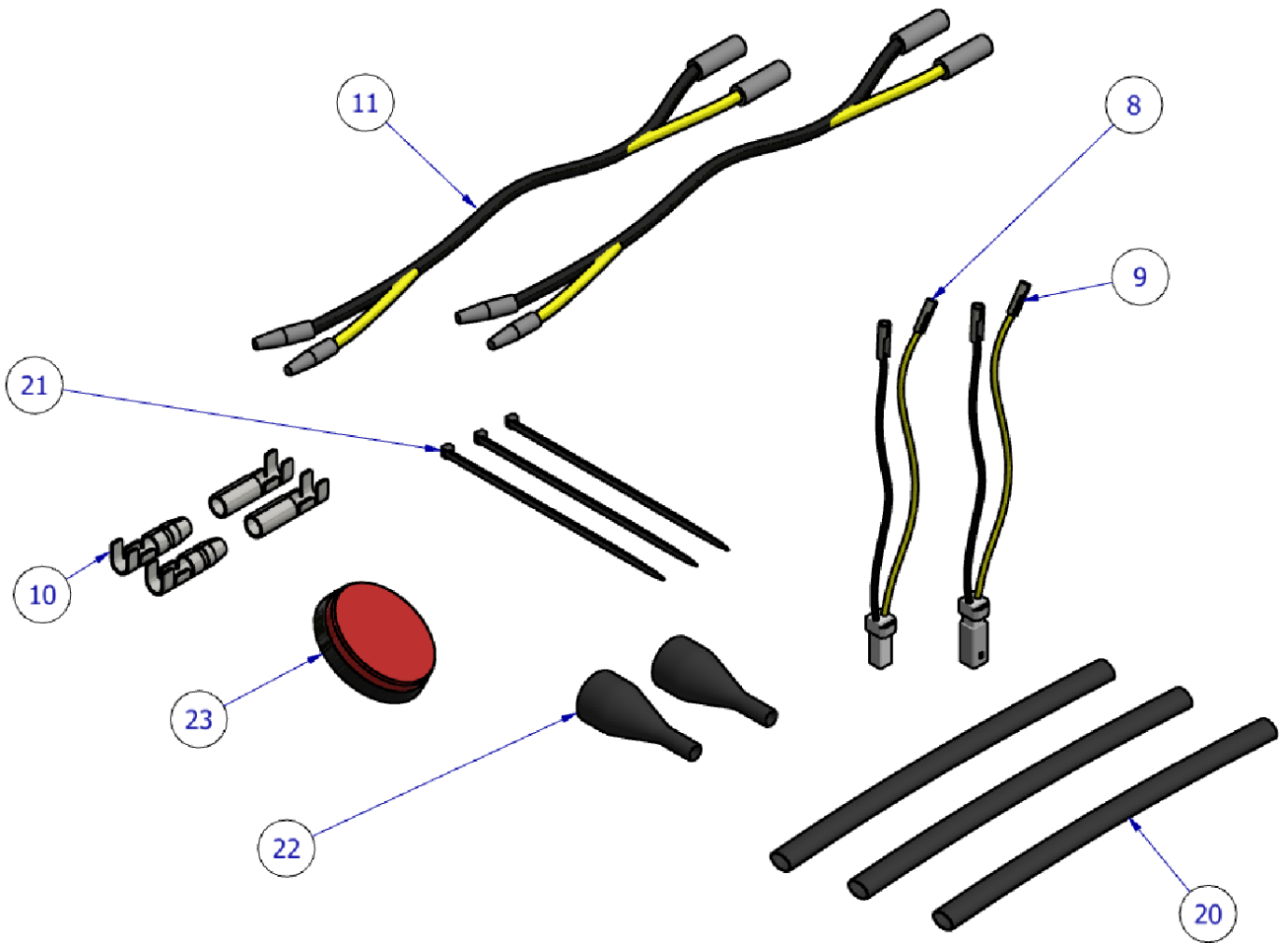

**ASSEMBLY DIAGRAM 3**



Picture 1

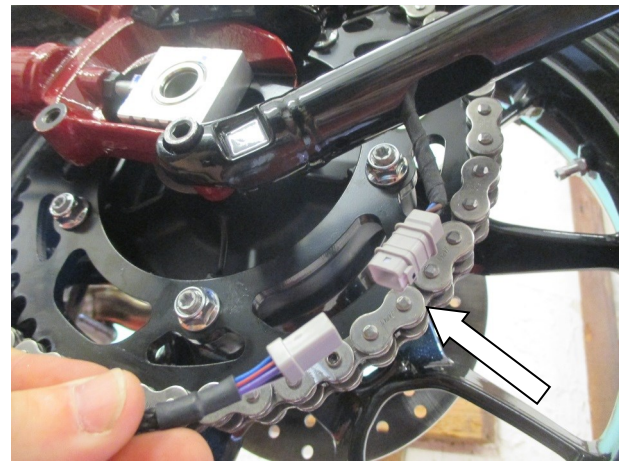

Picture 2

R&G Racing

Unit 1, Shelly's Lane, East Worldham, Alton, Hampshire GU34 3AQ.

Tel: +44 (0)1420 89007 Fax +44 (0)1420 87301 [www.rg-racing.com](http://www.rg-racing.com) Email: [info@rg-racing.com](mailto:info@rg-racing.com)



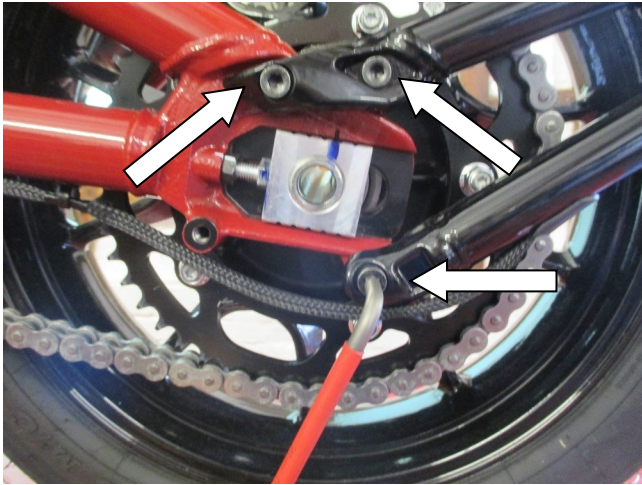

Picture 3

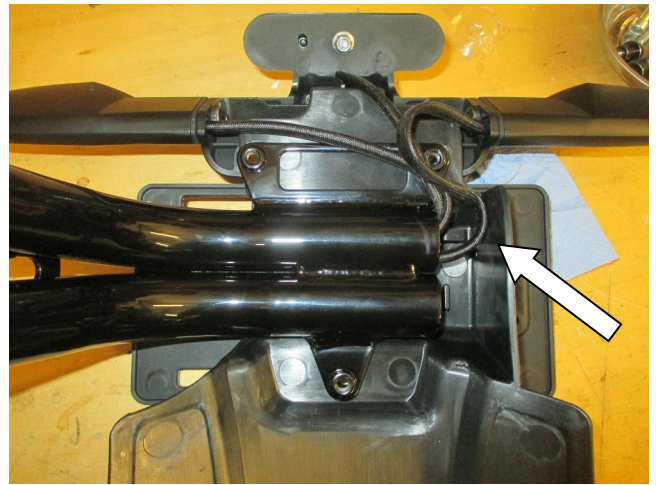

Picture 4



Picture 5

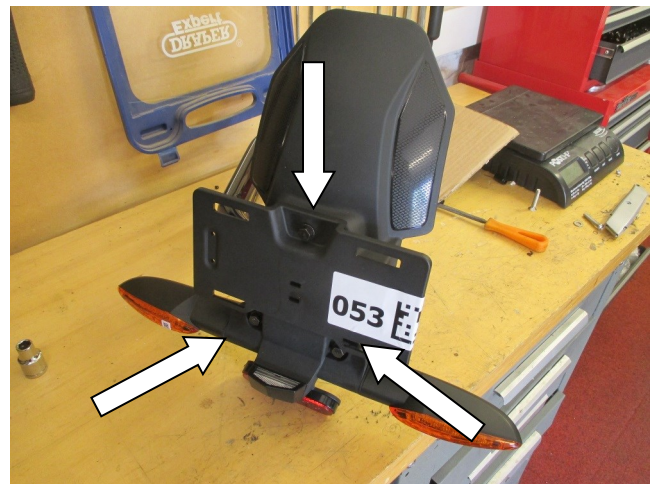

Picture 6



Picture 7



Picture 8

R&G Racing

Unit 1, Shelly's Lane, East Worldham, Alton, Hampshire GU34 3AQ.

Tel: +44 (0)1420 89007 Fax +44 (0)1420 87301 [www.rg-racing.com](http://www.rg-racing.com) Email: [info@rg-racing.com](mailto:info@rg-racing.com)





Picture 9



Picture 10



Picture 11



Picture 12

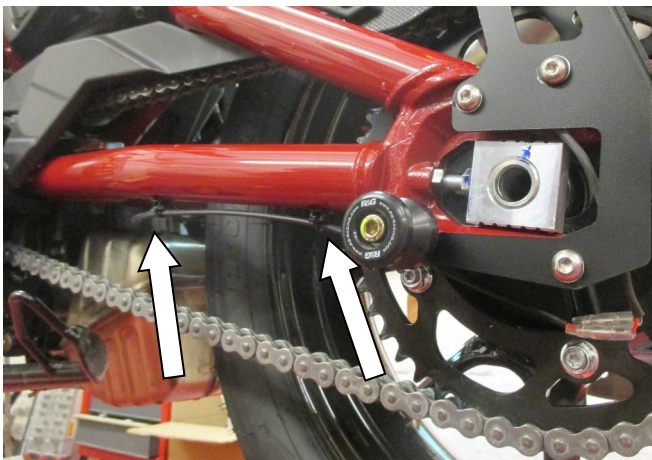

Picture 13

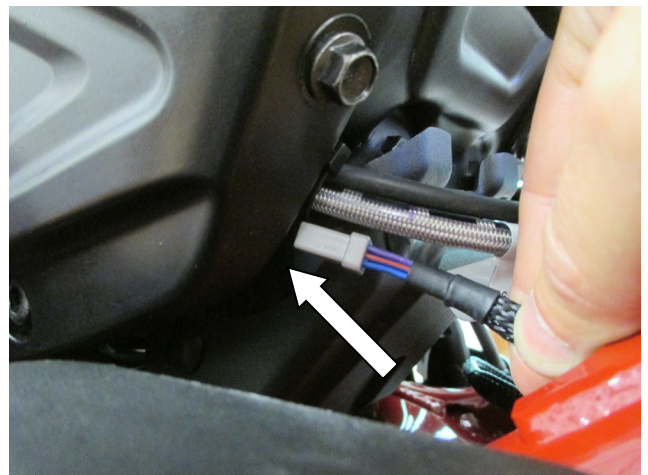

Picture 14

R&G Racing

Unit 1, Shelly's Lane, East Worldham, Alton, Hampshire GU34 3AQ.

Tel: +44 (0)1420 89007 Fax +44 (0)1420 87301 [www.rg-racing.com](http://www.rg-racing.com) Email: [info@rg-racing.com](mailto:info@rg-racing.com)



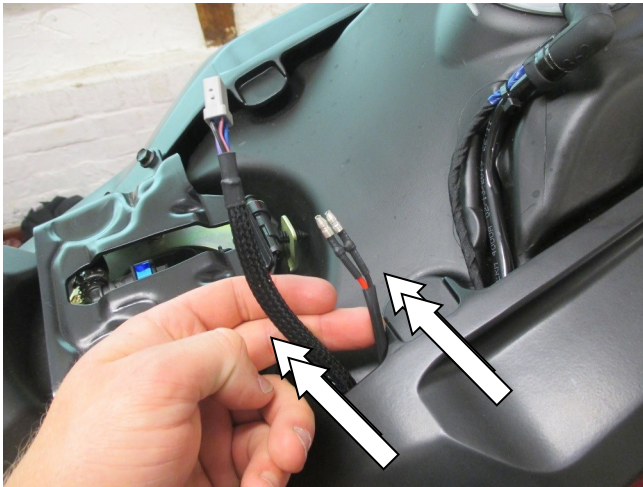

Picture 15



Picture 16



Picture 17



Picture 18



Picture 19



Picture 20

R&G Racing

Unit 1, Shelly's Lane, East Worldham, Alton, Hampshire GU34 3AQ.

Tel: +44 (0)1420 89007 Fax +44 (0)1420 87301 [www.rg-racing.com](http://www.rg-racing.com) Email: [info@rg-racing.com](mailto:info@rg-racing.com)



## **FITTING INSTRUCTIONS**

**Please note before beginning that you will need to modify your OEM licence plate light and reroute the indicator wiring to the tail of the bike under the seat unit. Please read the instructions in full before fitting.**

### **OEM Tail Unit Removal:**

- On the left side of the motorcycle swingarm, near the tube OEM licence plate mounting bracket, remove the rubber bung from the underside of the tube and as shown in **Picture 1**.
- Disconnect the grey connector block using a small flat bladed screwdriver as shown in **Picture 2**.
- Remove the 3 allen bolts shown in **Picture 3** using a 6mm allen key while supporting the frame structure to make sure it does not drop. Remove the tail unit completely from the bike.
- With the tail unit removed, you will need to remove the sub-loom connecting the indicators and licence plate light from the lower frame tube to re-use for the indicators.
- At the rear of the tail unit, you will find 3 connectors as shown in **Picture 4**. disconnect these using a small flat bladed screwdriver as shown in **Picture 5**.
- Remove the sub loom from either end and put to one side for use later.

### **If using the OEM indicators**

- To relocate the indicators, these will need to be removed from the OEM tail unit. First remove the 3 hex bolts, arrowed in **Picture 6**, fastening the rear plate to the licence plate support frame using a 10mm socket.
- Making sure to note the side of each indicator once removed, using a T30 Torx tool to remove the fastening bolt on the inside of the indicator to release each indicator from the OEM plate as shown in **Picture 7**.
- Referring to Assembly Diagram 2 on page 3, for the left hand indicator, locate this into left hand indicator mount plate (item 3) and use the M6 x 12mm bolt (item 14) and M6 washer (item 15) to secure in place as shown in **Picture 8**.
- Repeat this for the RHS using the RHS indicator mount plate (item 4).
- Use 2 x cable ties supplied (item 21) per side through the small slots to tidy the indicator wires. Both indicator assemblies should resemble that shown in **Picture 9**.

R&G Racing

Unit 1, Shelly's Lane, East Worldham, Alton, Hampshire GU34 3AQ.

Tel: +44 (0)1420 89007 Fax +44 (0)1420 87301 [www.rg-racing.com](http://www.rg-racing.com) Email: [info@rg-racing.com](mailto:info@rg-racing.com)





### **If using R&G mini indicators**

- If using R&G mini indicators, remove the M8 nut from the indicator stem of either indicator and feed the wire through the larger hole in each indicator mount plate.
- Fasten the indicator using the nut removed to secure the indicator in place.
- Next slide one indicator wiring cover (item 22) over each pair of indicator bullet connectors to cover the fastening nut of the mini indicator.
- Now slide one length of heat shrink (item 20) over the bullet connectors and heat until the wires are neatly covered.
- Use 2 x cable ties (item 21) per side to neatly tie back the wires using the small slots in either indicator wing.
- Fit the corresponding R&G connectors to the bullet connectors to the wires. The LHS uses CON0026 (item 9) and the RHS uses CON0014 (item 8).

### **Indicator bracket attachment.**

- To attach the indicator brackets, you will need to remove the pillion grab handles from the motorcycle subframe. To do this use a T40 torx to remove the 2 x bolts per side arrowed in **Picture 10**. This will reveal 2 mounting points behind the removed grab rails.
- Using 2 x M8x12mm bolts (item 12) and 2 x M8 washers (item 16) to affix the indicator mounting assemblies to the corresponding side as shown in **Picture 11**.
- At this point the seat should be removed from the motorcycle by removing one allen head bolt using a 6mm allen key on each side as shown in **Picture 12** and then lifting from the rear of the seat to remove.

### **Tail tidy assembly**

To assemble the R&G tail tidy, refer to the assembly diagram 1 on page 3.

- First, take a small amount of superglue and affix the LA0002 (item 7) licence plate light shroud to the light. This will help redirect the light towards the licence plate when illuminated.
- Use one length of heat shrink (item 20) to cover the wires and heat until the wires are neatly encased.
- This assembly can now be affixed using the nuts provided with the LA0002 assembly to the TB0278 light bracket (item 2) as shown in assembly diagram 1. ensuring the wires pass through the central hole.
- Now use 2 x M5 button head bolts (item 17) and 2 x M5 washers (item 18) on the inside of the main bracket TB0278 (item 1) and fix the light bracket with 2 x M5 washers (item 18) and 2 x Nyloc nuts (item 19). Leave this loose for now as this can be adjusted using the mounting slots when the licence plate is fixed in place to best illuminate the plate.

R&G Racing

Unit 1, Shelly's Lane, East Worldham, Alton, Hampshire GU34 3AQ.

Tel: +44 (0)1420 89007 Fax +44 (0)1420 87301 [www.rg-racing.com](http://www.rg-racing.com) Email: [info@rg-racing.com](mailto:info@rg-racing.com)



- Use 3 of the M8 x 25mm button head bolts (item 13) to fix the tail tidy the swingarm of the motorcycle, ensuring to include the correct spacers (items 5 & 6) as shown in assembly diagram 1.
- If desired, use the remaining bolt in the empty threaded hole in the swingarm.
- Using electrical crimps, connect one MALE pair of CON0004 bullet connectors (item 10) to the open ends of CON0030 (item 11) wire extension and connect the female ends to the R&G licence plate illuminator.
- Route this wire roughly following the OEM wire towards the front of the motorcycle.
- With the tail tidy assembled, the OEM indicator and licence plate light wire must be re-routed to meet the indicators connectors under the seat.
- To reroute the OEM wire on the motorcycle, cut the cable ties on the lower frame member as arrowed in **Picture 13**. Replace the cable ties to secure the CON0030 wire in place of the original.
- Locate the rear light wiring near the underside of the tail unit, as shown in **Picture 14**, and re-route the both the grey connector and CON0030 wire extension along the same path of the tail light so that appears beneath the seat as shown in **Picture 15**.
- **Ensure that both wires are clear of any moving parts of the motorcycle.**
- To aid in routing the wiring, the central connecting plate between both sides of the subframe should be removed using a 10mm socket and ratchet as shown in **Pictures 16 & 17**.
- The sub loom removed from the OEM tail unit earlier will be used to connect the indicators and R&G licence plate illuminator. Re-connect the grey block routed up from the subframe as shown in **Picture 18** to the sub loom and follow this towards the rear of the motorcycle as shown in **Picture 19**.
- The plastic fuel tank can now be lifted slightly to allow a gap to pass the connectors down underneath the tank and connect with the indicators, ensuring the connectors correspond to the correct side. Route the sub loom in a sensible position ensuring no wires can become trapped between the fuel tank and subframe.

### **Licence Plate Illuminator Connection**

- As mentioned previously, the OEM licence plate connector needs to be removed and connected to the new CON0030 bullet extension. To do this, cut the OEM connector off leaving enough wire to fit 2 x female bullet connectors from the CON0004 bullets (item 10) as shown in **Picture 20** including plastic sleeves.
- Use this custom connector to bridge between the OEM sub-loom and CON0030 bullet connector extension ensuring to connect the black wires to one another.

R&G Racing

Unit 1, Shelly's Lane, East Worldham, Alton, Hampshire GU34 3AQ.

Tel: +44 (0)1420 89007 Fax +44 (0)1420 87301 [www.rg-racing.com](http://www.rg-racing.com) Email: [info@rg-racing.com](mailto:info@rg-racing.com)





- At this stage, test all the lights and indicators illuminate as they should. If illumination fails, swap the bullet connectors.
- Use 3 cable ties to secure the licence plate illuminator wire to the main bracket. Tidy the rest of the wiring ensuring no wires can become trapped or pulled by the movement of the swingarm or under the seat.
- check tightness of all bolts and refit the seat and pillion grab rails to the bike in the same manner they were removed.
- Mount the licence plate (it may require drilling) to the rear of the bracket in your chosen position, it is suggested to mount the plate as high as possible to give extra ground clearance.
- Slide the licence plate light bracket into the position that best illuminates the licence plate and tighten the allen head bolts against the nyloc nuts.

**PLEASE NOTE: ONLY SMALL LICENCE PLATES ARE RECOMMENDED TO BE FITTED TO THE TAIL TIDY AS STANDARD PLATES COULD CAUSE GROUND CLEARANCE ISSUES AT MORE EXTREME LEAN ANGLES. PLEASE CHECK FOR THIS EVENTUALITY AND TAKE INTO ACCOUNT THE COMPRESSION OF THE SUSPENSION OVER LARGE BUMPS IN THE ROAD WHEN FITTING THE PLATE. FAILURE TO CHECK THIS COULD RESULT IN SERIOUS INJURY.**

- Depending on local laws, attach enclosed reflector (item 23) in an appropriate location.
- Retest the licence plate illuminator and all lights before riding and check tightness of all bolts regularly.

ISSUE 2 23/10/19 (DM)

#### CONSUMER NOTICE

The catalogue description and any exhibition of samples are only broad indications of the Products and R&G may make design changes which do not diminish their performance or visual appeal and supplying them in such state shall conform to the order. The Buyer acknowledges no representation or warranty (other than as to title) has been given or will apply to the Products other than those in R&G's order or confirmation and the Buyer confirms it has chosen the Products as being of merchantable quality and suitable for its particular purposes. Where R&G fits the Products or undertakes other services it shall exercise reasonable skill and care and rectify any fault free of charge unless the workmanship has been disturbed. The Buyer is responsible for ensuring that the warranty on the motorcycle is not affected by the fitting of the Products. On return of any defective Products R&G shall at its option either supply a replacement or refund the purchase money but shall not be liable if the Products have been modified or used or maintained otherwise than in accordance with R&G's or manufacturer's instructions and good engineering practice or if the defect arises from accident or neglect. Other than identified above and subject to R&G not limiting its liability for causing death and personal injury, it shall not be liable for indirect or consequential loss and otherwise its liability shall be limited to the amounts paid by the Buyer for the Products or the fitting or service concerned. These terms do not affect the Buyer's statutory rights.

#### R&G RETURNS POLICY (NON-FAULTY GOODS)

Returns must be pre-authorized (if not pre-authorized the return will be rejected). Goods may only be returned direct to us if they were purchased direct from us (customer must prove if necessary). Otherwise to be returned to original vendor. Goods must be in re-sellable condition, in the opinion of R&G. All returns are subject to a 25% restocking and handling fee (25% of the gross value exc. P&P – at the prevailing price at time of purchase). The customer must pay any and all carriage charges. No returns of discontinued products, unless within 14 days of purchase. This policy does not affect your statutory rights and does not refer to faulty goods.

R&G Racing

Unit 1, Shelly's Lane, East Worldham, Alton, Hampshire GU34 3AQ.

Tel: +44 (0)1420 89007 Fax +44 (0)1420 87301 [www.rg-racing.com](http://www.rg-racing.com) Email: [info@rg-racing.com](mailto:info@rg-racing.com)