



FITTING INSTRUCTIONS FOR LP0349



THIS KIT CONTAINS THE ITEMS PICTURED AND LABELLED OVER PAGE.

SOME PARTS MAY BE SHOWN FOR CLARITY OF INSTRUCTIONS ONLY.

DO NOT PROCEED UNTIL YOU ARE SURE ALL PARTS ARE PRESENT.

PLEASE READ ALL INSTRUCTIONS BEFORE PROCEEDING.

**IF IN ANY DOUBT WHEN FITTING OUR PRODUCTS, CONSULT ONE OF OUR DEALERS
OR HAVE FITTED BY A QUALIFIED TECHNICIAN.**

PLEASE NOTE THAT THE WAY THE KIT IS PACKED DOES NOT NECESSARILY REPRESENT THE WAY OF
MOUNTING TO THE BIKE.

IN THE EVENT OF RUBBER WASHERS BEING USED TO HOLD COMPONENTS ONTO BOLTS,
THESE RUBBER WASHERS CAN BE THROWN AWAY.

R&G

Unit 1, Shelley's Lane, East Worldham, Alton, Hampshire, GU34 3AQ
Tel: +44 (0)1420 89007 Fax: +44 (0)1420 87301 www.rg-racing.com Email: info@rg-racing.com



DIGITAL COPIES OF THESE INSTRUCTIONS ARE AVAILABLE FROM:

WWW.RG-RACING.COM

<u>TOOLS REQUIRED</u>	<u>GENERAL TORQUE SETTINGS</u>
Set of metric Allen keys to include 4 & 5mm A/F size	M4 BOLT = 8Nm
10mm spanners or socket and wrench	M5 BOLT = 12Nm
14mm spanner	M6 BOLT = 15Nm
Phillips screwdriver	M8 BOLT = 20Nm
Cable cutters	M10 BOLT = 40Nm
Small amount of adhesive	M12 BOLT = 40Nm

LEGEND

ITEM NO.	DESCRIPTION	QTY
ITEM 1	SPACERS (S1025=8.5mm LONG)	4
ITEM 2	COVER PLATE (TB0225 PART 2)	1
ITEM 3	LICENCE PLATE BRACKET (TB0349)	1
ITEM 4	SMALL RUBBER GROMMETS (RB50-20-00FG)	2
ITEM 5	LA0002 LICENCE PLATE ILLUMINATOR	1
ITEM 6	LICENCE PLATE ILLUMINATOR SHROUD	1
ITEM 7	LARGE RUBBER GROMMET (RB0002)	1
ITEM 8	M6 WASHERS	4
ITEM 9	M6 x 28mm LONG BUTTON HEAD BOLTS	4
ITEM 10	LICENCE PLATE ILLUMINATOR CONNECTORS	1
ITEM 11	150mm LENGTH OF HEATSHRINK	1
ITEM 12	2.5mm CABLE TIES	3
ITEM 13	SELF-ADHESIVE CABLE CLIPS	3
ITEM 14	REFLECTOR	1

R&G

Unit 1, Shelley's Lane, East Worldham, Alton, Hampshire, GU34 3AQ

Tel: +44 (0)1420 89007 Fax: +44 (0)1420 87301 www.rg-racing.com Email: info@rg-racing.com

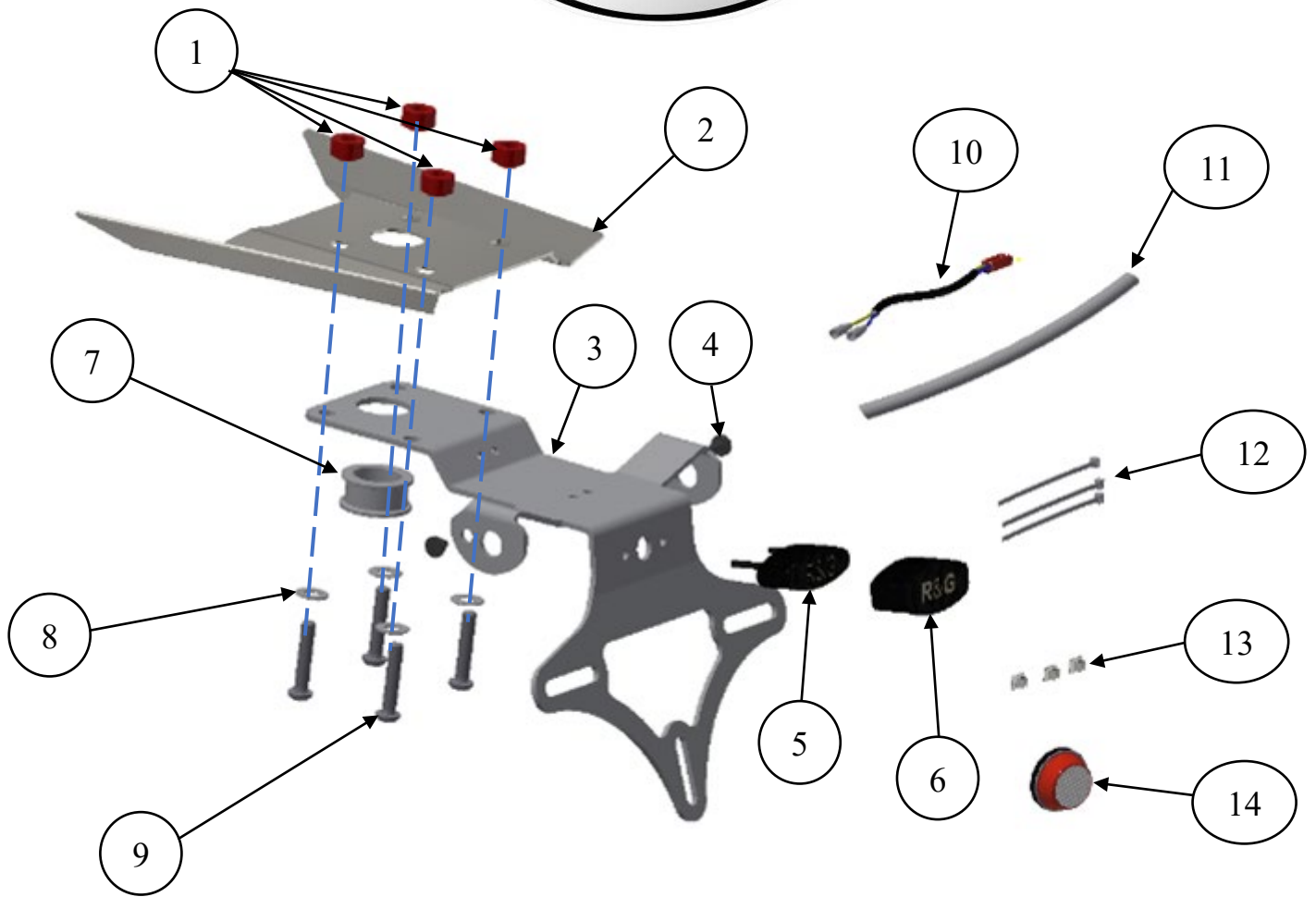

Assembly Diagram 1



PICTURE 1

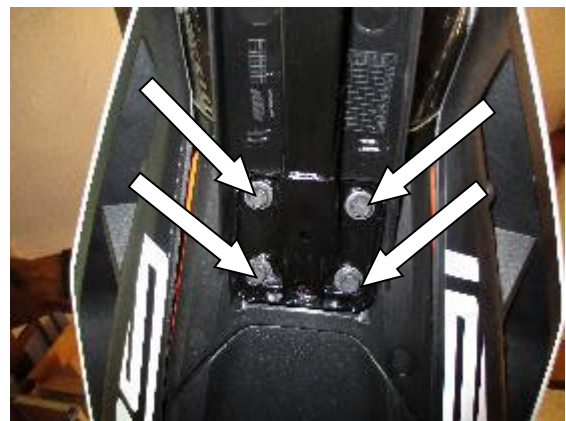

PICTURE 2

R&G

Unit 1, Shelley's Lane, East Worldham, Alton, Hampshire, GU34 3AQ

Tel: +44 (0)1420 89007 Fax: +44 (0)1420 87301 www.rg-racing.com Email: info@rg-racing.com

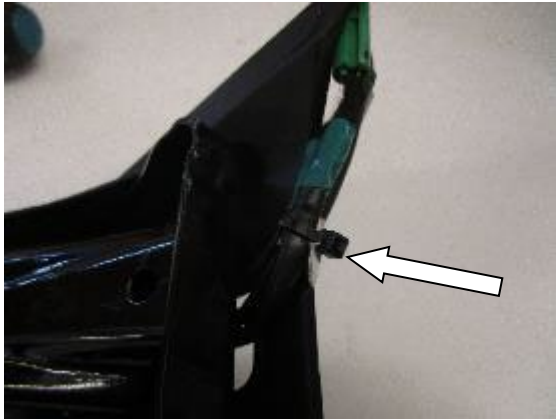

PICTURE 3

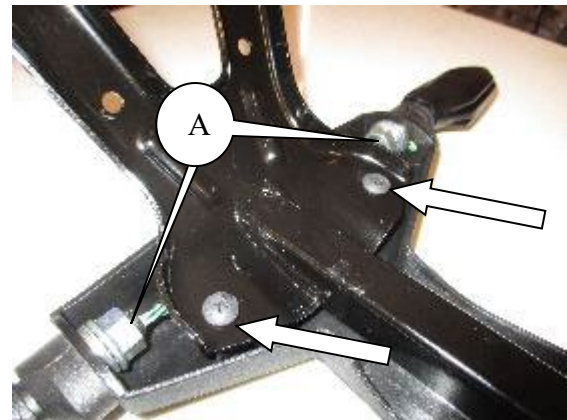

PICTURE 4

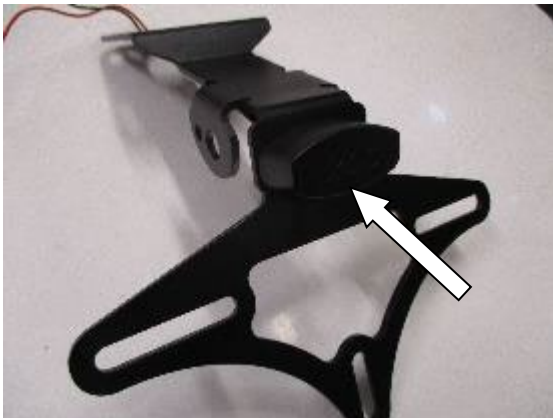

PICTURE 5



PICTURE 6



PICTURE 7



PICTURE 8



PICTURE 9



PICTURE 10

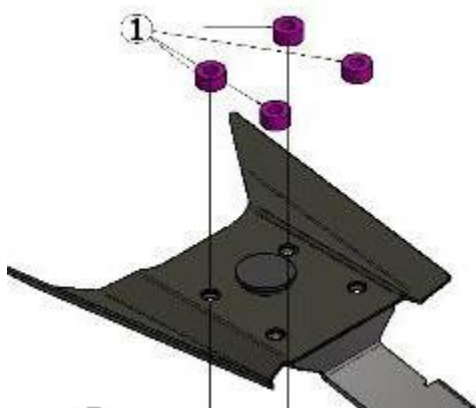

PICTURE 11

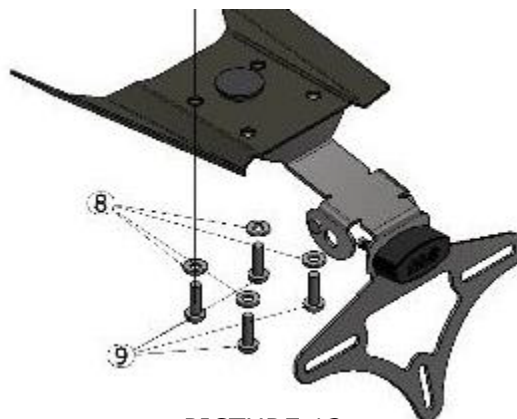

PICTURE 12

FITTING INSTRUCTIONS

- To fit R&G tail tidy, remove the seat using the key and disconnect the licence plate illuminator and indicator connectors in the positions that are arrowed in **Picture 1**.
- Remove the four bolts that mount the OEM licence plate bracket to the underside of the subframe, as shown in **Picture 2** and gently remove from the bike, feeding the wiring out in the process.
- On the OEM licence plate bracket, cut the cable tie that ties all the wires together as shown in **Picture 3**.
- Remove the two screws arrowed in **Picture 4** using a Philips screwdriver. The OEM licence plate bracket can now be separated.
- Remove the two indicators by removing the nuts and washers labelled A in **Picture 4** using 14mm open ended spanner. The OEM indicator washers and nuts are to be re-used.
- From the kit, take the R&G licence plate bracket (**Item 3**) and fit R&G licence plate illuminator (**Item 5**) into the three in-line holes on the licence plate bracket and secure with the M3 washers & nuts provided (Arrowed in **Picture 5**). Apply a small amount of super glue around the top surface of the license plate illuminator (**Item 5**) and place the licence plate illuminator shroud (**Item 6**) over.
- Feed the licence plate illuminator wires through one of the heat-shrink tube (**Item 11**) provided and using a suitable heat resource, shrink the tube to protect the wires.

R&G

Unit 1, Shelley's Lane, East Worldham, Alton, Hampshire, GU34 3AQ

Tel: +44 (0)1420 89007 Fax: +44 (0)1420 87301 www.rg-racing.com Email: info@rg-racing.com



- If using OEM indicators, fit both indicators onto indicator mount on the licence plate bracket as shown in **Picture 6** and secure using OEM washer and nuts removed earlier.
- From the kit, take the three cable clips (**Item 13**) and attach them in-line onto the underside of the licence plate bracket as shown in **Picture 7**.
- From the kit take the cover plate (**Item 2**) and Rubber bung (**Item 7**), Place the Licence plate bracket (**Item 3**) assembly onto the cover plate (**Item 2**), align all the mounting holes as shown in **Picture 8**. Insert the Rubber bung (**Item 7**) through the large centre holes on both licence plate bracket and the cover plate. The rubber bung will hold the two plates together.
- Feed all the wires through the Rubber bung (**Item 7**) fitted earlier (as shown in **Picture 9**) and clip-in all the wires to the cable clips (**Item 13**) fitted earlier on the underside of the licence plate bracket as shown in **Picture 10**.
- From the kit take the four spacers (**Item 1**) provided. Place the spacers on top of the four mounting points on the licence plate bracket assembly with the counter-bore sits against the cover plate as shown in **Picture 11**.
- Offer the whole assembly towards the sub-frame of the motorcycle and secure using the four button head bolts (**Item 9**) and washers (**Item 8**) as shown in **Picture 12**. Tighten the bolts to an appropriate torque setting.
- Please ensure the assembly accuracy of the fitted components are the same as the diagram shown on **Page 1**.
- Connect the licence plate & indicator connectors to the main loom as original.
- Tidy all the wiring using cable ties provided.
- Check all the lights for correct operations.
- Fit a licence plate to new licence plate bracket (it may require re-drilling).
- **IMPORTANT: WHEN FITTING A LICENCE PLATE, IT MUST BE PLACED AS HIGH AS POSSIBLE ON THE LICENCE PLATE HANGER AND CHECKED FOR COLLISION WITH THE REAR WHEEL WHEN THE SUSPENSION IS AT FULL COMPRESSION, THERE IS A SMALL CHANCE OF THE LICENCE PLATE HITTING THE BACK WHEEL UNDER HEAVY LOAD AND OVER LARGE BUMPS IN THE ROAD. IT IS YOUR RESPONSIBILITY TO CHECK FOR THIS POSSIBILITY AND TAKE AVOIDING ACTION. FAILURE TO CHECK THIS COULD RESULT IN SERIOUS INJURY.**
- Refit the seat.
- Depending on local laws, attach enclosed red reflector (**Item 14**) in an appropriate location.
- **Please test the rear light and licence plate illuminator before riding.**

See more R&G products for your Motorcycle in the link below:

[R&G Racing | All Products for KTM - 200 Duke \(rg-racing.com\)](http://www.rg-racing.com)

ISSUE 1 26/10/2022 (MH)

CONSUMER NOTICE

The catalogue description and any exhibition of samples are only broad indications of the Products and R&G may make design changes which do not diminish their performance or visual appeal and supplying them in such state shall conform to the order. The Buyer acknowledges no representation or warranty (other than as to title) has been given or will apply to the Products other than those in R&G's order or confirmation and the Buyer confirms it has chosen the Products as being of merchantable quality and suitable for its particular purposes. Where R&G fits the Products or undertakes other services it shall exercise reasonable skill and care and rectify any fault free of charge unless the workmanship has been disturbed. The Buyer is responsible for ensuring that the warranty on the motorcycle is not affected by the fitting of the Products. On return of any defective Products R&G shall at its option either supply a replacement or refund the purchase money but shall not be liable if the Products have been modified or used or maintained otherwise than in accordance with R&G's or manufacturer's instructions and good engineering practice or if the defect arises from accident or neglect. Other than identified above and subject to R&G not limiting its liability for causing death

R&G

Unit 1, Shelley's Lane, East Worldham, Alton, Hampshire, GU34 3AQ

Tel: +44 (0)1420 89007 Fax: +44 (0)1420 87301 www.rg-racing.com Email: info@rg-racing.com