



FITTING INSTRUCTIONS FOR BR0001
BACK REST FOR KAWASAKI VULCAN S '15-



THIS KIT CONTAINS THE ITEMS PICTURED AND LABELLED BELOW.
DO NOT PROCEED UNTIL YOU ARE SURE ALL PARTS ARE PRESENT.

Please note that the way the kit is packed does not necessarily represent the way of mounting to the bike.

THE PARTS SHOWN MAY BE REPRESENTATIVE ONLY (FOR CLARITY OF INSTRUCTIONS ONLY).

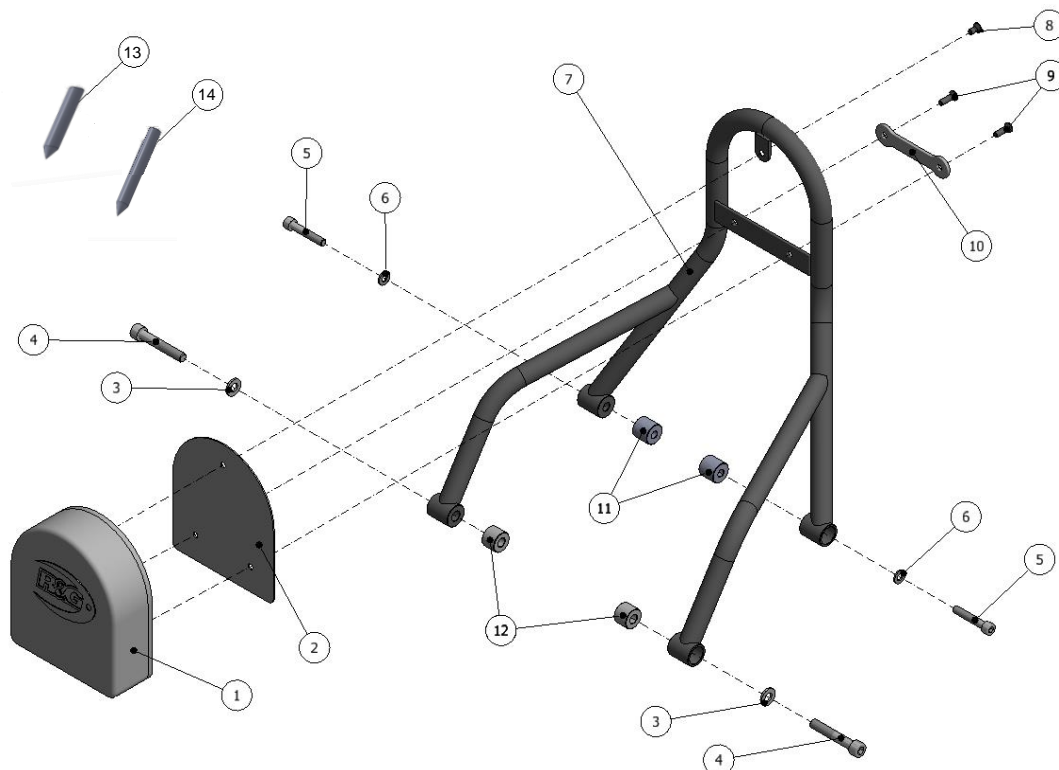



LEGEND

- ITEM 1 = BACK REST PAD (BRC0008) (x1).
- ITEM 2 = PAD BACKING PLATE (BRC0022) (x1).
- ITEM 3 = M10 WASHER (x2).
- ITEM 4 = M10 x 1.25 x 60mm LONG CAP HEAD BOLTS (x2).
- ITEM 5 = M8 x 45mm LONG CAP HEAD BOLTS (x2).
- ITEM 6 = M8 WASHER (x2).
- ITEM 7 = BACK REST FRAME (BR0001) (x1).
- ITEM 8 = M6 x 12mm LONG COUNTERSUNK BOLT (x1).
- ITEM 9 = M6 x 20mm LONG COUNTERSUNK BOLT (x2).
- ITEM 10 = BLANKING PLATE (BRC0021) (x1).
- ITEM 11 = SPACER (S0914 – 21mm LONG) (x2).
- ITEM 12 = SPACER (S0220 – 17.5mm LONG) (x2).
- ITEM 13 = MARKING TOOL (T0009 – M10 THREAD) (x1).
- ITEM 14 = MARKING TOOL (T0026 – M8 THREAD) (x1).
- ITEM 15 = BLANKING CAPS (8mm CAP HEAD BOLT) (x2). *NOT SHOWN*
- ITEM 16 = BLANKING CAPS (10mm CAP HEAD BOLT) (x2). *NOT SHOWN*

Please note that in cases where kits are packed with rubber washers holding the components onto the bolt – *the rubber washers should be thrown away!*

TOOLS REQUIRED

- 4, 6 & 8mm Allen key.
- 12 & 14mm socket & wrench.
- 25mm (1 inch) hole saw and drill.

GENERAL TORQUE SETTINGS

- M4 Bolt = 8 Nm
- M5 Bolt = 12 Nm
- M6 Bolt = 15 Nm
- M8 Bolt = 20 Nm
- M10 Bolt = 40 Nm



Picture 1

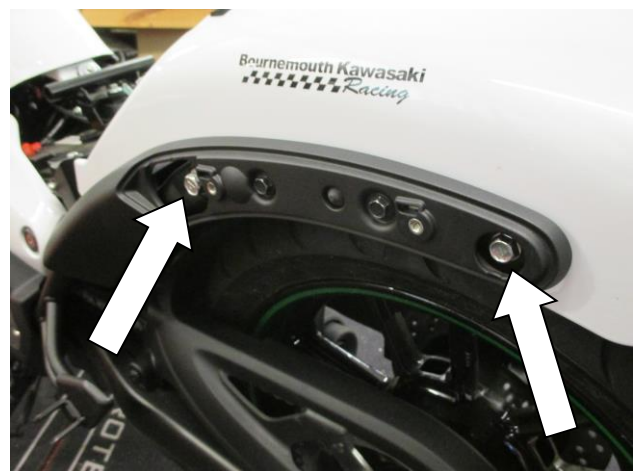

Picture 2



Picture 3



Picture 4



Picture 5



Picture 6



Picture 7



Picture 8



Picture 9



Picture 10



Picture 11



Picture 12



Picture 13



Picture 14



Picture 15



Picture 16

FITTING INSTRUCTIONS

- Remove the side cover by removing the two bolts that secure it in place, as arrowed in picture 1. Do this on both sides of the bike.
- Remove the two subframe mounting bolts, as arrowed in picture 2.
- Take the two marking tools supplied (item 13 & 14) and fit into the threaded holes that the two bolts were removed from, ensuring the point is facing outwards, as shown in picture 3. *Screw in by hand so that the end of the point slightly protrudes from the plastic surface.*
- Offer the plastic cover that was previously removed back into its original position. Press gently against the bike and this should leave a witness mark on the inside of the plastic from the two points on the marking tools, as shown in pictures 4 & 5. *If no mark is left, unscrew the marking tool slightly.*
- Take a 25mm (1 inch) hole saw (not provided) and a block of scrap wood and carefully drill a pilot hole through the plastic part, using the marks as a centre, as shown in picture 6. *At this stage, do not go all the way through – only create the pilot hole.*
- Offer the plastic cover back up to the bike and check to ensure the pilot hole position aligns with the point of the marking tool, as shown in picture 7.
- Once satisfied with the position, remove from the bike and drill all the way through both holes using the hole saw from the outside, as shown in picture 8.
- Offer the cover up to the bike and re-fit the panel using the two original bolts, as shown in picture 9.
- Repeat the above 7 steps to drill the holes in the plastic cover on the other side of the bike.
- Take the two shorter spacers (item 12 – S0220 – 17.5mm long) and offer into position in the cut-out hole of the plastic in the two forward mounts, as shown in picture 10. *In order to help hold them in place, we advise a small amount of adhesive tape or similar to the back face of the spacer.*
- Take the two remaining, longer spacers (item 13 – S0914 – 21mm long) and offer into position in the cut-out hole of the plastic in the two rearward mounts, as shown in picture 11. *In order to help hold them in place, we advise a small amount of adhesive tape or similar to the back face of the spacer.*
- Take the M8 washers (item 6) and offer over the exposed thread of the two M8 bolts (item 5).
- Offer the back rest frame (item 7 – BR0001) up to the bike and align the rear two mounts with the spacers previously positioned. Take both M8 bolts and washers and locate through both bosses and spacers and loosely tighten into the thread on the subframe, as shown in picture 12.
- Rotate the back rest frame around and align the front two bosses with the previously fitted spacers. Fit one M10 bolt (item 4) with one M10 washer (item 3) fitted to the bolt through the boss and spacer on both sides of the bike, and loosely tighten, as shown in pictures 13 & 14.



- With all four bolts loosely fitted, check that the holes in the plastic cover are clear of the spacer/bosses and tighten all bolts evenly. Torque all four bolts to the recommended torque values found on page 2.
- Take the shortest M6 countersunk bolt (item 8 – 12mm long) along with the pad backing plate (item 2) and back rest pad (item 1) and assemble as shown in the exploded diagram on page 1, with the bolt fitting through the upper countersunk hole on the back rest frame, before loosely tightening.
- Now take the blanking plate (item 10) and locate the two remaining longer M6 countersunk bolts (item 9 – 20mm long) through the two countersunk holes, then through the two mounting holes on the back rest frame and backing plate before loosely tightening into the threaded boss of the back rest pad, as shown in picture 15.
- Ensure the back rest pad is level and tighten all three bolts evenly.
- Ensure the back rest is correctly fitted and all bolts are tight before use.
- Fit the four blanking caps into the four bolts heads the mount the frame to the bike. The two larger, 10mm caps (item 16) fit in the front two cap head bolts and the two smaller, 8mm caps (item 17) fit in the remaining two rear cap head bolts.

ISSUE 1 28/01/2016 (AR)

Digital copies of these instructions are available to download from www.rg-racing.com

CONSUMER NOTICE

The catalogue description and any exhibition of samples are only broad indications of the Products and R&G may make design changes which do not diminish their performance or visual appeal and supplying them in such state shall conform to the order. The Buyer acknowledges no representation or warranty (other than as to title) has been given or will apply to the Products other than those in R&G's order or confirmation and the Buyer confirms it has chosen the Products as being of merchantable quality and suitable for its particular purposes. Where R&G fits the Products or undertakes other services it shall exercise reasonable skill and care and rectify any fault free of charge unless the workmanship has been disturbed. The Buyer is responsible for ensuring that the warranty on the motorcycle is not affected by the fitting of the Products. On return of any defective Products R&G shall at its option either supply a replacement or refund the purchase money but shall not be liable if the Products have been modified or used or maintained otherwise than in accordance with R&G's or manufacturer's instructions and good engineering practice or if the defect arises from accident or neglect. Other than identified above and subject to R&G not limiting its liability for causing death and personal injury, it shall not be liable for indirect or consequential loss and otherwise its liability shall be limited to the amounts paid by the Buyer for the Products or the fitting or service concerned. These terms do not affect the Buyer's statutory rights.

R&G RACING RETURNS POLICY (NON-FAULTY GOODS)

Returns must be pre-authorised (if not pre-authorised the return will be rejected). Goods may only be returned direct to us if they were purchased direct from us (customer must prove if necessary). Otherwise to be returned to original vendor. Goods must be in re-sellable condition, in the opinion of R&G Racing. All returns are subject to a 25% restocking and handling fee (25% of the gross value exc. P&P – at the prevailing price at time of purchase). The customer must pay any and all carriage charges. No returns of discontinued products, unless within 14 days of purchase. This policy does not affect your statutory rights and does not refer to faulty goods.