



FITTING INSTRUCTIONS FOR LP0295BK
LICENSE PLATE BRACKET
MV AGUSTA SUPERVELOCE 800 & BRUTALE 1000RR 2020-



THIS KIT CONTAINS THE ITEMS PICTURED AND LABELLED OVER PAGE.

SOME PARTS MAY BE SHOWN FOR CLARITY OF INSTRUCTIONS ONLY.

DO NOT PROCEED UNTIL YOU ARE SURE ALL PARTS ARE PRESENT.

PLEASE READ ALL INSTRUCTIONS BEFORE PROCEEDING.

**IF IN ANY DOUBT WHEN FITTING OUR PRODUCTS, CONSULT ONE OF OUR DEALERS
OR HAVE FITTED BY A QUALIFIED TECHNICIAN.**

PLEASE NOTE THAT THE WAY THE KIT IS PACKED DOES NOT NECESSARILY REPRESENT THE WAY OF
MOUNTING TO THE BIKE.

IN THE EVENT OF RUBBER WASHERS BEING USED TO HOLD COMPONENTS ONTO BOLTS,
THESE RUBBER WASHERS CAN BE THROWN AWAY.

DIGITAL COPIES OF THESE INSTRUCTIONS ARE AVAILABLE FROM:

WWW.RG-RACING.COM

R&G Racing
Unit 1, Shelley's Lane, East Worldham, Alton, Hampshire, GU34 3AQ
Tel: +44 (0)1420 89007 Fax: +44 (0)1420 87301 www.rg-racing.com Email: info@rg-racing.com



<u>TOOLS REQUIRED</u>	<u>GENERAL TORQUE SETTINGS</u>
<ul style="list-style-type: none"> • 2.5, 3, 4, 5, 6 & 10mm A/F ALLEN TOOLS • 6mm A/F SPANNER • CABLE CUTTERS 	M4 BOLT = 8Nm M5 BOLT = 12Nm M6 BOLT = 15Nm M8 BOLT = 20Nm M10 BOLT = 40Nm M12 BOLT = 40Nm

LEGEND

ITEM NO.	DESCRIPTION	QTY
ITEM 1	TB0295 PART 1 - LICENCE PLATE BRACKET	1
ITEM 2	TB0295 PART 2 - MOUNTING BRACKET	1
ITEM 3	M0627 SPANNING MOUNTING BLOCK	1
ITEM 4	M6 x 1.00 x 16.00mm COUNTERSUNK BOLT (MOUNTING BRACKET)	4
ITEM 5	M6 x 1.00 x 25.00mm COUNTERSUNK BOLT (LICENCE PLATE MOUNT TOP)	1
ITEM 6	M6 x 1.00 x 18.00mm COUNTERSUNK BOLT (LICENCE PLATE MOUNT MIDDLE)	1
ITEM 7	M6 x 1.00 x 10.00mm COUNTERSUNK BOLT (LICENCE PLATE MOUNT LOWER)	1
ITEM 8	M8 x 1.25 x 20.00mm COUNTERSUNK BOLT (SPANNING BLOCK MOUNT)	2
ITEM 9	LA0002 TAIL LIGHT ASSEMBLY (TO INCLUDE SHROUD)	1
ITEM 10	CON0014 LICENSE PLATE ILLUMINATOR WIRING ADAPTOR	1
ITEM 11	150mm LENGTH OF 666-896 (HEAT-SHRINK)	2
ITEM 12	CLIP 1 (SELF-ADHESIVE CABLE CLIPS)	4
ITEM 13	REFL 3 REFLECTOR	1
ITEM 14	CT100BK (2.5mm CABLE TIES x 100mm LONG)	2

R&G Racing

Unit 1, Shelley's Lane, East Worldham, Alton, Hampshire, GU34 3AQ

Tel: +44 (0)1420 89007 Fax: +44 (0)1420 87301 www.rg-racing.com Email: info@rg-racing.com



EXPLODED ASSEMBLY VIEW

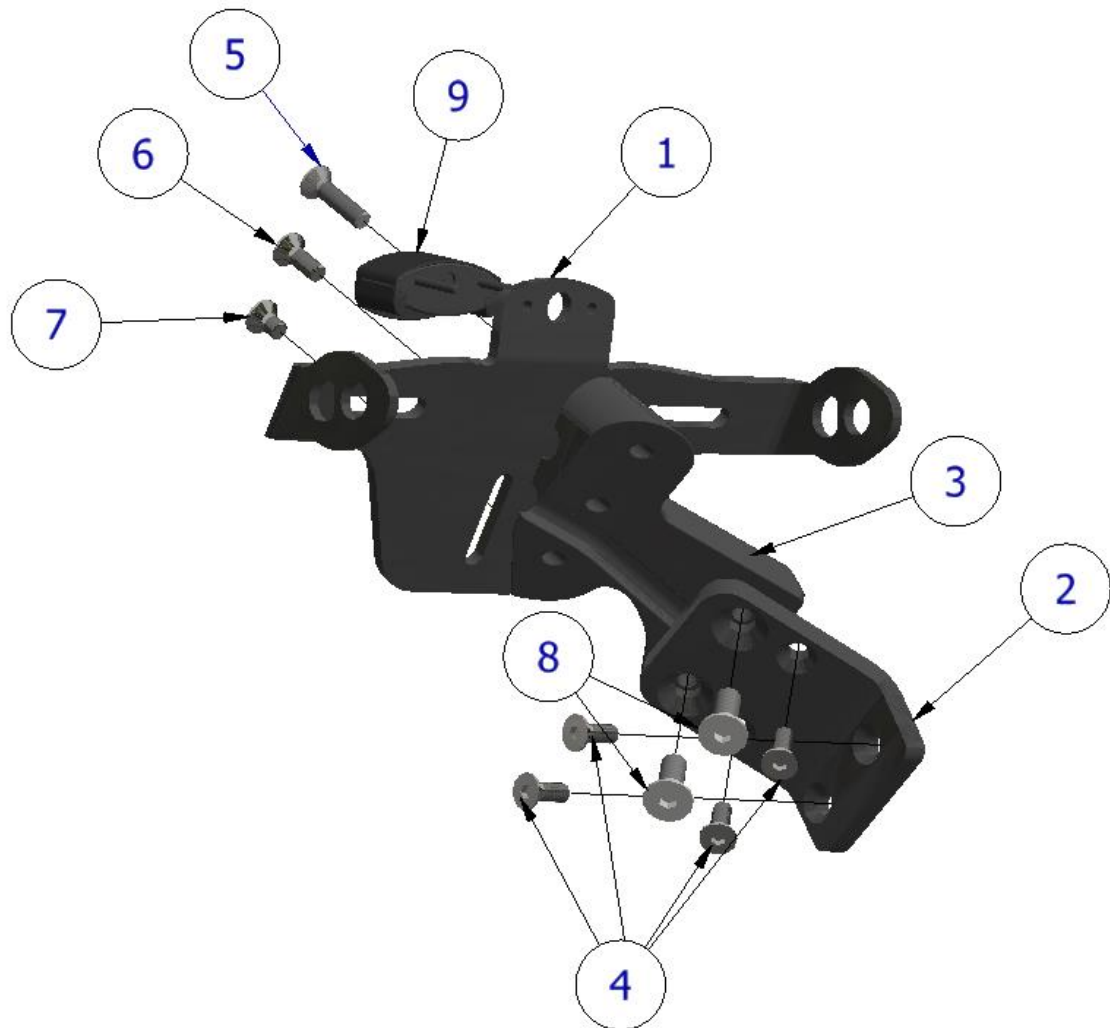

FITTING PICTURES

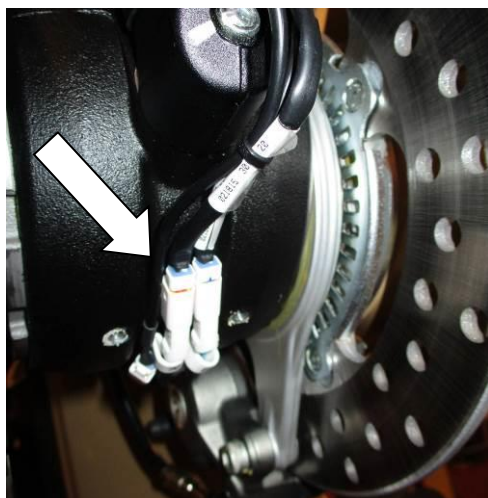

Picture 1

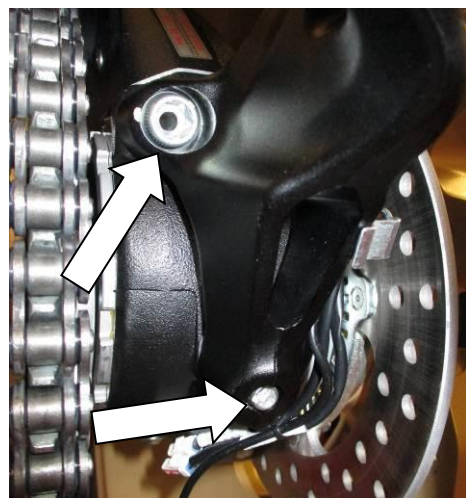

Picture 2

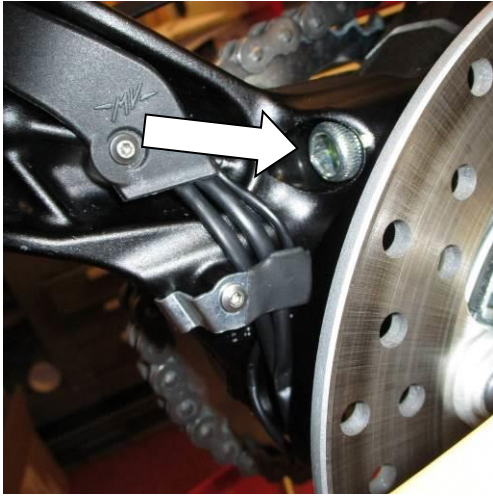

Picture 3



Picture 4



Picture 5



Picture 6

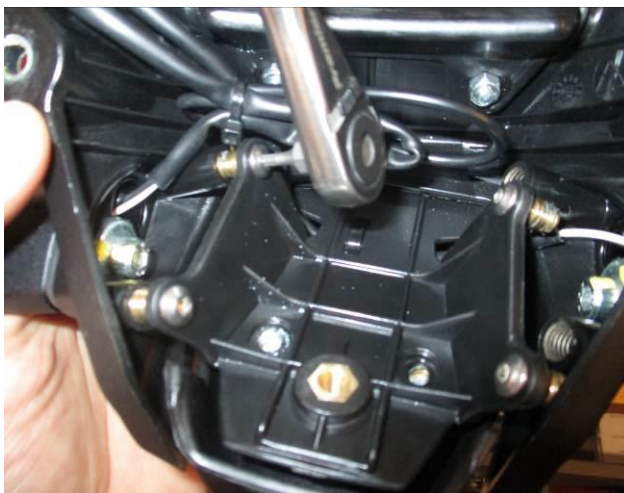

Picture 7



Picture 8



Picture 9

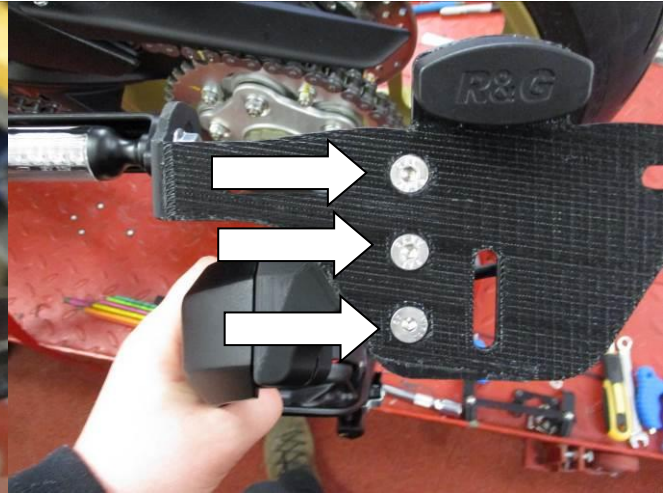

Picture 10

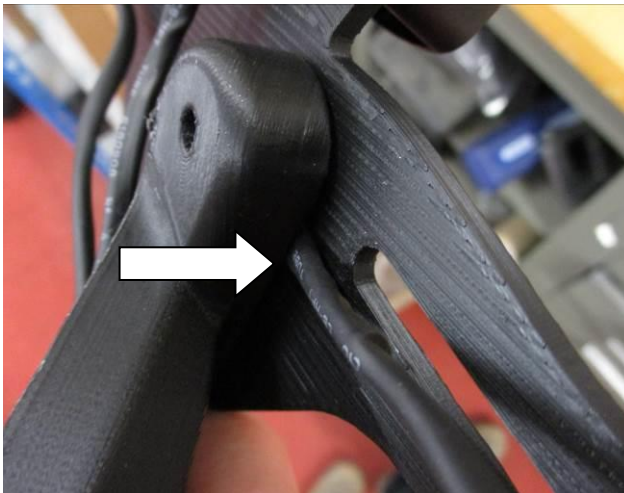

Picture 11

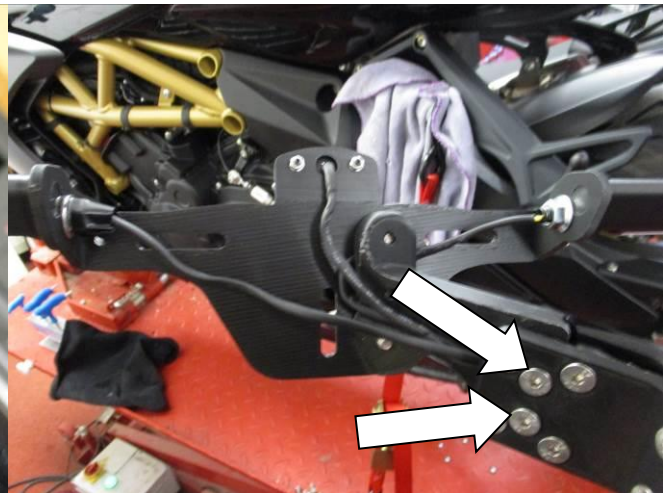

Picture 12

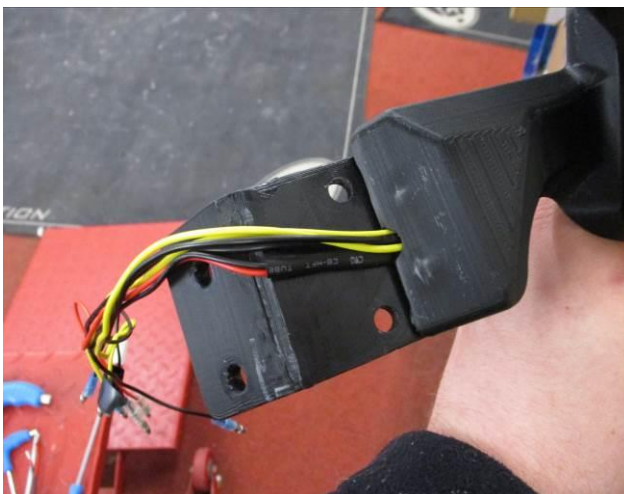

Picture 13

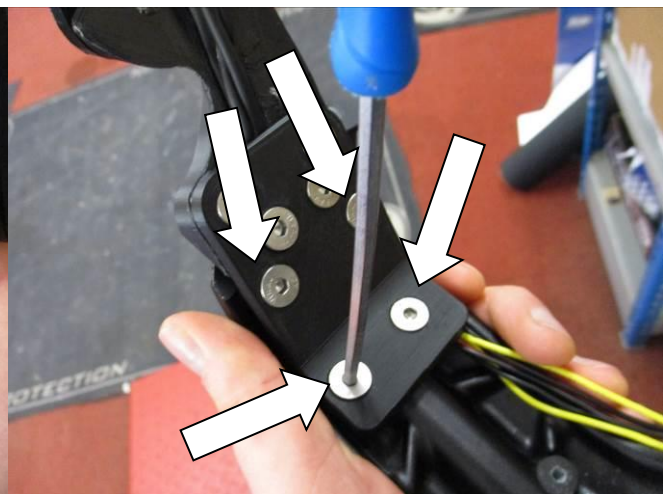

Picture 14



Picture 15



Picture 16

FITTING INSTRUCTIONS

PLEASE NOTE – If you are fitting aftermarket indicators (i.e. R&G mini-indicator product code RG374 for LED type, or RG372 for Aero Style LED type), RAP0016 will need to be purchased separately (2x kits required for Brutale 1000RR, 1x kit required for all other models). This kit includes a heatshield to protect the indicators from damage due to the proximity to the exhaust silencers.

- Using a 4mm Allen tool, remove the plastic wiring cover on the LHS of the swingarm to expose the tail bracket wiring connectors, as shown in picture 1. Disconnect all 3 connectors, noting the fitment of each, then cut the cable tie securing the wiring to the bracket.
- Staying on the LHS of the bike, using a 5mm Allen tool, remove the lower tail bracket assembly securing bolt shown in picture 2, then using a 10mm Allen tool, remove the 2x upper bolts shown in pictures 2 & 3. Gently lift the whole assembly off the bike.
- Flip the tail bracket assembly over and remove the 3x bolts shown in picture 4 and 5. Remove the wiring cover to expose the tail bracket wiring.
- Using a 5mm Allen tool, remove the 4x bolts shown in picture 6 to separate the main tail bracket from the swingarm mounting bracket.
- To remove the OEM indicators, flip the main tail bracket over and remove the wiring cover shown in picture 7 using a 3mm Allen tool, to expose the indicator mounting bolts, as shown in picture 8. Unscrew these with a 5mm Allen tool, then remove the indicators from the bracket.
- Fit the new license plate light (**item 9**) to the R&G tail bracket (**item 1**), fitting the securing nuts with a 6mm spanner, as shown in picture 9. Neatly wrap the license plate light wires with the included heat shrink (**item 11**).
- Fit the indicators to the tail bracket, securing as previous with a 5mm Allen tool. Tidy the wiring on the bracket using the included cable clips (**item 12**). Now, with a 4mm Allen tool secure the tail bracket to the spanning mounting block (**item 3**) as shown in picture 10 with the included M6 countersunk bolts – **item 5 (top), item 6 (middle) and item 7 (lower)**. Ensure the LHS indicator wiring passes through the cut-out on the spanning block as shown in picture 11.

R&G Racing

Unit 1, Shelley's Lane, East Worldham, Alton, Hampshire, GU34 3AQ

Tel: +44 (0)1420 89007 Fax: +44 (0)1420 87301 www.rg-racing.com Email: info@rg-racing.com



- Now, using a 5mm Allen tool, secure the tail bracket assembly to the mounting bracket (**item 2**) using the 2x included M8 countersunk bolts (**item 8**). Ensure the tail bracket wiring passes along the wiring channel on the spanning block, emerging as shown in picture 13.
- Using a 4mm Allen tool, secure the tail bracket assembly to the original swingarm mounting bracket using the included 4x M6 x 16mm countersunk bolts (**item 4**), as shown in picture 14. Ensure the wiring passes along the channel on the RHS of the swingarm mounting bracket, as shown in picture 15.
- Fit the included wiring adaptor (**item 10**) to the license plate light wiring, then refit the wiring cover previously removed (see pictures 4 & 5).
- Refit the assembly to the swingarm, securing with the 3x bolts previously removed (see pictures 2 & 3). **THESE MUST BE TIGHTENED TO THE MANUFACTURER SPECIFIED TORQUE SETTINGS.**
- Reconnect all 3 wiring connectors (see picture 1). At this point, turn on the ignition and check all lights function correctly, if lights fail to illuminate, check connections. Resecure the wiring as original with the included cable ties (**item 14**).
- Mount the licence plate (it may require drilling) to the rear of the bracket ensuring that it does not cover the indicators.
- **IMPORTANT: IF FITTING A FULL-SIZE LICENCE PLATE AND PLACING IT FAR DOWN ON THE LICENCE PLATE HANGER, THERE IS A SMALL CHANCE OF THE LICENCE PLATE HITTING THE BACK WHEEL UNDER HEAVY LOAD AND OVER LARGE BUMPS IN THE ROAD. IT IS YOUR RESPONSIBILITY TO CHECK FOR THIS POSSIBILITY AND TAKE AVOIDING ACTION. FAILURE TO CHECK THIS COULD RESULT IN SERIOUS INJURY.**
- Depending on local laws, attach enclosed reflector (**item 13**) in an appropriate location.
- **Please test the indicators, rear light, and licence plate illuminator before riding.**

ISSUE 1 - 27/02/2021 (FB)

CONSUMER NOTICE

The catalogue description and any exhibition of samples are only broad indications of the Products and R&G may make design changes which do not diminish their performance or visual appeal and supplying them in such state shall conform to the order. The Buyer acknowledges no representation or warranty (other than as to title) has been given or will apply to the Products other than those in R&G's order or confirmation and the Buyer confirms it has chosen the Products as being of merchantable quality and suitable for its particular purposes. Where R&G fits the Products or undertakes other services it shall exercise reasonable skill and care and rectify any fault free of charge unless the workmanship has been disturbed. The Buyer is responsible for ensuring that the warranty on the motorcycle is not affected by the fitting of the Products. On return of any defective Products R&G shall at its option either supply a replacement or refund the purchase money but shall not be liable if the Products have been modified or used or maintained otherwise than in accordance with R&G's or manufacturer's instructions and good engineering practice or if the defect arises from accident or neglect. Other than identified above and subject to R&G not limiting its liability for causing death and personal injury, it shall not be liable for indirect or consequential loss and otherwise its liability shall be limited to the amounts paid by the Buyer for the Products or the fitting or service concerned. These terms do not affect the Buyer's statutory rights.

R&G RACING RETURNS POLICY (NON-FAULTY GOODS)

Returns must be pre-authorized (if not pre-authorized the return will be rejected). Goods may only be returned direct to us if they were purchased direct from us (customer must prove if necessary). Otherwise to be returned to original vendor. Goods must be in re-sellable condition, in the opinion of R&G Racing. All returns are subject to a 25% restocking and handling fee (25% of the gross value exc. P&P - at the prevailing price at time of purchase). The customer must pay any and all carriage charges. No returns of discontinued products, unless within 14 days of purchase. This policy does not affect your statutory rights and does not refer to faulty goods.

R&G Racing

Unit 1, Shelley's Lane, East Worldham, Alton, Hampshire, GU34 3AQ

Tel: +44 (0)1420 89007 Fax: +44 (0)1420 87301 www.rg-racing.com Email: info@rg-racing.com