



**FITTING INSTRUCTIONS FOR CP0397BL/WH NO-CUT AERO CRASH
PROTECTORS**
MV AGUSTA F4-R, RR 2010- MODELS

Page | 1



PICTURE 'A'



PICTURE 'B'



REAR OF BIKE

FRONT OF BIKE

PICTURE 'C'

THIS KIT CONTAINS THE ITEMS PICTURED AND LABELLED BELOW.
DO NOT PROCEED UNTIL YOU ARE SURE ALL PARTS ARE PRESENT.

Please note that the way the kit is packed does not necessarily represent the way of mounting to the bike

Please note that in cases where kits are packed with rubber washers holding the components onto the bolt – *the rubber washers should be thrown away!*

THE PARTS SHOWN MAY BE REPRESENTATIVE ONLY (FOR CLARITY OF INSTRUCTIONS ONLY)

Digital copies of these instructions are available to download from www.rg-racing.com

GENERAL TORQUE SETTINGS

M4 BOLT = 8Nm
M5 BOLT = 12Nm
M6 BOLT = 15Nm
M8 BOLT = 20Nm
M10 BOLT = 40Nm

R&G Racing

Unit 1 Shelleys Lane, East Worldham, Alton, Hants GU34 3AQ

Tel: +44 (0)1420 89007 Fax: +44 (0)1420 87301 www.rg-racing.com Email: info@rg-racing.com

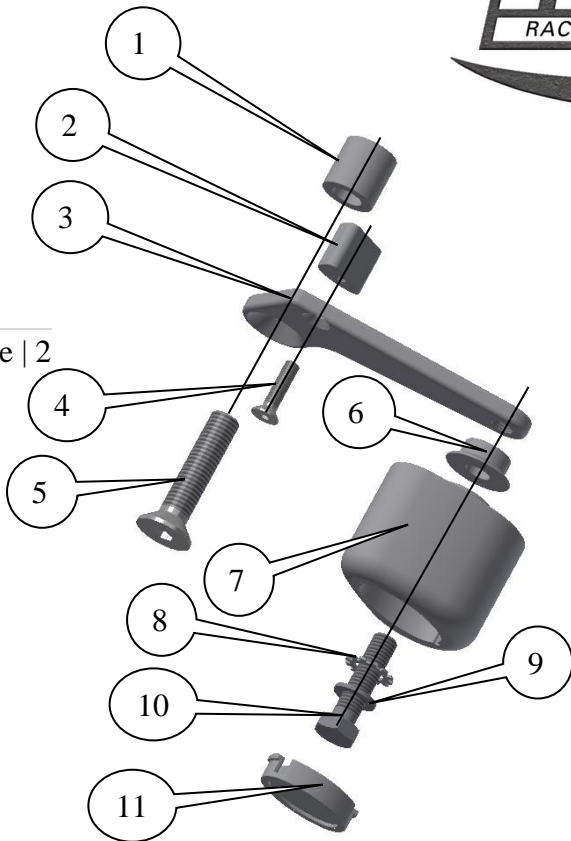
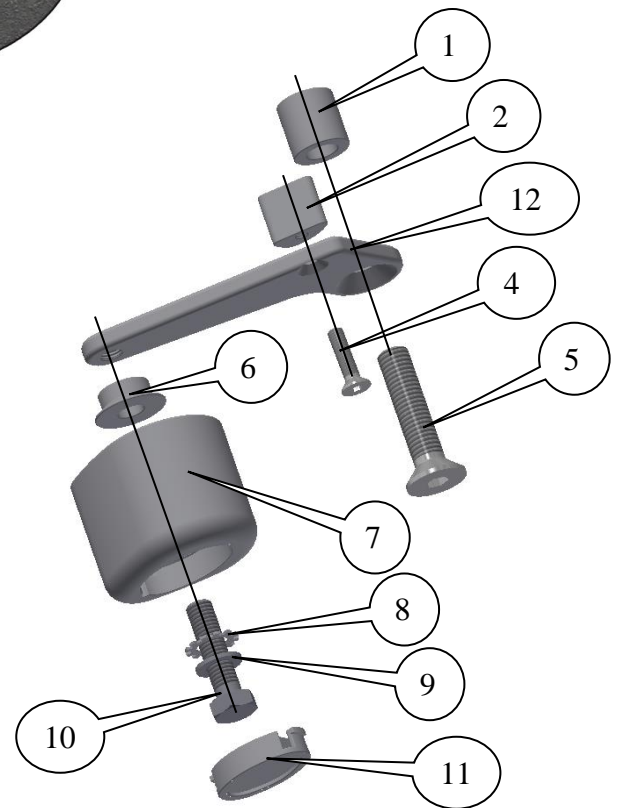
LEFT HAND SIDE ASSEMBLYRIGHT HAND SIDE ASSEMBLY**TOOLS REQUIRED**

- Socket set to include 14 and 17mm A/F socket and wrench.
- Hex drive bits or set of Allen keys to include 6mm A-F.
 - Torque wrench (up to 40Nm).

LEGEND

ITEM 1 = MOUNTING PLATE SPACERS, L&RHS (S0938=22mm WIDE) (x2).

ITEM 2 = ANTI-ROTATION SPACERS, L&RHS (M0471) (x2).

ITEM 3 = MOUNTING PLATE LHS (M0469) (x1).

ITEM 4 = M6x25mm LONG COUNTER-SUNK BOLT, L&RHS (x2).

ITEM 5 = M12x55mm LONG COUNTER-SUNK BOLT, L&RHS (x2).

ITEM 6 = CRASH PROTECTOR SPACERS, L&RHS (S0939=10mm WIDE) (x2).

ITEM 7 = CRASH PROTECTORS, L&RHS (B0063 with CS066, 10mm) (x2).

ITEM 8 = LOCKING WASHERS, L&RHS (LW0001) (x2).

ITEM 9 = M10 PLAIN WASHERS, L&RHS (x2).

ITEM 10 = CRASH PROTECTOR BOLTS, L&RHS, M10x40mm LONG HEX HEAD (x2).

ITEM 11 = CRASH PROTECTOR CAPS, L&RHS (BC0002) (x2).

ITEM 12 = MOUNTING PLATE RHS (M0470) (x1).

R&G Racing

Unit 1 Shelleys Lane, East Worldham, Alton, Hants GU34 3AQ

Tel: +44 (0)1420 89007 Fax: +44 (0)1420 87301 www.rg-racing.com Email: info@rg-racing.com



PICTURE 1

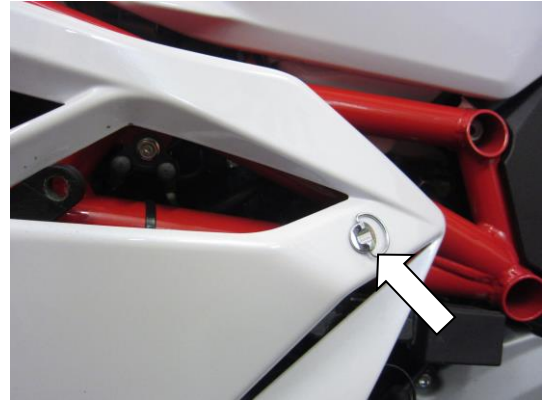

PICTURE 2

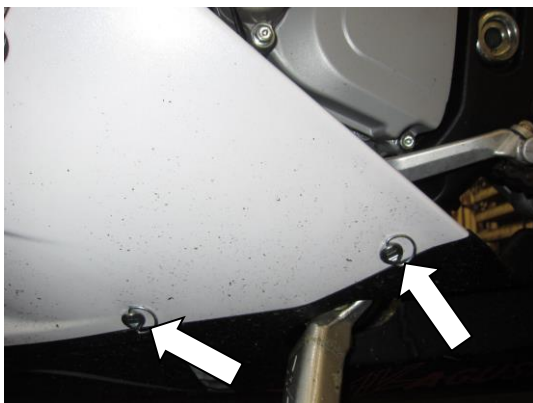

PICTURE 3



PICTURE 4

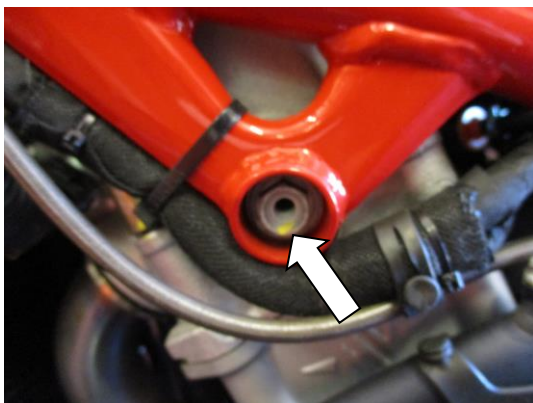

PICTURE 5



PICTURE 6

R&G Racing

Unit 1 Shelleys Lane, East Worldham, Alton, Hants GU34 3AQ

Tel: +44 (0)1420 89007 Fax: +44 (0)1420 87301 www.rg-racing.com Email: info@rg-racing.com



PICTURE 7

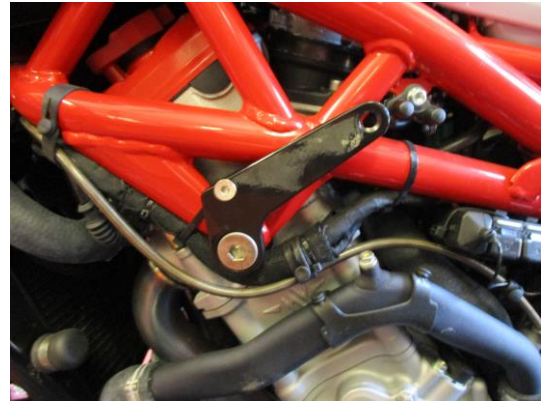

PICTURE 8

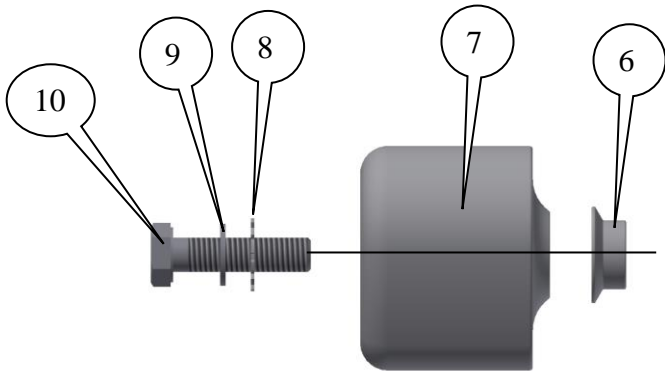

PICTURE 9



PICTURE 10



PICTURE 11

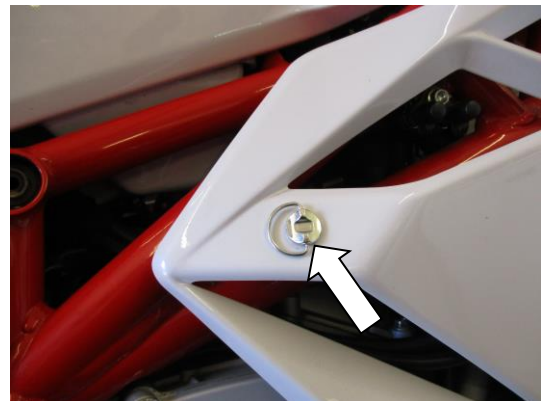

PICTURE 12

R&G Racing

Unit 1 Shelleys Lane, East Worldham, Alton, Hants GU34 3AQ

Tel: +44 (0)1420 89007 Fax: +44 (0)1420 87301 www.rg-racing.com Email: info@rg-racing.com



PICTURE 13

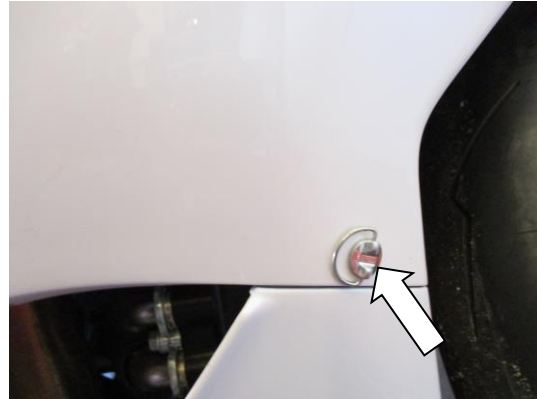

PICTURE 14

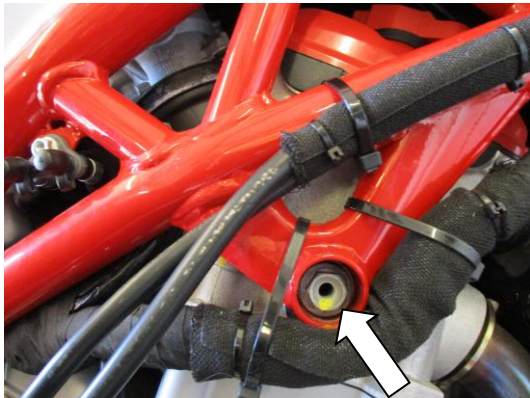

PICTURE 15



PICTURE 16



PICTURE 17



PICTURE 18

R&G Racing

Unit 1 Shelleys Lane, East Worldham, Alton, Hants GU34 3AQ

Tel: +44 (0)1420 89007 Fax: +44 (0)1420 87301 www.rg-racing.com Email: info@rg-racing.com

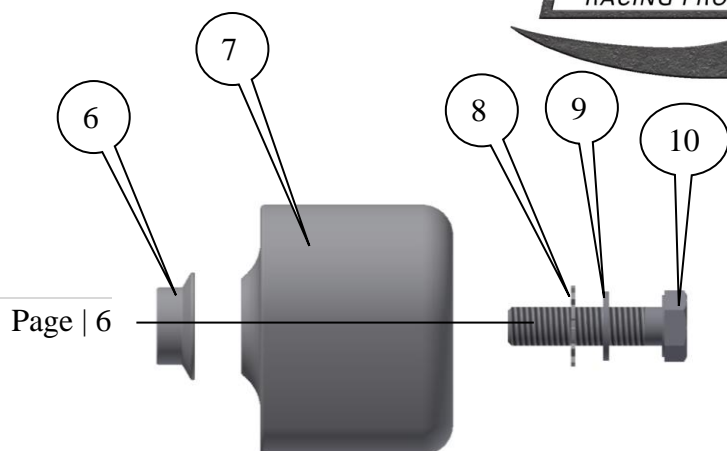

PICTURE 19



PICTURE 20

FITTING INSTRUCTIONS

Near side (left side as you sit on bike)

- Remove the seven quarter turn fasteners arrowed in pictures 1, 2, 3 and 4 and remove the left hand side fairing.
- Remove the bolt in position arrowed in picture 5.
- Place one of the larger counter-sunk bolts (item 10, M12x55mm long) into the left hand side mounting plate (item 3) as shown in pictures 6 and 7 (and the assembly drawing), place one of the larger spacers (item 1) over the exposed end of the bolt as shown in picture 6 and 7.
- Place one of the smaller counter-sunk bolts (item 4, M6x25mm long) into the left hand side mounting plate (item 3) as shown in pictures 6 and 7 (and the assembly drawing), place one of the shaped threaded anti-rotation spacers (item 2) onto the exposed thread of the bolt as shown in pictures 6 and 7 (do not fully tighten at this stage).
- Offer this assembly into position as shown in picture 8 (the larger spacer goes into the frame recess) while ensuring the anti-rotation spacer fits snugly into the frame and tighten both bolts.
- Refit the left hand side fairing as original (as the fairing are close to the mounting bracket care must be taken when fitting).
- Place one of the M10 washers (item 9) onto the one of the M10 bolts (item 10) as shown in picture 9.
- Place one of the locking washers (item 8) onto the bolt so it sits against the washer just fitted as shown in picture 9.
- Place the bolt with both washers into the crash protector (item 7) as shown in picture 9.
- Place one of the stepped spacers (item 6) over the exposed end of the bolt so the larger end sits against the crash protector as shown in picture 9.
- Offer this assembly into the threaded hole in the mounting plate as shown in picture 10 (care must be taken so as to cause no damage to the fairing). Please ensure no parts come in contact with any fairing panels. Finally tighten the crash protector bolts until you feel some compression from inside the protector using 17mm socket and wrench. **PLEASE NOTE THE CRASH PROTECTOR MUST BE POSITIONED AS IN PICTURE 'C' WITH BIGGER END TOWARD FRONT OF BIKE.** Turn a little more so that you feel the compression increase slightly. Then apply a quarter turn. Do not over tighten as damage can occur to the bike. Do not exceed 40 N/m of torque.
- If not already fitted, fit bubble sticker into recess of crash protector cap (item 11).
- Fit crash protector cap (item 1) into the crash protector.

R&G Racing

Unit 1 Shelleys Lane, East Worldham, Alton, Hants GU34 3AQ

Tel: +44 (0)1420 89007 Fax: +44 (0)1420 87301 www.rg-racing.com Email: info@rg-racing.com



Off side (right side as you sit on bike)

- Remove the seven quarter turn fasteners arrowed in pictures 11, 12, 13 and 14 and remove the right hand side fairing.
- Remove the bolt in position arrowed in picture 15.
- Place the remaining larger counter-sunk bolt (item 10, M12x55mm long) into the right hand side mounting plate (item 12) as shown in pictures 16 and 17 (and the assembly drawing), place the remaining larger spacer (item 1) over the exposed end of the bolt as shown in picture 16 and 17.
- Place the remaining smaller counter-sunk bolt (item 4, M6x25mm long) into the right hand side mounting plate (item 12) as shown in pictures 16 and 17 (and the assembly drawing), place the remaining shaped threaded anti rotation spacers (item 2) onto the exposed thread of the bolt as shown in pictures 16 and 17 (do not fully tighten at this stage).
- Offer this assembly into position as shown in picture 18 (the larger spacer goes into the frame recess) while ensuring the anti-rotation spacer fits snugly into the frame and tighten both bolts.
- Refit the right hand side fairing as original (as the fairing are close to the mounting bracket care must be taken when fitting).
- Place the remaining M10 washer (item 9) onto the remaining M10 bolt (item 10) as shown in picture 19.
- Place the remaining locking washer (item 8) onto the bolt so it sits against the washer just fitted as shown in picture 19.
- Place the bolt with both washers into the crash protector (item 7) as shown in picture 19.
- Place the remaining stepped spacer (item 6) over the exposed end of the bolt so larger the larger end sits against the crash protector as shown in picture 19.
- Offer this assembly into the threaded hole in the mounting plate as shown in picture 20 (care must be taken so as to cause no damage to the fairing). Please ensure no parts come in contact with any fairing panels. Finally tighten the crash protector bolts until you feel some compression from inside the protector using 17mm socket and wrench. **PLEASE NOTE THE CRASH PROTECTOR MUST BE POSITIONED AS IN PICTURE 'C' WITH BIGGER END TOWARD FRONT OF BIKE.** Turn a little more so that you feel the compression increase slightly. Then apply a quarter turn. Do not over tighten as damage can occur to the bike. Do not exceed 40 N/m of torque.
- If not already fitted, fit bubble sticker into recess of crash protector cap (item 11).
- Fit crash protector cap (item 1) into the crash protector.

ISSUE 1 16/03/2016 (NSY)

CONSUMER NOTICE

The catalogue description and any exhibition of samples are only broad indications of the Products and R&G may make design changes which do not diminish their performance or visual appeal and supplying them in such state shall conform to the order. The Buyer acknowledges no representation or warranty (other than as to title) has been given or will apply to the Products other than those in R&G's order or confirmation and the Buyer confirms it has chosen the Products as being of merchantable quality and suitable for its particular purposes. Where R&G fits the Products or undertakes other services it shall exercise reasonable skill and care and rectify any fault free of charge unless the workmanship has been disturbed. The Buyer is responsible for ensuring that the warranty on the motorcycle is not affected by the fitting of the Products. On return of any defective Products R&G shall at its option either supply a replacement or refund the purchase money but shall not be liable if the Products have been modified or used or maintained otherwise than in accordance with R&G's or manufacturer's instructions and good engineering practice or if the defect arises from accident or neglect. Other than identified above and subject to R&G not limiting its liability for causing death and personal injury, it shall not be liable for indirect or consequential loss and otherwise its liability shall be limited to the amounts paid by the Buyer for the Products or the fitting or service concerned. These terms do not affect the Buyer's statutory rights.

R&G Racing

Unit 1 Shelleys Lane, East Worldham, Alton, Hants GU34 3AQ

Tel: +44 (0)1420 89007 Fax: +44 (0)1420 87301 www.rg-racing.com Email: info@rg-racing.com