



FITTING INSTRUCTIONS FOR LP0157BK LICENCE PLATE BRACKET
MV AGUSTA RIVALE 800 '14-



THIS KIT CONTAINS THE ITEMS PICTURED AND LABELLED BELOW.
DO NOT PROCEED UNTIL YOU ARE SURE ALL PARTS ARE PRESENT.

Please note that the way the kit is packed does not necessarily represent the way of mounting to the bike.

THE PARTS SHOWN MAY BE REPRESENTATIVE ONLY (FOR CLARITY OF INSTRUCTIONS ONLY)

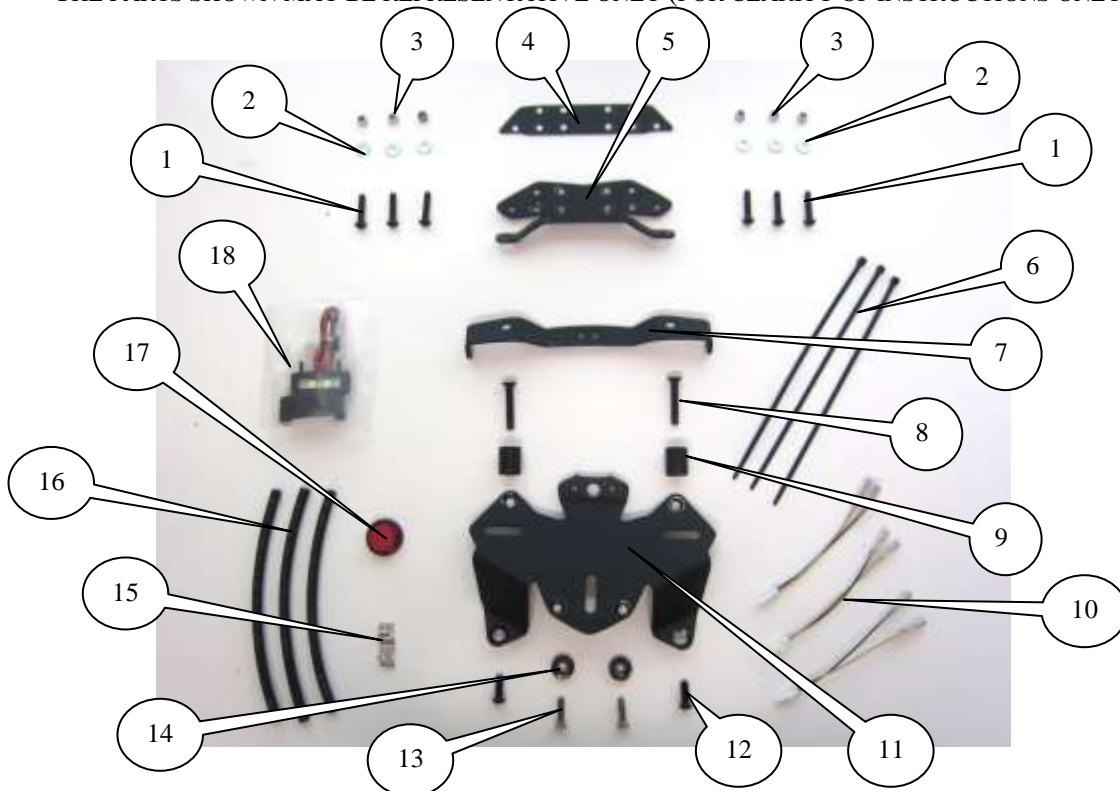



LEGEND

- ITEM 1 = M5 x 20mm LONG BUTTON HEAD BOLTS (x6).
ITEM 2 = M5 WASHERS (x6).
ITEM 3 = M5 NYLOC NUTS (x6).
ITEM 4 = OEM INDICATOR COVER (TB0157 Part 4) (x1).
ITEM 5 = OEM INDICATOR MOUNTING BRACKET (TB0157 Part 3) (x1).
ITEM 6 = 2.5mm CABLE TIES (x3).
ITEM 7 = MINI INDICATOR MOUNTING BRACKET (TB0157 Part 2) (x1).
ITEM 8 = M6 x 35mm LONG COUNTERSUNK BOLTS (x2).
ITEM 9 = S0741 SPACERS (20mm long) (x2).
ITEM 10 = WIRING CONNECTORS (CON0014) (x3).
ITEM 11 = LICENCE PLATE BRACKET (TB0157 Part 1) (x1).
ITEM 12 = M6 x 12mm LONG BUTTON HEAD BOLTS (x2).
ITEM 13 = M5 x 20mm LONG COUNTERSUNK BOLTS (x2).
ITEM 14 = S0742 SPACERS (5.5mm long) (x2).
ITEM 15 = SELF ADHESIVE CABLE CLIPS (x2).
ITEM 16 = 150mm LENGTH OF HEATSHRINK (x3).
ITEM 17 = REFLECTOR (x1).
ITEM 18 = LA0002 No. PLATE LIGHT ASSEMBLY (x1).

Please note that in cases where kits are packed with rubber washers holding the components onto the bolt – *the rubber washers should be thrown away!*

TOOLS REQUIRED

- Set of metric Allen keys to include 2.5, 3 & 4mm A/F sizes.
- Socket set to include 6 & 8mm sockets and wrench.
 - Phillips screwdriver.
- Small amount of superglue.
 - Cable cutters.



Picture 1



Picture 2



Picture 3



Picture 4



Picture 5



Picture 6



Picture 7



Picture 8



Picture 9



Picture 10



Picture 11



Picture 12



Picture 13



Picture 14



Picture 15



Picture 16



Picture 17



Picture 18



Picture 19



Picture 20



Picture 21



Picture 22



Picture 23



Picture 24



Picture 25



Picture 26



Picture 27



Picture 28



Picture 29



Picture 30



Picture 31



Picture 32



FITTING INSTRUCTIONS

- *The fitting instructions show how to fit the R&G Tail Tidy with the rear wheel and licence plate mounting arm in place. To make fitting easier, either one of these can be removed to improve accessibility.*
- To fit the R&G tail tidy, start off by removing the two bolts that secure the wiring cover in place on the swingarm, located on the back side of the rear wheel axle housing, as shown in picture 1.
- Undo the three wiring connectors for the indicators and licence plate illuminator, as shown in picture 2. *It is a good idea to note which connectors match, to make re-fitting easier.*
- On the back side of the licence plate mounting arm, there are three 2.5mm button head bolts. Remove these three bolts and the plastic wiring cover to gain access to the wiring. Two are shown in pictures 3 & 4 through the rear wheel, the third is higher up to the side of the tyre.
- On the licence plate bracket, remove the two button head bolts, as arrowed in picture 5.
- Gently place this bracket to one side, before removing the four button head bolts and two hex headed bolts now uncovered, as shown in picture 6.
- There is an additional button head bolt on the underside of the right side of the rear hugger. Remove this also, before gently pulling the rear hugger/licence plate assembly away and resting on the back wheel, as shown in picture 7.
- Loosen the two lower bolts and remove the two upper bolts on the back side of the mounting arm as shown in picture 8.
- With these two bolts removed, the wiring can be removed through the side, as shown in picture 9.
- With the wiring removed, the entire hugger/licence plate bracket can be removed from the bike, as shown in picture 10.
- If you intend to fit the R&G mini indicators, skip the following five stages.
- If you intend to re-use the OEM indicators, remove them from the hugger by removing the six button head bolts and loosen the two Phillips screws which secure the cable guides in place, allowing the indicators and wiring to come away from the hugger assembly, as shown in picture 11.
- Take the R&G OEM Indicator Mounting Bracket (item 5 – TB0157 Part 3) and place on a workbench along with both OEM indicators, as shown in picture 12. *Please note that when re-using the OEM indicators on the R&G Tail Tidy, the indicators are on the opposite sides to standard. Please ensure when re-connecting the wiring that it is reversed from the standard setup.*
- Take three of the M5 x 20mm long button head bolts (item 1) and offer them through the holes in the mounting bracket and then through the rubber mounted bushes in the indicator housing, as shown in picture 13.
- On the back, locate the OEM Indicator Cover (item 4 – TB0157 Part 4) over the three holes to align with the mounting bracket, before loosely fitting three M5 washers (item 2) and M5 nyloc nuts (item 3) over the exposed ends of the thread, as shown in picture 14. *Take care to ensure the wiring sits in the small void at the top of the cover and locates around the clip on the indicator housing.*
- Fit the remaining indicator using the same process. Once fitted, tighten all bolts evenly (do not overtighten - the nyloc nuts will remain secure), as shown in picture 15. The mounting bracket to re-use the OEM indicators is now prepared.
- *To fit the R&G Mini Indicators, take TB0157 Part 2 (item 7) and fit the mini indicators through the holes on either side before fitting the nut on the reverse. (Please use the heatshrink (item 16) to protect the indicator wires), as shown in picture 16. (If using the R&G Bulb Mini Indicators, simply connect the two bullet connectors to those on one of the wiring connectors (item 10 – CON0014) (black to black and black/white to black/white). If using the R&G LED Mini Indicators or Aero*

R&G Racing

Unit 1, Shelley's Lane, East Worldham, Alton, Hampshire, GU34 3AQ

Tel: +44 (0)1420 89007 Fax: +44 (0)1420 87301 www.rg-racing.com Email: info@rg-racing.com



Indicators, a small 5w resistor will be required on each indicator to achieve the correct flash rate (available separately). To fit, simply connect in line on each indicator, between the indicator wiring and the wiring on the connector (item 10 – CON0014) (black to black and black/white to yellow for the Aero Indicators), as shown in picture 17.

- Take the indicator mounting bracket and rest it on the rear wheel whilst feeding the wiring down the inside of the mounting arm in the same way the original wiring was removed, as shown in picture 18. *Cable ties are provided in the kit to clip the wires together to keep them neatly together.*
- Take the R&G Licence Plate Bracket (item 11 – TB0157 Part 1) and fit the R&G license plate illuminator (item 18), as shown in picture 19. Use a small amount of superglue to stick the light shroud in position. Fit one length of heatshrink to the wires and tighten the nuts on the rear along with fitting a wiring connector (item 10 – CON0014) (black to black and red to yellow), as shown in picture 20.
- The R&G licence plate bracket can now be offered up to the rear of the bike. Take the two M6 x 12mm long button head bolts (item 12) and locate through the two lower mounting holes into the threaded bosses on the metal arm underneath, as shown in picture 21.
- Locate the illuminator wiring neatly down inside the mounting arm along with the indicator wiring, as shown in picture 22.
- With the wiring in place and tucked inside the mounting arm, tighten the bolt that secures the cable clip along with the two bolts that secure the plastic cover in place and re-fit the protective cable sleeve, as shown in pictures 23, 24 and 25.
- At this stage it is advisable to connect the wiring connectors and ensure the correct operation and flash rates of the lights. *If re-fitting the OEM indicators, the red wire should connect to the connector marked “L” and the white wire should connect to the connector marked “R” (the opposite to standard).*
- Re-fit the two mounting arm bracket bolts and then tighten all four bolts, taking care to ensure no wiring is trapped, as shown in picture 26.
- Re-fit the plastic cover using the two bolts from the underside of the swingarm/rear axle, ensuring all the connectors are protected, as shown in picture 27.
- Take the two M5 x 20mm long countersunk bolts (item 13) and locate through the two lower countersunk holes on the licence plate bracket, ensuring that the shorter spacers (item 14 – S0472 – 5.5mm long) sit between the licence plate bracket and threaded boss on the mounting bracket before loosely tightening, as shown in picture 28.
- If using the OEM indicators, take the assembly and offer it up to the top two mounting holes, as shown in picture 29. Take the two M6 x 35mm long countersunk bolts (item 8) and locate through the remaining countersunk holes on the licence plate bracket, then through one of the remaining longer spacers (item 9 – S0741 – 20mm long), then the mounting holes on the indicator bracket before loosely tightening into the threaded boss on the mounting bracket, as shown in picture 30.
- If using the bracket with the mini indicators, position the indicator bracket above the spacer, opposed to below it, as shown in picture 31. *There are also two slots in the middle of the bracket to cable tie any loose wiring to.*
- Tighten the six bolts that secure the licence plate bracket in place, ensuring no wiring is trapped on the reverse.
- The OEM indicators can be set in a narrow position as well as a wider position to suit wider licence plates. This can be adjusted by using the different mounting holes in the OEM Indicator Mounting Bracket (TB0157 Part 3) to space the indicators wider apart, as shown in picture 32.
- Re-fit the licence plate (it may require drilling).
- Depending on local laws, attach enclosed reflector in an appropriate location.
- Test the license plate illuminator and all lights before riding.

R&G Racing

Unit 1, Shelley's Lane, East Worldham, Alton, Hampshire, GU34 3AQ

Tel: +44 (0)1420 89007 Fax: +44 (0)1420 87301 www.rg-racing.com Email: info@rg-racing.com