



**FITTING INSTRUCTIONS FOR LP0363 LICENCE PLATE BRACKET**



**This kit contains the items pictured and labelled over page.  
Some parts may be shown for clarity of instructions only.  
Do not proceed until you are sure all parts are present.  
Please read all instructions before proceeding.**

**IF IN ANY DOUBT WHEN FITTING OUR PRODUCTS, CONSULT ONE OF OUR DEALERS  
OR HAVE FITTED BY A QUALIFIED TECHNICIAN.**

Please note that the way the kit is packed does not necessarily represent the way of mounting to the bike.

In the event of rubber washers being used to hold components onto bolts, these rubber washers can be thrown away.

**DIGITAL COPIES OF THESE INSTRUCTIONS ARE AVAILABLE FROM**

**[WWW.RG-RACING.COM](http://WWW.RG-RACING.COM)**

R&G

Unit 1, Shelley's Lane, East Worldham, Alton, Hampshire, GU34 3AQ  
Tel: +44 (0)1420 89007 Fax: +44 (0)1420 87301 [www.rg-racing.com](http://www.rg-racing.com) Email: [info@rg-racing.com](mailto:info@rg-racing.com)



<b><u>TOOLS REQUIRED</u></b>	<b><u>GENERAL TORQUE SETTINGS</u></b>
<ul style="list-style-type: none"> <li>• Set of metric Hex keys to include 3mm, 4mm and 5mm.</li> <li>• Set of metric sockets and wrench. To include 6, 8 &amp; 10mm.               <ul style="list-style-type: none"> <li>• 8mm &amp; 10mm spanners.</li> <li>• Phillips screwdriver.</li> </ul> </li> </ul>	M4 BOLT = 8Nm M5 BOLT = 12Nm M6 BOLT = 15Nm M8 BOLT = 20Nm M10 BOLT = 40Nm M12 BOLT = 40Nm

### **LEGEND**

<b>ITEM No.</b>	<b>DESCRIPTION</b>	<b>QTY</b>
ITEM 1	TB0363 PART 1 (TAIL TIDY BRACKET 2mm STAINLESS)	1
ITEM 2	TB0363 PART 2 (NUMBER PLATE BRACKET 3mm ALUMINIUM)	1
ITEM 3	TB0363 PART 3 (SPACER PLATE 4mm ALUMINIUM)	1
ITEM 4	LA0007 (BREAK LIGHT ASSEMBLY)	1
ITEM 5	LH0005 (LIGHT HOUSING / COVER FITTING KIT)	1
ITEM 6	CON0004 (BULLET CONNECTORS)	2
ITEM 7	CON0040 (BRAKE/ NUMBER PLATE CONNECTOR)	1
ITEM 8	(M6x1.0x16mm BUTTON HEAD BOLT)	4
ITEM 9	(M5x0.8x16mm COUNTERSUNK BOLT)	4
ITEM 10	M5x10mm (FLAT WASHER)	4
ITEM 11	M6x12mm (FLAT WASHER)	6
ITEM 12	M5X0.8 (NYLOC NUT)	4
ITEM 13	RB0004 (RUBBER BUNG)	1
ITEM 14	666-896/20 (200mm LENGTH OF 666-896 (HEAT-SHRINK))	2
ITEM 15	CT75BK (2.5mm WIDE x 75mm LONG CABLE TIES (BLACK))	3
ITEM 16	REFL3 (REFLECTOR)	1

R&G

Unit 1, Shelley's Lane, East Worldham, Alton, Hampshire, GU34 3AQ

Tel: +44 (0)1420 89007 Fax: +44 (0)1420 87301 [www.rg-racing.com](http://www.rg-racing.com) Email: [info@rg-racing.com](mailto:info@rg-racing.com)



## **ASSEMBLY DIAGRAM 1**

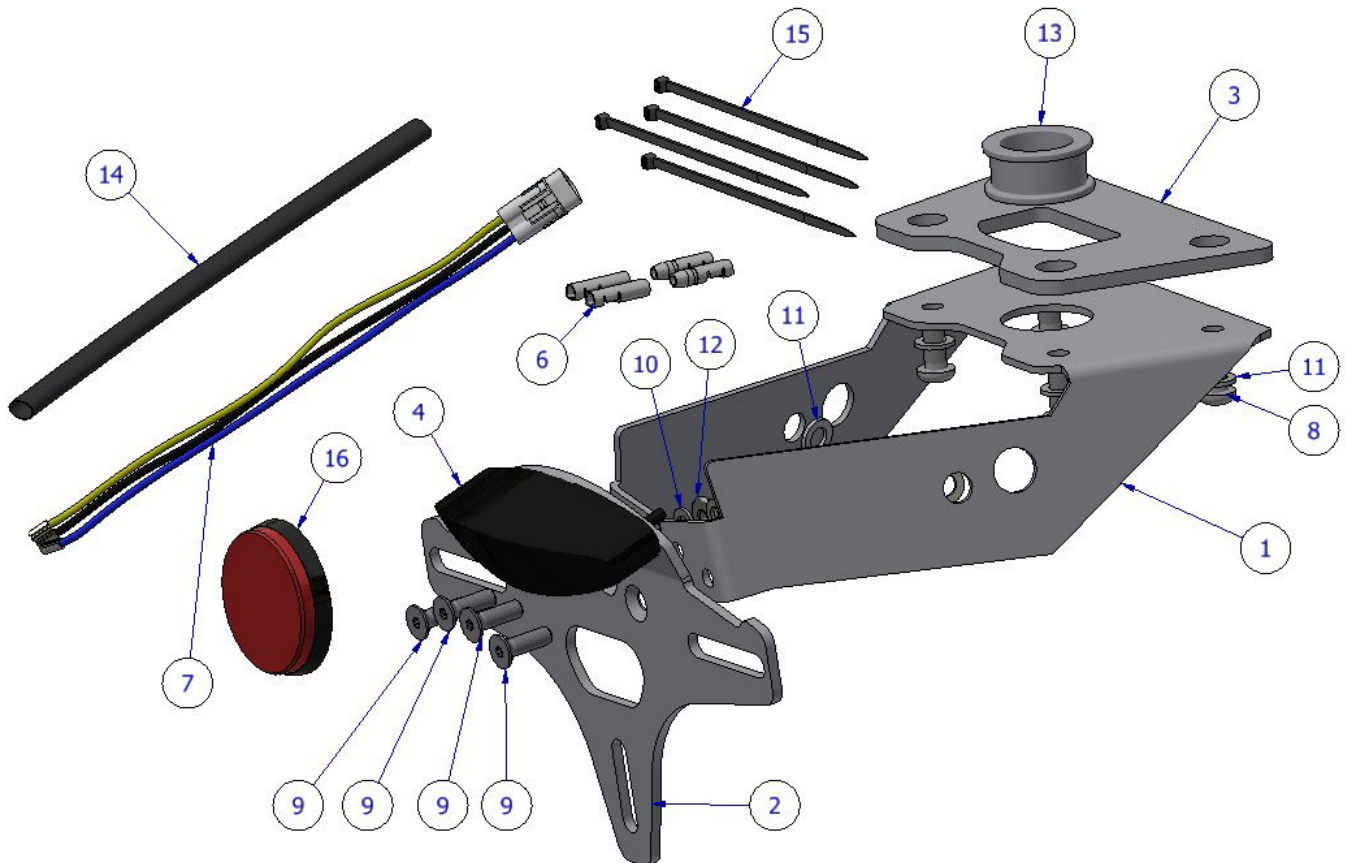

## **FITTING INSTRUCTIONS**

Before fitting the R&G tail tidy you will need to remove some OEM parts. Below is a suggested list of parts to be removed.

- Seat
- Unplug indicators and number plate light.
- OEM number plate bracket
- OEM indicators (re-use all components with Tail Tidy)
- Unplug indicator and number plate light wires

R&G

Unit 1, Shelley's Lane, East Worldham, Alton, Hampshire, GU34 3AQ

Tel: +44 (0)1420 89007 Fax: +44 (0)1420 87301 [www.rg-racing.com](http://www.rg-racing.com) Email: [info@rg-racing.com](mailto:info@rg-racing.com)



## **Tail Tidy Assembly**

Before assembling this product, ensure all the components within the box are correct by comparing the **legend** and **diagrams**.

1. To start the assembly process, connect the tail tidy bracket (**ITEM 1**) and the number plate bracket (**ITEM 2**) together using x4 of (**ITEM 9**), (**ITEM 10**) and (**ITEM 12**). As shown in **DIAGRAM 1**.
2. Before the Rubber bung (**ITEM 13**) can be mounted, you will need to cut a small cross into the centre of the flat face to make an access hole for the wires to enter.
3. Now place the Rubber Grommet (**ITEM 13**) through the Licence plate bracket (**ITEM 1**) with the hole facing towards the top of the bike, as shown in **DIAGRAM 1**.
4. Apply the Heat shrink (**ITEM 14**) to the number plate light (**ITEM 4**) wires.
5. Mount the break light assembly (**ITEM 4**) and light housing (**ITEM 5**) with the fitting kit supplied to the number plate bracket (**ITEM 2**) using the supplied nuts and bolts.

### **Mounting To the Bike**

6. Now the assembly is ready to be mounted to the motorbike. To do so you will need x4 (**ITEM 8**) & (**ITEM 11**) and the spacer plate (**ITEM 3**). Use **DIAGRAM 1** to assist with where each ITEM goes.

**MAKE SURE TO SLOT x1 WASHER (ITEM 11) ONTO ALL BOLTS (ITEM 8) BEFORE MOUNTING.**

7. Now place the Tail tidy into the same mounting holes as the OEM number plate bracket and tighten the bolts to the correct torques settings using the **GENERAL TORQUE SETTINGS** on **page 2**. **Ensure the spacer plate has been installed.**
8. Fit the OEM indicators into the new Tail tidy assembly **ENSURE YOU REMOVE THE OEM SPACERS AND USE TWO OF THE WASHERS (ITEM 11) AS SHOWN IN THE ASSEMBLY DIAGRAM** and place the wires through the rubber bung (**ITEM 13**). Then plug them back into the OEM connectors.

**ENSURE INDICATORS ARE CORRECT WAY AROUND.**

9. Final step, re-install all OEM parts except from the OEM Number Plate Bracket. (The reflector within the kit in case a new number plate is required).

**IMPORTANT: IF FITTING A FULL-SIZE LICENCE PLATE AND PLACING IT LOW DOWN ON THE LICENCE PLATE MOUNT, THERE IS A POTENTIAL CHANCE THE LICENCE PLATE COULD HIT THE BACK WHEEL UNDER HEAVY LOAD AND OVER LARGE BUMPS IN THE ROAD. IT IS YOUR RESPONSIBILITY TO CHECK FOR THIS POSSIBILITY AND TAKE AVOIDING ACTION. FAILURE TO CHECK THIS COULD RESULT IN SERIOUS INJURY.**

R&G

Unit 1, Shelley's Lane, East Worldham, Alton, Hampshire, GU34 3AQ

Tel: +44 (0)1420 89007 Fax: +44 (0)1420 87301 [www.rg-racing.com](http://www.rg-racing.com) Email: [info@rg-racing.com](mailto:info@rg-racing.com)