



**FITTING INSTRUCTIONS FOR LP0260BK LICENCE PLATE BRACKET**  
**YAMAHA NIKEN 2018**



**THIS KIT CONTAINS THE ITEMS PICTURED AND LABELLED BELOW.**  
**DO NOT PROCEED UNTIL YOU ARE SURE ALL PARTS ARE PRESENT.**

Please note that the way the kit is packed does not necessarily represent the way of mounting to the bike.

THE PARTS SHOWN MAY BE REPRESENTATIVE ONLY (FOR CLARITY OF INSTRUCTIONS ONLY).

Please note that in cases where kits are packed with rubber washers holding the components onto the bolt – *the rubber washers should be thrown away!*

Digital copies of these instructions are available to download from [www.rg-racing.com](http://www.rg-racing.com)

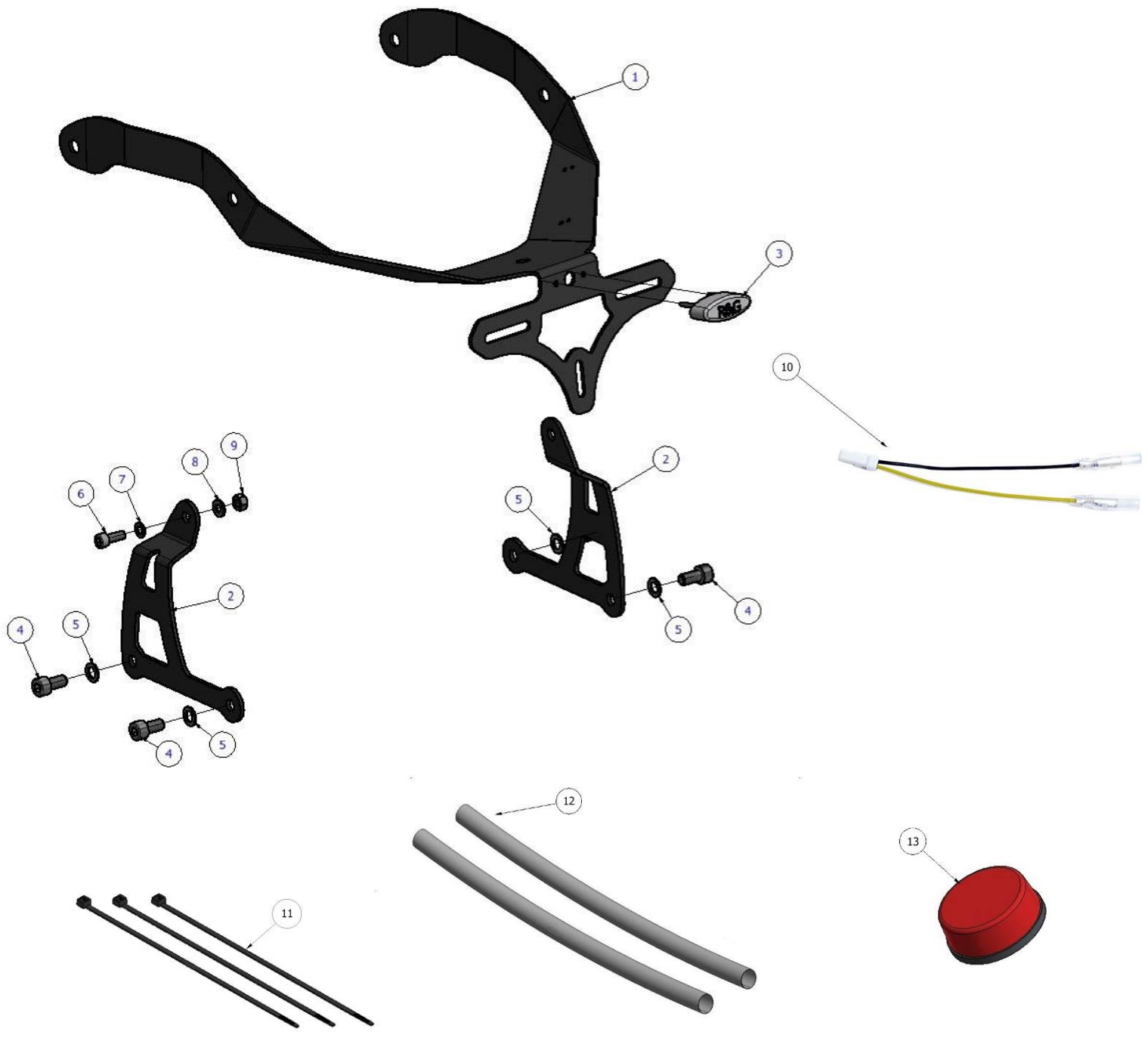



### **LEGEND**

- ITEM 1 = LICENCE PLATE BRACKET (TB0260) (x1)
- ITEM 2 = CHAIN GUARD/ABS LINE MOUNT (SMW0135) (x2)
- ITEM 3 = LICENCE PLATE ILLUMINATOR ASSEMBLY (x1)
- ITEM 4 = M8 x 1.25mm x 15mm LONG CAP HEAD BOLTS (x4)
- ITEM 5 = M8 WASHER (x4)
- ITEM 6 = M6 x 1.00mm x 15mm CAP HEAD BOLT (x1)
- ITEM 7 = M6 WASHER (x1)
- ITEM 8 = M6 PENNY WASHER (x1)
- ITEM 9 = M6 NYLOC NUT (x1)
- ITEM 10 = LICENCE PLATE ILLUMINATOR CONNECTOR (CON0014) (x1)
- ITEM 11 = SMALL CABLE TIES (x6)
- ITEM 12 = 200MM LENGTH OF LARGE HEATSHRINK (x2)
- ITEM 13 = REFLECTOR (x1)

### **TOOLS REQUIRED**

- Set of metric Allen keys.
  - Cable cutters.
- Small flat head screwdriver.
- Small Philips head screwdriver.
  - 10mm Socket/ Spanner.
- Small amount of adhesive.

### **MAXIMUM TORQUE SETTINGS**

- M4 BOLT = 8Nm
- M5 BOLT = 12Nm
- M6 BOLT = 15Nm
- M8 BOLT = 20Nm



Picture 1



Picture 2

R&G

Unit 1, Shelley's Lane, East Worldham, Alton, Hampshire, GU34 3AQ  
 Tel: +44 (0)1420 89007 Fax: +44 (0)1420 87301 [www.rg-racing.com](http://www.rg-racing.com) Email: [info@rg-racing.com](mailto:info@rg-racing.com)





Picture 3



Picture 4



Picture 5



Picture 6

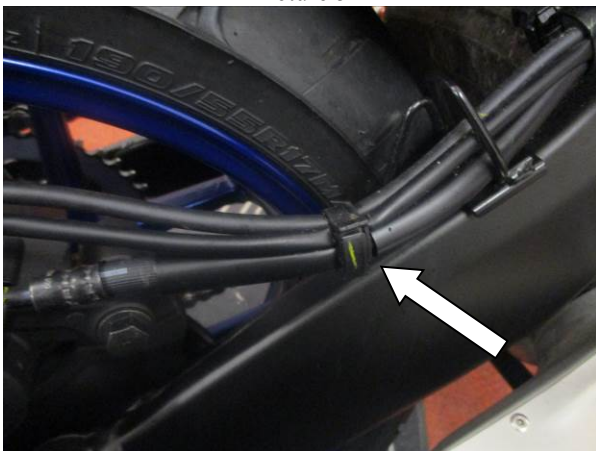

Picture 7

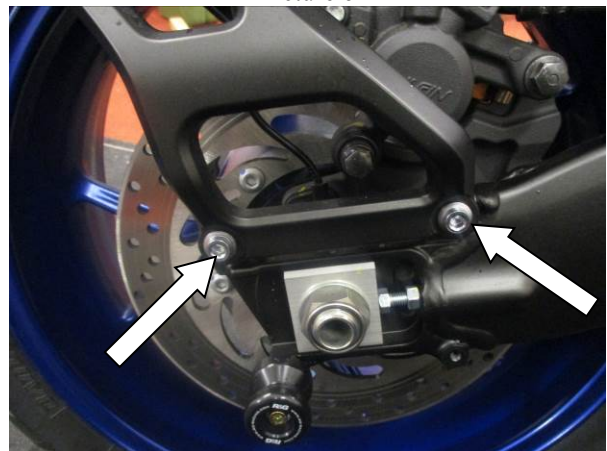

Picture 8





Picture 9



Picture 10

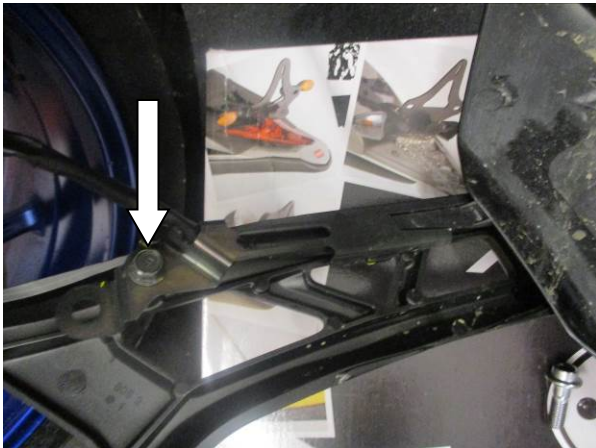

Picture 11



Picture 12



Picture 13

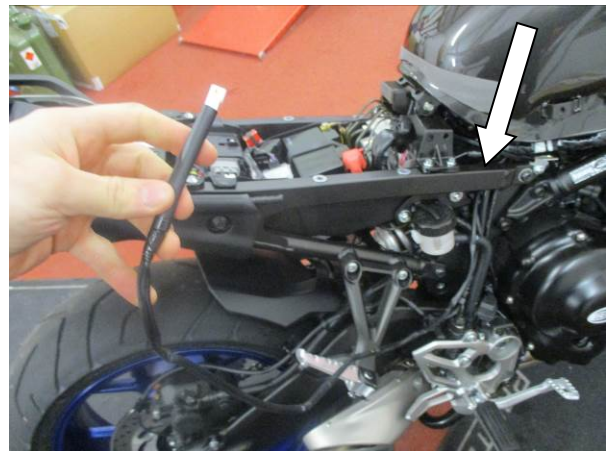

Picture 14



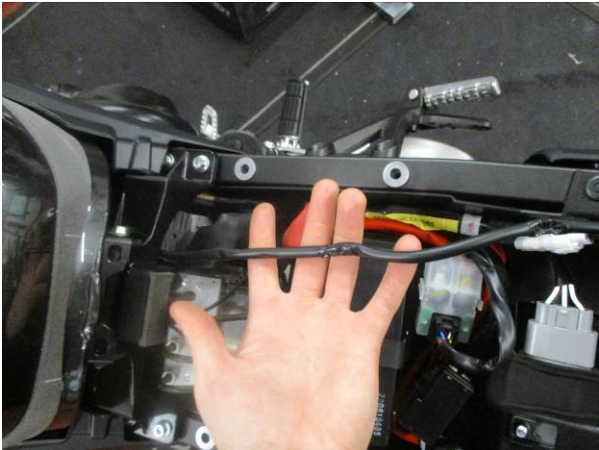

Picture 15

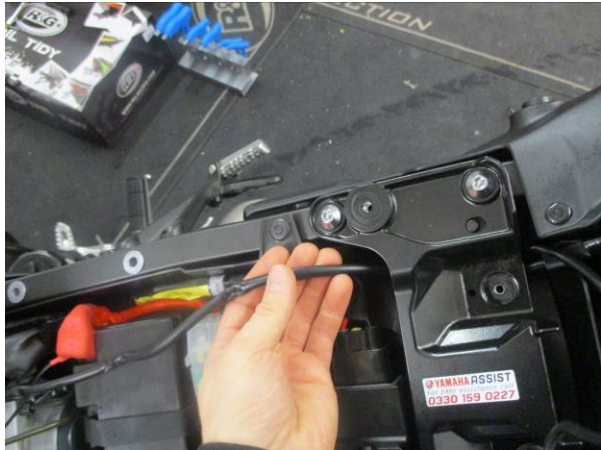

Picture 16



Picture 17



Picture 18



Picture 19

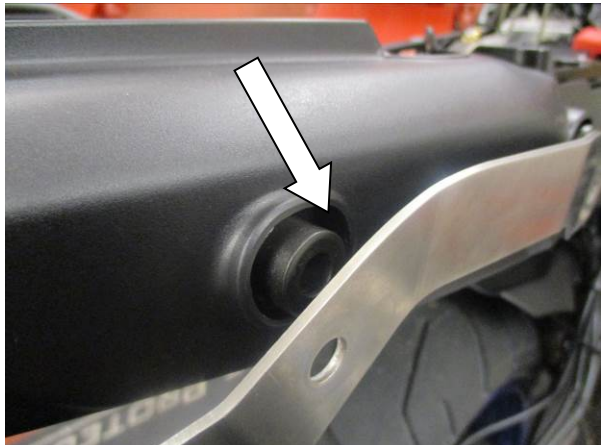

Picture 20

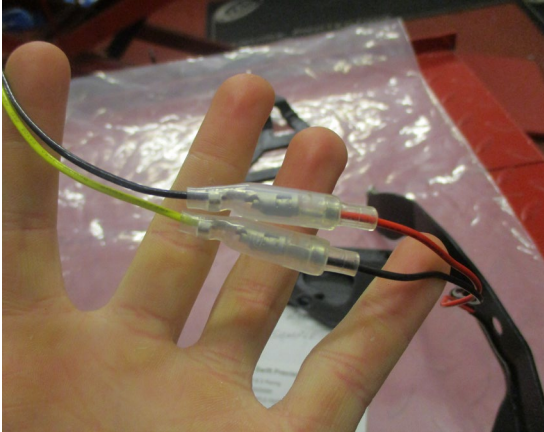

Picture 21

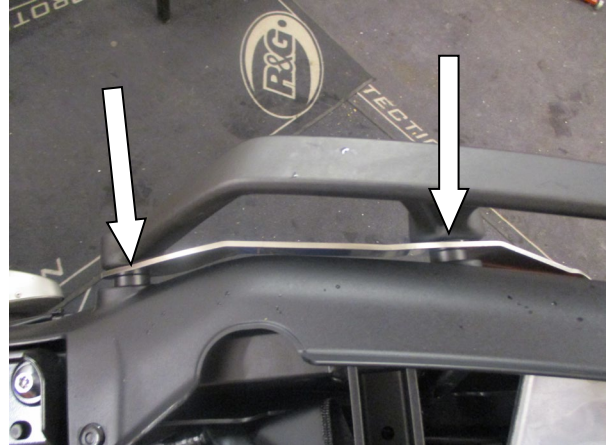

Picture 22

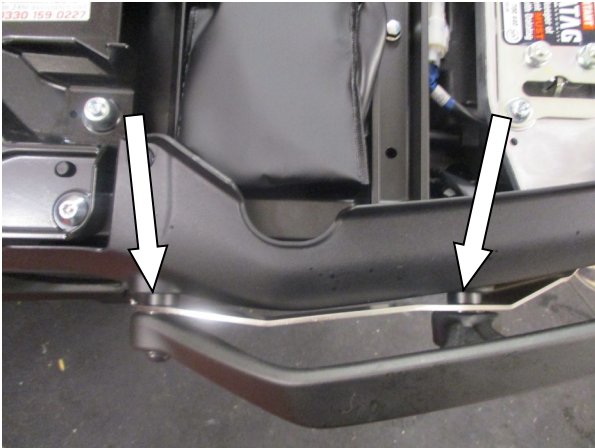

Picture 23



Picture 24

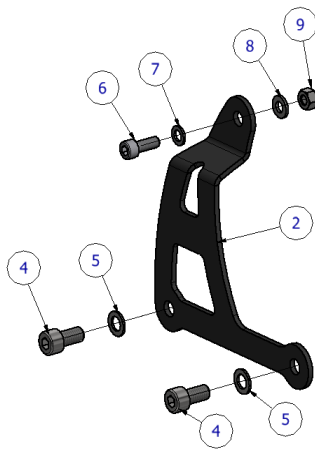

Picture 25

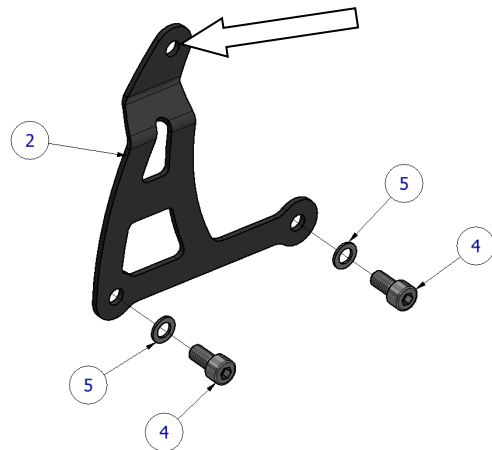

Picture 26





### FITTING INSTRUCTIONS

- Remove the pillion seat, using the lock under the tail.
- Remove the two grab rails by removing the four bolts shown in Picture 1. Put these to one side with the bolts, washers, and spacers; for later use.
- Remove the two bolts shown in Picture 3, and carefully remove the seat (Shown in Picture 4).
- On the RH side of the bike remove the plastic push rivet and bolt shown in Picture 5, and carefully remove the panel.
- Locate the small cable tie shown in Picture 6, which can be found above the rear brake calliper, and carefully cut it using clippers, ensuring you do not cut/damage the other wires.
- Trace the licence plate illuminator cable and remove it from the clip shown in Picture 7.
- On the RH side of the bike trace the ABS line back to the small fir tree clip used to secure it to the licence plate mount and remove it from the mount.
- On the LH side of the bike remove the small plastic screw used to mount the chain guard to the licence plate mount.
- Remove the 4 bolts shown in Picture 8 and Picture 9, ensuring the licence plate mount is supported.
- With the four bolts removed the licence plate mount can be carefully moved over to the RH side of the bike (shown in Picture 10). NOTE: Be sure not to pull on the cable attached to it.
- Remove the bolt on the licence plate mount (shown in Picture 11) to expose the licence plate illuminator connector (Picture 12).
- Disconnect the connector (shown in Picture 13).
- With the licence plate illuminator cable detached from the licence plate mount, the cable can now be fed through/removed from all the wiring clips/cable ties, up to the arrow shown in Picture 14.
- Neatly route the cable under the seat, using no more than four of the cable ties supplied (ITEM 11), to reach the rear of the tail (Shown in Pictures 15 – 17). **NOTE: BE SURE NOT TO ROUTE THE CABLE ANYWHERE IT CAN GET CAUGHT, OR IN THE WAY OF THE PILLION SEAT LATCH.**
- Connect the licence plate illuminator connector (ITEM 10) to the end of the cable (shown in Picture 18).
- Slide the two lengths of heat shrink (ITEM 12) over the licence plate illuminator assembly (ITEM 3) wiring, and heat gently to shrink it.
- Fit the licence plate illuminator assembly (ITEM 3) to the tail tidy (ITEM 1) using the bolts, washers and nuts provided. Please note you will have to fit the light shroud and use a small amount of adhesive to hold it in position.
- Feed the wiring through the hole shown in Picture 19.
- Secure the wiring to the tail tidy (ITEM 1) using two of the cable ties (ITEM 11) supplied.
- Offer the tail tidy up to the bike and feed the licence plate illuminator wires through the hole shown in Picture 20.
- The tail tidy is mounted between the grabrails and the bike. Reusing the grab rail, with the original bolts and spacers, slide the two grab rail bolts through the two holes either side of the tail tidy, and screw them into the original grab rail mounts (shown in Pictures 22-24).
- Connect the licence plate illuminator bullet connectors and test all the lights. If illumination fails, swap the bullet connectors.
- Re-fit the RH side panel, seat, and pillion seat.
- Place two M8 washers (ITEM 5) over the two M8 Bolts (ITEM 4) (as shown in Picture 25) and fit the chain guard mount (ITEM 2) to the LH side of the swingarm.
- Using the M6 Bolt (ITEM 6), M6 Washer (ITEM 7), M6 Penny Washer (ITEM 8) and the M6 Nyloc nut (ITEM 9), secure the chain guard to the chain guard mount (ITEM 2).

R&G

Unit 1, Shelley's Lane, East Worldham, Alton, Hampshire, GU34 3AQ

Tel: +44 (0)1420 89007 Fax: +44 (0)1420 87301 [www.rg-racing.com](http://www.rg-racing.com) Email: [info@rg-racing.com](mailto:info@rg-racing.com)





- Place two M8 washers (ITEM 5) over the two M8 Bolts (ITEM 4) as shown in Picture 26 and fit the ABS Mount to the RH side of the swingarm.
- Reusing the small fir tree clip in the hole shown in Picture 26, mount the ABS line to the ABS line Mount (ITEM 2).
- Refit the licence plate to the tail tidy (ITEM 1) (it may require drilling).
- Please check the operation of all lights before riding the motorcycle.
- **IMPORTANT: IF FITTING A FULL-SIZE LICENCE PLATE AND PLACING IT FAR DOWN ON THE LICENCE PLATE HANGER, THERE IS A SMALL CHANCE OF THE LICENCE PLATE HITTING THE BACK WHEEL UNDER HEAVY LOAD AND OVER LARGE BUMPS IN THE ROAD. IT IS YOUR RESPONSIBILITY TO CHECK FOR THIS POSSIBILITY AND TAKE AVOIDING ACTION. FAILURE TO CHECK THIS COULD RESULT IN SERIOUS INJURY.**
- Depending on local laws, attach enclosed reflector (ITEM 13) in an appropriate location

ISSUE 1 21/12/2018 (LF)

#### CONSUMER NOTICE

The catalogue description and any exhibition of samples are only broad indications of the Products and R&G may make design changes which do not diminish their performance or visual appeal and supplying them in such state shall conform to the order. The Buyer acknowledges no representation or warranty (other than as to title) has been given or will apply to the Products other than those in R&G's order or confirmation and the Buyer confirms it has chosen the Products as being of merchantable quality and suitable for its particular purposes. Where R&G fits the Products or undertakes other services it shall exercise reasonable skill and care and rectify any fault free of charge unless the workmanship has been disturbed. The Buyer is responsible for ensuring that the warranty on the motorcycle is not affected by the fitting of the Products. On return of any defective Products R&G shall at its option either supply a replacement or refund the purchase money but shall not be liable if the Products have been modified or used or maintained otherwise than in accordance with R&G's or manufacturer's instructions and good engineering practice or if the defect arises from accident or neglect. Other than identified above and subject to R&G not limiting its liability for causing death and personal injury, it shall not be liable for indirect or consequential loss and otherwise its liability shall be limited to the amounts paid by the Buyer for the Products or the fitting or service concerned. These terms do not affect the Buyer's statutory rights.

#### R&G RETURNS POLICY (NON-FAULTY GOODS)

Returns must be pre-authorized (if not pre-authorized the return will be rejected). Goods may only be returned direct to us if they were purchased direct from us (customer must prove if necessary). Otherwise to be returned to original vendor. Goods must be in re-sellable condition, in the opinion of R&G. All returns are subject to a 25% restocking and handling fee (25% of the gross value exc. P&P – at the prevailing price at time of purchase). The customer must pay any and all carriage charges. No returns of discontinued products, unless within 14 days of purchase. This policy does not affect your statutory rights and does not refer to faulty goods.

R&G

Unit 1, Shelley's Lane, East Worldham, Alton, Hampshire, GU34 3AQ

Tel: +44 (0)1420 89007 Fax: +44 (0)1420 87301 [www.rg-racing.com](http://www.rg-racing.com) Email: [info@rg-racing.com](mailto:info@rg-racing.com)