



FITTING INSTRUCTIONS FOR LSR0001
LUGGAGE SIDE RAILS
YAMAHA TÉNÉRÉ 700 2019-



THIS KIT CONTAINS THE ITEMS PICTURED AND LABELLED OVER PAGE.

SOME PARTS MAY BE SHOWN FOR CLARITY OF INSTRUCTIONS ONLY.

DO NOT PROCEED UNTIL YOU ARE SURE ALL PARTS ARE PRESENT.

PLEASE READ ALL INSTRUCTIONS BEFORE PROCEEDING.

**IF IN ANY DOUBT WHEN FITTING OUR PRODUCTS, CONSULT ONE OF OUR DEALERS
OR HAVE FITTED BY A QUALIFIED TECHNICIAN.**

PLEASE NOTE THAT THE WAY THE KIT IS PACKED DOES NOT NECESSARILY REPRESENT THE WAY OF
MOUNTING TO THE BIKE.

IN THE EVENT OF RUBBER WASHERS BEING USED TO HOLD COMPONENTS ONTO BOLTS,
THESE RUBBER WASHERS CAN BE THROWN AWAY.

DIGITAL COPIES OF THESE INSTRUCTIONS ARE AVAILABLE FROM:

WWW.RG-RACING.COM

R&G Racing
Unit 1, Shelley's Lane, East Worldham, Alton, Hampshire, GU34 3AQ
Tel: +44 (0)1420 89007 Fax: +44 (0)1420 87301 www.rg-racing.com Email: info@rg-racing.com



<u>TOOLS REQUIRED</u>	<u>GENERAL TORQUE SETTINGS</u>
<ul style="list-style-type: none"> 13mm SPANNER 13mm SOCKET & WRENCH T40 TORX TOOL 	M4 BOLT = 8Nm M5 BOLT = 12Nm M6 BOLT = 15Nm M8 BOLT = 20Nm M10 BOLT = 40Nm M12 BOLT = 40Nm

LEGEND

ITEM NO.	DESCRIPTION	QTY
ITEM 1	SMW0183 LHS LUGGAGE RACK	1
ITEM 2	SMW0183 RHS LUGGAGE RACK	1
ITEM 3	SMW0185 LHS MOUNTING BRACKET	1
ITEM 4	SMW0186 RHS MOUNTING BRACKET	1
ITEM 5	S1314 MOUNTING SPACER	4
ITEM 6	M8 x 1.25 x 80.00mm HEX HEAD BOLT (UPPER MOUNTS)	4
ITEM 7	M8 x 1.25 x 20mm HEX HEAD BOLT (LOWER MOUNTS)	2
ITEM 8	M8 x 1.25 x 25mm HEX HEAD BOLT (FOOTREST MOUNTS)	4
ITEM 9	M8 x 1.25 NYLOC NUT	2
ITEM 10	M8 WASHER OD=19mm	12
ITEM 11	M8 HEX HEAD BOLT COVER/CAP	6

R&G Racing

Unit 1, Shelley's Lane, East Worldham, Alton, Hampshire, GU34 3AQ

Tel: +44 (0)1420 89007 Fax: +44 (0)1420 87301 www.rg-racing.com Email: info@rg-racing.com



LHS/RHS EXPLODED ASSEMBLY VIEW

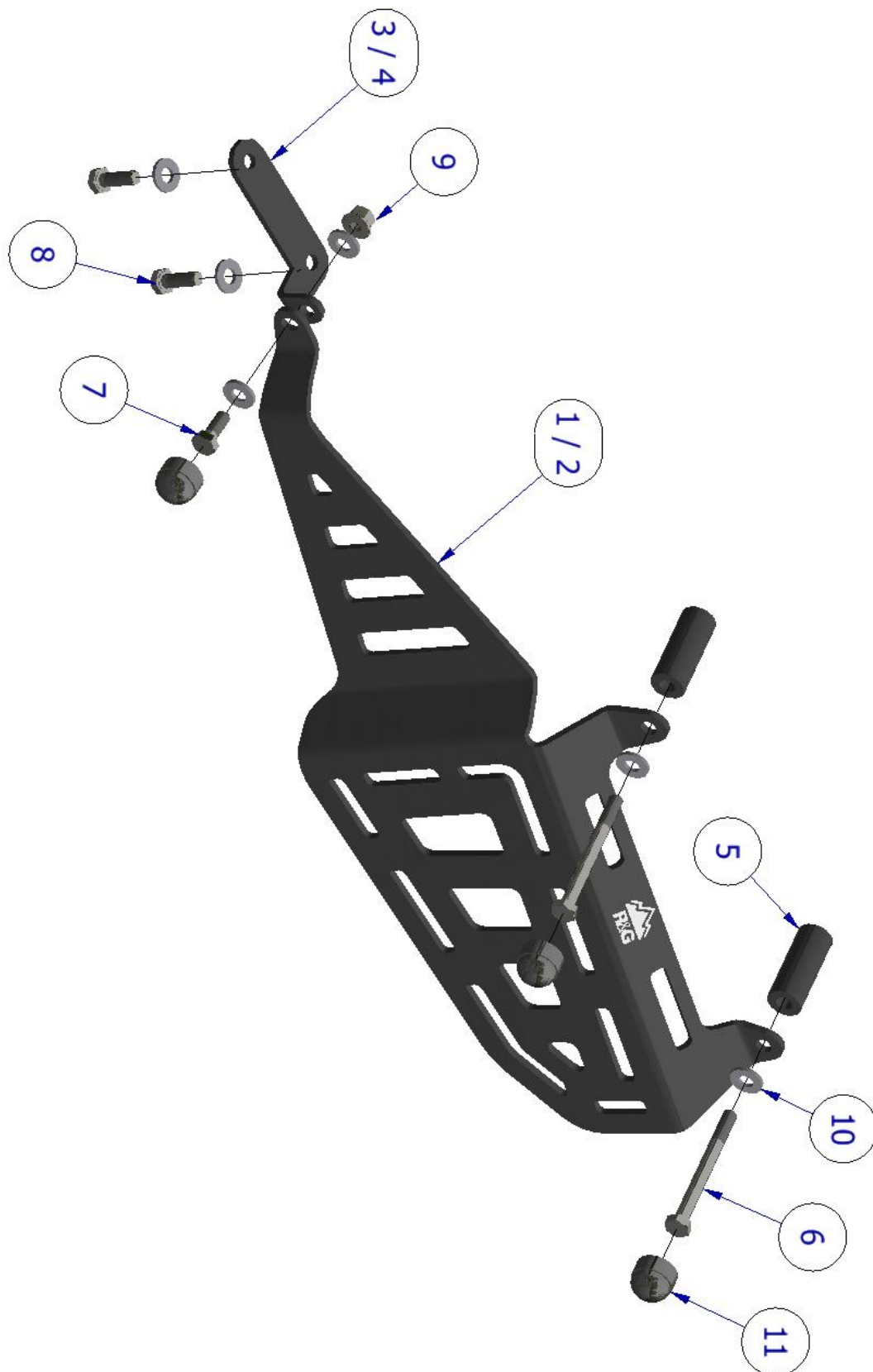

R&G Racing

Unit 1, Shelley's Lane, East Worldham, Alton, Hampshire, GU34 3AQ

Tel: +44 (0)1420 89007 Fax: +44 (0)1420 87301 www.rg-racing.com Email: info@rg-racing.com



FITTING PICTURES

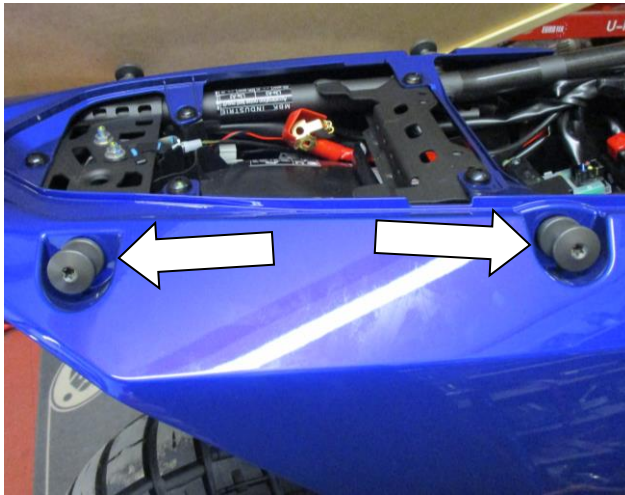

Picture 1



Picture 2



Picture 3



Picture 4



Picture 5



Picture 6



FITTING INSTRUCTIONS

- Remove the original hooks on both sides of the bike as shown in picture 1, using a T40 Torx tool.
- Remove both pillion footrests as shown in picture 2 (these can be re-fitted later, if desired).
- **If not re-fitting the footrests:** starting on the LHS of the bike, using a 13mm socket and wrench, fit the LHS mounting bracket **(item 3)** with 2 of the included M8 x 25mm bolts **(item 8)** and washers **(item 10)**, as shown in picture 3. The mounting tab should be pointing upwards and towards the rear of the bike, as shown in the diagram on page 3.
- **If re-fitting the footrests:** sandwich the LHS mounting bracket **(item 3)** between the mounting holes and the footrest mounting surface and secure with the original bolts.
- Slide a washer **(item 10)** over the 2x included longer M8 x 80mm bolts **(item 6)**, then slide through the upper mounting holes of the LHS luggage rack **(item 1)**. Place a spacer **(item 5)** over the exposed bolt length, then offer up to the original hook mounting holes, as shown in picture 4. Tighten the bolts using a 13mm socket and wrench, to give a structure as shown in picture 5.
- Align the lower mounting hole of the luggage rack with the tab hole of the mounting bracket previously fitted, then secure together using one of the included M8 x 20mm bolts **(item 7)**, washers **(item 10)** and M8 Nyloc nuts **(item 9)**. Tighten using a 13mm socket and wrench, whilst holding the nut with a 13mm spanner, as shown in picture 6.
- Repeat previous steps for the RHS of the bike, then fully tighten all bolts. Finally, fit a bolt cap **(item 11)** to each of the bolt heads.
- Fit your choice of soft luggage, securing to the racks using suitable straps if required.
- **If fitting particularly large/long luggage that overhangs the racks, you will additionally need to fit an R&G exhaust heat shield (product code - ESG0002BK) to prevent the luggage from contacting the exhaust silencer during use.**

Before riding with luggage fitted, ensure that all luggage is fully secured and will not contact any part of the chain or exhaust silencer during use.

Failure to do so will result in damage to the luggage and bike and may cause serious injury or death.