



FITTING INSTRUCTIONS FOR LP0346 LICENCE PLATE BRACKET



This kit contains the items pictured and labelled over page.

Some parts may be shown for clarity of instructions only.

Do not proceed until you are sure all parts are present.

Please read all instructions before proceeding.

**IF IN ANY DOUBT WHEN FITTING OUR PRODUCTS, CONSULT ONE OF OUR DEALERS
OR HAVE FITTED BY A QUALIFIED TECHNICIAN.**

Please note that the way the kit is packed does not necessarily represent the way of mounting to the bike.

In the event of rubber washers being used to hold components onto bolts, these rubber washers can be thrown away.

DIGITAL COPIES OF THESE INSTRUCTIONS ARE AVAILABLE FROM

WWW.RG-RACING.COM

R&G

Unit 1, Shelley's Lane, East Worldham, Alton, Hampshire, GU34 3AQ

Tel: +44 (0)1420 89007 Fax: +44 (0)1420 87301 www.rg-racing.com Email: info@rg-racing.com



<u>TOOLS REQUIRED</u>	<u>GENERAL TORQUE SETTINGS</u>
<ul style="list-style-type: none"> • Set of metric Hex keys to include 3mm, 4mm and 5mm. <ul style="list-style-type: none"> • T30 Torx head tool • Set of metric sockets and wrench. To include 6, 8 & 10mm. <ul style="list-style-type: none"> • 8mm & 10mm spanners. • Phillips screwdriver. 	M4 BOLT = 8Nm M5 BOLT = 12Nm M6 BOLT = 15Nm M8 BOLT = 20Nm M10 BOLT = 40Nm M12 BOLT = 40Nm

LEGEND

ITEM No.	DESCRIPTION	QTY
ITEM 1	TB0346 PART 1 LICENCE PLATE BRACKET	1
ITEM 2	TB0346 PART 2 LICENCE PLATE SUPPORT	1
ITEM 3	LA0011 SMALL SMOKED TAILLIGHT	1
ITEM 4	RB0013 G10-RSB320-40-00F RUBBER GROMMET	1
ITEM 5	M6x1.0x25mm BUTTON HEAD BOLT	10
ITEM 6	M6x12mm OD WASHER	20
ITEM 7	M6x1.0mm NYLOC NUTS	10
ITEM 8	666-896 150mm LENGTH OF HEAT-SHRINK	3
ITEM 9	CT100BK 2.5x100mm LONG CABLE TIES	3
ITEM 10	REFL 3 REFLECTOR	1
ITEM 11	RGS0002 SMALL STICKERS	2
ITEM 12	CON0040 TAILLIGHT ILLUMINATOR CONNECTOR	1
ITEM 13	M4x0.75x6mm BUTTON HEAD BOLT	

R&G

Unit 1, Shelley's Lane, East Worldham, Alton, Hampshire, GU34 3AQ

Tel: +44 (0)1420 89007 Fax: +44 (0)1420 87301 www.rg-racing.com Email: info@rg-racing.com



ASSEMBLY DIAGRAM 1

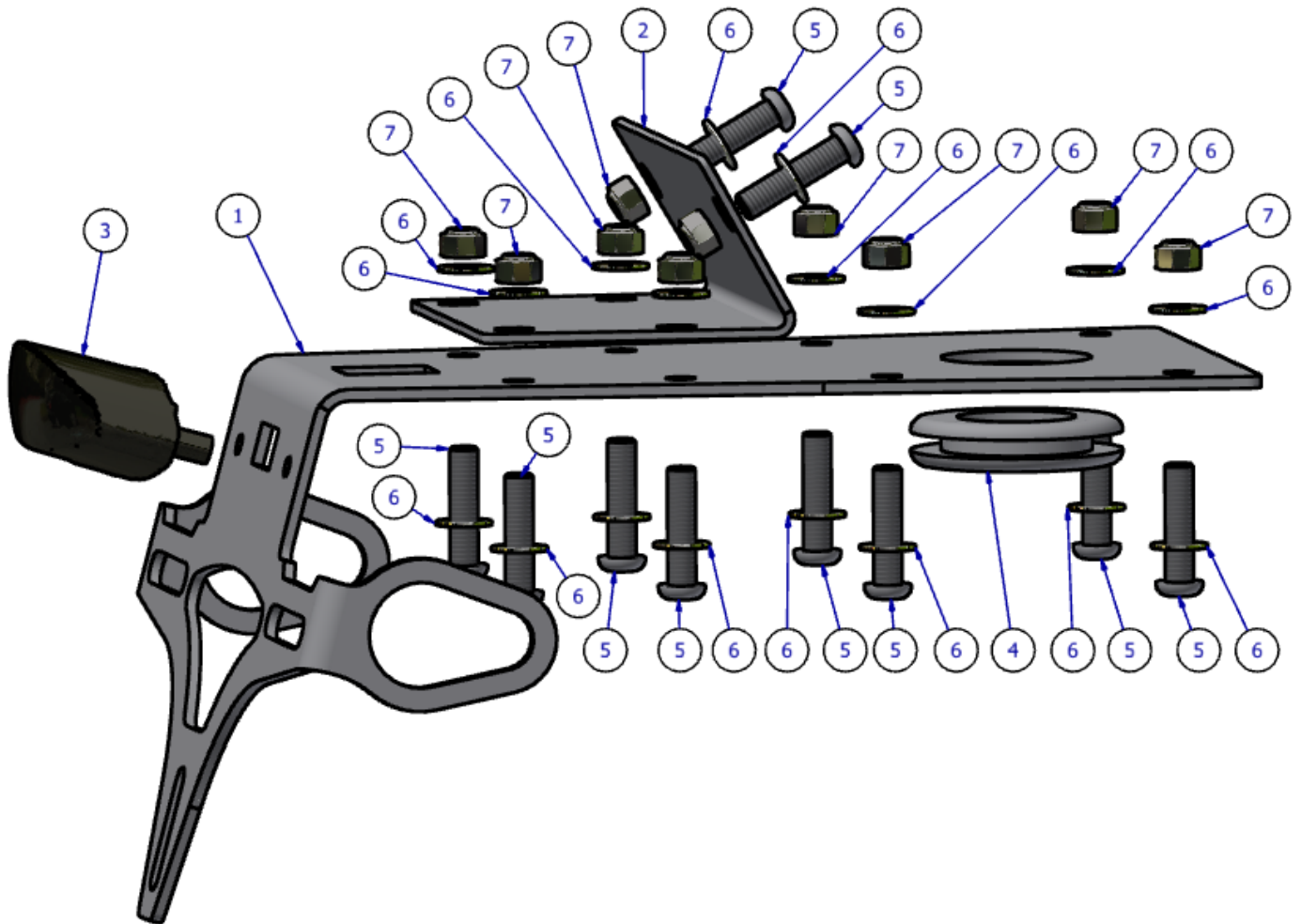

R&G

Unit 1, Shelley's Lane, East Worldham, Alton, Hampshire, GU34 3AQ

Tel: +44 (0)1420 89007 Fax: +44 (0)1420 87301 www.rg-racing.com Email: info@rg-racing.com



ASSEMBLY DIAGRAM 2

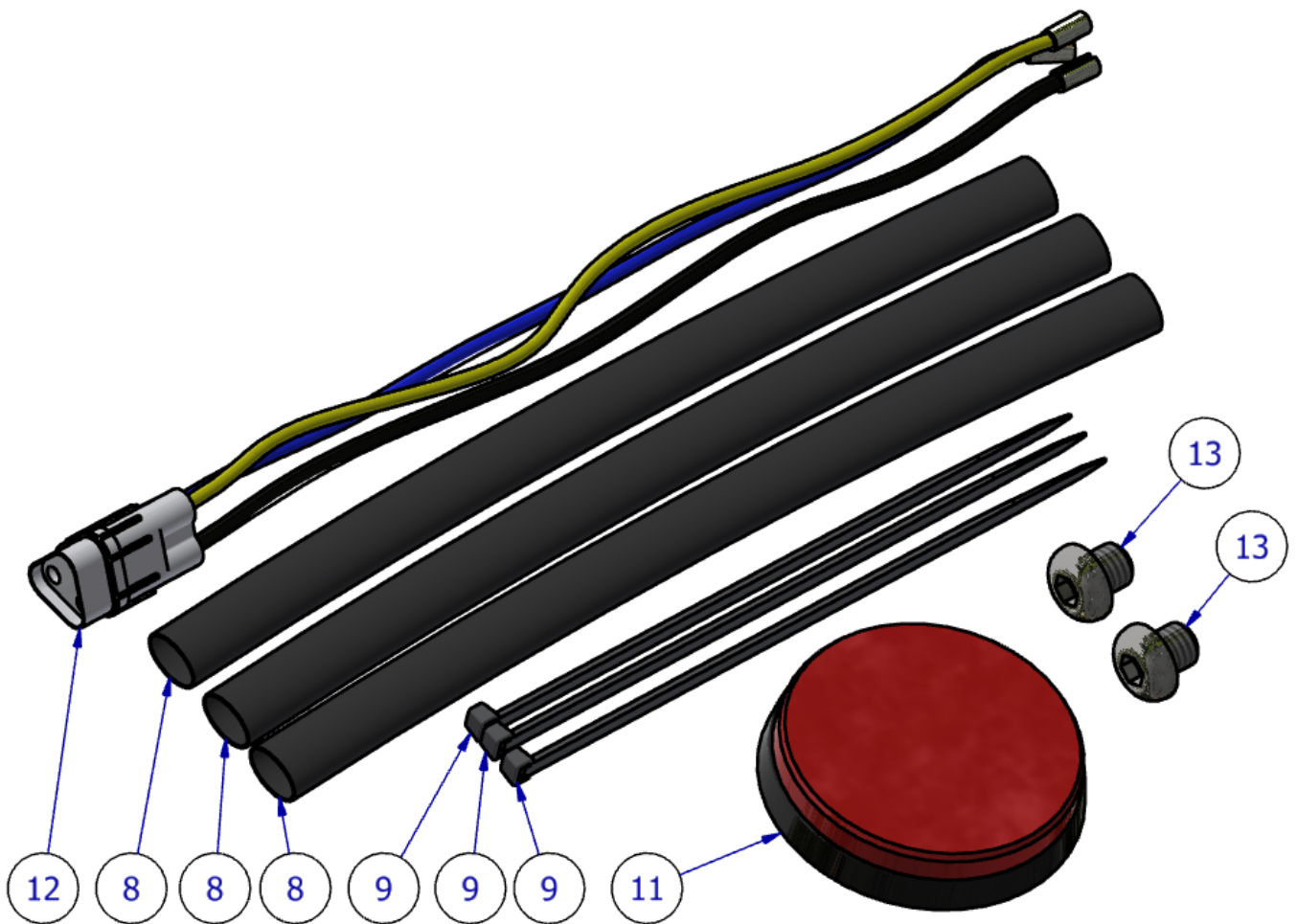



FITTING PICTURES



PICTURE 1



PICTURE 2

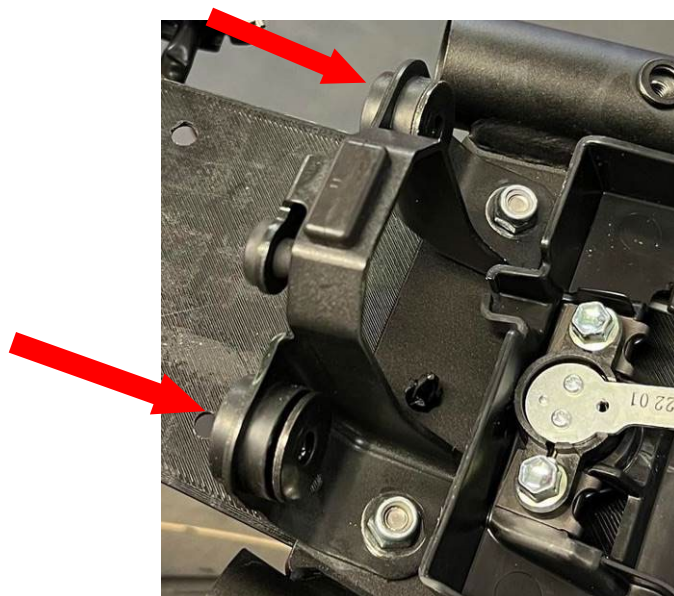

PICTURE 3



FITTING INSTRUCTIONS

Before fitting the R&G tail tidy you will need to remove some OEM parts. Below is a suggested list of parts to be removed.

- Seat
- Seat latch cover plate
- Unplug indicator's, number plate light and brake light wires
- OEM number plate bracket
- OEM indicators (re-use all components with Tail Tidy)
- Unplug indicator and number plate light wires
- OEM brake light (leave the rubber/ metal spacer in the mount)
- Brake light lower bump stop.

Tail Tidy Assembly

Before assembling this product, ensure all the components within the box are correct by comparing the **legend** and **diagrams**.

1. To start the assembly process, connect (**ITEM 1**) and (**ITEM 2**) together using x4 (**ITEM 5**) (**ITEM 7**) and x8 (**ITEM 6**). As shown in **DIAGRAM 1**.

DO NOT FULLY TIGHTEN AT THIS STAGE

2. Before the Rubber grommet (**ITEM 4**) can be mounted, you will need to cut a small cross into the centre of the flat face to make an access hole for the key to enter.
3. Now place the Rubber Grommet (**ITEM 4**) through the Licence plate bracket (**ITEM 1**) with the hole facing towards the top of the bike, as shown in **DIAGRAM 1**.
4. Apply the Heat shrink (**ITEM 8**) to the Small smoked taillight (**ITEM 3**) wires.
5. Next, mount the Small smoked taillight (**ITEM 3**) To the end of the licence plate bracket (**ITEM 1**). To do so use the M4x0.75x6mm Button head bolts (**ITEM 13**).

MAKE SURE (ITEM 3) WIRES ARE SLOTTED THROUGH THE TWO SQUARES SO THE WIRES ARE ON THE TOP SIDE OF THE TAIL TIDY AS SHOWN IN PICTURE 2

6. Now the assembly is ready to be mounted to the motorbike. To do so you will need x4 (**ITEM 5**) (**ITEM 7**) and x8 (**ITEM 6**). Use **DIAGRAM 1** to assist with where each ITEM goes.

MAKE SURE TO SLOT x1 WASHER (ITEM 6) ONTO ALL BOLTS (ITEM 5) BEFORE MOUNTING.

R&G

Unit 1, Shelley's Lane, East Worldham, Alton, Hampshire, GU34 3AQ

Tel: +44 (0)1420 89007 Fax: +44 (0)1420 87301 www.rg-racing.com Email: info@rg-racing.com



Now place the Tail tidy into the same mounting holes as the OEM number plate bracket and tighten the nuts and bolts to the correct torques settings using the **GENERAL TORQUE SETTINGS** on **page 2.**

7. The next step is to connect the Licence plate support (**ITEM 2**) to the OEM brake light mount. You will need x2 (**ITEM 5**) (**ITEM 6**) and (**ITEM 7**). Place the bolts (**ITEM 5**) with the washer (**ITEM 6**) placed over, through the OEM washer that is still connected to the motorbike and then through the Licence plate support (**ITEM 2**) and tighten it down with a nut (**ITEM 7**). Use **PICTURE 3** for an example of where the OEM brake light mount is located.

Tighten the nuts and bolts to the correct torques settings using the **GENERAL TORQUE SETTINGS** on **page 2.**

8. Connect Taillight illuminator connector (**ITEM 12**) to the Small smoked taillight (**ITEM 3**) wires as shown in **PICTURE 1.**

9. Now tighten the Licence plate bracket (**ITEM 1**) and Licence plate support (**ITEM 2**) together as step (**1.**) originally stated not to tighten.

10. Fit the OEM indicators into the new Tail tidy assembly and place the wires through the square hole as shown in **PICTURE 2.** Then plug them back into the OEM connectors. (Cable ties (**ITEM 9**) can be used to tidy the cables underneath the seat).

ENSURE INDICATORS ARE CORRECT WAY AROUND.

11. Final step, re-install all OEM parts except from the OEM Number Plate Bracket and OEM Brake Light. (The reflector (**ITEM 11**) is within the kit in case a new number plate is required).

IMPORTANT: IF FITTING A FULL-SIZE LICENCE PLATE AND PLACING IT LOW DOWN ON THE LICENCE PLATE MOUNT, THERE IS A POTENTIAL CHANCE THE LICENCE PLATE COULD HIT THE BACK WHEEL UNDER HEAVY LOAD AND OVER LARGE BUMPS IN THE ROAD. IT IS YOUR RESPONSIBILITY TO CHECK FOR THIS POSSIBILITY AND TAKE AVOIDING ACTION. FAILURE TO CHECK THIS COULD RESULT IN SERIOUS INJURY.

ISSUE 1 10/10/2022 (JH)

CONSUMER NOTICE

The catalogue description and any exhibition of samples are only broad indications of the Products and R&G may make design changes which do not diminish their performance or visual appeal and supplying them in such state shall conform to the order. The Buyer acknowledges no representation or warranty (other than as to title) has been given or will apply to the Products other than those in R&G's order or confirmation and the Buyer confirms it has chosen the Products as being of merchantable quality and suitable for its particular purposes. Where R&G fits the Products or undertakes other services it shall exercise reasonable skill and care and rectify any fault free of charge unless the workmanship has been disturbed. The Buyer is responsible for ensuring that the warranty on the motorcycle is not affected by the fitting of the Products. On return of any defective Products R&G shall at its option either supply a replacement or refund the purchase money but shall not be liable if the Products have been modified or used or maintained otherwise than in accordance with R&G's or manufacturer's instructions and good engineering practice or if the defect arises from accident or neglect. Other than identified above and subject to R&G not limiting its liability for causing death and personal injury, it shall not be liable for indirect or consequential loss and otherwise its liability

R&G

Unit 1, Shelley's Lane, East Worldham, Alton, Hampshire, GU34 3AQ

Tel: +44 (0)1420 89007 Fax: +44 (0)1420 87301 www.rg-racing.com Email: info@rg-racing.com