



FITTING INSTRUCTIONS FOR CG0026
CHAIN GUARD



THIS KIT CONTAINS THE ITEMS PICTURED AND LABELLED OVER PAGE.

SOME PARTS MAY BE SHOWN FOR CLARITY OF INSTRUCTIONS ONLY.

DO NOT PROCEED UNTIL YOU ARE SURE ALL PARTS ARE PRESENT.

PLEASE READ ALL INSTRUCTIONS BEFORE PROCEEDING.

**IF IN ANY DOUBT WHEN FITTING OUR PRODUCTS, CONSULT ONE OF OUR DEALERS
OR HAVE FITTED BY A QUALIFIED TECHNICIAN.**

PLEASE NOTE THAT THE WAY THE KIT IS PACKED DOES NOT NECESSARILY REPRESENT THE WAY OF
MOUNTING TO THE BIKE.

IN THE EVENT OF RUBBER WASHERS BEING USED TO HOLD COMPONENTS ONTO BOLTS,
THESE RUBBER WASHERS CAN BE THROWN AWAY.

DIGITAL COPIES OF THESE INSTRUCTIONS ARE AVAILABLE FROM:

WWW.RG-RACING.COM

R&G Racing
Unit 1, Shelley's Lane, East Worldham, Alton, Hampshire, GU34 3AQ
Tel: +44 (0)1420 89007 Fax: +44 (0)1420 87301 www.rg-racing.com Email: info@rg-racing.com



<u>TOOLS REQUIRED</u>	<u>GENERAL TORQUE SETTINGS</u>
<ul style="list-style-type: none"> • 3mm, 4mm & 5mm A/F ALLEN TOOLS • 10mm A/F SPANNER 	<p>M4 BOLT = 8Nm</p> <p>M5 BOLT = 12Nm</p> <p>M6 BOLT = 15Nm</p> <p>M8 BOLT = 20Nm</p> <p>M10 BOLT = 40Nm</p> <p>M12 BOLT = 40Nm</p>

LEGEND

ITEM NO.	DESCRIPTION	QTY
ITEM 1	SMW0216 - 3mm ALUMINIUM BLACK CHAIN GUARD	1
ITEM 2	SMW0217 - 1.5mm BRUSHED STAINLESS COVER PLATE	1
ITEM 3	S0456 – FORWARD MOUNT SPACER	1
ITEM 4	M6x12mm – HEX HEAD BOLT	2
ITEM 5	M5x6mm – BUTTON HEAD BOLT	2
ITEM 6	M5x10mm – FLAT WASHER	2
ITEM 7	M6x12mm – FLAT WASHER	2

EXPLODED ASSEMBLY VIEW

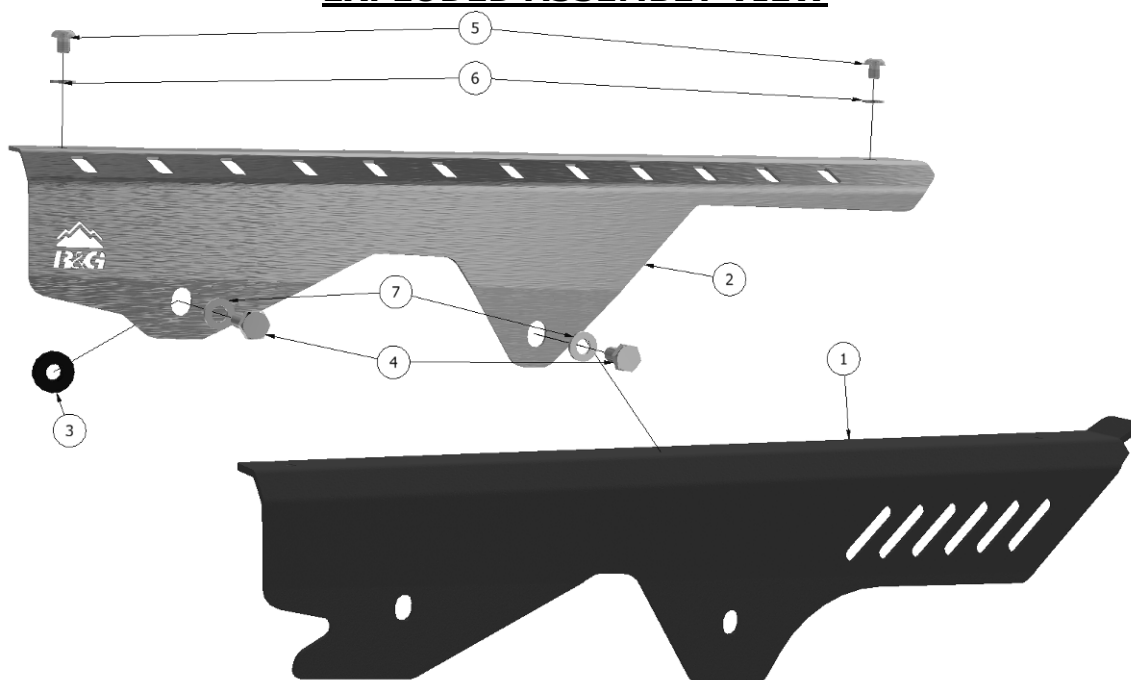



FITTING PICTURES

Picture 1

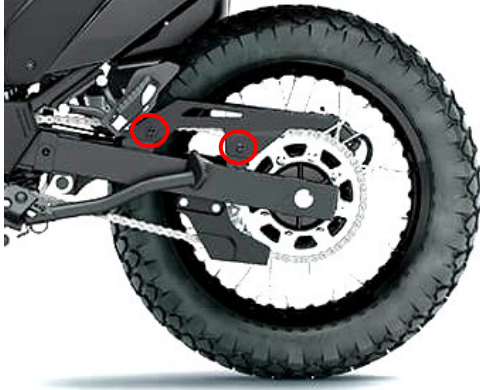

Picture 2



Picture 3

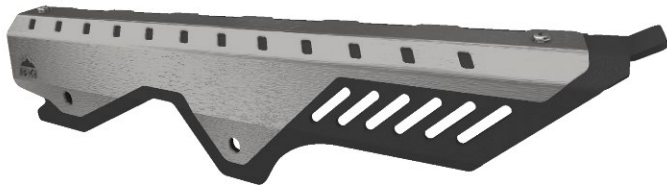

Picture 4



FITTING INSTRUCTIONS

- 1) Remove the plastic OEM chain guard by removing the two bolts shown in **Picture 1**.
- 2) Assemble the chain guard as shown in **Picture 2** by placing the stainless steel cover plate over the black aluminium chain guard.
 - a) Then place the M5 washers (**Item 6**) over the M5x6mm button head bolts (**Item 5**) and thread through the steel cover plate and into the aluminium chain guard.
 - b) The assembly should now resemble **Picture 3**.
- 3) Place the M6 washers (**Item 7**) over the M6 hex head bolts (**Item 4**) and apply a small amount of thread locking compound to the bolt threads.
 - a) Offer up the chain guard assembly to the motorcycle and thread in the M6 bolts.
 - b) Check the distance between the chain guard and the tyre, if wider/off road tyres are fitted the 3mm spacer may need to be fitted to increase the distance between the edge of tyre and the chain guard.

Please note: Remember to check the torque setting and distance to the tyre/chain regularly, when performing routine maintenance (cleaning chain/servicing).

See more R&G products for your Motorcycle in the link below:

[R&G Racing | All Products for Kawasaki - KLR 650 \(2022\) \(rg-racing.com\)](http://www.rg-racing.com)

ISSUE 1 - 03/01/2023 (TB)