



**FITTING INSTRUCTIONS FOR FE0320 LICENCE PLATE BRACKET**



**This kit contains the items pictured and labelled over page.  
Some parts may be shown for clarity of instructions only.  
Do not proceed until you are sure all parts are present.  
Please read all instructions before proceeding.**

**IF IN ANY DOUBT WHEN FITTING OUR PRODUCTS, CONSULT ONE OF OUR DEALERS  
OR HAVE FITTED BY A QUALIFIED TECHNICIAN.**

Please note that the way the kit is packed does not necessarily represent the way of mounting to the bike.

In the event of rubber washers being used to hold components onto bolts, these rubber washers can be thrown away.

**DIGITAL COPIES OF THESE INSTRUCTIONS ARE AVAILABLE FROM**

**[WWW.RG-RACING.COM](http://WWW.RG-RACING.COM)**



<b>TOOLS REQUIRED</b>	<b>GENERAL TORQUE SETTINGS</b>
<ul style="list-style-type: none"> <li>• Set of Torx keys or bits including T20, T25, T30.</li> <li>• Set of metric Allen keys to include 3, 4, 5 &amp; 6mm</li> <li>• 6 &amp; 8mm spanner or socket.               <ul style="list-style-type: none"> <li>• Phillips screwdriver.</li> </ul> </li> <li>• Small flat head screwdriver.</li> </ul>	<p>M4 BOLT = 8Nm</p> <p>M5 BOLT = 12Nm</p> <p>M6 BOLT = 15Nm</p> <p>M8 BOLT = 20Nm</p> <p>M10 BOLT = 40Nm</p> <p>M12 BOLT = 40Nm</p>

### **LEGEND**

<b>ITEM No.</b>	<b>DESCRIPTION</b>	<b>QTY</b>
ITEM 1	FEP0320BK PART 3 – LICENCE PLATE BRACKET	1
ITEM 2	LA0002 - NUMBER PLATE LIGHT ASSEMBLY	1
ITEM 3	FEP0320BK PART 1 – MAIN BRACKET RHS	1
ITEM 4	FEP0320BK PART 2 – MAIN BRACKET LHS	1
ITEM 5	S1360 – MOUNTING SPACERS	4
ITEM 6	150mm LENGTH OF HEATSHRINK	1
ITEM 7	M5x0.8x10.0 mm COUNTER SUNK SCREWS	4
ITEM 8	M5x10mm WASHERS	4
ITEM 9	M5x0.8 NYLOC NUTS	4
ITEM 10	M6x1.0x15mm BUTTON HEAD SCREWS	2
ITEM 11	M6 X 12MM WASHER	2
ITEM 12	M6x19mm WASHER	4
ITEM 13	CON0065 - LICENCE PLATE ILLUMINATOR CONNECTOR (CON0014 FOR 2025- 1200 RX)	1
ITEM 14	M6 NYLOC NUTS	2
ITEM 15	2.5mm CABLE TIES	4
ITEM 16	CLIP 1 – SELF ADHEISIVE CABLE CLIPS	2
ITEM 17	REFL 3 - REFLECTOR	1



**ASSEMBLY DIAGRAM**

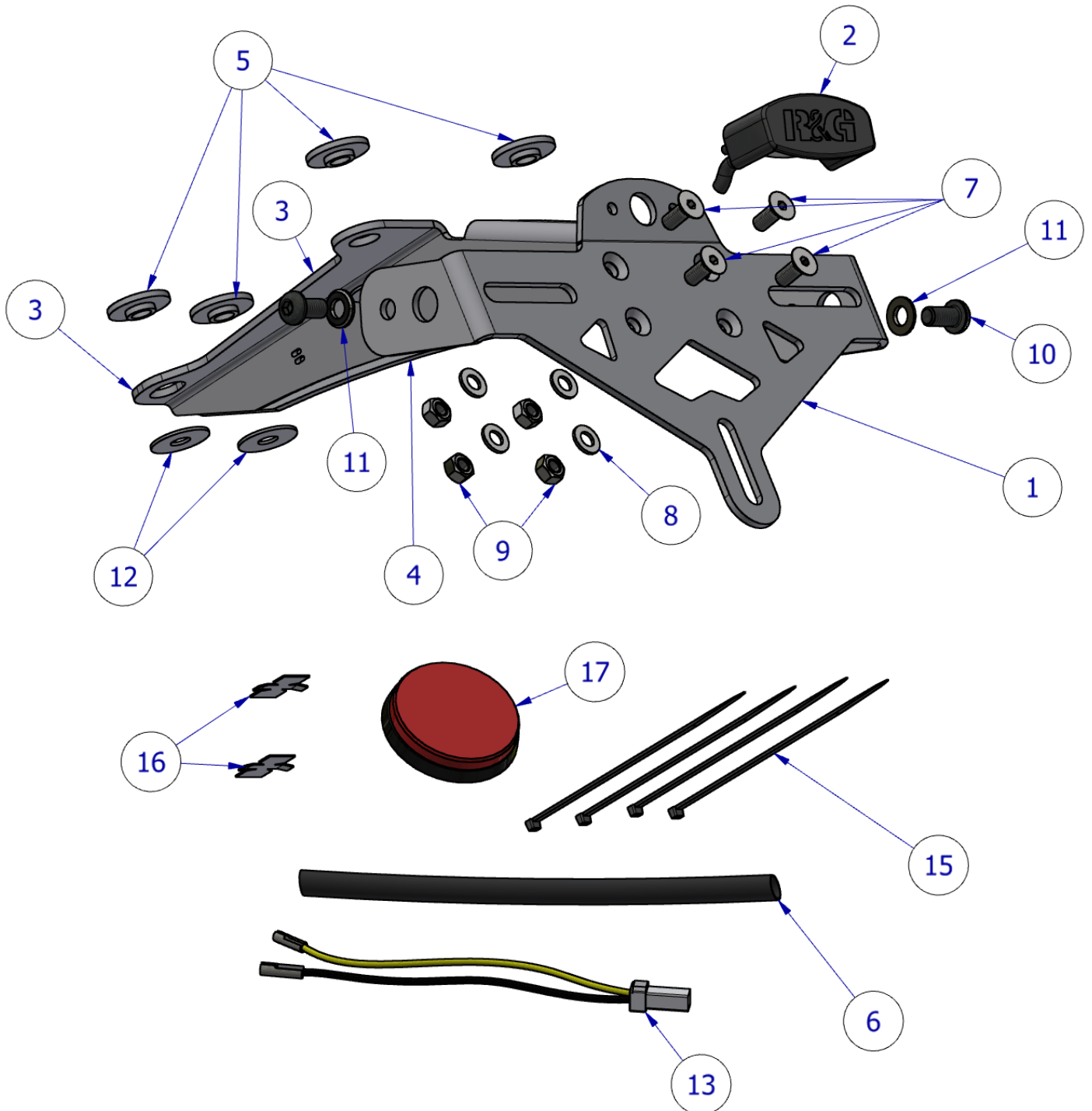



**FITTING PICTURES**



Picture 1



Picture 2



Picture 3



Picture 4

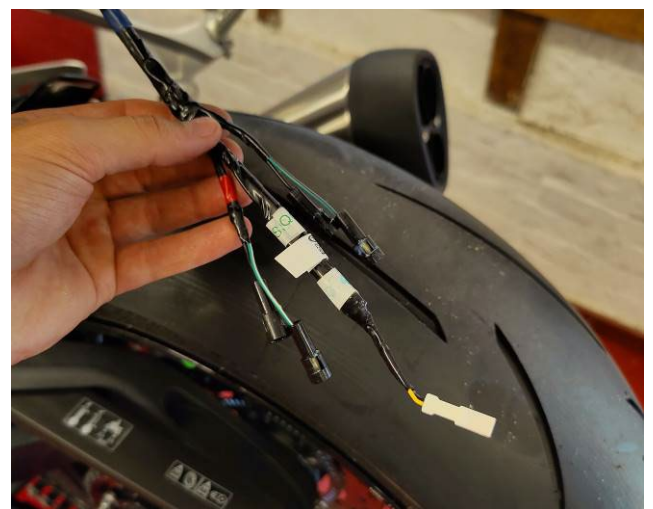



Picture 5

Picture 6



Picture 7

Picture 8

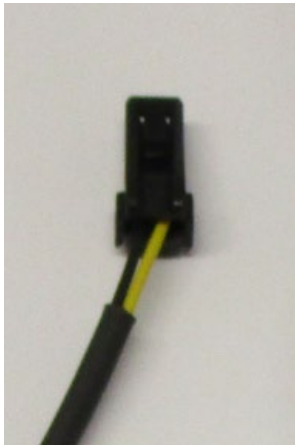

Picture 9

Picture 10



Picture 11



## **FITTING INSTRUCTIONS**

- Begin by unscrewing the bolts securing the OEM licence plate holder to the tail unit of the bike with a T20 Torx driver as shown in **Picture 1**.
- This will leave the licence plate holder loose and connected only by the indicator wires, keep the licence plate holder supported so that the wires are not damaged as shown in **picture 2**.
- Gently pull the plastic cover piece to remove it as shown in **Picture 3**.
- This will expose the 2 screws shown in **Picture 4**. These must be removed using a T20 Torx drive to separate the 2 halves of the licence plate holder.
- The remaining plastic covers can now be carefully removed.
- With the indicator and illuminator connectors exposed as shown in **Picture 5**, disconnect these, and remove the OEM licence plate holder, leaving the wires shown in **Picture 6**. (Take note of which indicators are connected to the left and right sides as these will need to be reconnected correctly when re-connecting the R&G tail tidy.)
- To fit the OEM indicators, remove the bolts holding these to the licence plate holder and unthread the wires to free them. Ensuring these are installed on the correct sides, these can then be secured to the R&G Tail Tidy using the M6 screws and Nyloc nuts provided (**items 10 & 11**).
- Assemble the R&G tail tidy as shown in **Picture 7** and the **Assembly Diagram** by using the M5 countersunk screws, M5 washers and M5 Nyloc nuts fasteners provided. ensure the nuts are tight.
- Attach the R&G licence plate illuminator (**Item 2**) as shown in **Picture 8**.
- Use the heat shrink provided (**item 6**) to seal the licence plate illuminator wires.
- Insert the 4 spacers (**Item 5**) into the mounting holes as shown in **Assembly diagram** ensuring that the flat sides face upwards.
- Connect CON0065 Licence plate illuminator connector (**Item 13**) as shown on **Picture 9**, to the illuminator wires ensuring to connect black to black (CON0014 for 2025- 1200 RX).
- Reconnect the indicator and illuminator connectors to the wires protruding from the tail unit of the motorcycle. Ensure that the left and right indicators are connected correctly. (This can be checked by turning on the ignition and testing that they flash correctly.)
- Attach the R&G tail tidy to the tail unit of the motorcycle using the same 4 Torx screws which were removed from the OEM licence plate holder as well as the large M6 washers (**item 12**) provided as shown in **Picture 10**.
- The wires can be tidied up using the cable ties and cable tie slots in the tail tidy as shown in **Picture 11**.

**IMPORTANT: FOR SAFETY, ENSURE THE LICENCE PLATE IS PLACED AS HIGH AS POSSIBLE ON THE TAIL TIDY (IT MAY REQUIRE DRILLING). IF FITTING A LICENCE PLATE OF 200MM OR LONGER (INCLUDING ANY SHROUD OR REFLECTOR ATTACHMENT) TO THE BRACKET, BEFORE RIDING, FULLY COMPRESS THE SUSPENSION TO ENSURE NO PART OF THE ASSEMBLY CAN CONTACT THE TYRE WHILE THE VEHICLE IS IN MOTION OR UNDER LOAD. IT IS YOUR RESPONSIBILITY TO CHECK FOR THIS POSSIBILITY AND TAKE AVOIDING ACTION. FAILURE TO CHECK THIS COULD RESULT IN SERIOUS INJURY OR DAMAGE TO THE MOTORCYCLE.**

ISSUE 2 - 08/10/2025 - (MH)



### **CONSUMER NOTICE**

The catalogue description and any exhibition of samples are only broad indications of the Products and R&G may make design changes which do not diminish their performance or visual appeal and supplying them in such state shall conform to the order. The Buyer acknowledges no representation or warranty (other than as to title) has been given or will apply to the Products other than those in R&G's order or confirmation and the Buyer confirms it has chosen the Products as being of merchantable quality and suitable for its particular purposes. Where R&G fits the Products or undertakes other services it shall exercise reasonable skill and care and rectify any fault free of charge unless the workmanship has been disturbed. The Buyer is responsible for ensuring that the warranty on the motorcycle is not affected by the fitting of the Products. On return of any defective Products R&G shall at its option either supply a replacement or refund the purchase money but shall not be liable if the Products have been modified or used or maintained otherwise than in accordance with R&G's or manufacturer's instructions and good engineering practice or if the defect arises from accident or neglect. Other than identified above and subject to R&G not limiting its liability for causing death and personal injury, it shall not be liable for indirect or consequential loss and otherwise its liability shall be limited to the amounts paid by the Buyer for the Products or the fitting or service concerned. These terms do not affect the Buyer's statutory rights.

### **R&G RACING RETURNS POLICY (NON-FAULTY GOODS)**

Returns must be pre-authorized (if not pre-authorized the return will be rejected). Goods may only be returned direct to us if they were purchased direct from us (customer must prove if necessary). Otherwise to be returned to original vendor. Goods must be in re-sellable condition, in the opinion of R&G Racing. All returns are subject to a 25% restocking and handling fee (25% of the gross value exc. P&P – at the prevailing price at time of purchase). The customer must pay any and all carriage charges. No returns of discontinued products, unless within 14 days of purchase. This policy does not affect your statutory rights and does not refer to faulty goods.

Racing Technique Ltd T/A R&G

Unit 1, Shelley's Lane, East Worldham, Alton, Hampshire, GU34 3AQ

Tel: +44 (0)1420 89007 Fax: +44 (0)1420 87301 [www.rg-racing.com](http://www.rg-racing.com) Email: [info@rg-racing.com](mailto:info@rg-racing.com)