



**FITTING INSTRUCTIONS FOR GBP0003**  
**GRAB RAIL BLANKING PLATES**



**THIS KIT CONTAINS THE ITEMS PICTURED AND LABELLED OVER PAGE.**

SOME PARTS MAY BE SHOWN FOR CLARITY OF INSTRUCTIONS ONLY.

DO NOT PROCEED UNTIL YOU ARE SURE ALL PARTS ARE PRESENT.

**PLEASE READ ALL INSTRUCTIONS BEFORE PROCEEDING.**

**IF IN ANY DOUBT WHEN FITTING OUR PRODUCTS, CONSULT ONE OF OUR DEALERS  
OR HAVE FITTED BY A QUALIFIED TECHNICIAN.**

PLEASE NOTE THAT THE WAY THE KIT IS PACKED DOES NOT NECESSARILY REPRESENT THE WAY OF  
MOUNTING TO THE BIKE.

IN THE EVENT OF RUBBER WASHERS BEING USED TO HOLD COMPONENTS ONTO BOLTS,  
THESE RUBBER WASHERS CAN BE THROWN AWAY.

**DIGITAL COPIES OF THESE INSTRUCTIONS ARE AVAILABLE FROM:**

**[WWW.RG-RACING.COM](http://WWW.RG-RACING.COM)**



<b><u>TOOLS REQUIRED</u></b>	<b><u>GENERAL TORQUE SETTINGS</u></b>
<ul style="list-style-type: none"> <li>• 5mm A/F ALLEN TOOL</li> <li>• METRIC SOCKET SET</li> </ul>	<p>M4 BOLT = 8Nm</p> <p>M5 BOLT = 12Nm</p> <p>M6 BOLT = 15Nm</p> <p>M8 BOLT = 20Nm</p> <p>M10 BOLT = 40Nm</p> <p>M12 BOLT = 40Nm</p>

**LEGEND**

ITEM NO.	DESCRIPTION	QTY
ITEM 1	GRAB RAIL BLANKING PLATE LHS (SMW0222)	1
ITEM 2	GRAB RAIL BLANKING PLATE RHS (SMW0223)	1
ITEM 3	M8 x 1.25 x 16mm CAP HEAD BOLT	4
ITEM 4	M8 WASHER	4

**ASEMBLY DIAGRAM**

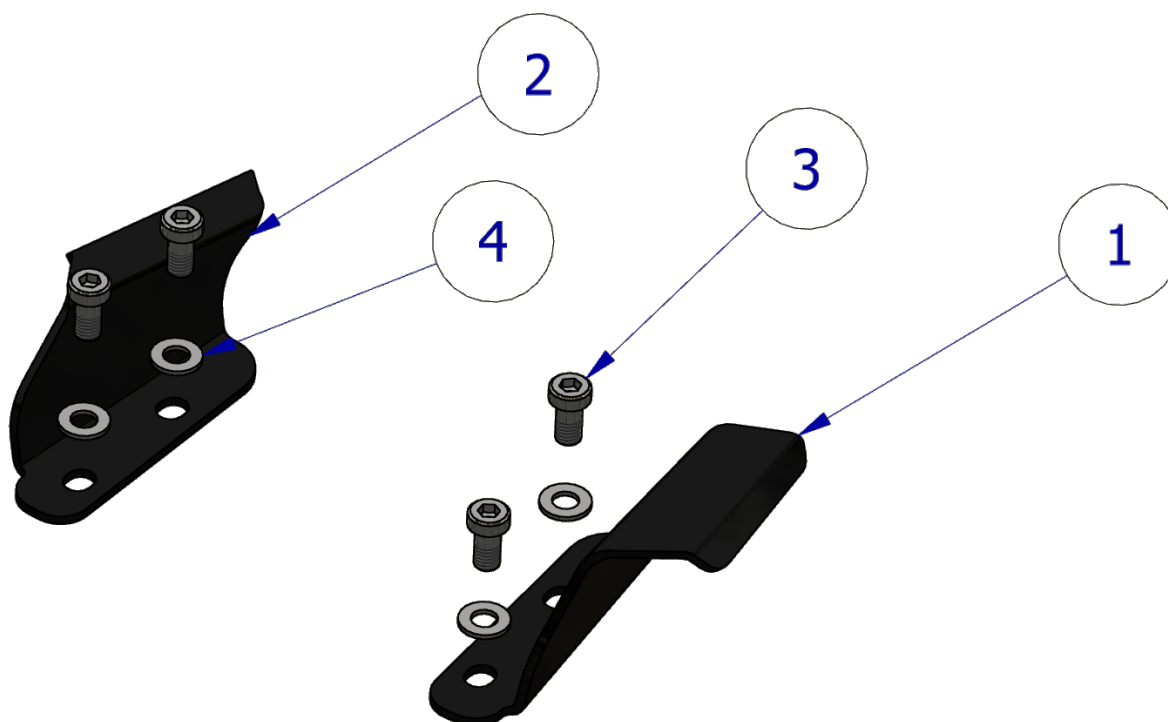



## FITTING PICTURES



Picture 1



Picture 2



Picture 3

## FITTING INSTRUCTIONS

- Remove the pillion seat, this will expose the 4 bolt covers shown in **Picture 1**.
- Remove the bolt covers and the 4 bolts (shown in **Picture 2**), this will release the OEM grab rail.
- Offer one of the blanking plates (**Items 1 & 2**) into position and secure with 2x M8 bolts (**Item 3**) and M8 washers (**Item 4**) as shown in **Picture 3**.
- Repeat for the opposite side.

**See more R&G products for your Motorcycle in the link below:**

[R&G Racing | All Products for Suzuki - GSX-S 1000 \(rg-racing.com\)](http://www.rg-racing.com)

R&G Racing

Unit 1, Shelley's Lane, East Worldham, Alton, Hampshire, GU34 3AQ

Tel: +44 (0)1420 89007 Fax: +44 (0)1420 87301 [www.rg-racing.com](http://www.rg-racing.com) Email: [info@rg-racing.com](mailto:info@rg-racing.com)