



**FITTING INSTRUCTIONS FOR LP0042BK LICENCE PLATE BRACKET
FOR HONDA CBR600 RR 20007-**



THIS KIT CONTAINS THE ITEMS PICTURED AND LABELLED OVER PAGE.

SOME PARTS MAY BE SHOWN FOR CLARITY OF INSTRUCTIONS ONLY.

DO NOT PROCEED UNTIL YOU ARE SURE ALL PARTS ARE PRESENT.

PLEASE READ ALL INSTRUCTIONS BEFORE PROCEEDING.

**IF IN ANY DOUBT WHEN FITTING OUR PRODUCTS, CONSULT ONE OF OUR DEALERS
OR HAVE FITTED BY A QUALIFIED TECHNICIAN.**

PLEASE NOTE THAT THE WAY THE KIT IS PACKED DOES NOT NECESSARILY REPRESENT THE WAY OF
MOUNTING TO THE BIKE.

IN THE EVENT OF RUBBER WASHERS BEING USED TO HOLD COMPONENTS ONTO BOLTS,
THESE RUBBER WASHERS CAN BE THROWN AWAY.

DIGITAL COPIES OF THESE INSTRUCTIONS ARE AVAILABLE FROM:

WWW.RG-RACING.COM

R&G

Unit 1, Shelley's Lane, East Worldham, Alton, Hampshire, GU34 3AQ

Tel: +44 (0)1420 89007 Fax: +44 (0)1420 87301 www.rg-racing.com Email: info@rg-racing.com



<u>TOOLS REQUIRED</u>	<u>GENERAL TORQUE SETTINGS</u>
<ul style="list-style-type: none"> • Set of metric Allen keys. • Metric socket set. • Cable cutters/pliers. 	M4 BOLT = 8Nm M5 BOLT = 12Nm M6 BOLT = 15Nm M8 BOLT = 20Nm M10 BOLT = 40Nm M12 BOLT = 40Nm

LEGEND

ITEM NO.	DESCRIPTION	QTY
ITEM 1	LICENCE PLATE BRACKET (TB0042)	1
ITEM 2	M6 NYLOC NUTS	2
ITEM 3	M6 LARGE WASHERS	4
ITEM 4	M6 x 20mm LONG BUTTON HEAD BOLTS	4
ITEM 5	M6 STANDARD WASHERS	2
ITEM 6	M6 x 15mm LONG BUTTON HEAD BOLTS	2
ITEM 7	COVER PLATE (TB0042 PART 2)	1
ITEM 8	REAR LIGHT SHROUD (LA0003 SHROUD)	1
ITEM 9	REAR LIGHT/LICENCE PLATE ILLUMINATOR ASSEMBLY	1
ITEM 10	150mm LENGTH OF HEATSHRINK	3
ITEM 11	SCOTCH BLOCK CONNECTORS	3
ITEM 12	REFLECTOR (REFL 3)	1

R&G

Unit 1, Shelley's Lane, East Worldham, Alton, Hampshire, GU34 3AQ

Tel: +44 (0)1420 89007 Fax: +44 (0)1420 87301 www.rg-racing.com Email: info@rg-racing.com

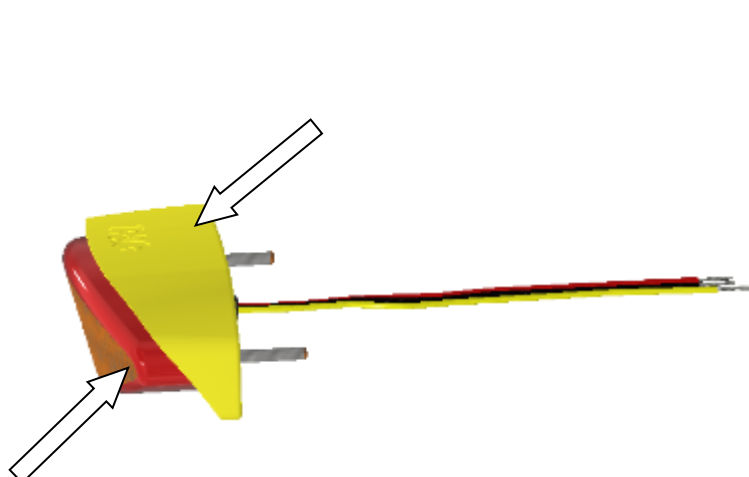
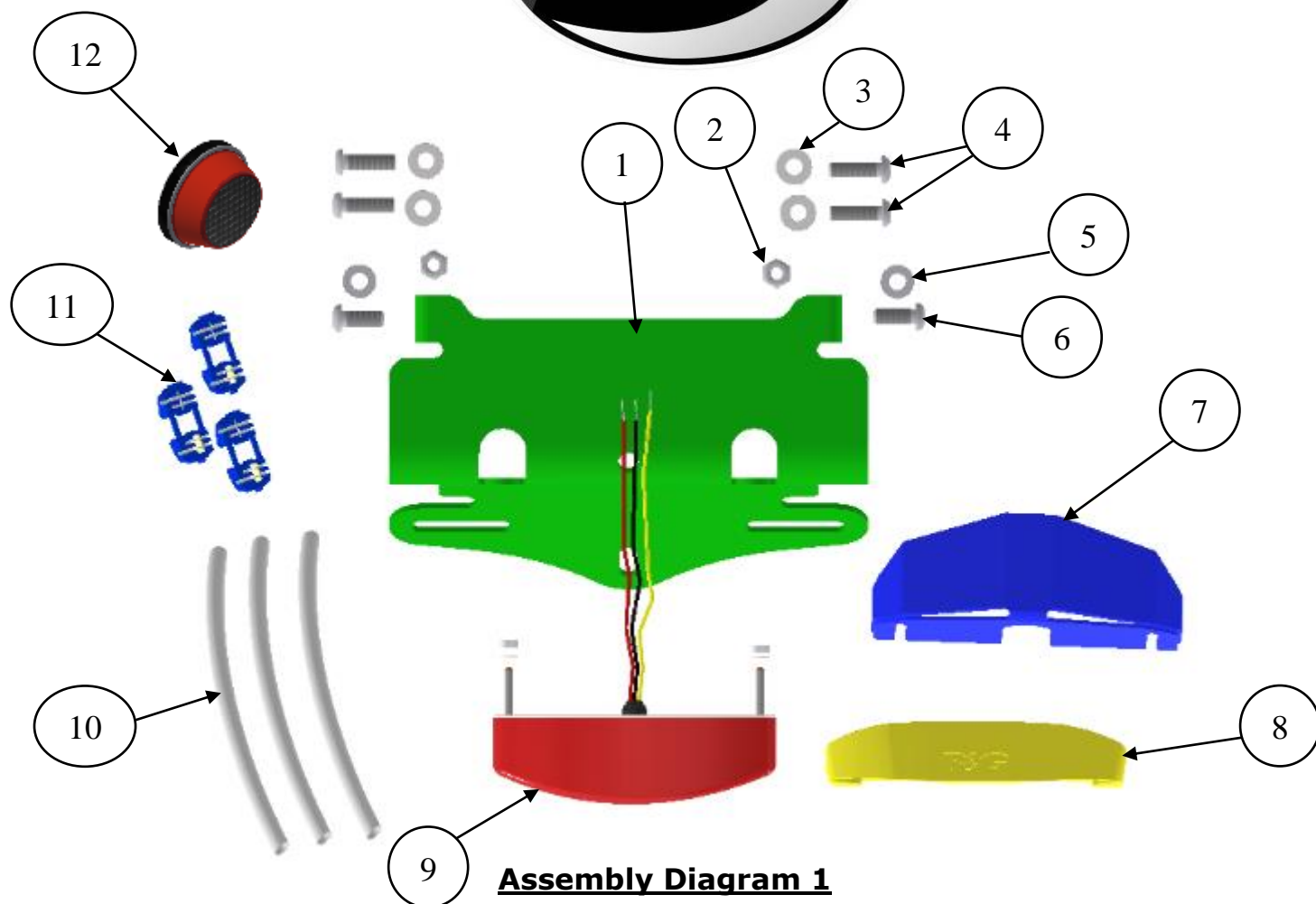

PICTURE 1

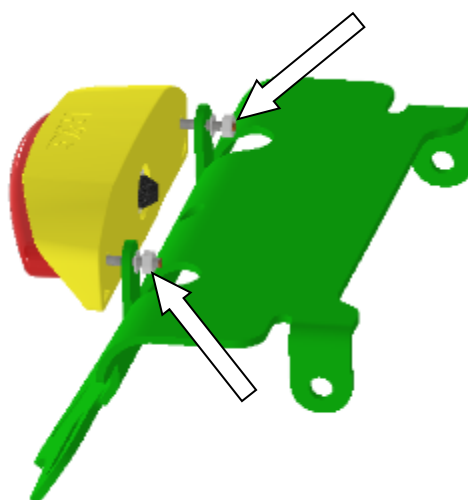

PICTURE 2

R&G

Unit 1, Shelley's Lane, East Worldham, Alton, Hampshire, GU34 3AQ

Tel: +44 (0)1420 89007 Fax: +44 (0)1420 87301 www.rg-racing.com Email: info@rg-racing.com

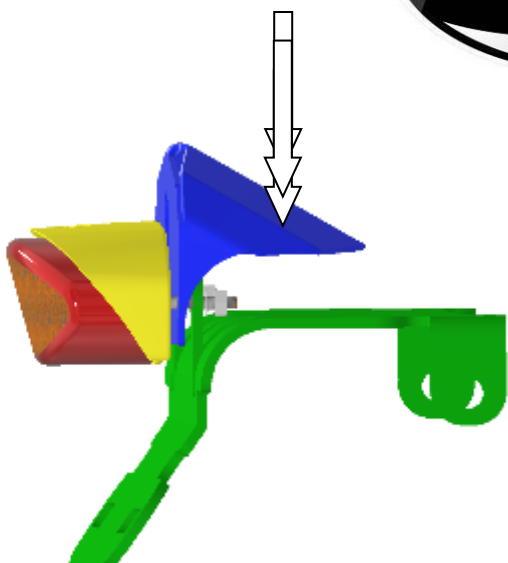

PICTURE 3

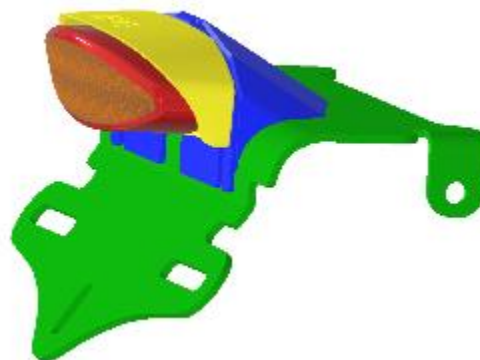

PICTURE 4

FITTING INSTRUCTIONS

- Remove both seats.
- Remove rear seat cowling.
- Disconnect wiring to original number plate unit.
- Undo the four bolts holding the original number plate unit to the subframe.
- Remove OEM indicators and rear light unit from original number plate unit.
- The OEM tail unit should be in three parts i.e.; two sides and one number plate hanger.
- Replace both side assemblies to sub-frame using longer supplied button head bolts and washers (**items 3 and 4**) but leave all bolts loose.
- Fit OEM or after-market indicators (we recommend R&G micro indicators - product code RG370) to OEM sides
- Fit the shroud (**item 8**) to the new rear light (**item 9**) as shown in **picture 1**.
- Place this assembly through the holes in the licence plate bracket (**item 1**) as shown in **picture 2**.
- Place the M3 nuts and washers onto the exposed threads as shown in **picture 2** (do not tighten at this stage) and feed the wires through the central hole.
- Please protect the wire with a length of heat shrink (**item 10**).
- Place the cover plate (**item 7**) between the shroud and the bracket as shown in **picture 3** and push down to the bracket as shown in **picture 4** and tighten the nuts.
- Offer new tail-tidy unit up between side panels.
- Using shorter button head bolts and smaller washers supplied (**items 5 and 6**) secure new tail-tidy to OEM sides using nyloc nuts supplied (**item 2**).
- Route indicator and new rear light wiring through clips provided as original.
- Reconnect indicator wiring, checking operation (Note: right side indicator has the ORANGE connector).
- Using scotch block connectors supplied (**item 11**), re-attach the rear light wiring (suggest cutting connector from OEM unit and splicing to R&G unit) as shown below.

New wires		OEM wires
Black	to	Black
Yellow	to	Black/White
Red	to	Black/Yellow

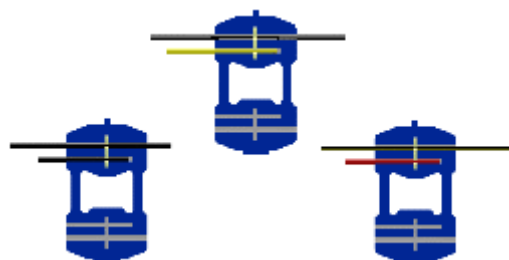

R&G

Unit 1, Shelley's Lane, East Worldham, Alton, Hampshire, GU34 3AQ

Tel: +44 (0)1420 89007 Fax: +44 (0)1420 87301 www.rg-racing.com Email: info@rg-racing.com



- **IMPORTANT: IF FITTING A FULL-SIZE LICENCE PLATE AND PLACING IT FAR DOWN ON THE LICENCE PLATE HANGER, THERE IS A SMALL CHANCE OF THE LICENCE PLATE HITTING THE BACK WHEEL UNDER HEAVY LOAD AND OVER LARGE BUMPS IN THE ROAD. IT IS YOUR RESPONSIBILITY TO CHECK FOR THIS POSSIBILITY AND TAKE AVOIDING ACTION. FAILURE TO CHECK THIS COULD RESULT IN SERIOUS INJURY.**
- Recheck that wires cannot contact the exhaust silencer.
- Tighten all bolts securing tail-tidy to sub-frame.
- Refit rear cowling.
- Refit seats.
- Depending on local laws, attach enclosed reflector (**item 12**) in an appropriate location.
- Test the indicators and licence plate illuminator before riding.
- **Please test the indicators, rear light and licence plate illuminator before riding.**

ISSUE 2 22/10/2019 (NSY)

CONSUMER NOTICE

The catalogue description and any exhibition of samples are only broad indications of the Products and R&G may make design changes which do not diminish their performance or visual appeal and supplying them in such state shall conform to the order. The Buyer acknowledges no representation or warranty (other than as to title) has been given or will apply to the Products other than those in R&G's order or confirmation and the Buyer confirms it has chosen the Products as being of merchantable quality and suitable for its particular purposes. Where R&G fits the Products or undertakes other services it shall exercise reasonable skill and care and rectify any fault free of charge unless the workmanship has been disturbed. The Buyer is responsible for ensuring that the warranty on the motorcycle is not affected by the fitting of the Products. On return of any defective Products R&G shall at its option either supply a replacement or refund the purchase money but shall not be liable if the Products have been modified or used or maintained otherwise than in accordance with R&G's or manufacturer's instructions and good engineering practice or if the defect arises from accident or neglect. Other than identified above and subject to R&G not limiting its liability for causing death and personal injury, it shall not be liable for indirect or consequential loss and otherwise its liability shall be limited to the amounts paid by the Buyer for the Products or the fitting or service concerned. These terms do not affect the Buyer's statutory rights.

R&G RETURNS POLICY (NON-FAULTY GOODS)

Returns must be pre-authorised (if not pre-authorised the return will be rejected). Goods may only be returned direct to us if they were purchased direct from us (customer must prove if necessary). Otherwise to be returned to original vendor. Goods must be in re-sellable condition, in the opinion of R&G. All returns are subject to a 25% restocking and handling fee (25% of the gross value exc. P&P – at the prevailing price at time of purchase). The customer must pay any and all carriage charges. No returns of discontinued products, unless within 14 days of purchase. This policy does not affect your statutory rights and does not refer to faulty goods.

R&G

Unit 1, Shelley's Lane, East Worldham, Alton, Hampshire, GU34 3AQ

Tel: +44 (0)1420 89007 Fax: +44 (0)1420 87301 www.rg-racing.com Email: info@rg-racing.com