



LP0197

**FITTING INSTRUCTIONS FOR LP0197BK LICENCE PLATE BRACKET**  
**YAMAHA XSR900 '16-**

Page | 1



**THIS KIT CONTAINS THE ITEMS PICTURED AND LABELLED BELOW.**  
**DO NOT PROCEED UNTIL YOU ARE SURE ALL PARTS ARE PRESENT.**

Please note that the way the kit is packed does not necessarily represent the way of mounting to the bike

THE PARTS SHOWN MAY BE REPRESENTATIVE ONLY (FOR CLARITY OF INSTRUCTIONS ONLY)

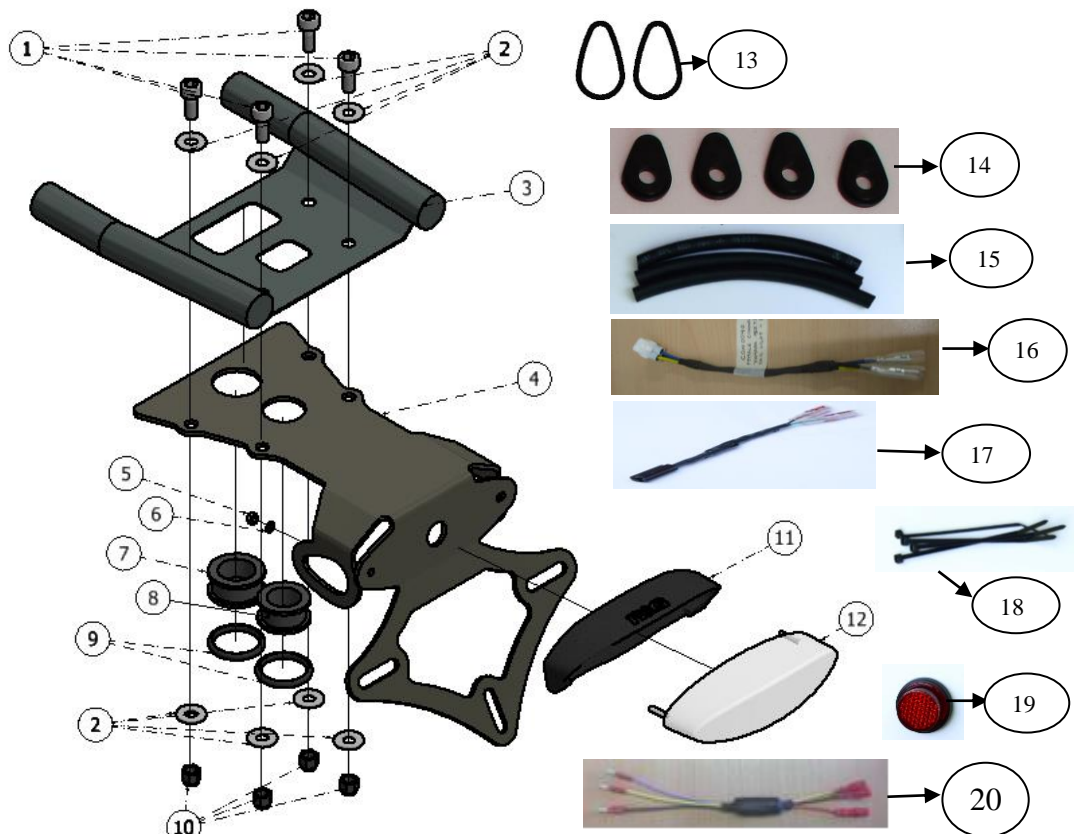

R&G Racing

Unit 1, Shelley's Lane, East Worldham, Alton, Hampshire, GU34 3AQ

Tel: +44 (0)1420 89007 Fax: +44 (0)1420 87301 [www.rg-racing.com](http://www.rg-racing.com) Email: [info@rg-racing.com](mailto:info@rg-racing.com)



LP0197

### **LEGEND**

- ITEM 1 = M6 x 16mm LONG BUTTON HEAD BOLTS (x4)  
ITEM 2 = M6 WASHERS (x8)  
ITEM 3 = SUB-FRAME (FOR ILLUSTRATION ONLY)  
ITEM 4 = LICENCE PLATE BRACKET (TB0197BK) (x1)  
ITEM 5 = M3 NUTS (x2).  
ITEM 6 = M3 WASHERS (x2).  
ITEM 7 = RUBBER GROMMET FOR KEY LOCK COVER (RB0004) (x1).  
ITEM 8 = RUBBER GROMMET FOR TAIL LIGHT WIRING (RB0002) (x1).  
ITEM 9 = O-RING FOR RUBBER GROMMETS (OR0006) (x2).  
ITEM 10 = M6 NYLOC NUTS (x4)  
ITEM 11 = TAIL LIGHT SHROUD (LA0003 SHROUD) (x1)  
ITEM 12 = TAIL LIGHT ASSEMBLY (LA0003) (x1)  
ITEM 13 = OEM INDICATOR ADAPTERS (I0037) (x2)  
ITEM 14 = MINI INDICATOR ADAPTERS (I0016) (x4)  
ITEM 15 = 180mm HEAT SHRINK TUBE (x3)  
ITEM 16 = TAIL LIGHT CONNECTOR (CON0040) (x1)  
ITEM 17 = INDICATOR CONNECTOR (CON0027) (x2)  
ITEM 18 = SMALL CABLE TIES (x3)  
ITEM 19 = REFLECTOR (x1)  
ITEM 20 = TAIL LIGHT RESISTOR (CON0048) (x1)

Page | 2

Please note that in cases where kits are packed with rubber washers holding the components onto the bolt – *the rubber washers should be thrown away!*

### **TOOLS REQUIRED**

- Set of metric Allen keys
- 8mm and 10mm Socket and wrench.
- Electrical pliers/ crimps
- Phillips screwdriver.

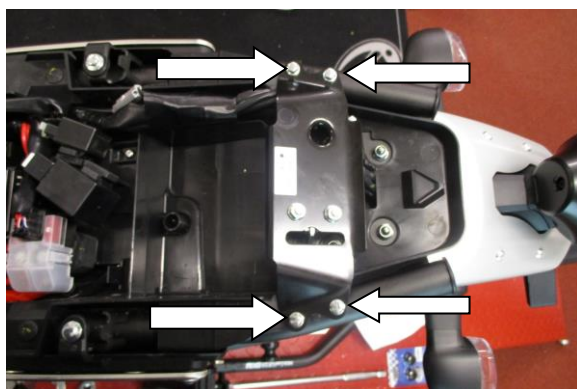

PICTURE 1



PICTURE 2



LP0197

Page | 3

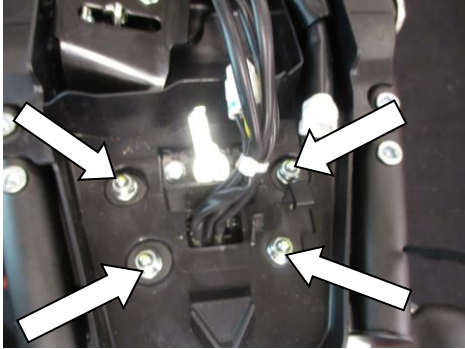

PICTURE 3

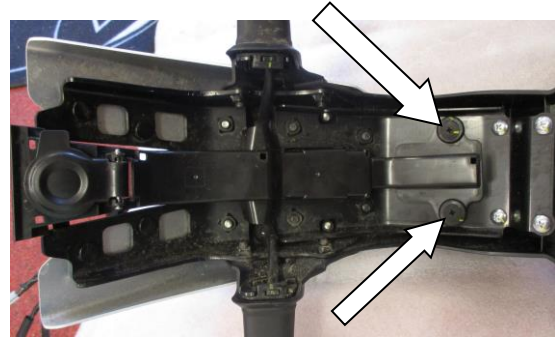

PICTURE 4



PICTURE 5

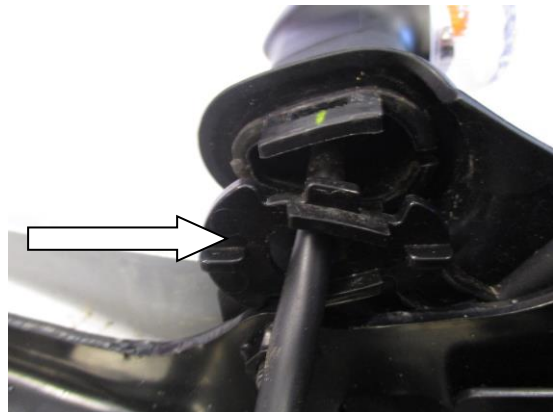

PICTURE 6



PICTURE 7



PICTURE 8



LP0197

Page | 4

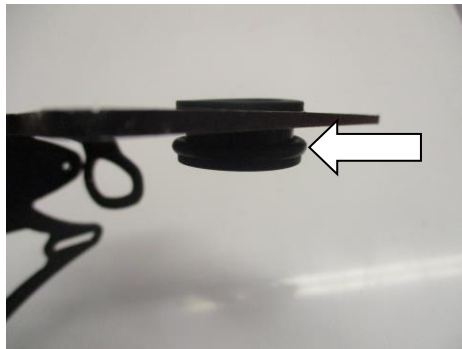

PICTURE 9



PICTURE 10

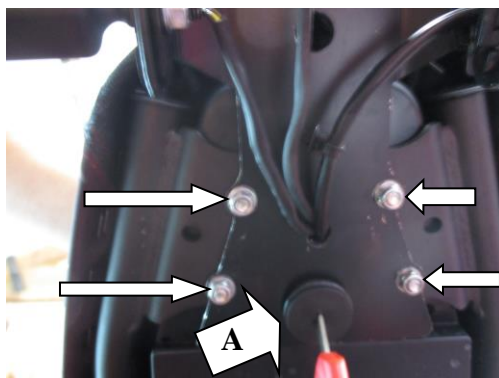

PICTURE 11



PICTURE 12

### **FITTING INSTRUCTIONS**

- Remove the seat using the key.
- Remove the four bolts that hold the seat lock mechanism (arrowed in picture 1) using 8mm socket and a wrench.
- Slide off the wires protective cover and disconnect all tail unit connectors (rear light, both indicators and licence plate light connectors) as shown in picture 2. Please take note of the routing and where each connector connects to.
- Remove the four bolts arrowed in picture 3 and gently retract the OEM tail unit assembly and its wiring away from the sub-frame. Please note to keep the tail unit supported while the bolts are being undone.
- On the OEM tail unit assembly, working from underneath, remove the seat lock/ cable cover by removing the two plastic expanders (arrowed in picture 4) using a phillip screwdriver. Slide the cover backwards to remove it completely.
- Remove the cable tie that holds the wiring bundle and unclip the two clips holding the indicator wires onto the OEM tail unit bracket (as arrowed in picture 5)

### **If using the original indicators**

- Remove the spreader/ location plate arrowed in picture 6.
- Gently squeeze the indicator stem and remove the indicator together with its wires.
- Insert the OEM Indicator adapter (Item 13) into the indicator stem as shown in picture 7.





LP0197

Page | 5

- Fit the original indicator with the adapter to the new licence plate bracket (Item 4) and re-fit the spreader. Ensure that the adapter (Item 13) is sitting on the outside of the licence plate bracket (Item 4).
- Repeat the procedure for the other indicator.

If fitting R&G mini indicators (R&G product code RG370=bulb, RG371=LED or RG372 = Aero LED

- If fitting the R&G Mini Indicators, cut the heat-shrink tube (Item 15) into a suitable length and insert the two wires coming from the indicator through. Please leave at least 50mm of wires uncovered by the heat shrink tube as bullet connectors are needed to be attached to it. Position and crimp male bullet connectors to the exposed wires, ensuring the connections are secured and the exposed wire end is in contact with the bullet connector. Using a suitable heating resources, shrink the heat-shrink tube.
- Using an indicator connector (Item 17) from the kit, plug in the female connectors into the male connectors just fitted on the indicator wires.
- Use the indicator adapters (item 14) on either side of the bracket and tighten the assembly.
- Repeat procedure to the other mini indicator.

Fitting the Tail Light

- From the kit, take the Tail light unit (Item 12) and its shroud (Item 11). Insert the tail light into the shroud by aligning the two studs at the back of the tail light into the two holes provided on the shroud. Mount the whole assembly into the new licence plate bracket (Item 4) and secure with M3 washers (Item 6) and M3 Nuts (Item 5). Tighten the M3 nuts (Item 5).
- Cut the Heat-shrink tube (Item 15) into a suitable length and feed the three wires through, please leave at least 50mm of wires uncovered by the heat shrink tube as bullet connectors are needed to be attached to it. Using a suitable heating resources, shrink the heat-shrink tube.
- Using suitable tool, install the male bullet connectors onto the exposed wiring from the tail light unit. Crimp the bullet connector, check for tightness and make sure the exposed wire is in contact with the bullet connector. Repeat this procedure to all three wires.
- Plug in the Tail light resistor (Item 20) from the kit onto the male bullet connector just fitted on the tail light unit. Please connect the wires in the orientation below:  
RESISTOR YELLOW -----→ YELLOW (TAIL LIGHT)  
RESISTOR RED -----→ RED (TAIL LIGHT)  
RESISTOR BLACK-----→ BLACK (TAIL LIGHT)
- From the kit, take the 26mm rubber grommet (Item 7) and fit the O-ring (Item 9) provided over it as shown in picture 8.
- Gently squeeze the rubber grommet and insert it into a larger hole on the licence plate bracket (Item 4) as arrowed in picture 9. Ensure that the O-rings sits below the licence plate bracket (Item 7).
- Repeat the procedure to the other rubber grommet (Item 8)
- Gently push all the wiring (Both indicators and tail light wiring) through the smaller rubber grommet (Item 8) as shown in picture 10.
- Bring the whole assembly towards the sub-frame, gently insert the larger rubber grommet (Item 7) over the key lock (labelled A in picture 11). *For an easier fitment, rub a thin layer of wd40 or equivalent around the outer surface of the key lock and slide the rubber grommet (item 7) in.*

R&G Racing

Unit 1, Shelley's Lane, East Worldham, Alton, Hampshire, GU34 3AQ

Tel: +44 (0)1420 89007 Fax: +44 (0)1420 87301 [www.rg-racing.com](http://www.rg-racing.com) Email: [info@rg-racing.com](mailto:info@rg-racing.com)



LP0197

Page | 6

- Mount the licence plate bracket (Item 4) using the four M6 x 16mm (Item 1) with M6 washers (Item 2) through the top four holes on the sub-frame. Secure the assembly with M6 washer (Item 2) and M6 nyloc nut (Item 10) on each bolt as arrowed in picture 11.
- Ensure that none of the wires are caught between the sub-frame and the licence plate bracket (item 4). Tighten the four nyloc nuts (Item 10) using 5mm Allen key, 10mm socket and a wrench to 12 Nm.
- Reconnect all the indicator wiring plug sockets and check operation (if illumination fails, swap the bullet connections around).
- Connect the tail light resistor (Item 20) to the tail light connector (Item 16) in this scheme:  
RESISTOR BLUE -----→ CONNECTOR YELLOW  
RESISTOR YELLOW -----→ CONNECTOR BLUE  
RESISTOR BLACK -----→ CONNECTOR BLACK
- Connect the male connector of the tail light connector (Item 16) into the OEM female connector in the main wiring loom.
- Route the wiring as original and tidy up using the cable ties provided from the kit.
- OEM number plate light connector is no longer in use as the tail light unit (Item 12) comes with built-in LED licence plate lights.
- Fit licence plate to the new licence plate bracket (Item 4) (it may require re-drilling).
- **IMPORTANT: IF FITTING A FULL-SIZE LICENCE PLATE AND PLACING IT FAR DOWN ON THE LICENCE PLATE HANGER, THERE IS A SMALL CHANCE OF THE LICENCE PLATE HITTING THE BACK WHEEL UNDER HEAVY LOAD AND OVER LARGE BUMPS IN THE ROAD. IT IS YOUR RESPONSIBILITY TO CHECK FOR THIS POSSIBILITY AND TAKE AVOIDING ACTION. FAILURE TO CHECK THIS COULD RESULT IN SERIOUS INJURY.**
- Refit the Seat lock mechanism as original using its original bolts.
- Refit seat.
- Depending on local laws, attach enclosed red reflector (item 19) in an appropriate location.
- **Please test the indicators, rear light, no. plate light and brake light before riding.**

Digital copies of these instructions are available to download from [www.rg-racing.com](http://www.rg-racing.com)

#### **GENERAL TORQUE SETTINGS**

M4 BOLT = 8Nm  
M5 BOLT = 12Nm  
M6 BOLT = 15Nm  
M8 BOLT = 20Nm  
M10 BOLT = 40Nm

ISSUE 4 04/11/2016 (HH)

#### **CONSUMER NOTICE**

The catalogue description and any exhibition of samples are only broad indications of the Products and R&G may make design changes which do not diminish their performance or visual appeal and supplying them in such state shall conform to the order. The Buyer acknowledges no representation or warranty (other than as to title) has been given or will apply to the Products other than those in R&G's order or confirmation and the Buyer confirms it has chosen the Products as being of merchantable quality and suitable for its particular purposes. Where R&G fits the Products or undertakes other services it shall exercise reasonable skill and care and rectify any fault free of charge unless the workmanship has been disturbed. The Buyer is responsible for ensuring that the warranty on the motorcycle is not affected by the fitting of the Products. On return of any defective Products

R&G Racing

Unit 1, Shelley's Lane, East Worldham, Alton, Hampshire, GU34 3AQ

Tel: +44 (0)1420 89007 Fax: +44 (0)1420 87301 [www.rg-racing.com](http://www.rg-racing.com) Email: [info@rg-racing.com](mailto:info@rg-racing.com)



LP0197

Page | 7

R&G shall at its option either supply a replacement or refund the purchase money but shall not be liable if the Products have been modified or used or maintained otherwise than in accordance with R&G's or manufacturer's instructions and good engineering practice or if the defect arises from accident or neglect. Other than identified above and subject to R&G not limiting its liability for causing death and personal injury, it shall not be liable for indirect or consequential loss and otherwise its liability shall be limited to the amounts paid by the Buyer for the Products or the fitting or service concerned. These terms do not affect the Buyer's statutory rights.

**R&G RACING RETURNS POLICY (NON-FAULTY GOODS)**

Returns must be pre-authorised (if not pre-authorised the return will be rejected). Goods may only be returned direct to us if they were purchased direct from us (customer must prove if necessary). Otherwise to be returned to original vendor. Goods must be in re-sellable condition, in the opinion of R&G Racing. All returns are subject to a 25% restocking and handling fee (25% of the gross value exc. P&P – at the prevailing price at time of purchase). The customer must pay any and all carriage charges. No returns of discontinued products, unless within 14 days of purchase. This policy does not affect your statutory rights and does not refer to faulty goods.