



**FITTING INSTRUCTIONS FOR LP0265BK LICENSE PLATE BRACKET
FOR YAMAHA YZF-R125 '19-**



**THIS KIT CONTAINS THE ITEMS PICTURED AND LABELLED BELOW.
DO NOT PROCEED UNTIL YOU ARE SURE ALL PARTS ARE PRESENT.**

Please note that the way the kit is packed does not necessarily represent the way of mounting to the bike

Please note that in cases where kits are packed with rubber washers holding the components onto the bolt – *the rubber washers should be thrown away!*

THE PARTS SHOWN MAY BE REPRESENTATIVE ONLY (FOR CLARITY OF INSTRUCTIONS ONLY)

Digital copies of these instructions are available to download from www.rg-racing.com

GENERAL TORQUE SETTINGS

- M4 BOLT = 8Nm
- M5 BOLT = 12Nm
- M6 BOLT = 15Nm
- M8 BOLT = 20Nm
- M10 BOLT = 40Nm

TOOLS REQUIRED

- Set of metric Allen keys to include 4 & 5mm A/F sizes.
- Socket set to include 8, 10 and 12mm sockets and wrench.
- 13mm Spanner.
- Small flathead screwdriver.
- Small amount of adhesive.

R&G

Unit 1, Shelley's Lane, East Worldham, Alton, Hampshire, GU34 3AQ

Tel: +44 (0)1420 89007 Fax: +44 (0)1420 87301 www.rg-racing.com Email: info@rg-racing.com

**This Kit Contains:**

- Item 1 = 1x LICENCE PLATE BRACKET (TB0265)
- Item 2 = 1x RUBBER GASKET (RG0035)
- Item 3 = 4x INDICATOR ADAPTOR (I0016)
- Item 4 = 1x CON0007 NUMBER PLATE ILLUMINATOR CONNECTOR
- Item 5 = 2x CON0027 INDICATOR CONNECTOR
- Item 6 = 1x LA0002 NUMBER PLATE LIGHT ASSEMBLY
- Item 7 = 1x REFLECTOR
- Item 8 = 3x 150mm LENGTH OF HEATSHRINK
- Item 9 = 4x 2.5mm CABLE TIES (100mm LENGTH)
- Item 10 = 2x MINI INDICATOR WIRING COVERS (IWC0002)
- Item 11 = 4x M6 x 1.0 x 15.0mm BUTTON HEAD BOLTS
- Item 12 = 4x M6 NYLOC NUTS
- Item 13 = 8x M6 WASHERS
- Item 14 = 2x OEM INDICATOR ADAPTORS (I0037)

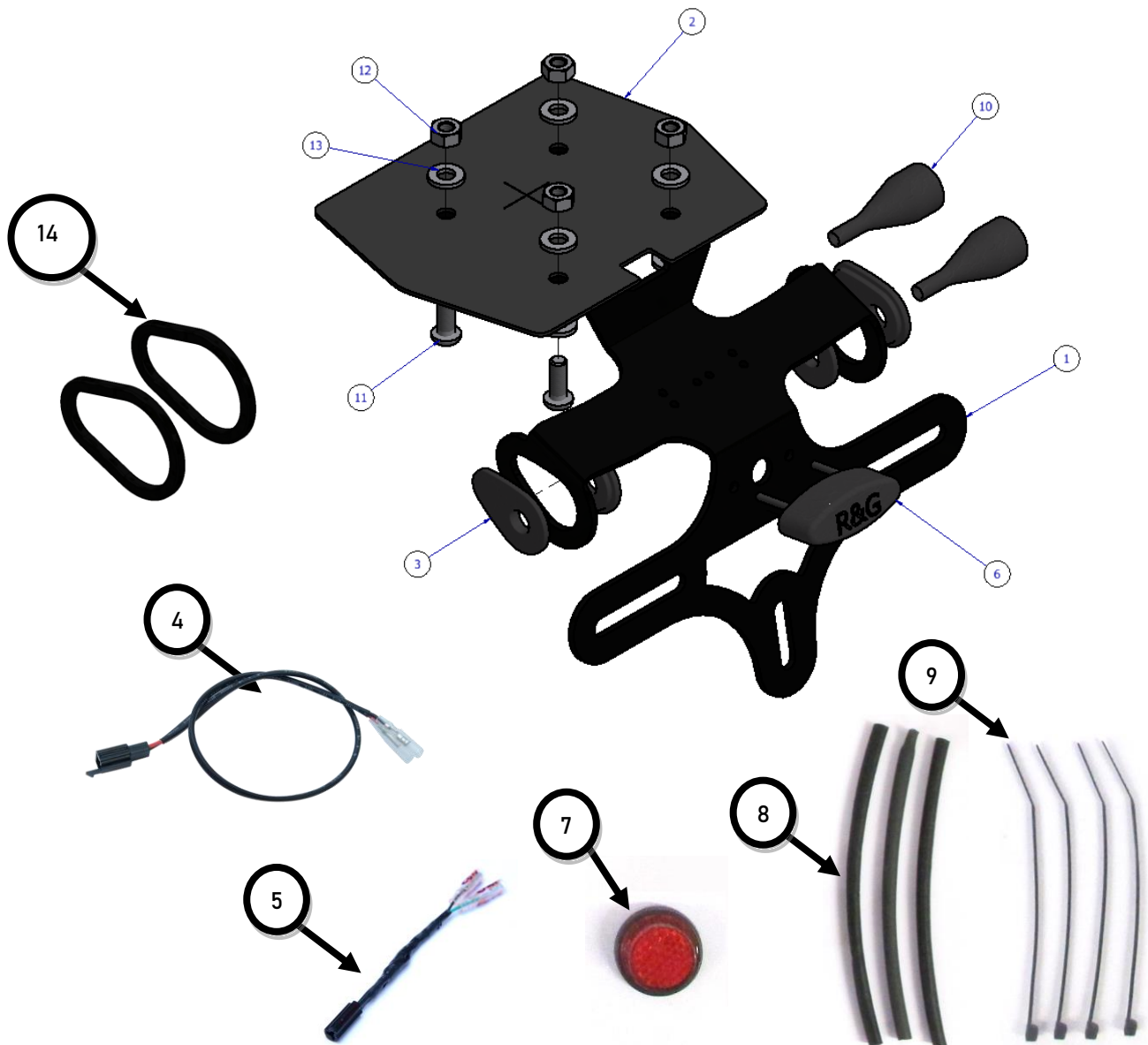

R&G

Unit 1, Shelley's Lane, East Worldham, Alton, Hampshire, GU34 3AQ

Tel: +44 (0)1420 89007 Fax: +44 (0)1420 87301 www.rg-racing.com Email: info@rg-racing.com



FITTING INSTRUCTIONS



Picture 1



Picture 2

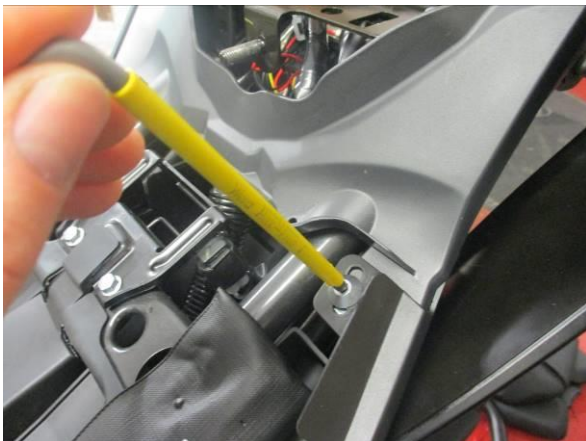

Picture 3

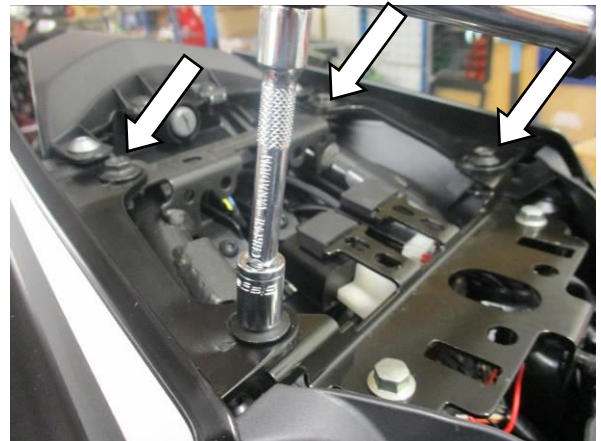

Picture 4



Picture 5



Picture 6

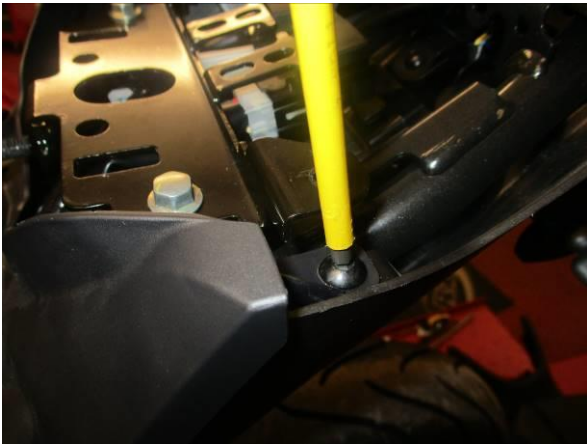

Picture 7



Picture 8



Picture 9



Picture 10



Picture 11



Picture 12



Picture 13

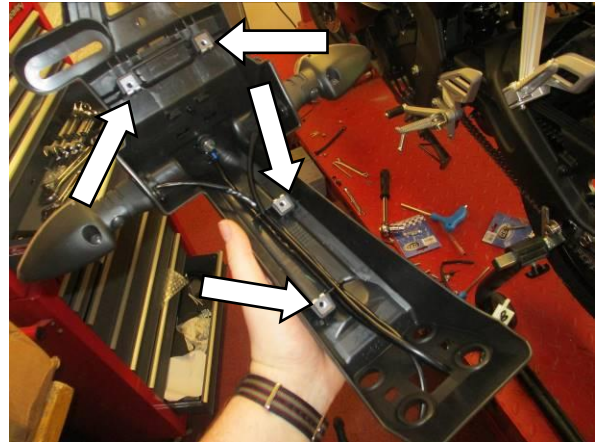

Picture 14



Picture 15



Picture 16



Picture 17

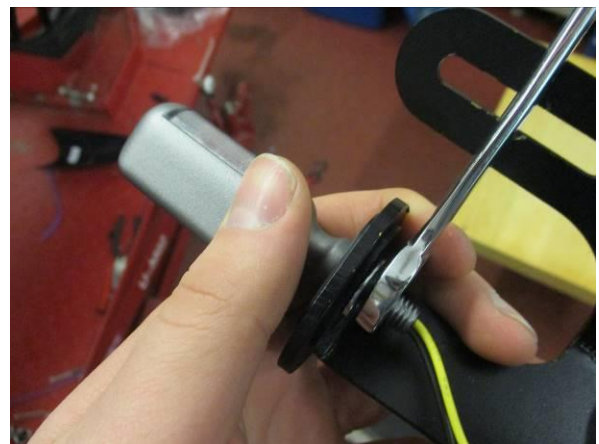

Picture 18



Picture 19

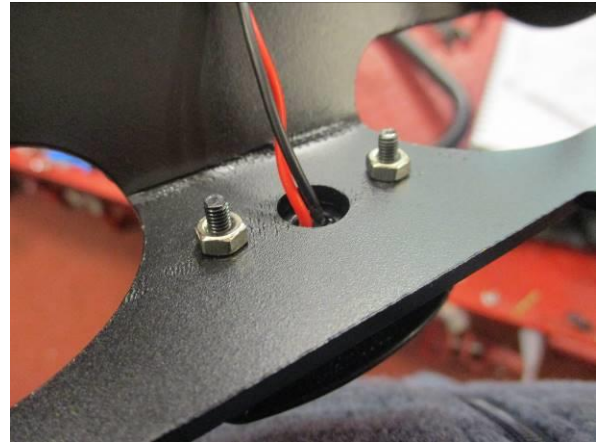

Picture 20



Picture 21



Picture 22

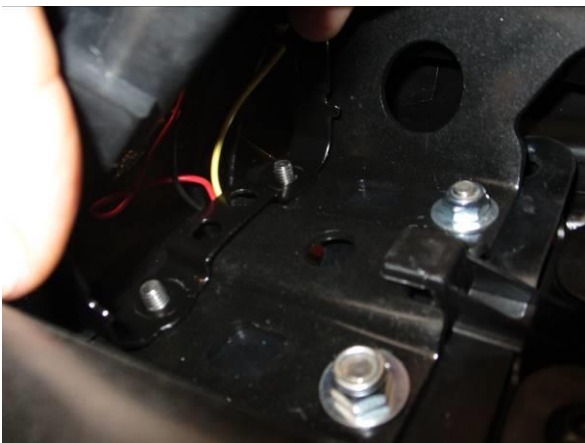

Picture 23



Picture 24

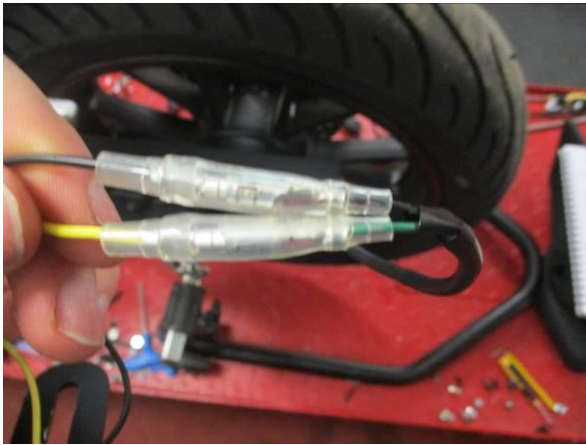

Picture 25

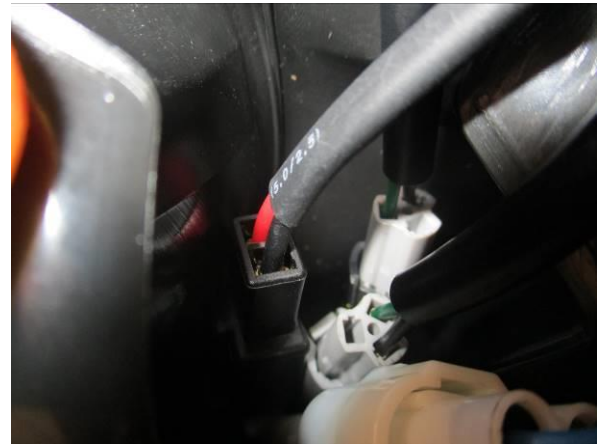

Picture 26



Picture 27



FITTING INSTRUCTIONS

- To fit the R&G tail tidy, remove the pillion seat by removing the plastic cover on the front of the seat (using a small flathead screwdriver to pry loose may help), then remove the securing nut with a 12mm socket, as shown in picture 1 & 2. The rider's seat must then also be removed using the ignition key in the lock located at the rear of the seat.
- Remove 2x lower panel bolts with a 4mm Allen key, as shown in picture 3.
- Remove 4x top 10mm bolts securing the 'wing' panels, as shown in picture 4.
- Remove 2x bolts linking 'wing' panels with rear light using a 4mm Allen key, as shown in picture 5.
- Remove 4x underside 10mm bolts securing the 'wing' panels, as shown in picture 6, and remove both panels by gently pulling to unclip from carrier.
- Remove 2x upper bolts securing the panel using a 4mm Allen key as shown in picture 7, and remove the panel.
- Remove the pair of relays from the carrier by gently sliding towards the rear of the bike, as shown in picture 8.
- Remove 2x 10mm bolts securing the relay carrier to the rear subframe, as shown in picture 9.
- Remove 2x bolts securing the relay carrier to side panels with a 4mm Allen key, as shown in picture 10, and remove the carrier.
- Slide main fuse box from carrier bracket as shown in picture 11.
- Open the wiring shroud and disconnect the 3 connections shown in picture 12 and detailed below:

WHITE/CLEAR 2-PIN CONNECTOR	=	NUMBER PLATE ILLUMINATOR
BLACK 3-PIN CONNECTOR	=	LEFT-HAND SIDE INDICATOR
GREY 3-PIN CONNECTOR	=	RIGHT-HAND SIDE INDICATOR

- Using a 10mm socket, remove the 4x nuts securing the OEM tail tidy and fuse box bracket, as shown in picture 13, and carefully lower the OEM tail tidy while feeding the wiring through the hole in the subframe.

R&G

Unit 1, Shelley's Lane, East Worldham, Alton, Hampshire, GU34 3AQ

Tel: +44 (0)1420 89007 Fax: +44 (0)1420 87301 www.rg-racing.com Email: info@rg-racing.com



If using the original indicators

- If fitting the OEM indicators, remove the two bolts on the underside and the two bolts at the rear of the OEM tail tidy to remove the plastic cover, exposing the wires, as shown in picture 14.
- Remove the indicator spreading plates shown in picture 15 by unclipping from either side of the indicator rubber seal and gently squeeze the indicator stems to remove the indicators.
- Fit the original indicators to the new licence plate bracket (item 1 – TB0265) using the indicator adaptors (item 14 – I0037) (in position shown in picture 16 so it fits in the groove in the stem and between the indicator and the bracket).

If using the mini indicators

- Fit the indicators of choice to the licence plate bracket (item 1 – TB0265) (R&G mini indicator product code RG370 for bulb type and RG371 for LED type or RG372 for the Aero shaped LED type) using the indicator adaptors (item 3 – I0016) sandwiched between either side of the bracket as shown in picture 17. Secure the indicators to the adaptors using the provided nuts and a 13mm spanner, as shown in picture 18.
- Please then use the heat shrink provided (item 8) to protect the wiring.
- Take the R&G licence plate bracket (item 1 – TB0265) and fit the R&G license plate illuminator (item 6) to the assembly, as shown in picture 19. Use a small amount of superglue to stick the light shroud in position. Fit one length of heatshrink (item 8) to the wires and tighten the nuts on the rear, as shown in picture 20.
- Feed all wiring through the access hole on the tail tidy and secure wiring to bracket using the provided cable ties (item 9) fed through corresponding holes in the bracket.
- Offer up the new rubber grommet (item 2 – RG0035) to the underside of the tail tidy mounting location, as shown in picture 21, aligning the 4 holes in the gromet with the 4 mounting holes and allow to sit flat within the panel.
- The new tail tidy assembly can now be offered up to the underside of the bike. To do this, first, feed the indicator and number plate illuminator wiring through the cut-out on the rubber gromet, then position one M6 x 15mm long button head bolt (item 11) with one M6 washer fitted (item 13) through each of the 4 holes on the mounting plate of the tail tidy, as shown in picture 22.
- This can now be positioned in the opening on the underside of the tail, before locating each of the 4 bolts with the corresponding holes on the rubber grommet and mounting holes on the subframe. Re-fit the fuse box bracket over the corresponding bolts, before fitting a washer (item 13) and loosely fitting one of the provided nyloc nuts (item 12) to the exposed end of each bolt, as shown in picture 23.
- Ensure the tail tidy is located correctly before tightening the 4 bolts, using a 10mm socket or spanner to hold the nut from above whilst tightening with a 4mm Allen key from the underside, as shown in picture 24.
- To connect the OEM indicators, simply re-fit the matching connectors together.

R&G

Unit 1, Shelley's Lane, East Worldham, Alton, Hampshire, GU34 3AQ

Tel: +44 (0)1420 89007 Fax: +44 (0)1420 87301 www.rg-racing.com Email: info@rg-racing.com



- To connect the R&G mini indicators, fit an indicator connector (item 5) to the corresponding indicator bullet connectors as shown in picture 25 (BLACK – BLACK, YELLOW – GREEN) and re-fit to the corresponding female 3-pin connectors within the shroud opened earlier.
- To connect the license plate illuminator, fit the wiring connector (item 4 – CON0007) to the corresponding bullet connectors of the illuminator as shown in picture 26 (BLACK – BLACK, RED – RED) and re-fit to the corresponding female 2-pin connector within the shroud opened earlier.
- If using mini indicators, you may have to use resistors to achieve the correct flash rate. It is a good idea to check the licence plate illuminator and indicators at this stage; if illumination fails please swap the bullet connection around. Once happy, close the wiring shroud and tuck back in to its original position.
- Ensure the tail tidy is securely mounted and all bolts are fully tightened.
- Re-fit all panels and brackets, making sure the fuse box and relays are secured safely back onto their carriers, with all wiring neatly routed.
- Re-fit the rider's seat and then the pillion seat, ensuring to re-fit the nut and plastic cover to securely mount the seat in place.
- Re-fit the licence plate (it may require drilling).
- Depending on local laws, attach enclosed reflector in an appropriate location.
- Test the license plate illuminator and all lights before riding.

ISSUE 2 28/03/2019 (FB)

CONSUMER NOTICE

The catalogue description and any exhibition of samples are only broad indications of the Products and R&G may make design changes which do not diminish their performance or visual appeal and supplying them in such state shall conform to the order. The Buyer acknowledges no representation or warranty (other than as to title) has been given or will apply to the Products other than those in R&G's order or confirmation and the Buyer confirms it has chosen the Products as being of merchantable quality and suitable for its particular purposes. Where R&G fits the Products or undertakes other services it shall exercise reasonable skill and care and rectify any fault free of charge unless the workmanship has been disturbed. The Buyer is responsible for ensuring that the warranty on the motorcycle is not affected by the fitting of the Products. On return of any defective Products R&G shall at its option either supply a replacement or refund the purchase money but shall not be liable if the Products have been modified or used or maintained otherwise than in accordance with R&G's or manufacturer's instructions and good engineering practice or if the defect arises from accident or neglect. Other than identified above and subject to R&G not limiting its liability for causing death and personal injury, it shall not be liable for indirect or consequential loss and otherwise its liability shall be limited to the amounts paid by the Buyer for the Products or the fitting or service concerned. These terms do not affect the Buyer's statutory rights.

R&G RACING RETURNS POLICY (NON-FAULTY GOODS)

Returns must be pre-authorized (if not pre-authorized the return will be rejected). Goods may only be returned direct to us if they were purchased direct from us (customer must prove if necessary). Otherwise to be returned to original vendor. Goods must be in re-sellable condition, in the opinion of R&G Racing. All returns are subject to a 25% restocking and handling fee (25% of the gross value exc. P&P – at the prevailing price at time of purchase). The customer must pay any and all carriage charges. No returns of discontinued products, unless within 14 days of purchase. This policy does not affect your statutory rights and does not refer to faulty goods.

R&G

Unit 1, Shelley's Lane, East Worldham, Alton, Hampshire, GU34 3AQ

Tel: +44 (0)1420 89007 Fax: +44 (0)1420 87301 www.rg-racing.com Email: info@rg-racing.com