



**FITTING INSTRUCTIONS FOR LP0311BK LICENCE PLATE BRACKET  
APRILIA RSV4 (FACTORY) 1100 & TUONO (FACTORY) 1100 2021-**



**This kit contains the items pictured and labelled over page.  
Some parts may be shown for clarity of instructions only.  
Do not proceed until you are sure all parts are present.  
Please read all instructions before proceeding.**

**IF IN ANY DOUBT WHEN FITTING OUR PRODUCTS, CONSULT ONE OF OUR DEALERS  
OR HAVE FITTED BY A QUALIFIED TECHNICIAN.**

Please note that the way the kit is packed does not necessarily represent the way of mounting to the bike.

In the event of rubber washers being used to hold components onto bolts, these rubber washers can be thrown away.

**DIGITAL COPIES OF THESE INSTRUCTIONS ARE AVAILABLE FROM**

**[WWW.RG-RACING.COM](http://WWW.RG-RACING.COM)**

R&G

Unit 1, Shelley's Lane, East Worldham, Alton, Hampshire, GU34 3AQ  
Tel: +44 (0)1420 89007 Fax: +44 (0)1420 87301 [www.rg-racing.com](http://www.rg-racing.com) Email: [info@rg-racing.com](mailto:info@rg-racing.com)



<b><u>TOOLS REQUIRED</u></b>	<b><u>GENERAL TORQUE SETTINGS</u></b>
<ul style="list-style-type: none"> <li>• Set of metric Hex keys to include 3mm &amp; 4mm.               <ul style="list-style-type: none"> <li>• T30 Torx head tool</li> </ul> </li> <li>• Set of metric sockets and wrench. To include 6, 8 &amp; 10mm.               <ul style="list-style-type: none"> <li>• 8mm &amp; 10mm spanners.</li> <li>• Phillips screwdriver.</li> </ul> </li> </ul>	M4 BOLT = 8Nm M5 BOLT = 12Nm M6 BOLT = 15Nm M8 BOLT = 20Nm M10 BOLT = 40Nm M12 BOLT = 40Nm

### **LEGEND**

<b>ITEM No.</b>	<b>DESCRIPTION</b>	<b>QTY</b>
ITEM 1	TB0311 PART 1 – MAIN BRACKET	1
ITEM 2	TB0299 PART 2 - LICENCE PLATE MOUNT PLATE	1
ITEM 3	TB0299 PART 3 – COVER PLATE	1
ITEM 4	S0722 – TAIL BRACKET MOUNTING SPACERS	2
ITEM 5	LA0002 - NUMBER PLATE LIGHT (TO INCLUDE SHROUD)	1
ITEM 6	M6 x 1.00 x 25MM LONG BUTTON HEAD BOLT	1
ITEM 7	M6 x 1.00 x 20MM LONG BUTTON HEAD BOLT	2
ITEM 8	M6 x 12MM OD WASHER	3
ITEM 9	M6 x 19MM OD WASHER	2
ITEM 10	M6 NYLOC NUTS	2
ITEM 11	M5 x 0.8 x 12MM COUNTERSUNK BOLTS	8
ITEM 12	M5 x 10MM OD WASHERS	4
ITEM 13	M5 x 16MM OD WASHERS	4
ITEM 14	M5 NYLOC NUTS	8
ITEM 15	RB0002 RUBBER BUNG	1
ITEM 16	150MM LENGTH OF HEAT SHRINK	3
ITEM 17	CT100 100MM CABLE TIE	8
ITEM 18	CLIP 1 SELF ADHESIVE CABLE CLIPS	4
ITEM 19	REFL 3 REFLECTOR	1
ITEM 20	IWC0002 INDICATOR WIRING COVERS	2
ITEM 21	CON0014 LICENCE PLATE CONNECTOR	1
ITEM 22	CON0073 INDICATOR CONNECTOR	1
ITEM 23	CON0074 INDICATOR CONNECTOR	1
ITEM 24	SPACER	1

R&G

Unit 1, Shelley's Lane, East Worldham, Alton, Hampshire, GU34 3AQ

Tel: +44 (0)1420 89007 Fax: +44 (0)1420 87301 [www.rg-racing.com](http://www.rg-racing.com) Email: [info@rg-racing.com](mailto:info@rg-racing.com)



**ASSEMBLY DIAGRAM 1**

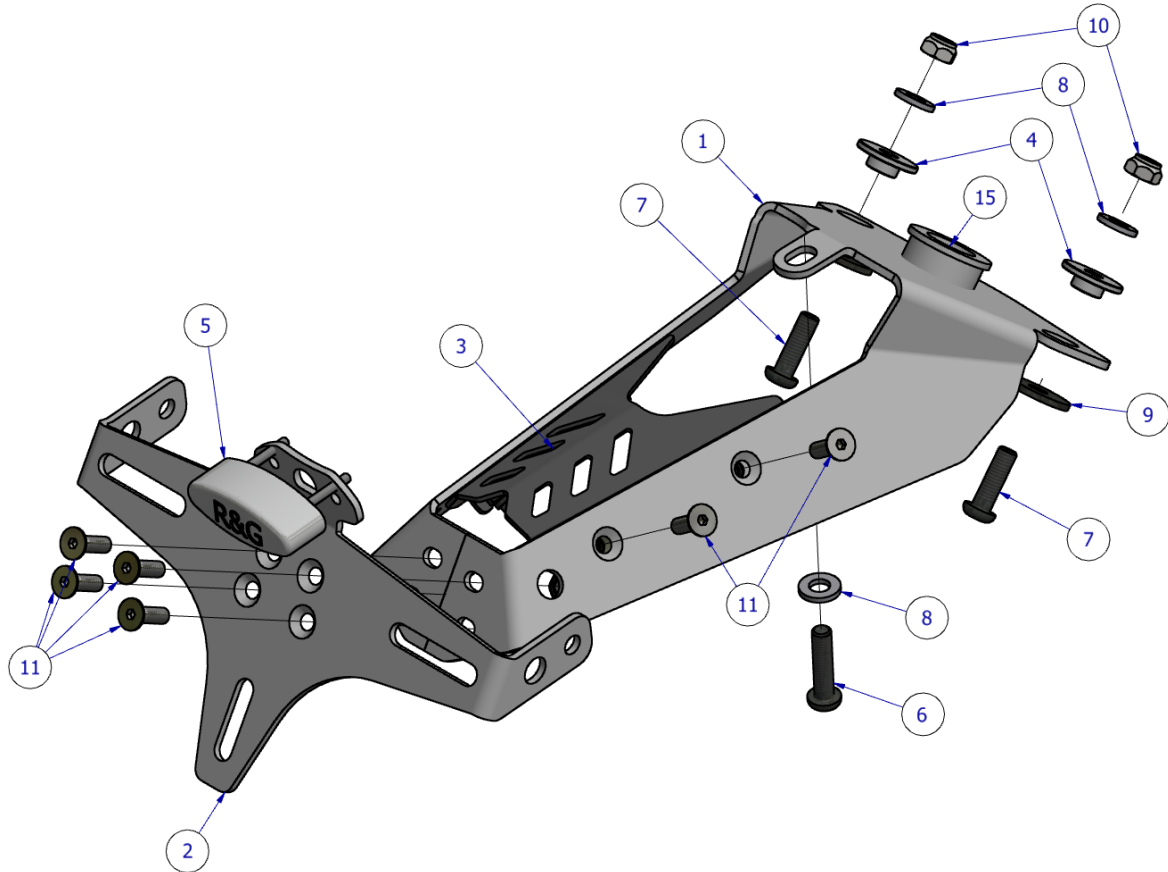

**ASSEMBLY DIAGRAM 2 – UNDERSIDE**

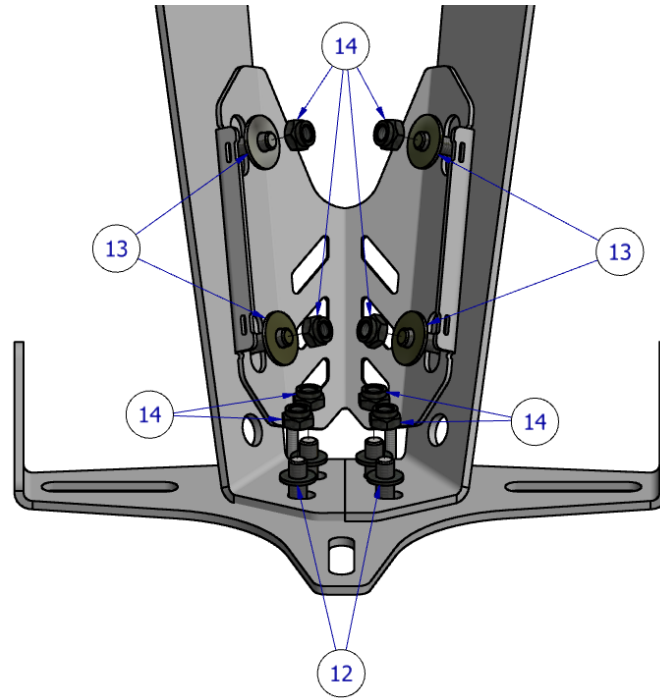

**Assembly Diagram 3 – ANCILLERY COMPONENTS**

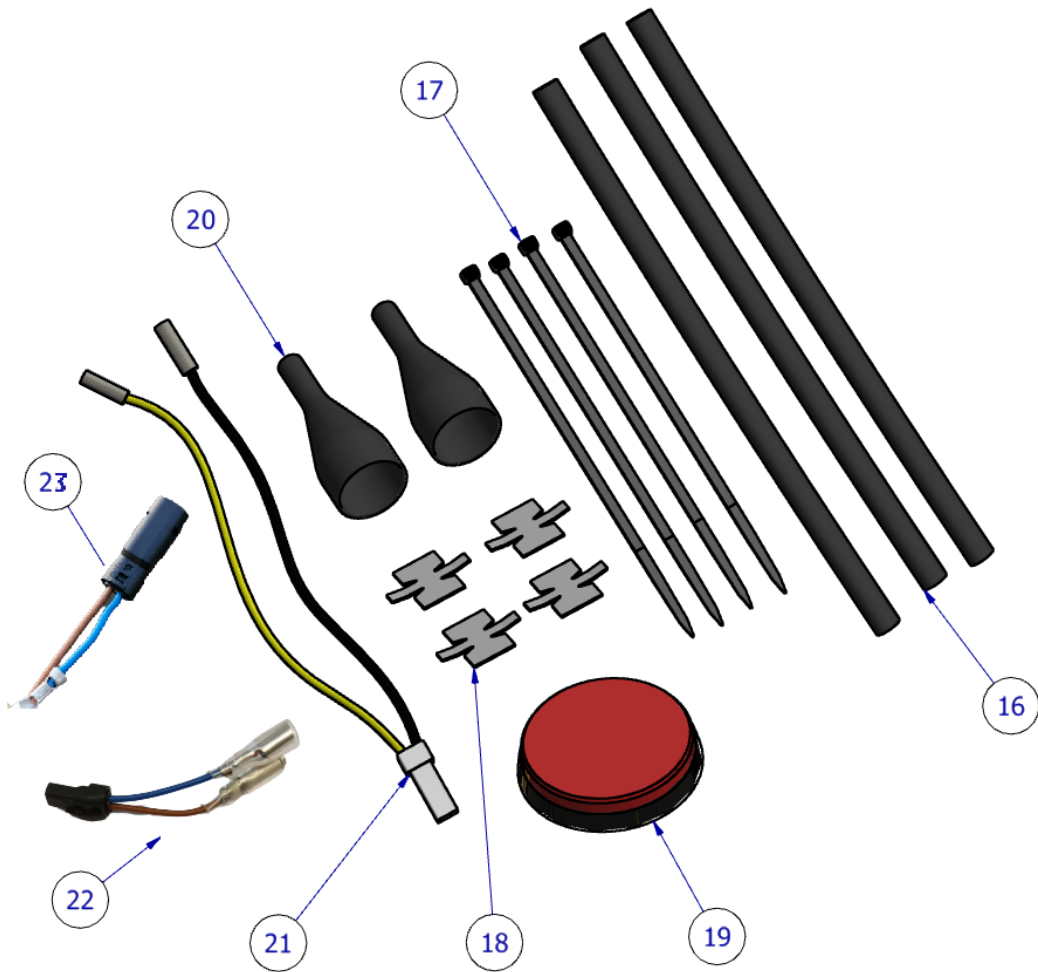

**FITTING PICTURES**



Picture 1



Picture 2

R&G

Unit 1, Shelley's Lane, East Worldham, Alton, Hampshire, GU34 3AQ

Tel: +44 (0)1420 89007 Fax: +44 (0)1420 87301 [www.rg-racing.com](http://www.rg-racing.com) Email: [info@rg-racing.com](mailto:info@rg-racing.com)



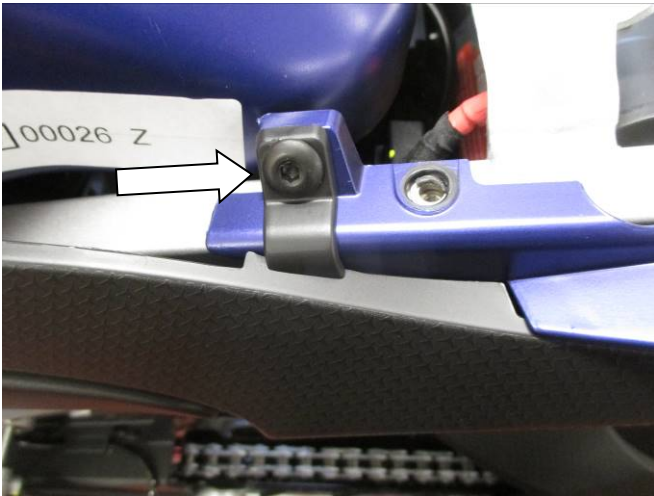

Picture 3



Picture 4



Picture 5



Picture 6

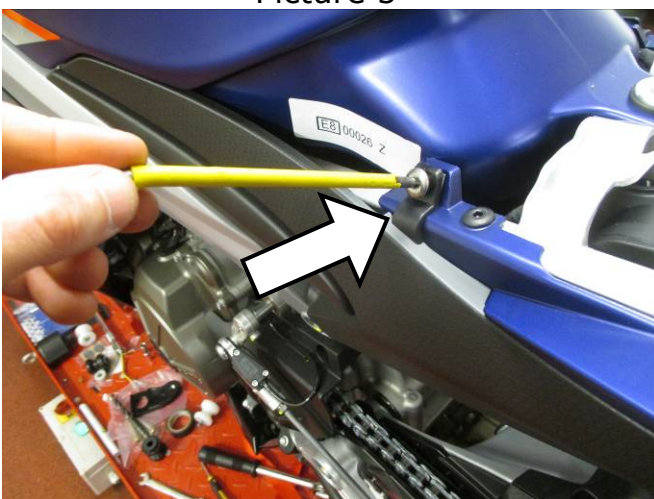

Picture 7

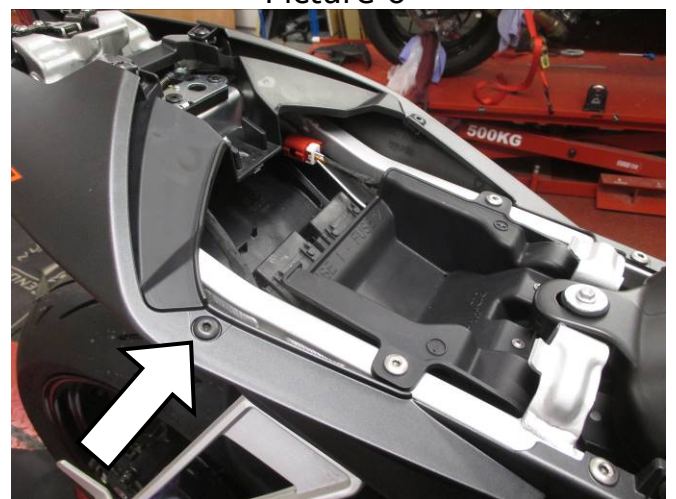

Picture 8

R&G





Picture 9



Picture 10

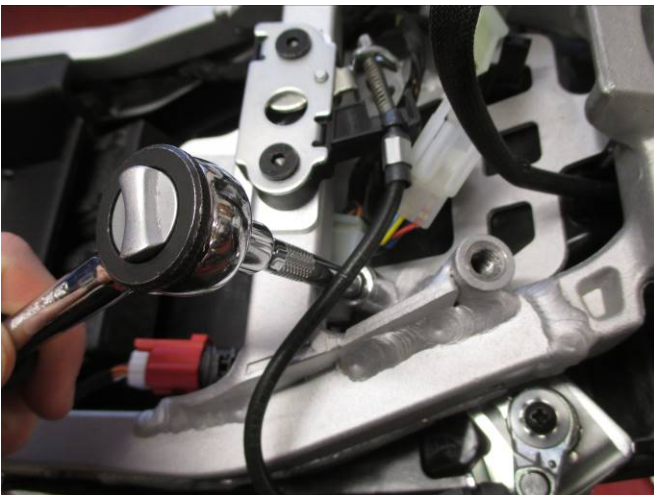

Picture 11



Picture 12

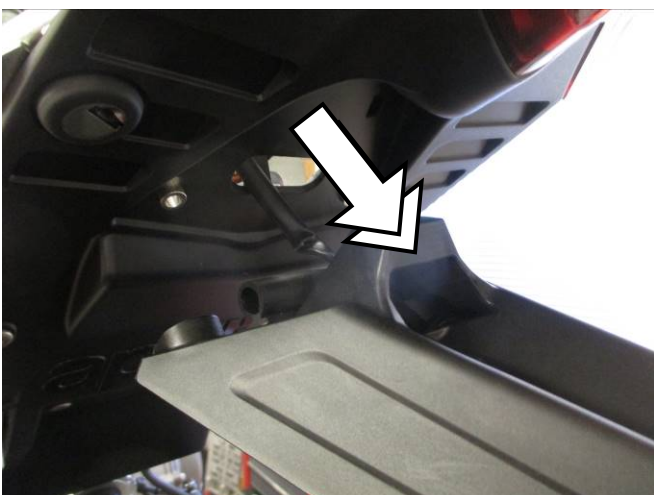

Picture 13

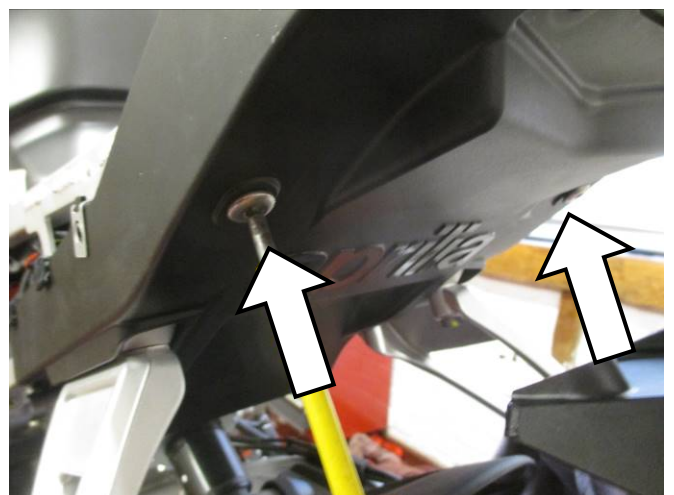

Picture 14

R&G





Picture 15



Picture 16



Picture 17



Picture 18



Picture 19



Picture 20

R&G





Picture 21



Picture 22

### **FITTING INSTRUCTIONS**

- To fit the R&G tail tidy, remove the rear pillion seat from the bike using the key in the tail unit. Then remove the plastic cover under the pillion seat as shown in **picture 1**.
- Remove the main seat unit using the bolts shown in **Picture 2**.
- Using a 4mm hex key, remove the bolts shown in **pictures 3 & 4**
- On both sides of the bike, remove the outer body panels by sliding the panels backwards to disengage the plastic hooks as shown in **picture 5**.
- Next, remove the 4 fairing bolts shown in **pictures 6, 7 & 8 & 9** and remove each rear panel separately from the bike.
- You now have access to the subframe and tail unit fixing bolts. Before proceeding, disconnect the tail unit wiring connection as shown in **picture 10**.
- To remove the tail unit, use a 10mm socket or spanner to hold the 2 nuts arrowed in **picture 11**, while using a T30 torx to remove the 2 x bolts from the underside of the tail unit as shown in **picture 12**. *Note: you may unhook the seat lock cable from the plastic guide to aid access to the nuts, remembering to replace before the seat is reattached.*
- While supporting the tail unit, remove the remaining torx bolt from the underside of the tail unit, being careful to remove thread the wiring through the slot in the bike as shown in **picture 13** as the unit is removed.
- With tail unit removed. The plastic undertray must be lowered slightly away from the bike so that 2 OEM spacers sandwiched between undertray and subframe may be replaced with the included S0722 (**item 4**) counterparts.
- Remove the two fairing bolts shown in **picture 14** and carefully slide the undertray forwards and down to lower this away from the subframe as shown in **picture 15**.
- Remove the two spacers arrowed in **picture 16** from above by sliding the spacers out and replacing with S0722 (**item 4**) in the same orientation ensuring the small boss sits into the undertray. Clip the tray back into place and replace the bolts removed in the previous step to secure.
- The OEM tail unit will need to be partially disassembled to re-use the wiring sub-loom for indicators and licence plate light. To do this, use a Philips screwdriver to remove the screw shown in **picture 17** and remove the plastic panel.

R&amp;G

Unit 1, Shelley's Lane, East Worldham, Alton, Hampshire, GU34 3AQ

Tel: +44 (0)1420 89007 Fax: +44 (0)1420 87301 [www.rg-racing.com](http://www.rg-racing.com) Email: [info@rg-racing.com](mailto:info@rg-racing.com)



- Remove the wiring sub loom by disconnecting the indicator and licence plate light connections and removing the sub-loom from the securing clips arrowed in **picture 18**.

### **Tail Tidy Assembly**

- To assemble the R&G tail tidy, refer to the Assembly Diagram 1 & 2 and follow the steps below:
  - Affix the TB0299 Part 3 (**item 3**) cover plate to the TB0311 Part 1 bracket (**Item 1**) using 4 x M5x12mm countersunk bolts (**item 11**) adjusting as necessary before fixing each bolt with an M5 x 16mm OD washer (item 13) and Nyloc nut (**item 14**) with an 8mm spanner as shown in **Assembly diagram 2**.
  - Affix the TB0299 Part 2 plate mount bracket (**item 2**). In the same fashion using 4 x M5x12mm bolts (**item 11**), 4 x M5x12mm washers (**item 12**) and remaining M5 Nyloc Nuts (**item 14**).
  - Insert the rubber bung RB0002 Rubber bung (**item 15**) into the large hole in the mounting face of the tail tidy, as shown in **Assembly diagram 1**.
  - Place one section of heat shrink (**item 16**) over the wires of LA0002 (item 5) and heat carefully until wires are covered neatly.
  - Affix the LA0002 shroud if not already and secure with a small drop of superglue, this will direct the light towards the licence plate when fitted.
  - Fix the LA0002 (item 5) to the licence plate mount bracket using the 2 x nuts and washers provided using a 6mm socket as shown on **Assembly diagram 1**. Thread the wires downwards through the gap between the main bracket (**item 1**) and cover plate (**item 3**)
  - Attach the CON0014 (**item 21**) to the bullet connectors, ensuing to connect both **BLACK** wires together.

### **If using OEM indicators**

- If re-using the OEM indicators, remove these from the OEM tail unit by removing the securing nut from each indicator and thread the wire through the bracket to remove.
- Ensuring fix the indicators to the correct side, thread the connector and wire through the indicator mount on the licence plate mount bracket and the wire hole on TB0299 Part 1 (**item 1**). And affix the indicators securely with the with the OEM nut as shown in **picture 19**.

### **If using R&G Mini Indicators**

- If using R&G mini indicators, follow the steps below:
- Take one length of heat shrink (**item 16**) and place over each pair of indicator wires and heat carefully until the wires are neatly encased, leaving the bullet connectors exposed.
- Thread either indicator wire through the forward indicator mount hole on the licence plate mount bracket (**item 2**) and the wiring hole on the TB0299 Part 1 main bracket (part 1) and fix the indicator in place using the flanged nut. **DO NOT OVERTIGHTEN**.
- Thread both indicator wiring covers (**Item 20**) over the mini-indicator wires and cover the nut and thread, a small amount of soap may help guide the wires through the rubber.
- Connect the two indicator adaptors provided CON0073 & CON0074 (**items 22 & 23**) to the relevant indicators.

### **Fixing to the bike**

- With the light and indicators fixed to the tail tidy the OEM sub-loom removed earlier can be attached by connecting the relevant connectors to their counterparts as shown in **picture 20**.

R&G

Unit 1, Shelley's Lane, East Worldham, Alton, Hampshire, GU34 3AQ

Tel: +44 (0)1420 89007 Fax: +44 (0)1420 87301 [www.rg-racing.com](http://www.rg-racing.com) Email: [info@rg-racing.com](mailto:info@rg-racing.com)



- Secure the wiring and connectors by using the cable ties (**item 17**) to keep the wires together and use the cable tie slots provided on the underside of the cover plate to secure the wires neatly.
- Push the opposite end of the loom through the rubber bung in the main bracket (**item 1**) and pull through the extra wire.
- Use the self-adhesive cable clips (**item 18**) to tidy any loose wires.
- The tail tidy is now fully assembled and can be affixed to the bike, offer the tail tidy up to the bike as shown in **picture 21**. Ensure the spacers fitted earlier protruding through the tail unit of the bike sit into the slotted mounts on the main bracket (**item 1**).
- Using the M6 x 25 bolt (**item 6**) and one M6x12mm washer (**item 8**) in the rearward hole on the mounting tab slot, secure the tail tidy loosely into place.
- From below, pass the M6x20mm bolts (**item 7**) through the main bracket (**item 1**) and spacers, so the end of the bolt is accessible from the inside of the bike.
- Secure these bolts in place by using one M6x19mm washer (**item 9**) and an M6 Nyloc nut (**item 10**) for each bolt.
- Adjust the tail tidy on the slots if necessary, to ensure all components line up correctly
- Now fully tighten each bolt to the correct torque so the tail tidy is fully secured to the bike.
- Reconnect the OEM sub-loom to the OEM connector removed previously.
- Test both indicators and the licence plate light function correctly. If lights fail to illuminate, then swap the bullet connectors around and re-test.
- Re-fit the bodywork as previously fitted by reversing the steps above.
- Re-fit the licence plate (it may require drilling).
- Depending on local laws, attach enclosed reflector (**item 19**) in an appropriate location.
- Test the licence plate illuminator and all lights before riding.
- **IMPORTANT: IF FITTING A FULL-SIZE LICENCE PLATE AND PLACING IT FAR DOWN ON THE LICENCE PLATE HANGER, THERE IS A SMALL CHANCE OF THE LICENCE PLATE HITTING THE BACK WHEEL UNDER HEAVY LOAD AND OVER LARGE BUMPS IN THE ROAD. IT IS YOUR RESPONSIBILITY TO CHECK FOR THIS POSSIBILITY AND TAKE AVOIDING ACTION. FAILURE TO CHECK THIS COULD RESULT IN SERIOUS INJURY.**

ISSUE 1 26/08/2021 (WW)

#### CONSUMER NOTICE

The catalogue description and any exhibition of samples are only broad indications of the Products and R&G may make design changes which do not diminish their performance or visual appeal and supplying them in such state shall conform to the order. The Buyer acknowledges no representation or warranty (other than as to title) has been given or will apply to the Products other than those in R&G's order or confirmation and the Buyer confirms it has chosen the Products as being of merchantable quality and suitable for its particular purposes. Where R&G fits the Products or undertakes other services it shall exercise reasonable skill and care and rectify any fault free of charge unless the workmanship has been disturbed. The Buyer is responsible for ensuring that the warranty on the motorcycle is not affected by the fitting of the Products. On return of any defective Products R&G shall at its option either supply a replacement or refund the purchase money but shall not be liable if the Products have been modified or used or maintained otherwise than in accordance with R&G's or manufacturer's instructions and good engineering practice or if the defect arises from accident or neglect. Other than identified above and subject to R&G not limiting its liability for causing death and personal injury, it shall not be liable for indirect or consequential loss and otherwise its liability shall be limited to the amounts paid by the Buyer for the Products or the fitting or service concerned. These terms do not affect the Buyer's statutory rights.

#### R&G RACING RETURNS POLICY (NON-FAULTY GOODS)

Returns must be pre-authorized (if not pre-authorized the return will be rejected). Goods may only be returned direct to us if they were purchased direct from us (customer must prove if necessary). Otherwise to be returned to original vendor. Goods must be in re-sellable condition, in the opinion of R&G Racing. All returns are subject to a 25% restocking and handling fee (25% of the gross value exc. P&P – at the prevailing price at time of purchase). The customer must pay any and all carriage charges. No returns of discontinued products, unless within 14 days of purchase. This policy does not affect your statutory rights and does not refer to faulty goods.

R&G

Unit 1, Shelley's Lane, East Worldham, Alton, Hampshire, GU34 3AQ

Tel: +44 (0)1420 89007 Fax: +44 (0)1420 87301 [www.rg-racing.com](http://www.rg-racing.com) Email: [info@rg-racing.com](mailto:info@rg-racing.com)