



FITTING INSTRUCTIONS FOR LP0354
LICENCE PLATE BRACKET



THIS KIT CONTAINS THE ITEMS PICTURED AND LABELLED OVER PAGE.

SOME PARTS MAY BE SHOWN FOR CLARITY OF INSTRUCTIONS ONLY.

DO NOT PROCEED UNTIL YOU ARE SURE ALL PARTS ARE PRESENT.

PLEASE READ ALL INSTRUCTIONS BEFORE PROCEEDING.

**IF IN ANY DOUBT WHEN FITTING OUR PRODUCTS, CONSULT ONE OF OUR DEALERS
OR HAVE FITTED BY A QUALIFIED TECHNICIAN.**

PLEASE NOTE THAT THE WAY THE KIT IS PACKED DOES NOT NECESSARILY REPRESENT THE WAY OF
MOUNTING TO THE BIKE.

IN THE EVENT OF RUBBER WASHERS BEING USED TO HOLD COMPONENTS ONTO BOLTS,
THESE RUBBER WASHERS CAN BE THROWN AWAY.

DIGITAL COPIES OF THESE INSTRUCTIONS ARE AVAILABLE FROM:

WWW.RG-RACING.COM



<u>TOOLS REQUIRED</u>	<u>GENERAL TORQUE SETTINGS</u>
<ul style="list-style-type: none"> • METRIC ALLEN SET • METRIC SOCKET AND WRENCH • PHILLIPS-HEAD SCREWDRIVER 	M4 BOLT = 8Nm M5 BOLT = 12Nm M6 BOLT = 15Nm M8 BOLT = 20Nm M10 BOLT = 40Nm M12 BOLT = 40Nm

LEGEND

ITEM NO.	DESCRIPTION	QTY
ITEM 1	TB0354 - LICENSE PLATE BRACKET	1
ITEM 2	LA0002 - LICENSE PLATE ILLUMINATOR	1
ITEM 3	CON0007 - LICENSE PLATE ILLUMINATOR CONNECTOR	1
ITEM 4	M6 x 1.00 x 20mm BUTTON HEAD BOLT	4
ITEM 5	M6 x 12mm OD WASHER	4
ITEM 6	666-896-18 - 180mm LENGTH OF HEAT SHRINK	1
ITEM 7	CT75 - 75mm LONG CABLE TIE	6
ITEM 8	RB0010 - RUBBER BUNG	1
ITEM 9	REFL3 - REFLECTOR	1

R&G Racing

Unit 1, Shelley's Lane, East Worldham, Alton, Hampshire, GU34 3AQ

Tel: +44 (0)1420 89007 Fax: +44 (0)1420 87301 www.rg-racing.com Email: info@rg-racing.com



ASSEMBLY DIAGRAM

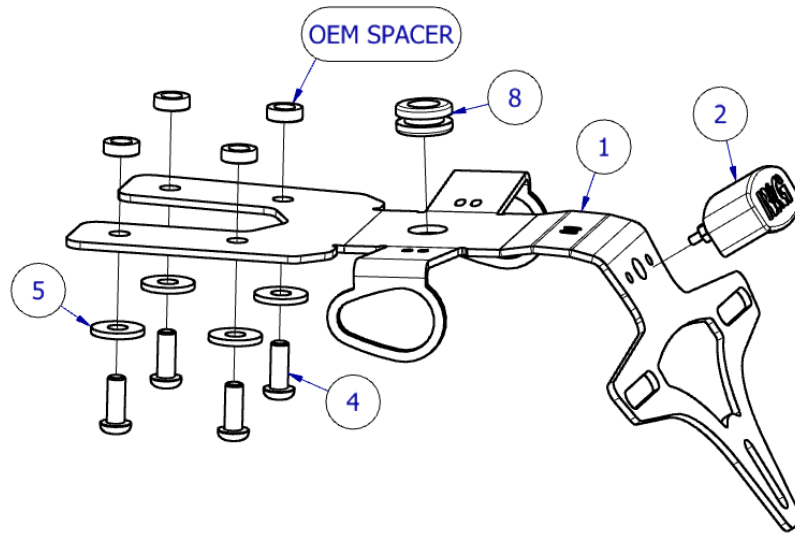

FITTING PICTURES

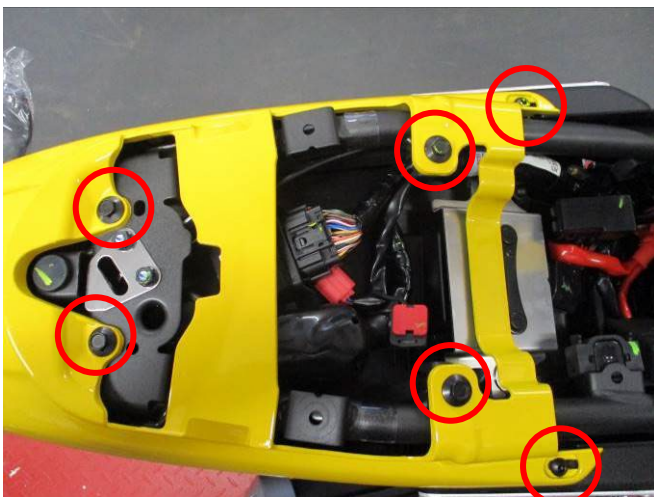

Picture 1

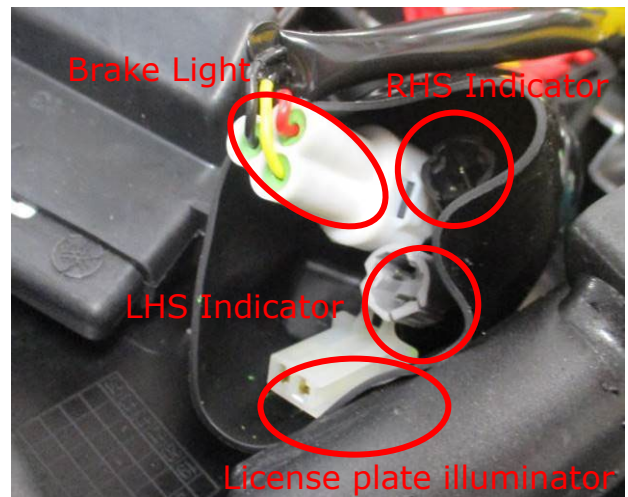

Picture 2

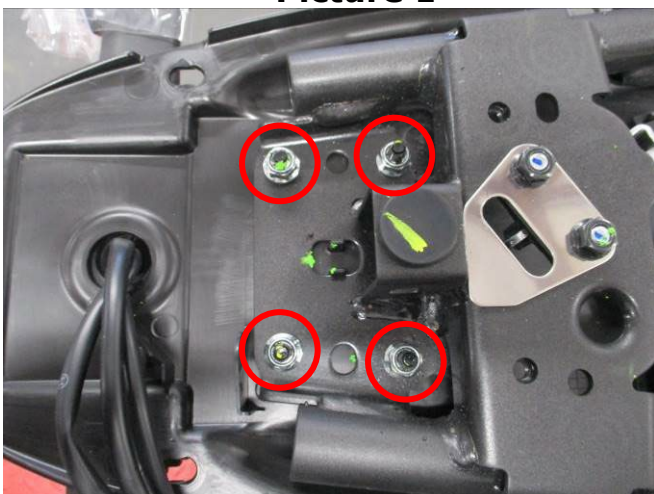

Picture 3

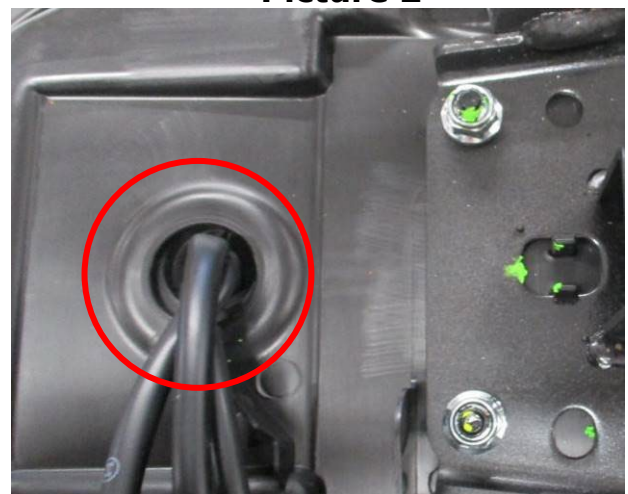

Picture 4



FITTING INSTRUCTIONS

- Begin by removing the passenger seat using the key.
- Remove the bolts securing the top of the tail fairing to the bike as shown in **Picture 1** and also carefully whilst holding the tail fairing to stop it from falling, remove the 4 x black screws from the underside of the tail to separate and remove the fairing from the bike.
- Now, with the tail ready to be lifted away, disconnect the 4 connectors highlighted in **Picture 2**.
- Remove the 4 x locking nuts as shown in **Picture 3** and carefully remove the OEM license plate bracket from the bike.
- Keep the 4 x OEM spacers safely to one side which are used to mount the OEM license plate bracket to the bike.
- Referring to the **ASSEMBLY DIAGRAM** above, pre-assemble the R&G Tail Tidy (**ITEM 1**) by attaching your OEM indicators to the bike along with the provided license plate illuminator (**ITEM 2**) and also the rubber bung to protect cables (**ITEM 8**).
- Thread the indicator cables along with the LA0002 cable through the rubber lined hole in the R&G Tail Tidy as shown in **Picture 4**.
- Protect the LA0002 wires by using the provided heat shrink (**ITEM 6**).
- Attach the provided license plate illuminator connector (**ITEM 3**).
- Tidy up all cables using the provided cable ties (**ITEM 7**) and slotted holes provided in the license plate bracket.
- Secure the R&G Tail Tidy to the bike using the bolts and washers provided (**ITEMS 4 & 5**) as shown in **ASSEMBLY DIAGRAM**, re-use the OEM spacers and locking nuts to attach to the bike.
- Check that the indicators and license plate illuminator are wired correctly and operating as they should before re-installing the tail fairing and seat.

IMPORTANT: IF FITTING A FULL-SIZE LICENCE PLATE AND PLACING IT FAR DOWN ON THE LICENCE PLATE HANGER, THERE IS A SMALL CHANCE OF THE LICENCE PLATE HITTING THE BACK WHEEL UNDER HEAVY LOAD AND OVER LARGE BUMPS IN THE ROAD. IT IS YOUR RESPONSIBILITY TO CHECK FOR THIS POSSIBILITY AND TAKE AVOIDING ACTION. FAILURE TO CHECK THIS COULD RESULT IN SERIOUS INJURY.

See more R&G products for your Motorcycle in the links below:

[R&G Racing | All Products for Yamaha - XSR125 \(2021\) \(rg-racing.com\)](http://www.rg-racing.com)

ISSUE 1 – 24/02/2023 - (AO)

CONSUMER NOTICE

The catalogue description and any exhibition of samples are only broad indications of the Products and R&G may make design changes which do not diminish their performance or visual appeal and supplying them in such state shall conform to the order. The Buyer acknowledges no representation or warranty (other than as to title) has been given or will apply to the Products other than those in R&G's order or confirmation and the Buyer confirms it has chosen the Products as being of merchantable quality and suitable for its particular purposes. Where R&G fits the Products or undertakes other services it shall exercise reasonable skill and care and rectify any fault free of charge unless the workmanship has been disturbed. The Buyer is responsible for ensuring that the warranty on the motorcycle is not affected by the fitting of the Products. On return of any defective Products R&G shall at its option either supply a replacement or refund the purchase money but shall not be liable if the Products have been modified or used or maintained otherwise than in accordance with R&G's or manufacturer's instructions and good engineering practice or if the defect arises from accident or neglect. Other than identified above and subject to R&G not limiting its liability for causing death and personal injury, it shall not be liable for indirect or consequential loss and otherwise its liability shall be limited to the amounts paid by the Buyer for the Products or the fitting or service concerned. These terms do not affect the Buyer's statutory rights.

R&G RACING RETURNS POLICY (NON-FAULTY GOODS)

Returns must be pre-authorized (if not pre-authorized the return will be rejected). Goods may only be returned direct to us if they were purchased direct from us (customer must prove if necessary). Otherwise to be returned to original vendor. Goods

R&G Racing

Unit 1, Shelley's Lane, East Worldham, Alton, Hampshire, GU34 3AQ

Tel: +44 (0)1420 89007 Fax: +44 (0)1420 87301 www.rg-racing.com Email: info@rg-racing.com