



## **FITTING INSTRUCTIONS FOR LP0394 LICENCE PLATE BRACKET**



**This kit contains the items pictured and labelled over page.**

**Some parts may be shown for clarity of instructions only.**

**Do not proceed until you are sure all parts are present.**

**Please read all instructions before proceeding.**

**IF IN ANY DOUBT WHEN FITTING OUR PRODUCTS, CONSULT ONE OF OUR DEALERS  
OR HAVE FITTED BY A QUALIFIED TECHNICIAN.**

Please note that the way the kit is packed does not necessarily represent the way of mounting to the bike.

In the event of rubber washers being used to hold components onto bolts, these rubber washers can be thrown away.

**DIGITAL COPIES OF THESE INSTRUCTIONS ARE AVAILABLE FROM**

**[WWW.RG-RACING.COM](http://WWW.RG-RACING.COM)**

**TOOLS REQUIRED**

- Set of metric Hex keys to include 3mm, 4mm and 5mm.
  - T30 Torx head tool
- Set of metric sockets and wrench. To include 6, 8 & 10mm.
  - 8mm & 10mm spanners.
  - Phillips screwdriver.

**GENERAL TORQUE SETTINGS**

M4 BOLT = 8Nm  
 M5 BOLT = 12Nm  
 M6 BOLT = 15Nm  
 M8 BOLT = 20Nm  
 M10 BOLT = 40Nm  
 M12 BOLT = 40Nm

**LEGEND**

ITEM No.	DESCRIPTION	QTY
ITEM 1	LICENSE PLATE BRACKET	1
ITEM 2	COVER PLATE	1
ITEM 3	LICENCE PLATE LIGHT	1
ITEM 4	BUTTON HEAD BOLT	2
ITEM 5	WASHER	4
ITEM 6	NYLOC NUT	4
ITEM 7	O-RING	2

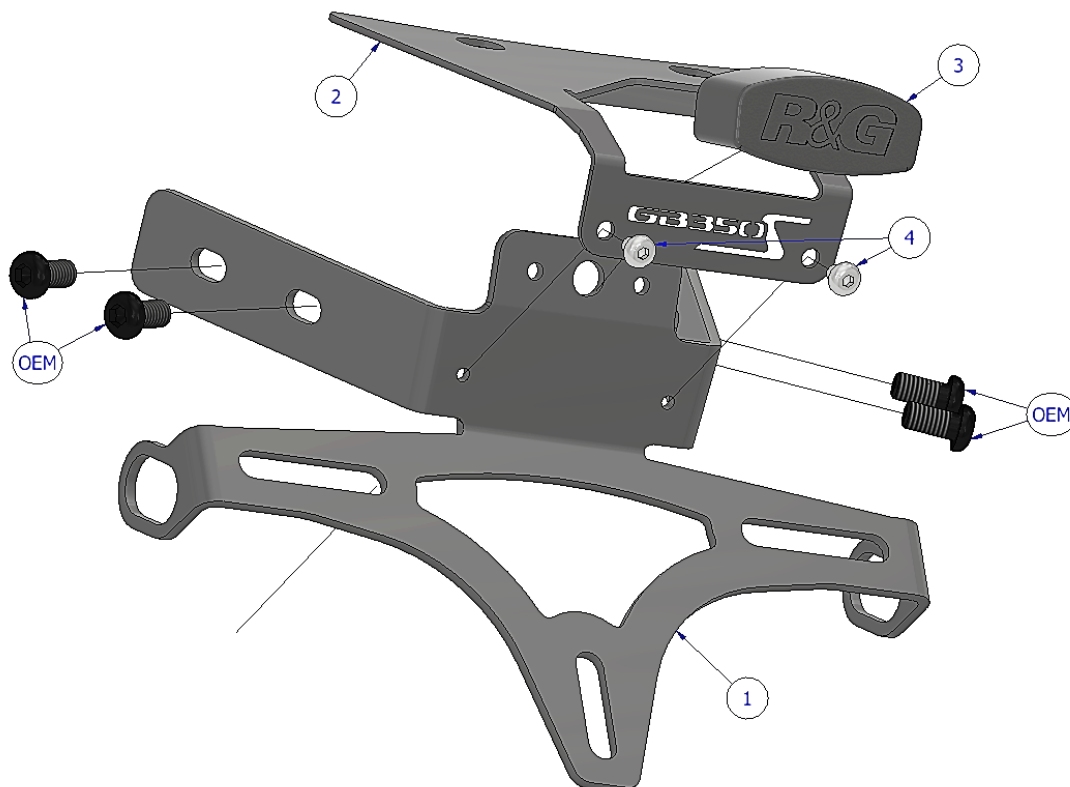
**ASSEMBLY DIAGRAM 1**



# FITTING PICTURES



**Picture 1**

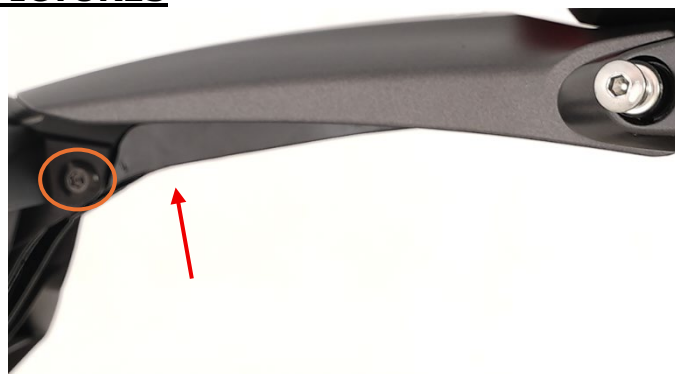

**Picture 2**

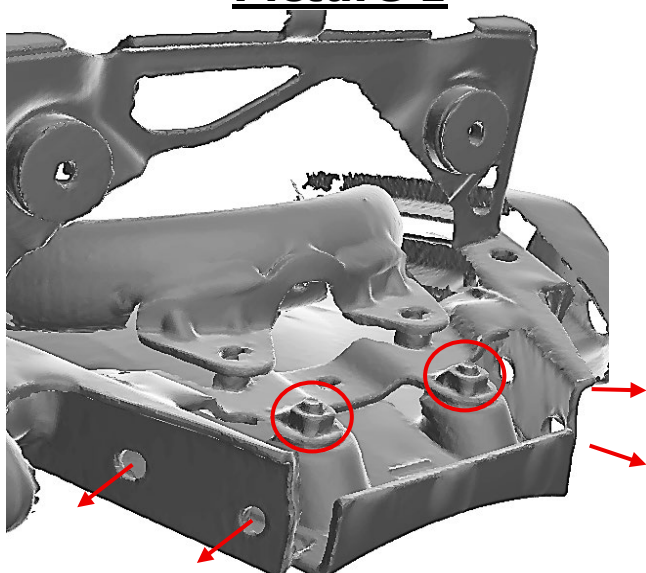

**Picture 3**

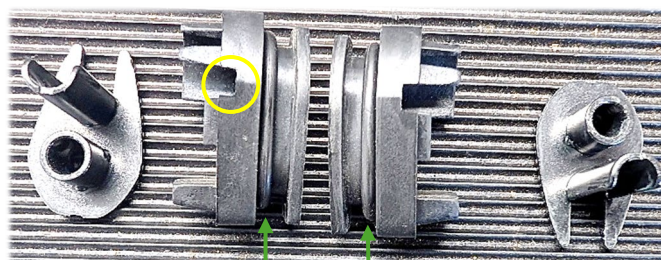

**Item 7**

**Picture 4**

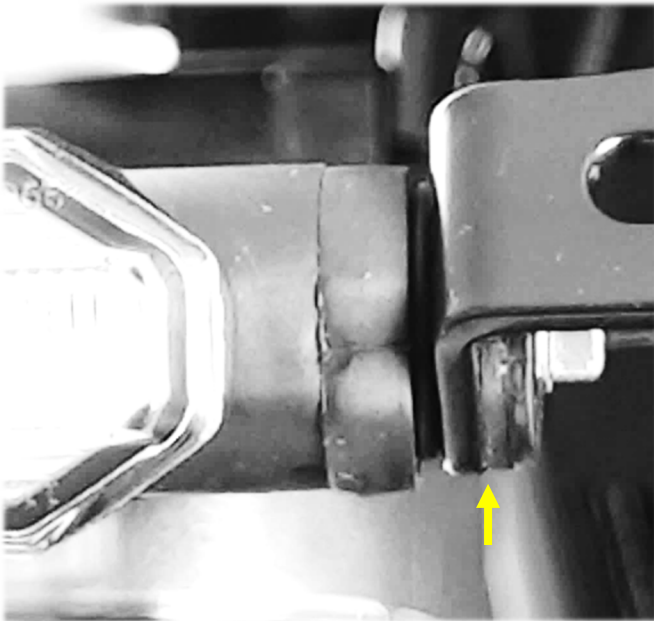

**Picture 5**

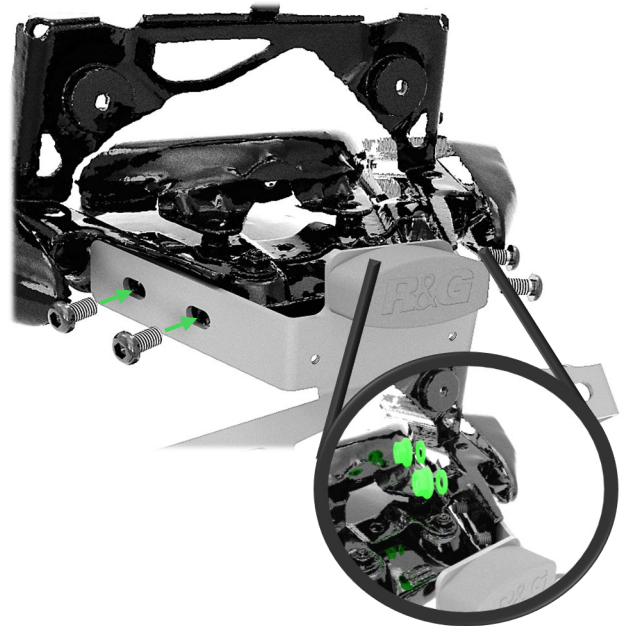

**Picture 6**

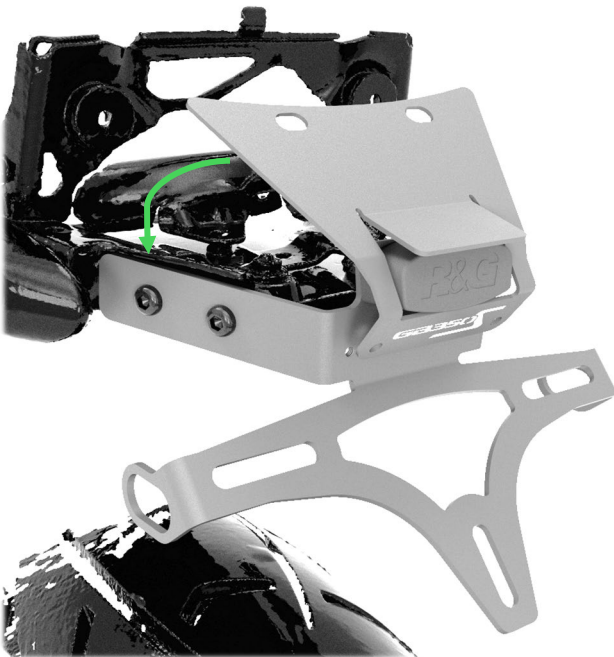

**Picture 7**

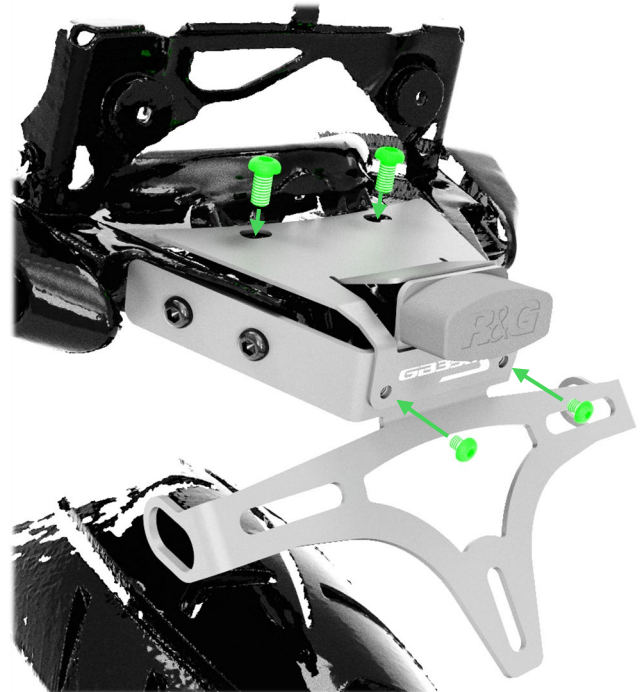

**Picture 8**





**Picture 9**

## **FITTING INSTRUCTIONS**

### **Disassembly Instructions:**

- Remove the seat unit by removing the two bolts either side of the seat, towards the back end of the seat. (circled in **Picture 1**)
- Then pull the seat unit backwards and up to release it from its hooks towards the front of the seat.
- Under the seat you will find a rubber/silicone sleeve which the wiring connectors for the brake/tail light and indicators.
- Disconnect the white connector then all the bullet connectors inside this sleeve.
- Remove the brake/tail light unit via the 2X nuts on the back of the unit, then unhook the shroud from the two side mounts & the top pin, then slide the whole assembly backwards.
- Remove the rearward bolts on the grab handles, leaving the forward mounting bolts in place but loose. (The handles will hang down, be careful not to let them swing down and hit the rear suspension) See **Picture 1**.
- Remove the rear fender via the two bolts that have been exposed by removing the tail light at the top of the fender, then remove the single self-tapping screw on the underside of the fender/tail unit. (Shown in **Picture 2**)
- Unhook the fender at each side then gently lift it away.
- Once the fender has been removed you should see the exposed subframe of the tail unit.
- Firstly, remove the 2X bolts on the underside of the under tray, circled in **Picture 3** this will allow the undertray to flex slightly while removing the original tail unit and fitting the tail tidy.
- Removing the four bolts in the positions shown in **Picture 3** will allow the tail unit subframe to be removed, please hold the unit while removing the final bolts.
- Dismantle the tail unit via the 2X bolts on either side of the frame (Circled orange in **Picture 2**) and remaining self-tapping screws.
- Remove the original indicators and re-assemble for storage.



### **Assembly of the R&G tail tidy:**

*Before assembling this product, ensure all the components within the box are correct by comparing the **legend** and **diagrams**.*

- Fit the original indicators to the R&G tail tidy in the same way they were attached to the original tail unit, except for addition the supplied O-rings (**Item 7**). These are applied to the mounting area and will sit behind the R&G bracket (**Item 1**) once fitted. (Please see **Picture 4** marked in green)

Please ensure the drainage hole on the indicators (Seen circled yellow in **Picture 7**) is located on the **underside** of the indicators when fitted.

- Apply the supplied heat shrink to number plate light (**Item 3**) wiring. Then fit the number plate light (**Item 3**) to the R&G tail tidy bracket (**Item 1**) using the supplied nuts and washers then apply the number plate light shroud.
- Once the lighting components have been fitted to the bracket, offer up the assembly to the outside of the subframe as shown in **Picture 6**. Routing the wiring through the centre of the mounts as it was on the original tail unit.
- Using a 5mm allen key and 10mm spanner, loosely apply the 4X OEM bolts you set aside earlier to the mounting points, with the supplied washers and nyloc nuts (**Items 5 & 6**) on the inside of the subframe. **Do not fully tighten at this point.**
- Once the bracket is secure, tidy the wiring using the supplied cable ties and make sure it will not be pinched when tightening the main bracket or when the cover plate is attached.

*At this point it is advised to thread in and back out the small M4 bolts into the bracket to make sure the thread is free of powder coat.*

- Slide the cover plate (**Item 2**) over the number plate light unit then rotate down onto the subframe.
- Once in place, loosely thread in the 2X small M4 bolts (**Item 4**)
- Followed by the 2X OEM bolts on the top of the cover plate.
- Re-attach the OEM brake/tail light using the original nuts & washers.
- Swing the 2X grab handles back up to their mounting points and insert the original bolt and spacer, then re-tighten all 4 grab handle bolts.
- Re-attach the 2X OEM under tray bolts your removed earlier to their original positions.
- Connect the brake/tail light, indicators & number plate light to the original loom.
- Re-attach the seat unit using the original mounting bolts.

**IMPORTANT: IF FITTING A FULL-SIZE LICENCE PLATE AND PLACING IT LOW DOWN ON THE LICENCE PLATE MOUNT, THERE IS A POTENTIAL CHANCE THE LICENCE PLATE COULD HIT THE BACK WHEEL UNDER HEAVY LOAD AND OVER LARGE BUMPS IN THE ROAD. IT IS YOUR RESPONSIBILITY TO CHECK FOR THIS POSSIBILITY AND TAKE AVOIDING ACTION. FAILURE TO CHECK THIS COULD RESULT IN SERIOUS INJURY.**

ISSUE 1 18/07/2025 (TB)

### **CONSUMER NOTICE**

The catalogue description and any exhibition of samples are only broad indications of the Products and R&G may make design changes which do not diminish their performance or visual appeal and supplying them in such state shall conform to the order. The Buyer acknowledges no representation or warranty (other than as to title) has been given or will apply to the Products other than those in R&G's order or confirmation and the Buyer confirms it has chosen the Products as being of merchantable quality and suitable for its particular purposes. Where R&G fits the Products or undertakes other services it shall exercise reasonable skill and care and rectify any fault free of charge unless the workmanship has been disturbed. The Buyer is responsible for ensuring that the warranty on the motorcycle is not affected by the fitting of the Products. On return of any defective Products R&G shall at its option either supply a replacement or refund the purchase money but shall not be liable if the Products have been modified or used or maintained otherwise than in accordance with R&G's or manufacturer's instructions and good engineering practice or if the defect arises from accident or neglect. Other than identified above and subject to R&G not limiting its liability for causing death



and personal injury, it shall not be liable for indirect or consequential loss and otherwise its liability shall be limited to the amounts paid by the Buyer for the Products or the fitting or service concerned. These terms do not affect the Buyer's statutory rights.

**R&G RACING RETURNS POLICY (NON-FAULTY GOODS)**

Returns must be pre-authorised (if not pre-authorised the return will be rejected). Goods may only be returned direct to us if they were purchased direct from us (customer must prove if necessary). Otherwise to be returned to original vendor. Goods must be in re-sellable condition, in the opinion of R&G Racing. All returns are subject to a 25% restocking and handling fee (25% of the gross value exc. P&P – at the prevailing price at time of purchase). The customer must pay any and all carriage charges. No returns of discontinued products, unless within 14 days of purchase. This policy does not affect your statutory rights and does not refer to faulty goods.