



FITTING INSTRUCTIONS FOR LP0395BK
LICENCE PLATE BRACKET



This kit contains the items pictured and labelled over page.
Some parts may be shown for clarity of instructions only.
Do not proceed until you are sure all parts are present.
Please read all instructions before proceeding.

IF IN ANY DOUBT WHEN FITTING OUR PRODUCTS, CONSULT ONE OF OUR DEALERS
OR HAVE FITTED BY A QUALIFIED TECHNICIAN.

Please note that the way the kit is packed does not necessarily represent the way of mounting to the bike.

In the event of rubber washers being used to hold components onto bolts, these rubber washers can be thrown away.



<u>TOOLS REQUIRED</u>	<u>GENERAL TORQUE SETTINGS</u>
<ul style="list-style-type: none"> Set of metric Hex keys to include 5mm & 6mm. Set of metric sockets and wrench. To include 8mm, 10mm & 12mm. <ul style="list-style-type: none"> Cable cutters 	M4 BOLT = 8Nm M5 BOLT = 12Nm M6 BOLT = 15Nm M8 BOLT = 20Nm M10 BOLT = 40Nm M12 BOLT = 40Nm

LEGEND

ITEM No.	DESCRIPTION	QTY
ITEM 1	MAIN MOUNTING BRACKET	1
ITEM 2	LICENCE PLATE BRACKET	1
ITEM 3	COVER PLATE	1
ITEM 4	NUMBER PLATE LIGHT	1
ITEM 5	M6X30mm BUTTON HEAD BOLT	4
ITEM 6	M6 NYLOC NUT	4
ITEM 7	6X12mm WASHER	8
ITEM 8	M5X12mm COUNTERSUNK BOLT	4
ITEM 9	M5 NYLOC NUT	4
ITEM 10	5x10mm WASHER	4
ITEM 11	RUBBER BUNG	2



Assembly Diagram

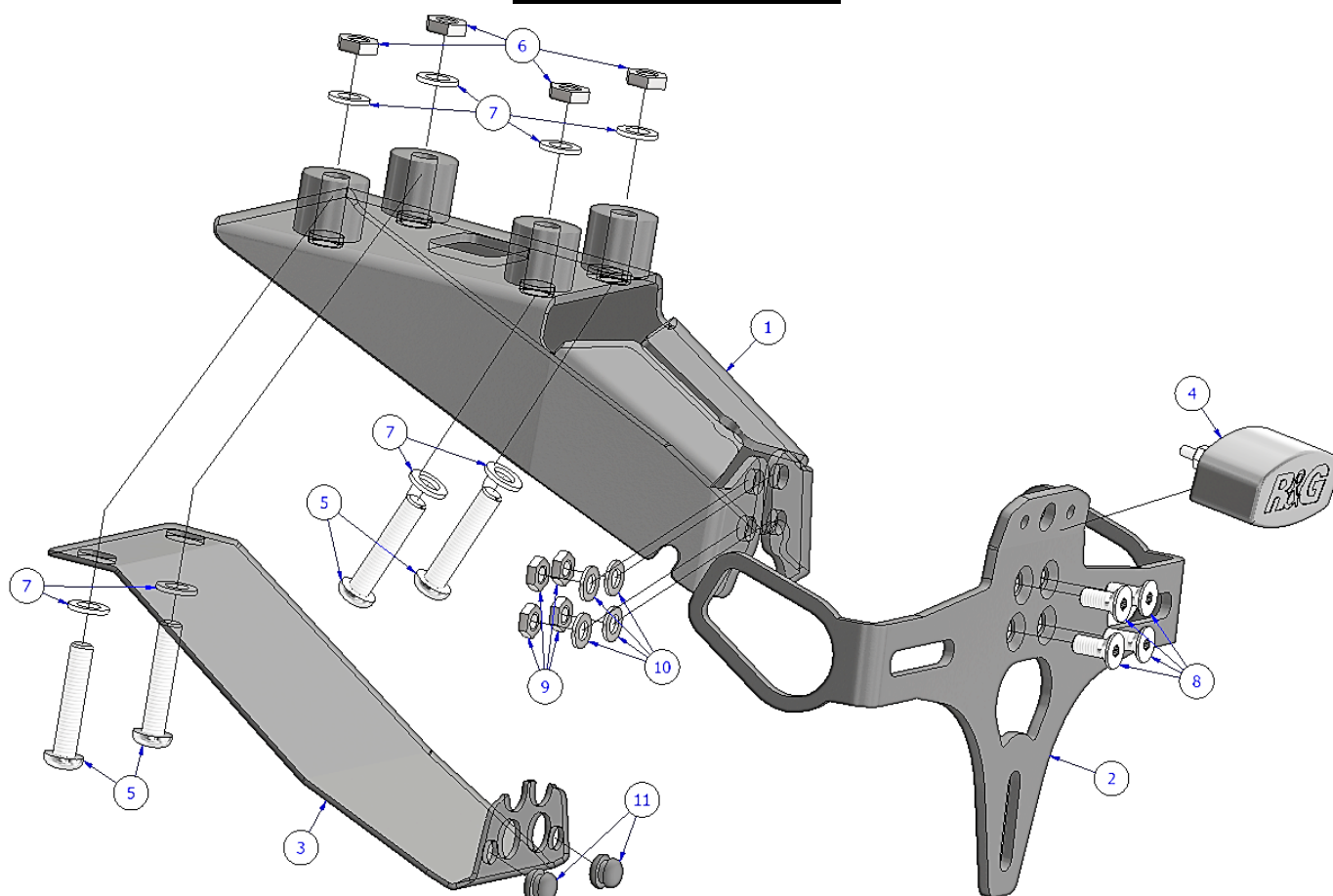

FITTING PICTURES

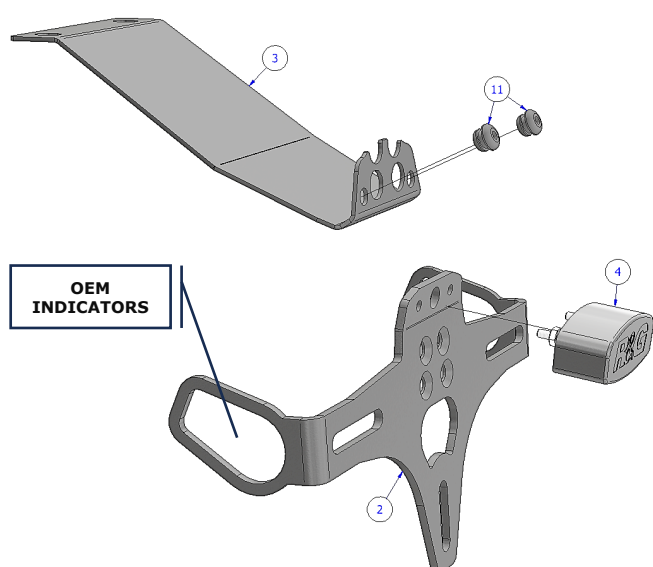

PICTURE 1

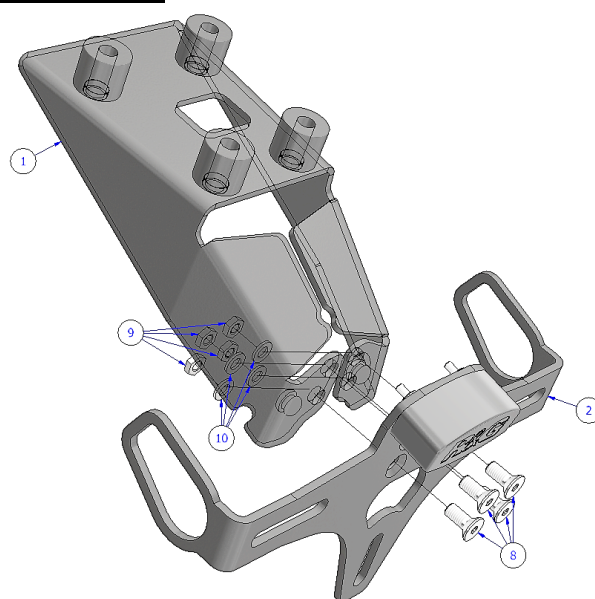

PICTURE 2

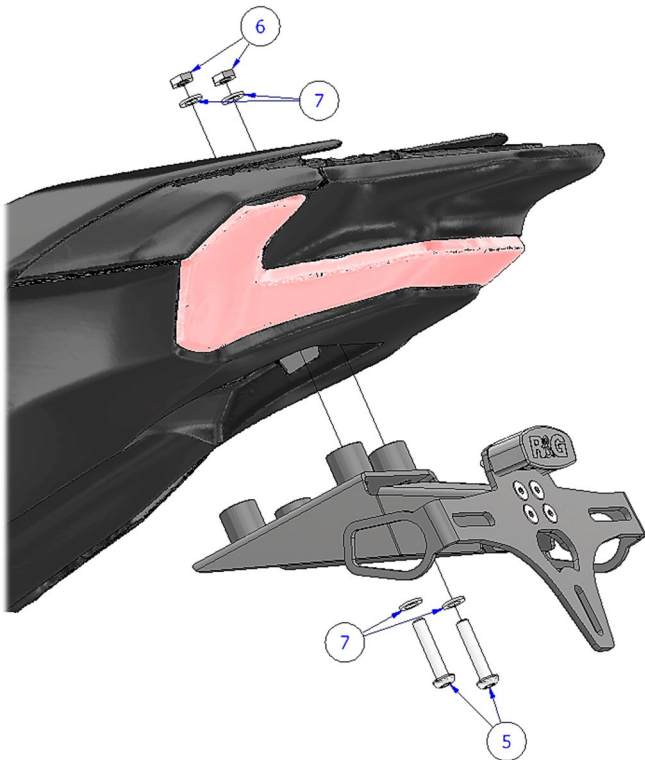

PICTURE 3

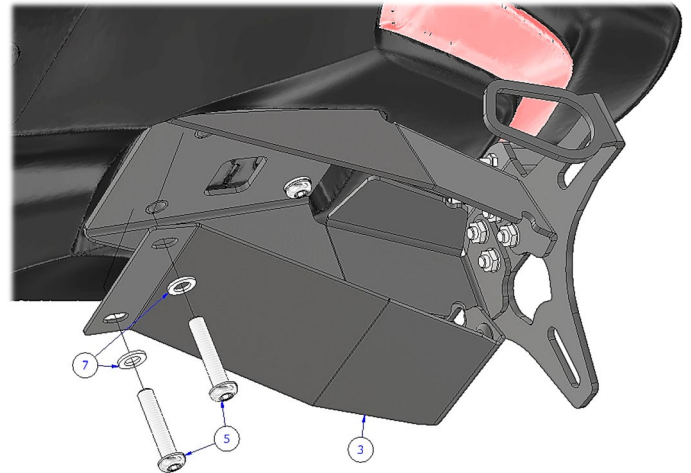

PICTURE 4

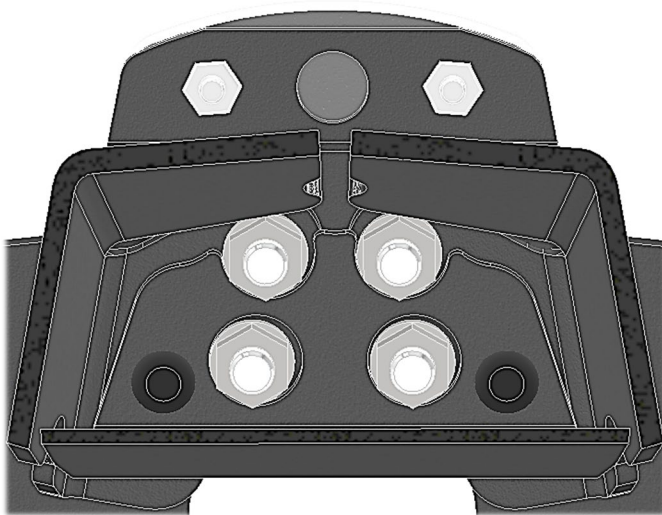

PICTURE 5



FITTING GUIDE

Disassembly Instructions:

- Remove the OEM seat unit and any tools etc from the storage compartment.
- Disconnect the wiring connectors coming through the undertray and into the tail unit.
- Remove the 4X bolts in the undertray, this will allow you to un-mount the OEM tail unit.
- Dismantle the OEM tail unit, keeping the indicators to one side for use with the R&G tail tidy.
- Re-assemble without the OEM indicators and store away safely.

Assembly Instructions:

- Using the supplied heat shrink, cover the number plate light wiring and indicator wiring (if necessary).
- Then fit the licence plate light (**Item 4**) to the licence plate bracket (**Item 2**).
- Fit the OEM indicators in the same way they were mounted to the OEM tail unit.
- Fit the supplied rubber bungs (**Item 11**) to the cover plate (**Item 3**) also shown in **Picture 1**.
- As shown in **Picture 2**; bolt the licence plate mounting bracket to the main mounting bracket using the supplied countersunk bolts (**Item 8**), washers (**Item 10**) and nyloc nuts (**Item 9**).

Fitting Instructions:

- Apply the 4X M6 washers (**Item 7**) onto the 4X M6 button head bolts (**Item 5**) ready for use, keeping the 4X M6 nyloc nuts & remaining washers close to hand.
- Holding the 2X bolts with washers in the rearward mounting positions, offer the assembly up to the bikes undertray and pass the exposed thread of the bolts through the mounting holes in the undertray.
- While holding the assembly in place, apply the washers and nyloc nuts to the exposed thread on the inside of the bike's storage compartment (See **Picture 3**).
- Fully tighten the bolts to their required torque setting while holding the other bolts in the forward mounting positions in order to keep the bracket aligned correctly.
- As shown in **Pictures 4**, offer up the cover plate (**Item 3**) with the supplied rubber bungs fitted, pushing the holes at the far end of the cover plate over the nuts on the back of the licence plate bracket (**Picture 5**)
- Making sure the indicator wires are secured in the slots to the side of the main bracket, push the remaining 2 bolts with washers through the main bracket and into the undertray, then apply the washers and nuts.
- Fully tighten the fasteners to their required torque setting.
- Re-connect the OEM indicator connectors to the wiring loom.



- Use the supplied connector to adapt the OEM wiring to the R&G number plate light.

IMPORTANT: FOR SAFETY, ENSURE THE LICENCE PLATE IS PLACED AS HIGH AS POSSIBLE ON THE TAIL TIDY (IT MAY REQUIRE DRILLING). IF FITTING A LICENCE PLATE OF 200MM OR LONGER (INCLUDING ANY SHROUD OR REFLECTOR ATTACHMENT) TO THE BRACKET, BEFORE RIDING, FULLY COMPRESS THE SUSPENSION TO ENSURE NO PART OF THE ASSEMBLY CAN CONTACT THE TYRE WHILE THE VEHICLE IS IN MOTION OR UNDER LOAD. IT IS YOUR RESPONSIBILITY TO CHECK FOR THIS POSSIBILITY AND TAKE AVOIDING ACTION. FAILURE TO CHECK THIS COULD RESULT IN SERIOUS INJURY OR DAMAGE TO THE MOTORCYCLE.

ISSUE 1 – 22/04/2025 (TB)

CONSUMER NOTICE

The catalogue description and any exhibition of samples are only broad indications of the Products and R&G may make design changes which do not diminish their performance or visual appeal and supplying them in such state shall conform to the order. The Buyer acknowledges no representation or warranty (other than as to title) has been given or will apply to the Products other than those in R&G's order or confirmation and the Buyer confirms it has chosen the Products as being of merchantable quality and suitable for its particular purposes. Where R&G fits the Products or undertakes other services it shall exercise reasonable skill and care and rectify any fault free of charge unless the workmanship has been disturbed. The Buyer is responsible for ensuring that the warranty on the motorcycle is not affected by the fitting of the Products. On return of any defective Products R&G shall at its option either supply a replacement or refund the purchase money but shall not be liable if the Products have been modified or used or maintained otherwise than in accordance with R&G's or manufacturer's instructions and good engineering practice or if the defect arises from accident or neglect. Other than identified above and subject to R&G not limiting its liability for causing death and personal injury, it shall not be liable for indirect or consequential loss and otherwise its liability shall be limited to the amounts paid by the Buyer for the Products or the fitting or service concerned. These terms do not affect the Buyer's statutory rights.

R&G RACING RETURNS POLICY (NON-FAULTY GOODS)

Returns must be pre-authorised (if not pre-authorised the return will be rejected). Goods may only be returned direct to us if they were purchased direct from us (customer must prove if necessary). Otherwise to be returned to original vendor. Goods must be in re-sellable condition, in the opinion of R&G Racing. All returns are subject to a 25% restocking and handling fee (25% of the gross value exc. P&P – at the prevailing price at time of purchase). The customer must pay any and all carriage charges. No returns of discontinued products, unless within 14 days of purchase. This policy does not affect your statutory rights and does not refer to faulty goods.