



FITTING INSTRUCTIONS FOR LP0415 LICENCE PLATE BRACKET



This kit contains the items pictured and labelled over page.

Some parts may be shown for clarity of instructions only.

Do not proceed until you are sure all parts are present.

Please read all instructions before proceeding.

**IF IN ANY DOUBT WHEN FITTING OUR PRODUCTS, CONSULT ONE OF OUR DEALERS
OR HAVE FITTED BY A QUALIFIED TECHNICIAN.**

Please note that the way the kit is packed does not necessarily represent the way of mounting to the bike.

In the event of rubber washers being used to hold components onto bolts, these rubber washers can be thrown away.



<u>TOOLS REQUIRED</u>	<u>GENERAL TORQUE SETTINGS</u>
<ul style="list-style-type: none"> • Set of metric Hex keys • Cable cutters • Phillips screwdriver 	M4 BOLT = 8Nm M5 BOLT = 12Nm M6 BOLT = 15Nm M8 BOLT = 20Nm M10 BOLT = 40Nm M12 BOLT = 40Nm

LEGEND

ITEM No.	DESCRIPTION	QTY
ITEM 1	TAIL TIDY BRACKET (TB0214 PART 1)	1
ITEM 2	COVER PLATE (TB0214 PART 2)	1
ITEM 3	SPACER PLATE (TB0415 PART 1)	1
ITEM 4	LICENSE PLATE LIGHT (LA0012)	1
ITEM 5	M6 x 20mm BOLT	4
ITEM 6	M6 x 30mm BOLT	4
ITEM 7	M6 NUT	4
ITEM 8	M6 WASHER	4
ITEM 9	180mm OF HEAT SHRINK	1
ITEM 10	LICENSE PLATE LIGHT CONNECTOR (CON0007)	1
ITEM 11	CABLE TIES (CT220)	2
ITEM 12	REFLECTOR (REFL3)	1
ITEM 13	RUBBER GROMMET	1
ITEM 14	RUBBER O-RING	1



Assembly Diagram

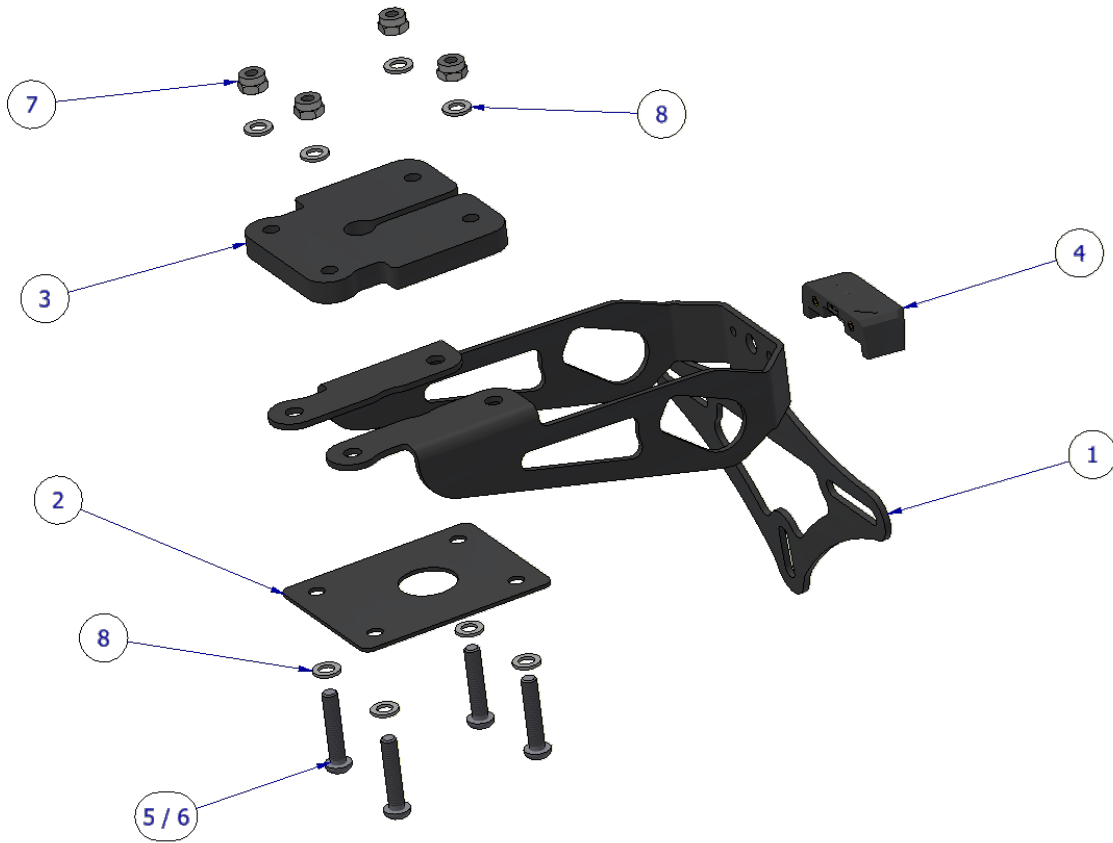

FITTING PICTURES



Picture 1



Picture 2

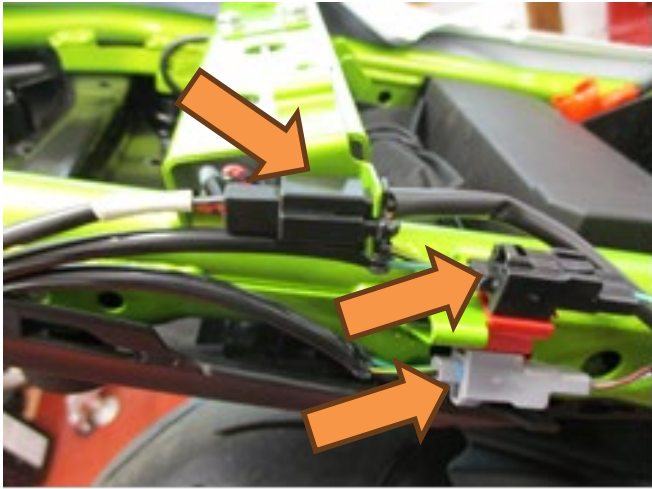

Picture 3

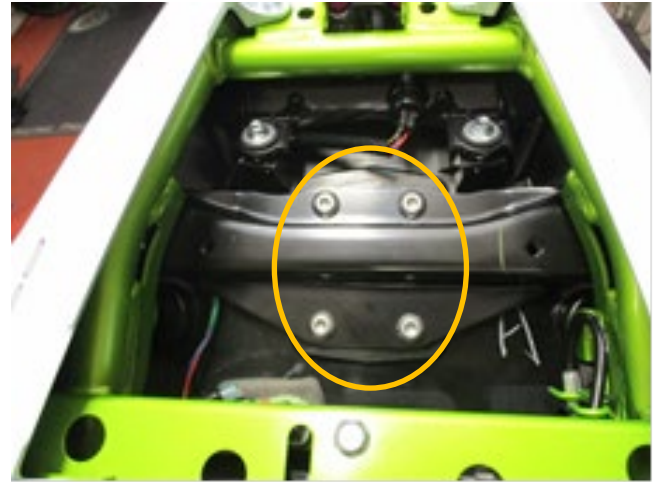

Picture 4

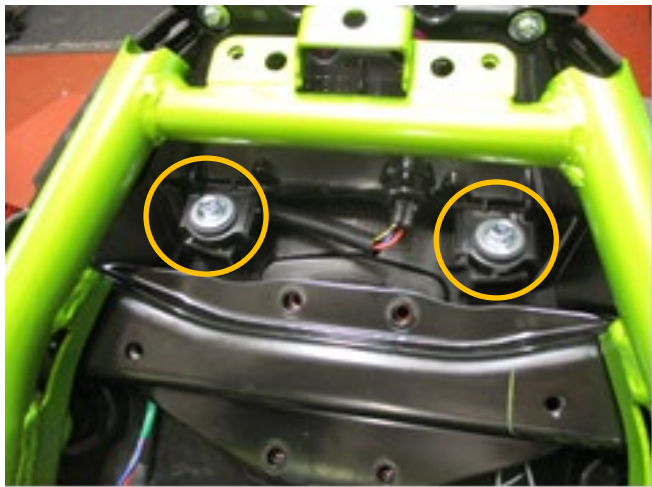

Picture 5



Picture 6

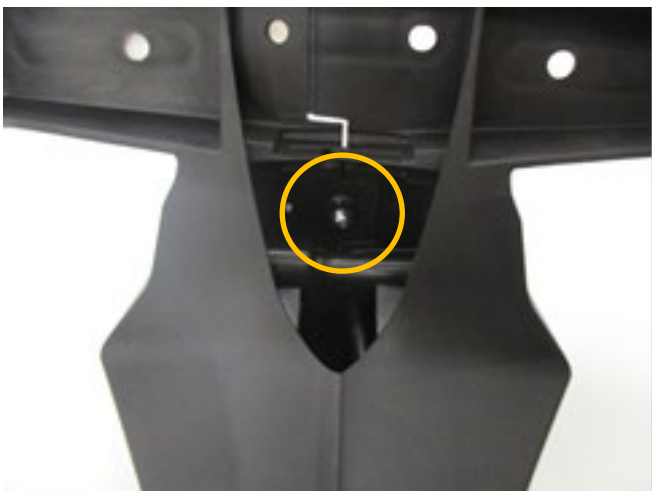

Picture 7



Picture 8



Picture 9



Picture 10

FITTING GUIDE

Disassembly Instructions:

- Remove the rear seat/cover using the key.
- Remove the bolt circled in **Picture 1**, and corresponding bolt on the LHS.
- Remove the 5x bolts circled and arrowed in **Picture 2**, this will allow you to remove the black plastic panel and coloured side panels. You can now disconnect the connectors circled in **Picture 3**.
- Now remove the 4 bolts circled in **Picture 4** this will allow you to gently pull down the undertray (you may also need to remove the 2 bolts circled in **Picture 5**) to allow you access to the screw securing the OEM tail unit in place shown in **Picture 6**.
- Remove this screw while supporting the OEM tail unit to keep it from falling.
- Remove the nut circled in **Picture 7** and 2x screws circled in **Picture 8** to allow access to the OEM indicators.
- Remove the screw arrowed in **Picture 9**, plate & retaining plastic molding shown in **Picture 10** on both sides to release the OEM indicators. Keep these screws and the indicators aside for use later, making a note of which indicator corresponds to which side of the bike.

Assembly Instructions:

- From the kit, take the R&G License plate Illuminator (**Item 4**) and place it through the three in-line holes in the centre of license plate bracket (**Item 1**). Secure the license plate illuminator using M3 washers and bolts provided in the kit. **Please use the supplied spacers & bolts to ensure the light clears any plate frame installed and fully illuminates the number plate.**
- Feed the license plate illuminator wires through the heat-shrink tube (**Item 9**) provided and using a suitable heat resource, shrink the tube to protect the wires.
- Fit the OEM indicators to the tail tidy bracket, using the same process detailed to remove them in reverse.
- Feed all the wires (License plate illuminator & indicators wiring) through the cover plate (**Item 2**) on top of the R&G license plate bracket as shown in the **Assembly Diagram**.

Racing Technique Ltd T/A R&G

Unit 1, Shelley's Lane, East Worldham, Alton, Hampshire, GU34 3AQ
 Tel: +44 (0)1420 89007 www.rg-racing.com Email: info@rg-racing.com



- Offer the whole assembly towards the sub-frame and feed the wires as original.
- **If fitting to a 2026+ Z650S, please place the spacer plate (Item 3) between the tail tidy bracket and the undertray, and use the longer 40mm bolts to mount the assembly.**
- **If fitting to a 2017- Ninja 650 or Z650 do not fit the spacer plate. Locate the O-ring (Item 14) into the Rubber bung (Item 13). Locate the rubber bung and O-Ring assembly into the provided hole in the cover plate (Item 3) (O-ring to sits below the cover plate), thread the wires through the rubber bung and use the 20mm bolts.**
- Secure the assembly onto the sub-frame using M6 bolts (**Item 5/6**), M6 washers (**Item 8**) and M6 nyloc nuts (**Item 7**). *Note: Washers to be located as illustrated in exploded diagram above.* Tighten the nuts to 15Nm.
- From the kit take the license plate illuminator connector (**Item 10**) and connect the bullet connectors to LA0012.
- Fit the LA0012 wires and OEM brake & indicator light unit wires to the OEM wiring harness.
- Test the indicators and license plate illuminator to ensure they are working correctly, if not the connectors may need to be swapped around.
- Fully tighten the bolts to their required torque.
- Tuck the wiring back into place, refit the OEM plastic panels and both seats.

IMPORTANT: FOR SAFETY, ENSURE THE LICENCE PLATE IS PLACED AS HIGH AS POSSIBLE ON THE TAIL TIDY (IT MAY REQUIRE DRILLING). IF FITTING A LICENCE PLATE OF 200MM OR LONGER (INCLUDING ANY SHROUD OR REFLECTOR ATTACHMENT) TO THE BRACKET, BEFORE RIDING, FULLY COMPRESS THE SUSPENSION TO ENSURE NO PART OF THE ASSEMBLY CAN CONTACT THE TYRE WHILE THE VEHICLE IS IN MOTION OR UNDER LOAD. IT IS YOUR RESPONSIBILITY TO CHECK FOR THIS POSSIBILITY AND TAKE AVOIDING ACTION. FAILURE TO CHECK THIS COULD RESULT IN SERIOUS INJURY OR DAMAGE TO THE MOTORCYCLE.

ISSUE 1 - 16/04/2026 (MH)

CONSUMER NOTICE

The catalogue description and any exhibition of samples are only broad indications of the Products and R&G may make design changes which do not diminish their performance or visual appeal and supplying them in such state shall conform to the order. The Buyer acknowledges no representation or warranty (other than as to title) has been given or will apply to the Products other than those in R&G's order or confirmation and the Buyer confirms it has chosen the Products as being of merchantable quality and suitable for its particular purposes. Where R&G fits the Products or undertakes other services it shall exercise reasonable skill and care and rectify any fault free of charge unless the workmanship has been disturbed. The Buyer is responsible for ensuring that the warranty on the motorcycle is not affected by the fitting of the Products. On return of any defective Products R&G shall at its option either supply a replacement or refund the purchase money but shall not be liable if the Products have been modified or used or maintained otherwise than in accordance with R&G's or manufacturer's instructions and good engineering practice or if the defect arises from accident or neglect. Other than identified above and subject to R&G not limiting its liability for causing death and personal injury, it shall not be liable for indirect or consequential loss and otherwise its liability shall be limited to the amounts paid by the Buyer for the Products or the fitting or service concerned. These terms do not affect the Buyer's statutory rights.

R&G RACING RETURNS POLICY (NON-FAULTY GOODS)

Returns must be pre-authorized (if not pre-authorized the return will be rejected). Goods may only be returned direct to us if they were purchased direct from us (customer must prove if necessary). Otherwise to be returned to original vendor. Goods must be in re-sellable condition, in the opinion of R&G Racing. All returns are subject to a 25% restocking and handling fee (25% of the gross value exc. P&P - at the prevailing price at time of purchase). The customer must pay any and all carriage charges. No returns of discontinued products, unless within 14 days of purchase. This policy does not affect your statutory rights and does not refer to faulty goods.

NOTICE DE MONTAGE LP0415 SUPPORT DE PLAQUE





CE KIT CONTIENT LES ARTICLES ILLUSTRÉS ET ÉTIQUETES SUR LA PAGE.

CERTAINES PARTIES PEUVENT ÊTRE PRÉSENTES UNIQUEMENT POUR LA CLARTÉ DES INSTRUCTIONS.

NE PAS PROCÉDER AU MONTAGE TANT QUE VOUS N'ÊTES PAS SÛR QUE TOUTES LES PIÈCES SOIENT PRÉSENTES.

VEUILLEZ LIRE TOUTES LES INSTRUCTIONS AVANT DE CONTINUER.

**EN CAS DE DOUTE LORS DU MONTAGE DE NOS PRODUITS, CONSULTEZ UN DE NOS
REVENDEURS OU FAITES APPEL À UN TECHNICIEN QUALIFIÉ.**

VEUILLEZ NOTER QUE LA FAÇON DONT LE KIT EST EMBALLÉ NE REPRÉSENTE PAS NECESSAIREMENT LA MANIÈRE DE LE
MONTER SUR LA MOTO. _

SI DES RONDELLES EN CAOUTCHOUC SONT UTILISÉES POUR MAINTENIR